

681392

GOVERNMENT CREEK
53° 30'



Min. & Placer Reserve
1/2 Mile Either Side
O/C 2732, 7 Aug. 73.
Subject To Conditions

MINERAL RESERVE
O/C 294: 85-02-22
SUBJECT TO CONDITIONS

1981 trenching
0.154 opt Au

manipulated
calcite

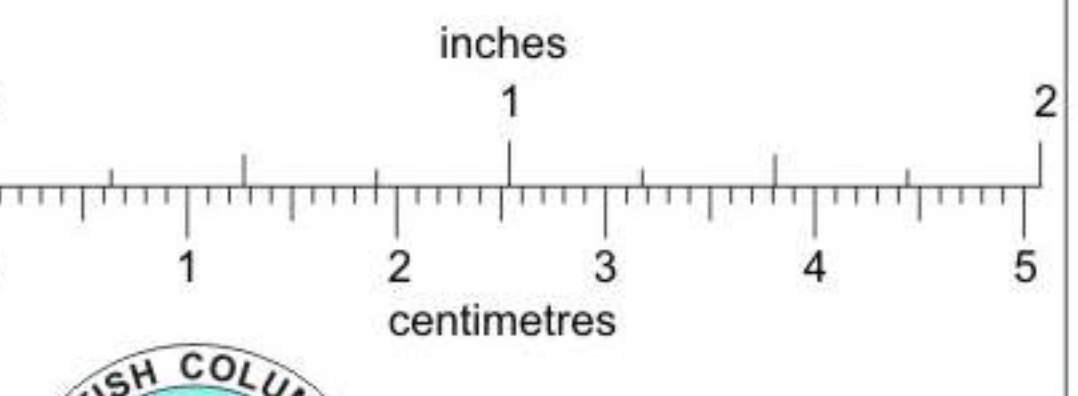

BRITISH COLUMBIA
GEOLOGICAL SURVEY

This reference scale bar has been added to the original image. It will scale at the same rate as the image, therefore it can be used as a reference for the original size.