

1" = 10'

(55)

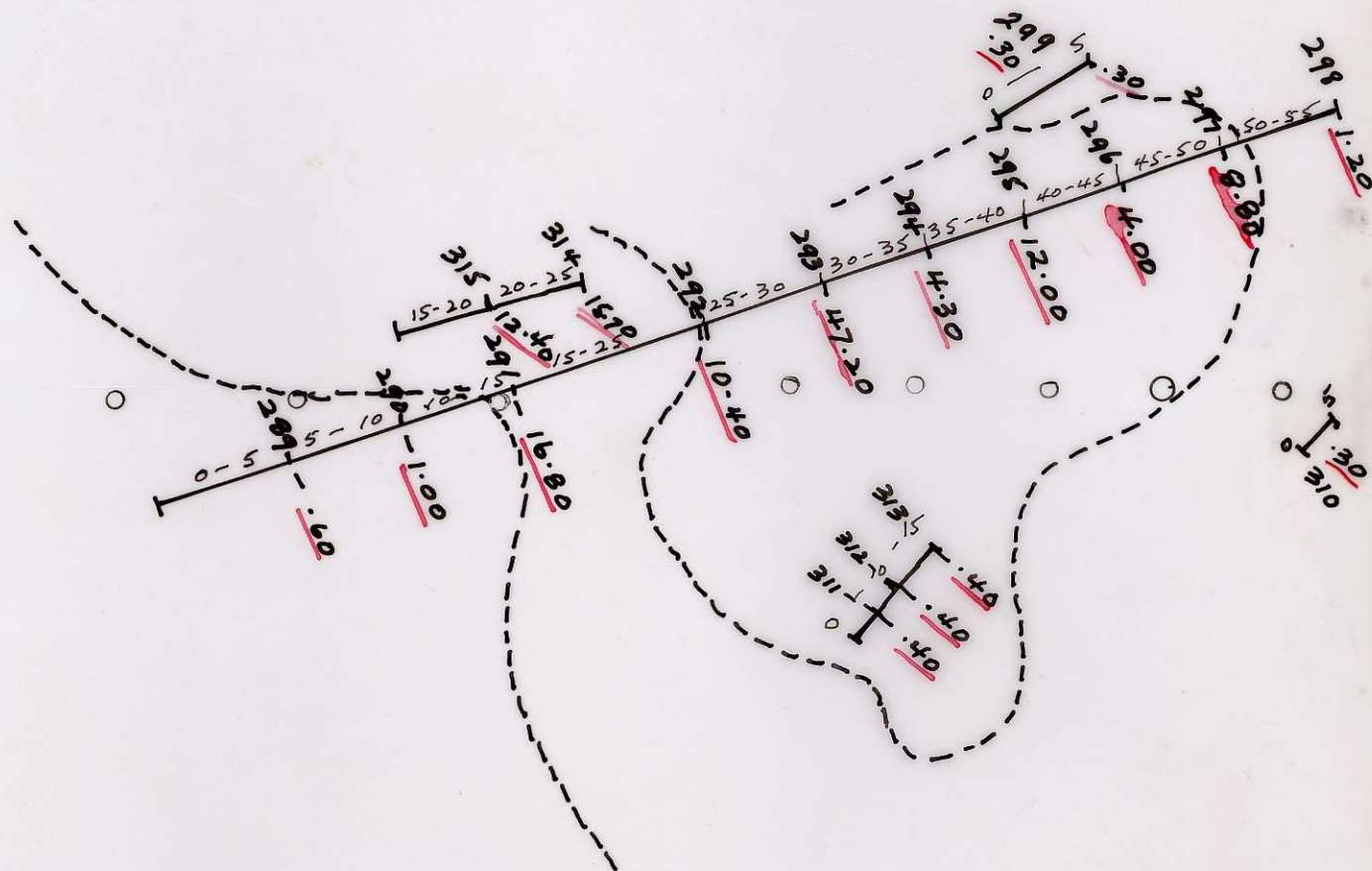

681260

CHIP SAMPLING 5' sections  
AU CLAIMS. MERRITT B.C. Sept/72  
OWNER. H. NESBITT. W. Deans

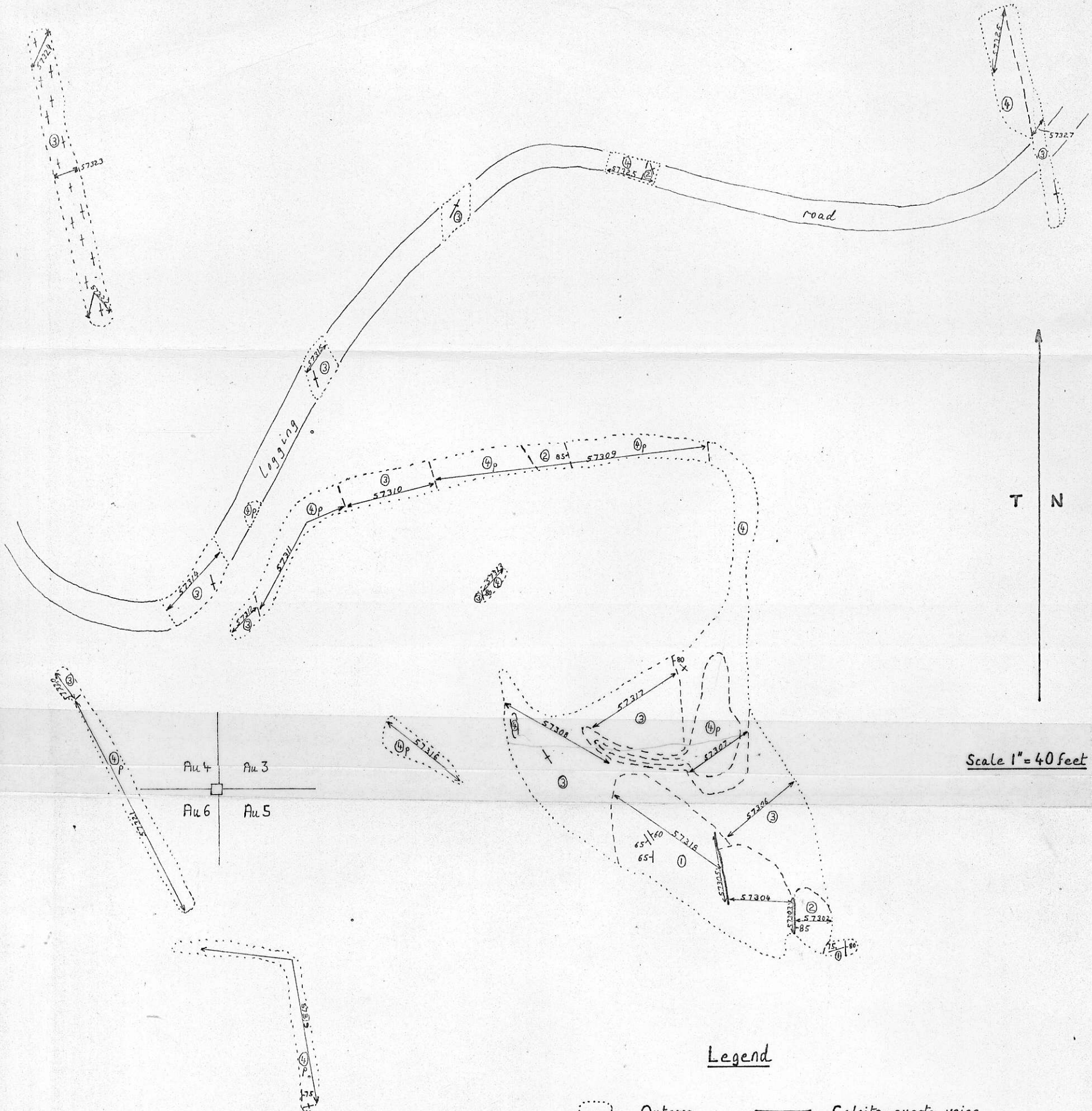

Scale 1" = 40 feet

Legend

- |  |             |  |                                     |
|--|-------------|--|-------------------------------------|
|  | Outcrop     |  | Calcite-quartz veins                |
|  | Contacts    |  | Dioritic Intrusive, porphyritic     |
|  | Fracturing  |  | " " , chilled                       |
|  | Samples     |  | Argillite, intensely silicified     |
|  | Claim posts |  | " , weakly to moderately silicified |
|  |             |  | " , unsilicified                    |

D. B. Petersen  
R. H. Pinsent

May, 1972.





SAMPLE PLAN  
 NESBITT GOLD PROPERTY  
 AU CLAIMS  
 ASPEN GROVE AREA  
 92H15  
 1" = 50'  
 Assays for gold (Dwt)

- Sample site
- Outcrop area
- == Road
- Claim post

To Highway #5  
 15 miles

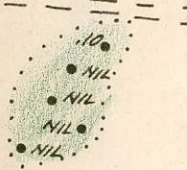

LEGEND

- V V V QUARTZ DIORITE
- ALTERED ARGILLITE AND VOLCANIC ROCKS

QUILCHENA CREEK ROAD

Chip Samples

A - B	
0-5'	0.60
5-10	1.00
10-25	10.40
25-30	47.20
30-35	4.30
35-40	12.00
40-45	4.00
45-50	18.80
50-55	1.20

Geology and sampling by W. Deans, 10/72  
 Drawn by PF

