

#65 MIN INV.
"Cu"

92H-4E



BC7056-167

BC7056-167



Lucky Falls
92H/4E

681222

3450 WEST 35TH AVE. VANCOUVER B.C. SEPT 17TH 1980.

A.F.REEVE.
No 904 675 WEST HASTING ST.
VANCOUVER B.C.

DEAR AFR:-

I LEFT A LETTER AT YOUR OFFICE THE OTHER DAY WITH MAP OF THE TWO CHEAM CLAIMS STAKED, WHICH HAD EXPIRED SEPT 12TH 1980. IF THEY DO NOT EXERCISE THEIR 30 DAY OPTION, THE CLAIMS WILL BE OPEN. IF SOME ONE WERE TO STAKE OVER THEM BEFORE THE 30 DAYS ARE UP, THE STAKER AND RECORDER WOULD HAVE PREFERENCE OVER OTHER STAKERS. IN THE PAST, I HAD THE MINERAL ACT UP TO DATE AND AT MY FINGER TIPS; BUT HAVE NOT FOLLOWED IT CLOSELY LATELY.

YESTERDAY I WENT TO 800 HORNBY STREET AND LOOKED UP TWO PROPERTIES SITUATED IN THE INTERIOR BOTH IN SOUTHERN PARTS OF B.C.; AND ACCESSIBLE BY CAR. THERE IS ONE PROPERTY WHICH WE NEVER FINALIZED WHICH IS A HELICOPTER TRANSPORTATION PROPOSITION; AND NOT FEASIBLE FOR WORKING THIS LATE IN THE SEASON. IT IS A PROPERTY WITH CAPPINGS OF MAGNETITE AND HEMATITE IRON; AND IS ENCIRCLED BY A LIMESTONE BELT, WHICH FORMS A SYNCLINE AND ALSO AN ANTICLINE AROUND THE IRON CAPPINGS OF MOST OF THE MOUNTAIN. THE LIMESTONE CIRCLE IS APPROXIMATELY THREE MILES IN DIAMETER.

FROM SAMPLE TESTS AND WHAT WE KNOW OF PORTIONS OF THE LIMESTONE CONTACTS IN PARTS OF THE CIRCLE, PLUS SOME PROBING OF THE CAPPINGS IT IS AS BIG (AND SIMILAR TO THE UTAH MINE PROPERTY.)

HAVE NOT CHECKED RECENTLY AS TO WHETHER IT'S A SLEEPER NOW OR NOT.

SINCERELY.

WEH

I LOOKED THE TWO PROPERTIES UP YESTERDAY, FOR A PARTNER OF MINE WHO NOW LIVES AT CAMPBELL RIVER. THE DRILLER PARTNER LIVES IN NORTH VANCOUVER.

We think

W. H. Arney

Just go straight back
southwardly ^{path or the} up the A hog - back.

Do NOT cross any creeks

That small stream a few
yards to the left of the
blacksmith's main excavation
is ^{as you face south} a branch that runs
into the main stream of
the East Creek.

The limestone bluff

will be iron-stained.
and plainly seen from
the flat which is
south of where the
hog back ends and ^{south of} where
you encounter a road
running east and west.
The flat has some trees on
it and begins to slope upward.

Just go straight back
southwardly up the path
on the hogback.

Do NOT cross any creeks.

That small stream a few
yards to the left of the
blacksmith's main excavation,
as you face south,
is a branch that
runs into the main
stream of The East Creek.

The limestone face will be
iron - stained. You

can see it quite plainly,
after you come to end of
hogback you come to a crossroad
and a flat with trees sloping
upward keep on going up south
and you will see a limestone bluff
and in contact with an iron stained bluff the blacksmith's deposit.

Aigassiz 6-24-64

(1)

Mr W. C. Harvey.

Dear Sir,

I rec'd your welcome letter this a.m.

I also hope you could come soon.

I have a Son living in Toronto & working there
He took some of my Samples, and showed
same to a friend of his, who is in the Mining
Business, and said it was high grade ore.
and He is about to see me July about
15th If I still have the same holdings.

Well I have.

Mr E. I want to sell soon, as I'm offered
a good job. In U.S.A. to teach the young Blacks
Smith. Some of my tricks on shoeing race
horses.

I specialize in stopping horses from forging.

That means over-reaching. And all said horses
do that. They are off Balance. & when corrected

they are the fastest Horses. & lead all other
Horses.

2 18924. I was running a B.S. Shop at
Carstairs Alta. 45 Miles North on C.P. Line
said Horse came to me by train. I spend
I corrected that pretty horse & He

broke his own record. I came first. (C)
So you see I. C. D.

A Mr Earl Nixon was owner of said horse & a
big money man. He paid me \$6,000 and
two qts of Scotch whiskey.

Now I'm an old man started my trade near Toronto
1902. when I was 16 years old. I now have reached
79 last April.

And I'm not braking I still take on all the
loggers coming to see me to twist wrist.
I weigh over 200 lbs & over 6 ft tall. I now
weigh only 176 & I feel better than when 190^{lbs}

31 I have much to be thankful for. I can still
do \$20,00 worth of work in one day but I
do get tired now. I should obey the law,
I want to sell my claim. The #2. I
did have 4 claims. If I had 20^{claims}
the No 2 has high grade ore & lots
of it, the deeper you go the better the ore.
I has more ore than the other 3 claims all told
I have spend over \$5000. I was offered
\$1,500, but not enough down. So I did
sell.

I also have a mine lying at Mission City. If I
were not got some ore & much interested ^{He} had it

Civilized & a very good assay, He says you have
gold & silver & lots of copper. I said Peter you
be the cause of me selling soon, then you get 1,000.
& what do you ask, I said I should have ^{20,000} ~~2,000~~
(over)

not over, This Instead.

If you could maybe get me more
than 20,000.

Then you receive half of whatever
it may be. Say ^{it} we were lucky & offered
30,000. then you & I half up
on that extra 10,000 & it could
easy happen Mr. V. D. D.

I hope you can get ahead of said Toronto
mining man.

My Mission ^{man} to meet me today, & bring home
more ore. I'll Enclose a small

sample for you. I mean to help you
also. I have a rich creek to go after it has
shown ^{me} & Purks paid over 60,000 a
Indian ^{for one piece} died & owed me some money
& told me all about said creek. & No one else in B.C.
knows. I have walked over 1000 miles in last
10 years over high mountains. My Second Home is Mountain
Truly Yours Tom Sherman (Climber)

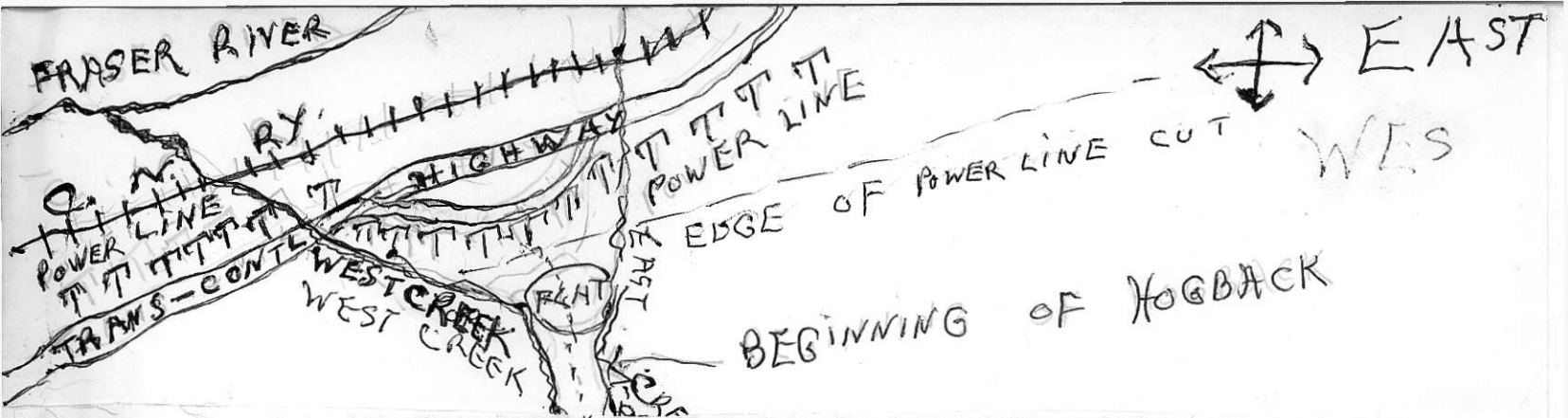

To get to the place between East and West "Hour Glass Creeks" from the west on TransCanada Highway, you go from Chilliwack and it is around two miles east of Bridal Falls. You turn off where the power line crosses over the Highway.

My records show that The Blacksmith went to U.S. taking over a position as "Smithing Instructor" to young blacksmiths, during the summer of 1964. Never had chance to meet him personally. Another party had visited his deposit during 1962; and gave me rough idea of the location. He never returned to his claims. I got good assays of Ag, Au, Cu and Fe from the samples he sent me. It took me most of summer of 1970 to find his deposit when I got a chance to look. I found it finally Sept 24th 1970. The ore is magnetized; and, walking along the talus and down the hill where he has worked, one could determine by the magnetometer readings, something of the strength and depth. You can easily look it over in one day's trip out. I calculate now that The Blacksmith, before he left for his summer in the U.S. as smithing instructor, went up with his son and burned out all the gold and silver that he had excavated. Anyone looking at what remains there, will look at it and calculate there's nothing there. They do not know the history of it; and that contact zone should be examined. According to the records of June 17th 1957, The Blacksmith staked one claim for himself; and one in the name of his son in June of 1957. You will note that in his letter of 1964, he had eight claims staked on the hill. He probably staked the other claims to keep anyone else from being in his way. When you get up to that seven acre flat which is less than a half mile up from the edge of the power line cut, you will find that where the hogback starts just above, the trees and bush have been washed out; so that if it is too steep to climb there, you can go around to the east side and climb up to the hogback, as there are trees there to hang on to. Once you get on the hogback you will find a well worn trail on up. Just keep on up the hogback all the way back; and when you get back to that flat where there are lots of trees and some trails crossing, just keep on up south and a little to the east. You will find his main deposit where he had built up a huge fire with logs; where he burned out all the gold and silver he had around before leaving. It's a one day's trip out and back; but an early start helps out if just one day is taken on the examination., or there is a motel two miles west of it on the highway.

There is his main deposit about 1700 feet elevation. There were many logs unburned; but the blacksmith had burned up a good many logs before he left.

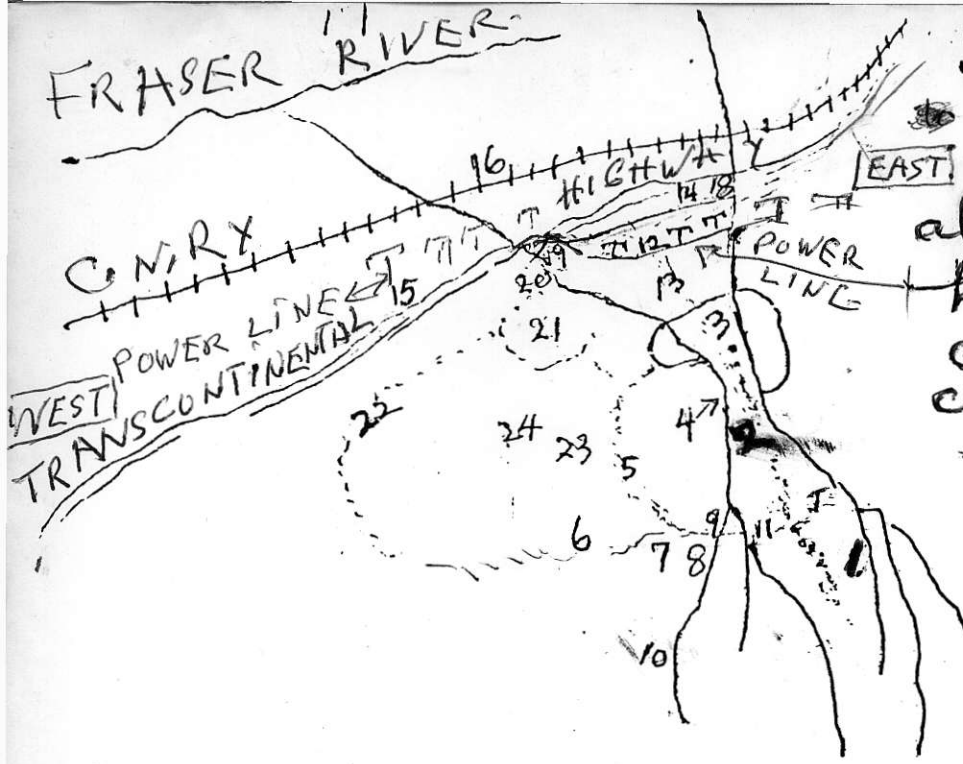

never had chance to complete below. About 30 yds above where hogback starts, close to where two creeks almost meet, it is very steep. Limestone cliff can be seen below. Require a rope ladder to get down to examine creek bed. It is on same strike and dip as blacksmith's main deposit above.

Scale 1 inch = 1 mile.
 Copy
 May Copy

LEGEND.

1. LIMESTONE BLUFF OFF HOGBACK. BLACKSMITH'S MAIN DEPOSIT. (this part water.)
2. HOGBACK. 3. SEVEN ACRE FLAT LOCATION.
4. POINT OF CLOSEST PROXIMITY OF TWO CREEKS, ON THE HOGBACK.
5. OLD LOGGING ROAD WHICH LEADS TO LIMESTONE BLUFF; (BUT YOU WILL GO STRAIGHT UP HOGBACK.) LIMESTONE-GRANITE CONTACT DEPOSIT WILL BE STRAIGHT STRAIGHT SOUTH, SLIGHTLY TO THE LEFT WHEN YOU GET HIGHER.
6. ROAD LEADING AWAY TO WEST. 7. SLIDE ON OLD LOGGING ROAD; WOULD NOW PROBABLY BE MORE DIFFICULT TO USE. 8. SLIDE WHERE ROAD TURNS EAST. MOST OF THESE ROADS NOW OUT OF REPAIR. 9. CROSSING ABOVE CREEK TO GET ACROSS TO NO 1 LIMESTONE-GRANITE CONTACT BLUFF.
10. APPROXIMATE POSITION OF SOME LIMESTONE CAVES AS SEEN FROM BELOW AT FIRST CREEK CROSSED, WHEN TURNING BACK EAST. IS THE LOCATION OF TWO PREVIOUS GOLD CLAIMS. NEVER HAD TIME TO GO UP TO EXAMINE.
11. BLOCKS OF GRANODIORITE NOW ALMOST BLOCKING ROAD. 12. APPROXIMATE POSITION OF POWER LINE CUT. 13. OLD LOGGING ROAD LEADING UP TO SEVEN ACRE FLAT. (1/2 to 1/4 OF ONE MILE UP TO THIS, FROM EDGE OF POWERLINE CUT.)
14. PRESENT DAY LOGGING ROAD IN USE. 15. TRANSCANADA HIGHWAY. 16. CANADIAN NATIONAL RAILWAY. 17. FRASER RIVER. 18. EAST CAMPSITE. 19. ROAD LEADING OFF TO BRIDGE WHICH CROSSES WEST CREEK.
20. WEST CAMPSITE, ALONGSIDE ONE OLD LOGGING ROAD. 21. CALCITE AND QUARTZ VEINS A FEW YARDS UP FROM CAMPSITE, ALONGSIDE ONE OLD LOGGING ROAD.
22. COURSE OF A FURTHER OLD LOGGING ROAD.
23. PLACE ALONG SLOPE WHERE MARBLE WAS PICKED UP. PLENTY OF IT THERE... A LAPIDARY PRONOUNCED IT AS A VERY GOOD GRADE OF MARBLE FOR POLISHING.
24. APPROXIMATE POSITION OF THE STREWN BLOCKS OF BROKEN OFF HORNBLENDE.

Before I only had a description of where the blacksmith's deposit was located, from an associate who had only been there one day in June some years before. This associate is a good bushman, but he was out on his location, and consequently was 3/4 of a mile too far east. "East of the Glass Creek" is a massive quartzite hill close to some gold claims.

1404 AND 1406, 13/6-53

804
18632
ST. ANTO
NIUS

FRASER

11960	L	LUCKY	STRIKE
11952	K	LUCKY	STRIKE
11953	K	LUCKY	STRIKE
11954	K	SUN-SET	1
11955	K	SUN-SET	2
11956	K	SUN-SET	3
11957	K	SUN-SET	H
11958	K	SUN-SET	S
11634	E	SUNSET	P.S.M.
11959	Z	LUCKY	STRIKE
11960	E	SUN-SET	
24427	M	MARY	M
24428	M	MARY	M
24429	M	MARY	M
24430	M	MARY	M
24431	M	MARY	M
24432	M	MARY	M
24433	M	MARY	M
24434	M	MARY	M
24435	M	MARY	M
24436	M	MARY	M
24437	M	MARY	M
24438	M	MARY	M
24439	M	MARY	M
24440	M	MARY	M
24441	M	MARY	M
24442	M	MARY	M
24443	M	MARY	M
24444	M	MARY	M
24445	M	MARY	M
24446	M	MARY	M
24447	M	MARY	M
24448	M	MARY	M
24449	M	MARY	M
24450	M	MARY	M
24451	M	MARY	M
24452	M	MARY	M
24453	M	MARY	M
24454	M	MARY	M
24455	M	MARY	M
24456	M	MARY	M
24457	M	MARY	M
24458	M	MARY	M
24459	M	MARY	M
24460	M	MARY	M
24461	M	MARY	M
24462	M	MARY	M
24463	M	MARY	M
24464	M	MARY	M
24465	M	MARY	M
24466	M	MARY	M
24467	M	MARY	M
24468	M	MARY	M
24469	M	MARY	M
24470	M	MARY	M
24471	M	MARY	M
24472	M	MARY	M
24473	M	MARY	M
24474	M	MARY	M
24475	M	MARY	M
24476	M	MARY	M
24477	M	MARY	M
24478	M	MARY	M
24479	M	MARY	M
24480	M	MARY	M
24481	M	MARY	M
24482	M	MARY	M
24483	M	MARY	M
24484	M	MARY	M
24485	M	MARY	M
24486	M	MARY	M
24487	M	MARY	M
24488	M	MARY	M
24489	M	MARY	M
24490	M	MARY	M
24491	M	MARY	M
24492	M	MARY	M
24493	M	MARY	M
24494	M	MARY	M
24495	M	MARY	M
24496	M	MARY	M
24497	M	MARY	M
24498	M	MARY	M
24499	M	MARY	M
24500	M	MARY	M

R. 2

I.R.1

I.R.1

NATIONAL

Popkum

Cheam L.

13226	C	MAY	DAY
13227	C	MAY	DAY
13228	C	MAY	DAY
13229	C	MAY	DAY
13230	C	MAY	DAY
13231	C	MAY	DAY
13232	C	MAY	DAY
13233	C	MAY	DAY
13234	C	MAY	DAY
13235	C	MAY	DAY
13236	C	MAY	DAY
13237	C	MAY	DAY
13238	C	MAY	DAY
13239	C	MAY	DAY
13240	C	MAY	DAY
13241	C	MAY	DAY
13242	C	MAY	DAY
13243	C	MAY	DAY
13244	C	MAY	DAY
13245	C	MAY	DAY
13246	C	MAY	DAY
13247	C	MAY	DAY
13248	C	MAY	DAY
13249	C	MAY	DAY
13250	C	MAY	DAY

2026	D	T.C.	2
2027	D	T.C.	2
2028	D	T.C.	2
2029	D	T.C.	2
2030	D	T.C.	2
2031	D	T.C.	2
2032	D	T.C.	2
2033	D	T.C.	2
2034	D	T.C.	2
2035	D	T.C.	2
2036	D	T.C.	2
2037	D	T.C.	2
2038	D	T.C.	2
2039	D	T.C.	2
2040	D	T.C.	2
2041	D	T.C.	2
2042	D	T.C.	2
2043	D	T.C.	2
2044	D	T.C.	2
2045	D	T.C.	2
2046	D	T.C.	2
2047	D	T.C.	2
2048	D	T.C.	2
2049	D	T.C.	2
2050	D	T.C.	2

CHEAM PK.

23439	D	LUCKY	LUCKY
23440	D	LUCKY	LUCKY
23441	D	LUCKY	LUCKY
23442	D	LUCKY	LUCKY
23443	D	LUCKY	LUCKY
23444	D	LUCKY	LUCKY
23445	D	LUCKY	LUCKY
23446	D	LUCKY	LUCKY
23447	D	LUCKY	LUCKY
23448	D	LUCKY	LUCKY
23449	D	LUCKY	LUCKY
23450	D	LUCKY	LUCKY
23451	D	LUCKY	LUCKY
23452	D	LUCKY	LUCKY
23453	D	LUCKY	LUCKY
23454	D	LUCKY	LUCKY
23455	D	LUCKY	LUCKY
23456	D	LUCKY	LUCKY
23457	D	LUCKY	LUCKY
23458	D	LUCKY	LUCKY
23459	D	LUCKY	LUCKY
23460	D	LUCKY	LUCKY
23461	D	LUCKY	LUCKY
23462	D	LUCKY	LUCKY
23463	D	LUCKY	LUCKY
23464	D	LUCKY	LUCKY
23465	D	LUCKY	LUCKY
23466	D	LUCKY	LUCKY
23467	D	LUCKY	LUCKY
23468	D	LUCKY	LUCKY
23469	D	LUCKY	LUCKY
23470	D	LUCKY	LUCKY
23471	D	LUCKY	LUCKY
23472	D	LUCKY	LUCKY
23473	D	LUCKY	LUCKY
23474	D	LUCKY	LUCKY
23475	D	LUCKY	LUCKY
23476	D	LUCKY	LUCKY
23477	D	LUCKY	LUCKY
23478	D	LUCKY	LUCKY
23479	D	LUCKY	LUCKY
23480	D	LUCKY	LUCKY
23481	D	LUCKY	LUCKY
23482	D	LUCKY	LUCKY
23483	D	LUCKY	LUCKY
23484	D	LUCKY	LUCKY
23485	D	LUCKY	LUCKY
23486	D	LUCKY	LUCKY
23487	D	LUCKY	LUCKY
23488	D	LUCKY	LUCKY
23489	D	LUCKY	LUCKY
23490	D	LUCKY	LUCKY
23491	D	LUCKY	LUCKY
23492	D	LUCKY	LUCKY
23493	D	LUCKY	LUCKY
23494	D	LUCKY	LUCKY
23495	D	LUCKY	LUCKY
23496	D	LUCKY	LUCKY
23497	D	LUCKY	LUCKY
23498	D	LUCKY	LUCKY
23499	D	LUCKY	LUCKY
23500	D	LUCKY	LUCKY

BRIDAL VEIL FALLS PARK

DY PK.

KNIGHT PK.

STEWART PK.

21516	G	GIBBS	11
21517	E	GIBBS	12
21518	E	GIBBS	13
21519	E	GIBBS	14
21520	E	GIBBS	15
21521	E	GIBBS	16
21522	E	GIBBS	17
21523	E	GIBBS	18
21524	E	GIBBS	19
21525	E	GIBBS	20
21526	E	GIBBS	21
21527	E	GIBBS	22
21528	E	GIBBS	23
21529	E	GIBBS	24
21530	E	GIBBS	25
21531	E	GIBBS	26
21532	E	GIBBS	27
21533	E	GIBBS	28
21534	E	GIBBS	29
21535	E	GIBBS	30
21536	E	GIBBS	31
21537	E	GIBBS	32
21538	E	GIBBS	33
21539	E	GIBBS	34
21540	E	GIBBS	35
21541	E	GIBBS	36
21542	E	GIBBS	37
21543	E	GIBBS	38
21544	E	GIBBS	39
21545	E	GIBBS	40
21546	E	GIBBS	41
21547	E	GIBBS	42
21548	E	GIBBS	43
21549	E	GIBBS	44
21550	E	GIBBS	45
21551	E	GIBBS	46
21552	E	GIBBS	47
21553	E	GIBBS	48
21554	E	GIBBS	49
21555	E	GIBBS	50
21556	E	GIBBS	51
21557	E	GIBBS	52
21558	E	GIBBS	53
21559	E	GIBBS	54
21560	E	GIBBS	55
21561	E	GIBBS	56
21562	E	GIBBS	57
21563	E	GIBBS	58
21564	E	GIBBS	59
21565	E	GIBBS	60
21566	E	GIBBS	61
21567	E	GIBBS	62
21568	E	GIBBS	63
21569	E	GIBBS	64
21570	E	GIBBS	65
21571	E	GIBBS	66
21572	E	GIBBS	67
21573	E	GIBBS	68
21574	E	GIBBS	69
21575	E	GIBBS	70
21576	E	GIBBS	71
21577	E	GIBBS	72
21578	E	GIBBS	73
21579	E	GIBBS	74
21580	E	GIBBS	75
21581	E	GIBBS	76
21582	E	GIBBS	77
21583	E	GIBBS	78
21584	E	GIBBS	79
21585	E	GIBBS	80
21586	E	GIBBS	81
21587	E	GIBBS	82
21588	E	GIBBS	83
21589	E	GIBBS	84
21590	E	GIBBS	85
21591	E	GIBBS	86
21592	E	GIBBS	87
21593	E	GIBBS	88
21594	E	GIBBS	89
21595	E	GIBBS	90
21596	E	GIBBS	91
21597	E	GIBBS	92
21598	E	GIBBS	93
21599	E	GIBBS	94
21600	E	GIBBS	95

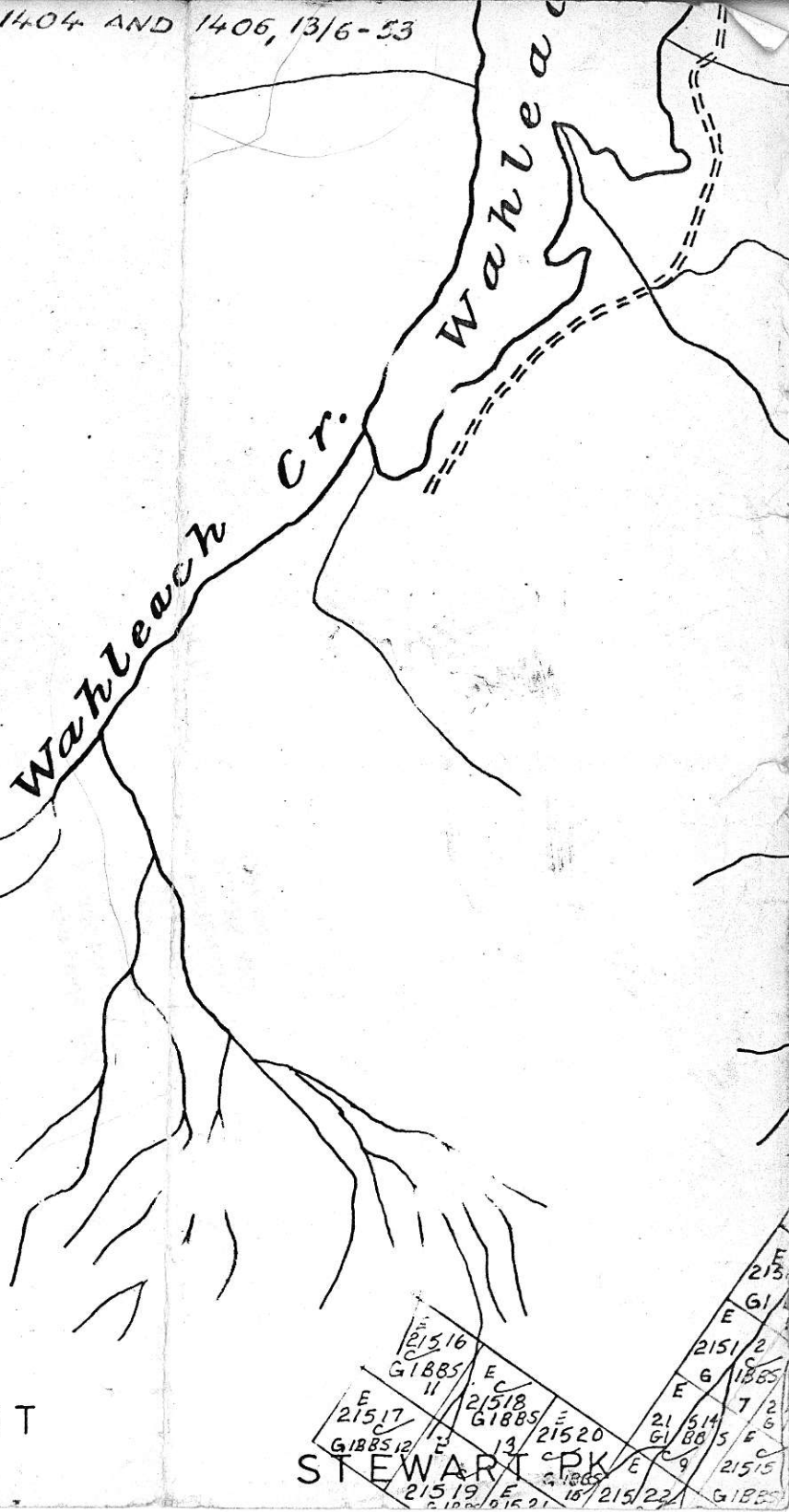

Taken June 11/71.

This map is prepared to serve as a guide only.
Positions of unsurveyed claims and placer leases
are plotted from locators' sketches
and are not guaranteed.
Letters C.G. indicate claim is Crown-Granted.
Symbol "C" indicates claim has forfeited.
B. C. DEPARTMENT OF MINES AND
PETROLEUM RESOURCES

Agreement between W.E. Harvey of 3450 West 35th Ave. Vancouver B C of The
First Part ;and.....

.....,of The Second Part

That The Party of The First Part will reveal to The Party of The Second Part
the location of a mineral deposit situated on Mount Cheam in British Columbia.

In consideration of which ^{stake} The Party of The Second Part decides to ~~stake~~ ^{stake} a group
of claims and develop the property, The Party of The ~~First Part to Receive~~ ^{Second Part}

*will stake one claim in the name
of W. E. HARVEY Free Miners' license
number 176000 issued June 13th 1979
of good standing Dec 31st 1983. The one
claim stated to be contingent
to the group of claims stated*

Party of First Part
Party of Second Part

W. E. Gorney
.....
W. E. Gorney
.....

(W.E.H)