

## I. M. WATSON &amp; ASSOCIATES LTD.

410 - 675 West Hastings Street  
Vancouver, B. C. V6B 1N2  
Telephone: (604) 669-6737

November 5, 1982.

Mr. J. White,  
Exploration Manager,  
Labrador Mining &  
Exploration Co. Ltd.,  
601 Commerce Court East,  
Toronto, Ontario,  
M5L 1E8.

Dear Joe,

1. Enclosed a sketch plan of the Slide 12 and 13 claims staked 2nd Nov. 1982. The claims were recorded 4th November and ownership transfer form has been signed. I will forward copies of all the documents shortly.

Cost of the exercise is approximately \$1650.00. The crew flew to Quesnel on the 1st, staked and returned to Vancouver on the evening of the 2nd.

There was no indication of staking by the dentist, nor had any staking been recorded up to our own staking.

2. Enclosed copies of George Cross issues covering the Tillicum area, to date.

3. B.P. computer print-out will cost us a good bottle of Scotch, a university student's wages for about 4+ days (~\$300.00) and the cost of printing paper and about 14 floppy discs. For that we hope to get vellum print-outs at 1:10,000 scale for approximately 12 of the I.C.P.

*J.McD*  
*Nok* *Item 1* *file*  
*[Signature]*

elements, showing anomaly distribution, statistically derived. Thereafter at next to no cost we will be able to process the data at any scale and in any statistical combination we desire, should there be desire or necessity.

The B.P. programme is the only one I know of using the I.C.P data, apparently others have tried with little success.

Hope this meets with your approval.

Regards,

I.M. WATSON & ASSOCIATES LTD.

*hws* →

I.M. Watson, P.Eng.

IMW/bjs



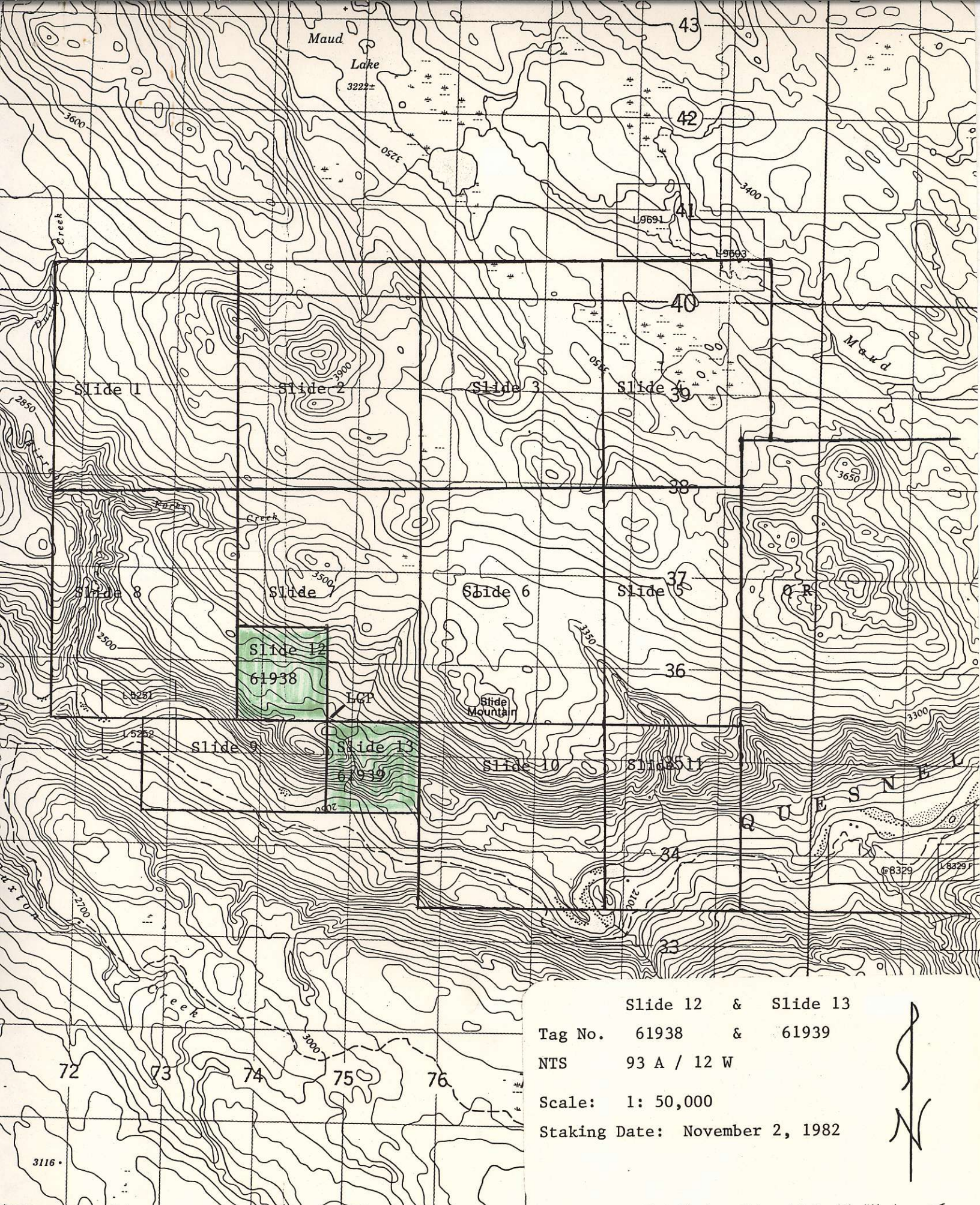

Slide 12 & Slide 13  
 Tag No. 61938 & 61939  
 NTS 93 A / 12 W  
 Scale: 1: 50,000  
 Staking Date: November 2, 1982

