

Gary Belik

June 18/93

- South of Mt Dent
- alteration, silica box, veins float stock work, thin SB.
- On Clisbako and to the south.

* New area SW Clisbako ^{new system}
 New logging (skullow ob) 25 samples

- New staking south of Rio by others
- Bid target

ALL FROM Williams L. side so far

Lewis Lake. silica As ~~to~~.

Next Posita Lake area.

Then Clisbako

Then

45 sample

KVL-
ATN-
GBL.

July 2/93

G. Belik

- 1st batch 200 ppb. best

- 5 additional days. around
Cliskako North end. some
attention on tail.

- finished in 2 or 3 days.

JUNE 25

Gary Belik - Quesnel

- EAST. Park OR Area

- Large alteration zone in
East part of area.
10 km long.

A. 93B.7.E

UTM 518150E A
581380 N

B

93B 7E

51740 E B
5811600 N

open.

Bill Poths

93B 7W

515000 E

MARK 1-4

58 05900 W

317153

313156

OB GENERALLY NOT BAD.

INTENSE ALT. UOANITE & ATG + Silica

30 samples

Cache Creek
Chert and
argillites

Heading for Eliskako



B.C.U

CLISBAKO
20
11070 (4)
5N x 4W

CLISBAKO 18
11068 (4)
4N x 5W

B.C. 945

MT.
DENT

200613

200611
200612

CLISBAKO 19
11069 (4)
4S x 5W

40

78

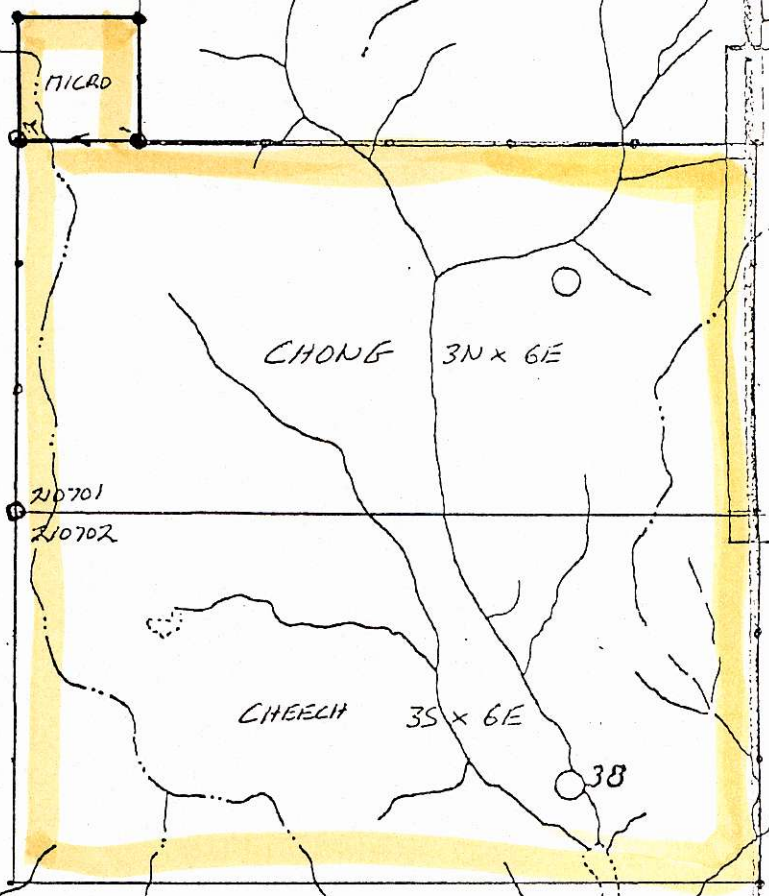

**LOCATOR'S SKETCH STAMP
(SUB) RECORDER'S INFORMATION**

CLAIM NAMES: MICRO

RECORD NUMBERS: 318207

MINING DIVISION: CARIBOON

MAP NUMBER: 93095

MINERAL TITLES BRANCH
DRAFTING INFORMATION

DATE COMPLETED:

INITIALS:

LOCATION SKETCH
MICRO

80