

680511

R E P O R T

O N

THE Q.F. CLAIM GROUP

for

KEWEENAW SYNDICATE

b y

A. F. Reeve

Cordilleran Exploration Corporation Ltd.

Vancouver, B.C.
October 12, 1967

C O N T E N T S

	<u>Page No.</u>
INTRODUCTION	1
ACCESS	1
RESULTS OF WORK TO DATE	1
Geology	1
Geochemistry	2
Property Overlap	3
CONCLUSIONS.	4
PROPOSAL	5
Phase I	5
Phase II	5
ESTIMATED COST OF PROPOSED SPECIAL VENTURE	
Q.F. CLAIM GROUP . . .	6
 <u>APPENDIX</u>	
1. Location map Q.F. Claim Group	1" = 10 mi.
2. Analytical report (check samples).	
3. Preliminary geological and geochemical map, Q.F. Claim Group	1" = 750'

INTRODUCTION

The Q.F. Claim group consists of 35 claims which were acquired on September 2 as a result of geochemical prospecting.

A sketch showing the results of geochemical sampling and prospecting to date is appended. The property overlaps an adjacent claim group in a critical area; however this matter can be resolved at reasonable cost.

ACCESS

A road, passable by 4-wheel drive, extends 2 miles NW to the property from a point on the Hydraulic-Likely road, 4 miles west of Likely.

RESULTS OF WORK TO DATE

Geology

The property is underlain by volcanic rocks of Mesozoic age. They consist of purplish coloured basalts and fine agglomerate carrying crystalline pyroxene. A small monzonite stock outcrops on the SE end of the group.

Geology (cont'd.)

The local alignment of topographical features suggests a fault zone, crossing the property in a NW direction, along which a number of similar intrusives have been emplaced.

Traces of chalcopyrite in syenite occur in a trench at the south end of the property. Fractured volcanic rocks on the northern-most part of the claim group are irregularly mineralized with pyrite and pyrrhotite.

Geochemistry

Approximately 100 soil and stream sediment samples have been taken from the property and analyzed for copper. An area of interest approximately 9,000' long x 2,000' wide is indicated by anomalous results.

Copper values exceed 400 ppm @ 9 sample points

"	"	"	250	"	"	17	"	"
"	"	"	150	"	"	30	"	"
"	"	"	100	"	"	45	"	"

During the season about 1,000 soil and stream sediment samples have been taken in the surrounding region. On the basis of this work a copper background of less than 100 ppm. is reasonable.

Geochemistry (cont'd.)

Many of the anomalous sample points occur on a steep well-drained slope so that the anomalies are not the result of physical precipitation traps.

Analytical results by Bondar Clegg & Company have been checked by Chemex Labs Ltd. (see the appended analytical report).

Property Overlap

After considerable time had been spent on this project it was discovered that the Q.F. group overlaps 10 prior claims in the heart of the anomalous areas. This was not immediately apparent because of very poor staking by the prior locators.

The prior claims are Axe #1, Axe #2 and Maud #1 to #8 inclusive, owned by Mr. Alden Andrews of Quesnel. Mr. Andrews has been approached and is willing to sell his claims outright for \$50 each.

CONCLUSIONS

1. A very strong, extensive copper anomaly underlain by a favourable geological environment on the Q.P. Claim group has been outlined by preliminary geochemical sampling and prospecting.
2. An expenditure of \$500 is required to secure absolute title to the property.
3. Further work is justified to investigate the source of the anomaly.
4. A number of exploration problems can be expected as follows:
 - a) The apparent source of the geochemical anomaly appears to be deeply buried by rubble and slide material on a very steep hillside so that strip-ping and/or drilling would be difficult in this area.
 - b) Some of the local volcanic rocks are pyritic. This may reduce the effectiveness of geophysical prospecting by electrical methods.

PROPOSAL

It is proposed that the Keweenaw group -

- a) Acquire the Naud and Axe claims from the owner.
- b) Undertake the following exploration programme on the Q.F. group as a special venture at a minimum cost of \$19,000.

Phase I

1. Cut a picket line grid.
Base line running N. 50° W. with cross lines at 400' intervals in the anomalous area.
2. Do electromagnetic traverses on the grid system using Rouka EM-16 equipment.
3. Cut two long trenches across the anomalous area on the basis of stream sediment sampling and the geophysical survey.
4. If the source is not revealed directly by trenching, detailed geochemical sampling should be done in the trenches.

Phase II

Additional trenching and/or diamond drilling would be required contingent upon the success of Phase I.

ESTIMATED COST OF PROPOSED SPECIAL VENTURE

O.F. CLAIM GROUP

Phase I

1. Property acquisition	\$	500.00
2. Line cutting 20 miles @ \$110		2,200.00
3. Geophysical survey, 20 line miles @ \$75		1,500.00
4. Trenching, 200 tractor hours (D-8 caterpillar or equal) @ \$30	\$6,000.00	
Mobilization	<u>500.00</u>	6,500.00
5. Camp operation or local accommodation		2,000.00
6. Truck (4x4) rental 2 mo. @ \$350 + mileage		1,000.00
7. Travelling		1,000.00
8. Miscellaneous supplies		500.00
9. Assaying and geochemical analysis		300.00
10. Supervision and management		1,500.00
11. Contingency allowance		2,000.00
		<hr/>
		\$ 19,000.00
		<hr/>

It is suggested that a minimum of \$30,000.00 be allowed for a second phase.

Respectfully submitted

A.F. Reeve,
Cordilleran Exploration Corporation Ltd.

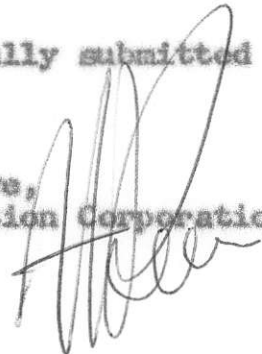

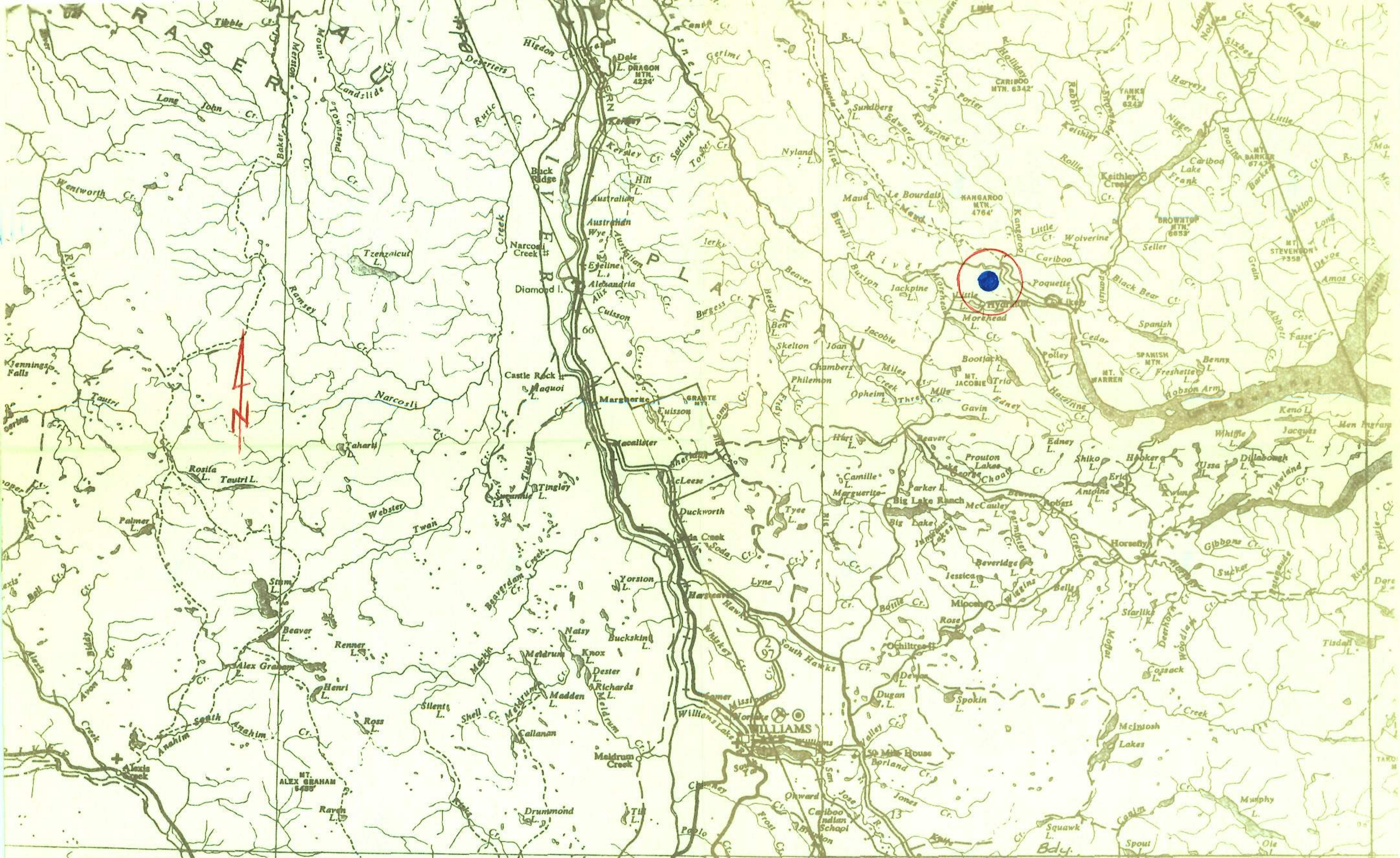

To Williams Lake 123°

To Alexis Creek To Clinton

122° To Clinton 96 miles

121°

Location Map Q.F. group 1" = 10 MI

CORDILLERAN EXPLORATION CORPORATION Ltd.
 400, 837 WEST HASTINGS STREET
 VANCOUVER 1, B. C.

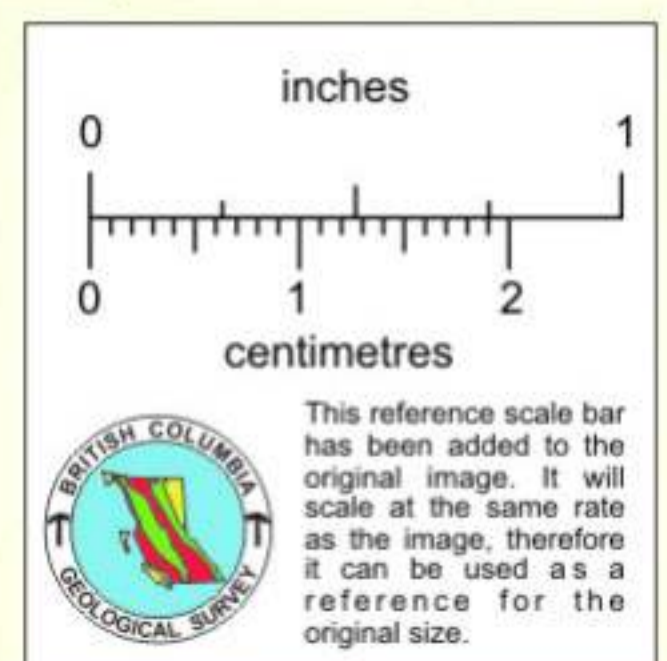

This reference scale bar has been added to the original image. It will scale at the same rate as the image, therefore it can be used as a reference for the original size.

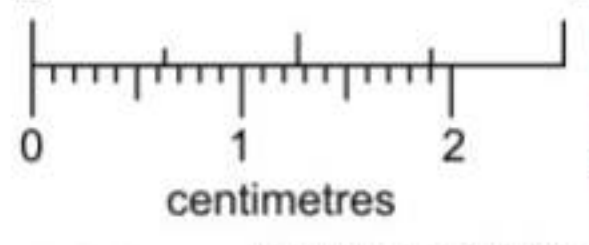
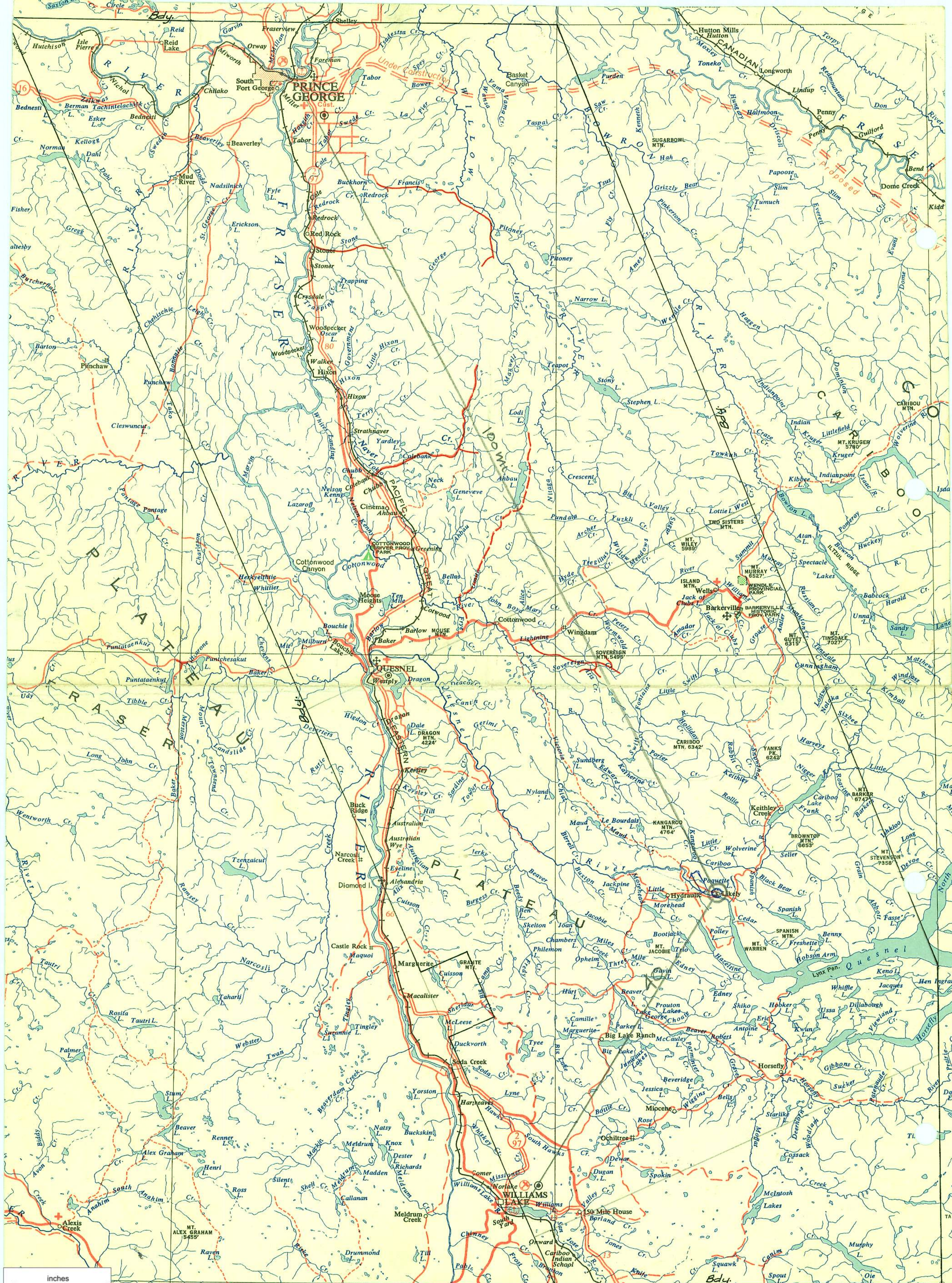

This reference scale bar has been added to the original image. It will scale at the same rate as the image, therefore it can be used as a reference for the original size.

Williams Lake 123°

To Alexis Creek To Clinton

122°

To Clinton 96 miles

121°



Scale 1" = 400'

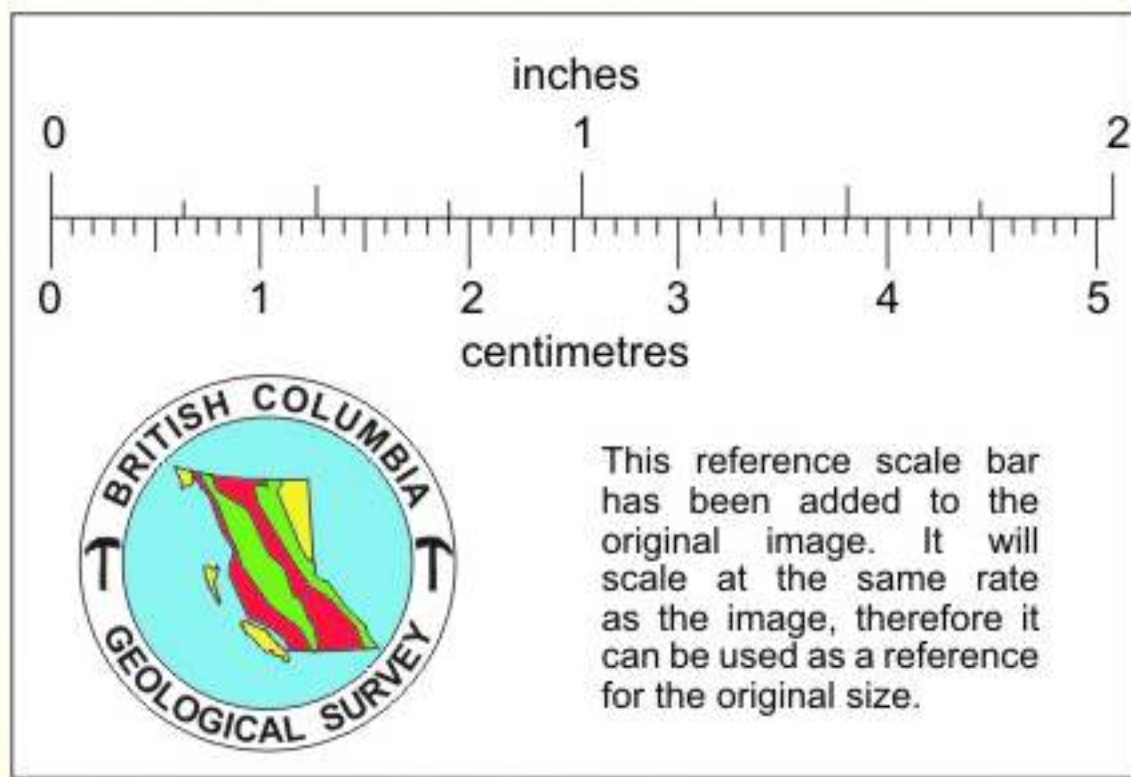

- LEGEND —
- Hb. Diorite
 - Volcanics - green pyroxene andesite; andesitic breccia.
 - Mineralization
 - Fault or shear
 - Geological boundary
 - Jointing

GEOLOGY OF TRENCHING
 G.F. CLAIMS
 LIKELY AREA - CARIBOO MINING DIV.
 KEWENAW SYNDICATE
 HOMESTAKE MINERAL DEVELOPMENT
 304 - 535 THURLOW STREET
 VANCOUVER B.C.
 NOV. 24/67


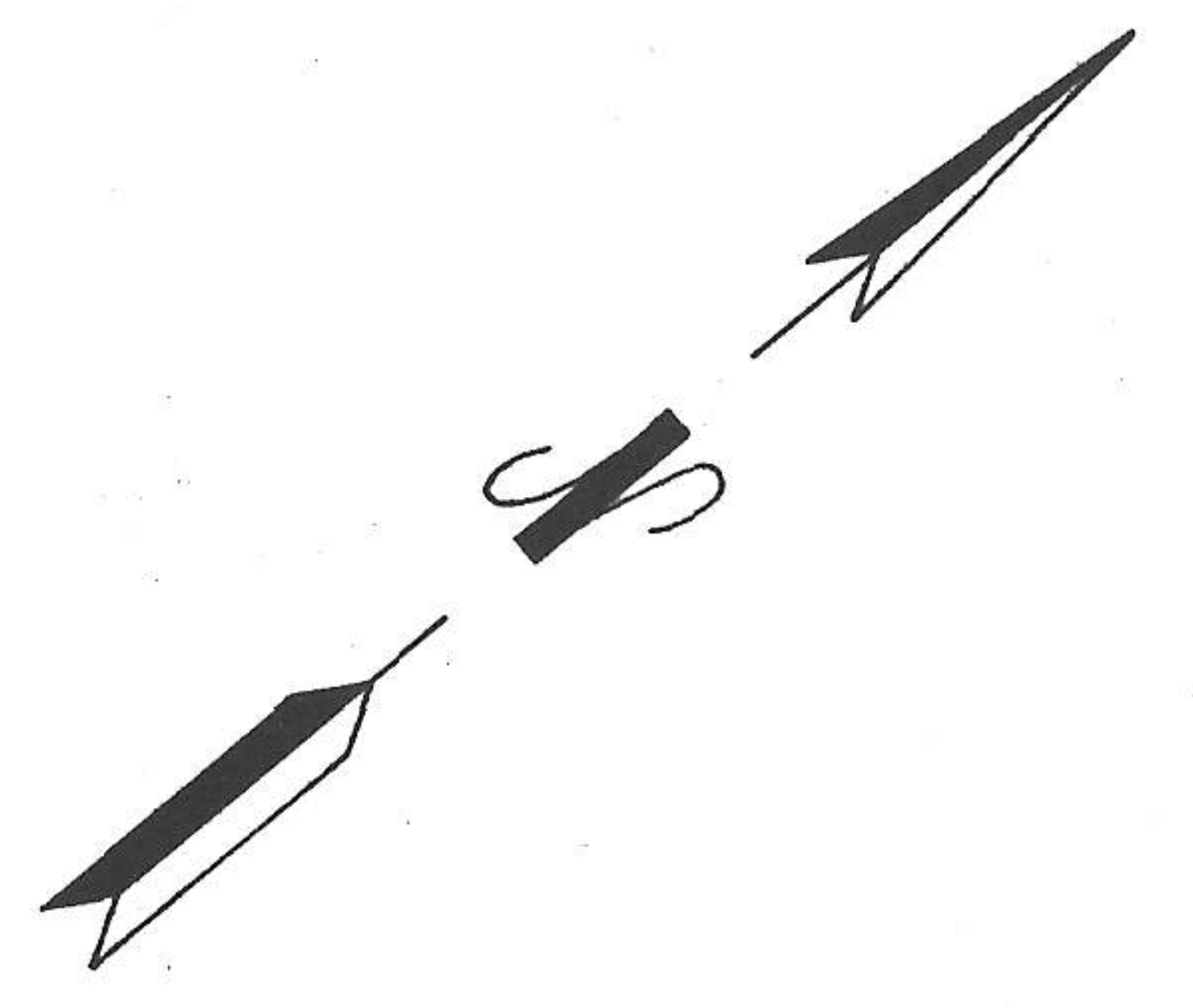

LEGEND

- Cu CONCENTRATION IN p.p.m. (PARTS PER MILLION)**
- 0 TO 149
 - 150 TO 250
 - 251 TO 500
 - 501 p.p.m. OR GREATER
- Mo CONCENTRATION IN p.p.m. (PARTS PER MILLION)**
- △ 0 TO 3
 - △ 4 TO 10
 - △ 11 TO 20
 - △ 21 p.p.m. OR GREATER
- TRENCH
 - ⑤ TRENCH NUMBER
 - ₃₇₅ Cu SAMPLE LOCATION
 - △₂₈ Mo SAMPLE LOCATION
 - - - ROAD
 - CREEK
 - BUILDING
 - ⊠ CLAIM POST

NOTES

SOIL SAMPLES IN TRENCHES TAKEN NEAR BEDROCK SURFACE. (i.e. C HORIZON)

SAMPLING BY L. P. DUQUETTE.

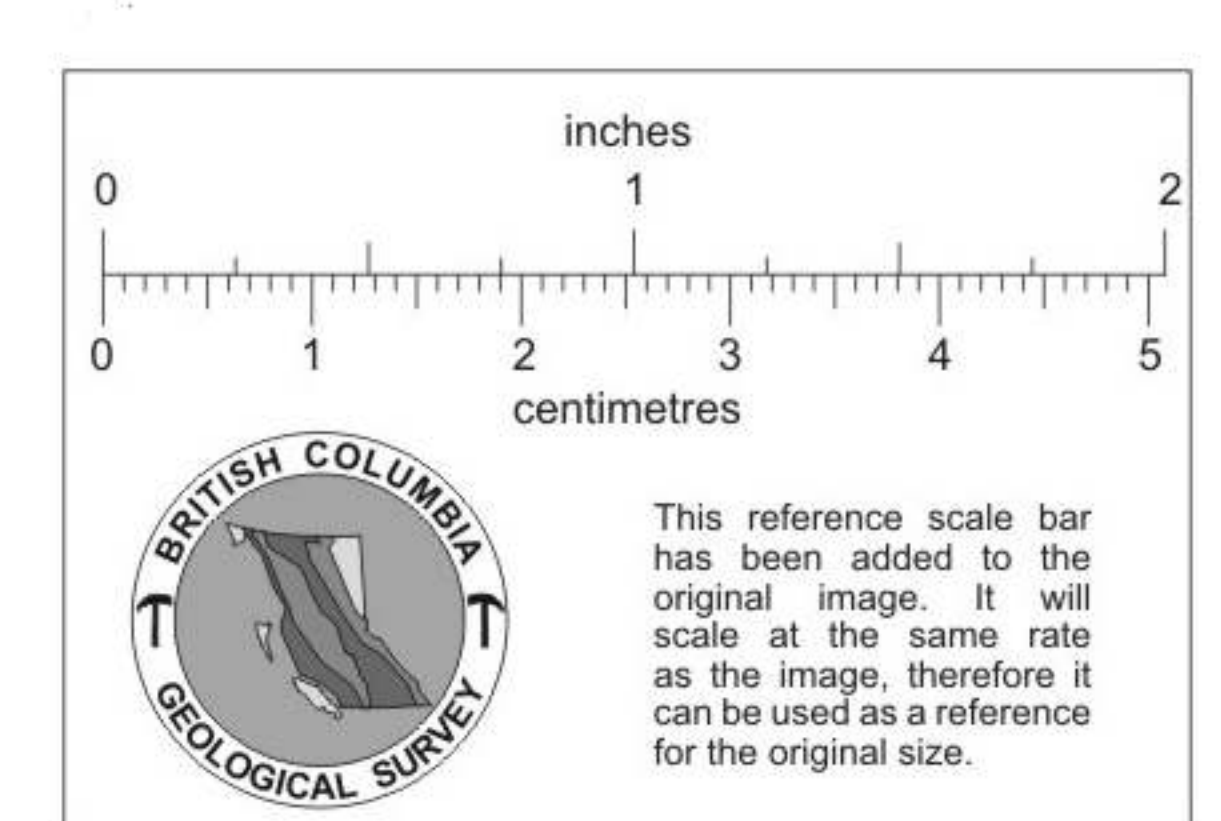

KEWEENAW SYNDICATE
TRENCH PLAN SHOWING
SOIL SAMPLING

Q.F. CLAIM GROUP

CARIBOO MINING DIVISION BRITISH COLUMBIA

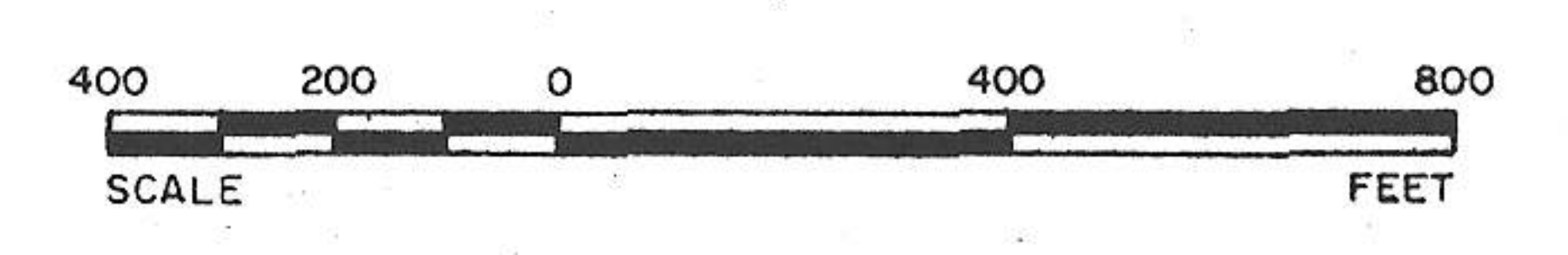

BY
CORDILLERAN ENGINEERING LIMITED
 400-837 W. HASTING ST. VANCOUVER 1, B.C.

NOVEMBER, 1967

CORDILLERA EXPLORATION COY. LTD.
400 WEST HASTINGS
VANCOUVER B.C.

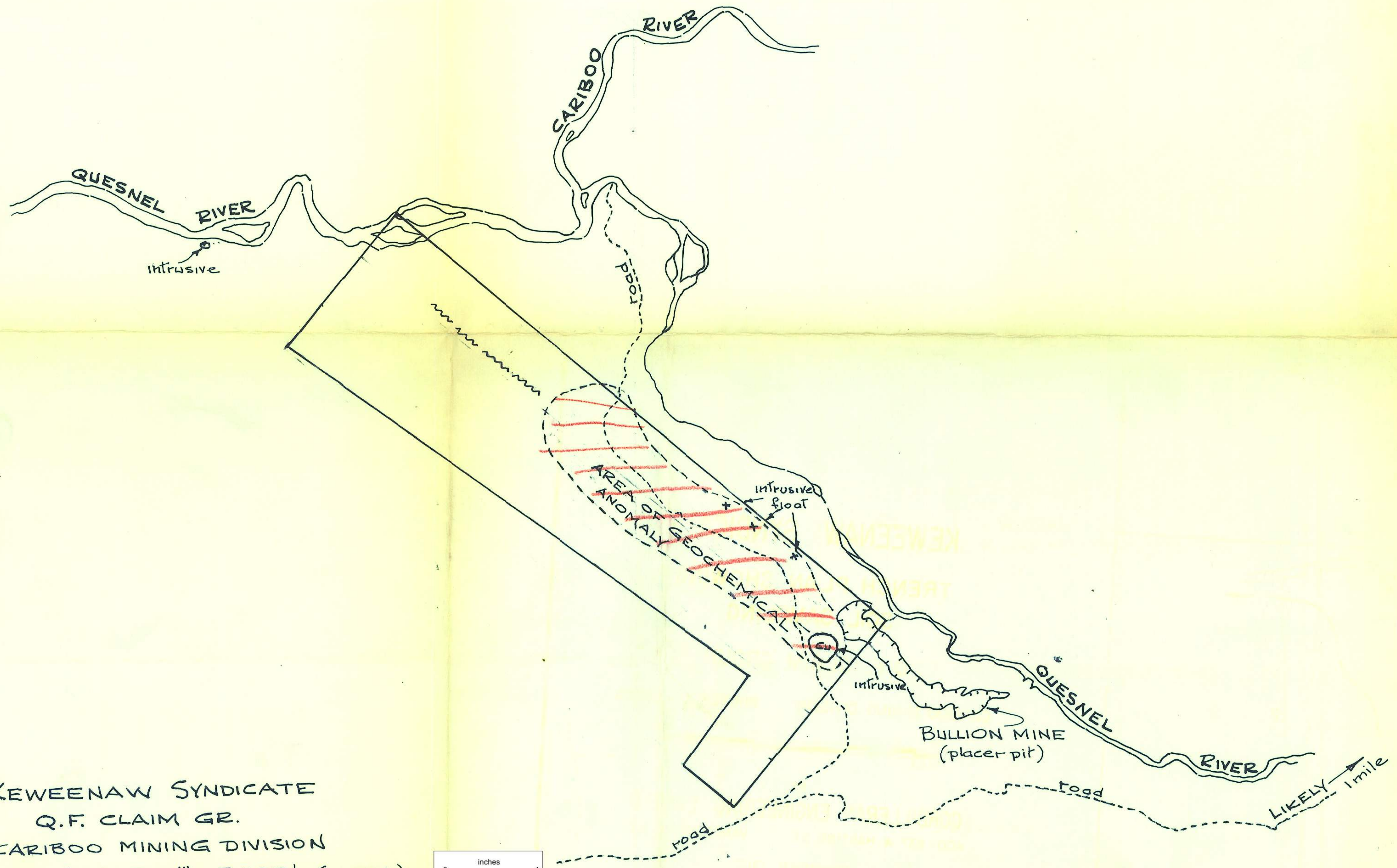

KEWEENAW SYNDICATE
Q.F. CLAIM GR.
CARIBOO MINING DIVISION
SCALE 1" = 3000' (approx)

Sept 10-67 CORDILLERA EXPLORATION CORPORATION LTD.
400 WEST HASTINGS STREET
VANCOUVER B.C.

