

# BONDAR-CLEGG & COMPANY LTD.

1500 PEMBERTON AVE., NORTH VANCOUVER, B.C. PHONE: 985-0681 TELEX: 04-54554

## Geochemical Lab Report

Ag; Hot Aqua Regia

Au; Fire Assay & Hot Aqua Regia

Report No. 29 - 1548

Method Atomic Absorption

From Clifford Gunn

Fraction Used \_\_\_\_\_

Date August 29, 1979

SAMPLE NO.	Ag ppm	Au PPB	Parts Ag	AV	SAMPLE NO.	Ag ppm	Au PPB	Parts Ag	AV
K - 100	1.3	100	/		K - 130	5.7	15	3.2	25
101	6.0	30	/		131	2.6	105	3.9	25
102	1.4	80	/		132	1.4	10	1.9	10
103	4.0	55	/		133	0.3	15	1.1	25
104	0.2	15	/		134	0.3	10	1.3	85
105	2.4	25	/		135	0.3	80	1.5	135
106	7.0	30	/		136	1.6	55	2.8	335
107	2.0	40	/		137	1.0	15	1.4	15
108	0.7	<60*			138	0.4	70	1.2	45
109	5.2	15	/		139	1.2	1085	2.0	65
110	6.0	<15*			140	0.8	1650	1.3	10
111	0.5	90	/						
112	2.6	45	/						
113	6.6	60	/						
114	3.1	90	/						
115	0.8	20	/						
116	4.0	60	/						
117	2.0	<10*							
118	1.0	30	/						
119	6.5	<15*							
120	0.7	5	/						
121	1.6	1170	2.8	175					
122	0.3	<20*	1.1	50					
123	3.3	30	3.2	370					
124	0.8	50	3.2	330					
125	0.8	25	1.1	45					
126	0.3	<5	1.2	15					
127	1.4	15	1.3	40					
128	1.7	40	1.1	160					
129	2.1	25	2.4	45					

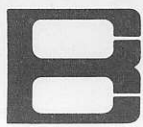

# BONDAR-CLEGG & COMPANY LTD.

1500 PEMBERTON AVE., NORTH VANCOUVER, B.C. PHONE: 985-0681 TELEX: 04-54554

## Geochemical Lab Report

Extraction Ag; Hot Aqua Regia  
Au; Fire Assay & Hot Aqua Regia

Report No. 29 - 2116

Method Atomic Absorption

From Mr. C. Gunn

Fraction Used \_\_\_\_\_

Date October 9 1979

SAMPLE NO.	Ag ppm	Au ppb		SAMPLE NO.	Ag ppm	Au ppb	Pat AA	AV
ER - 1	0.6	40		K141	0.4	305	0.7	45
2	0.5	30		K142	0.7	40	1.6	15
3	0.5	30		K143	0.6	15	1.0	20
4	0.5	60		K144	1.5	< 5	1.7	455
5	0.4	25						
6	0.5	25						
7	0.4	65						
8	0.6	25						
9	0.5	30						
10	0.5	15						
K120 - 1E	3.1	130						
2E	1.7	65						
1W	3.0	20						
2W	0.9	< 5						
K121 - 1E	1.0	70						
2E	0.7	50						
1W	1.4	10			* detection limit on a small sample			
2W	2.3	65						
K122 - 1E	1.3	10						
2E	2.0	70						
1W	5.7	< 5						
2W	2.8	25						
K139 - 1E	1.5	470						
2E	0.9	1135						
3E	1.5	20						
1W	2.4	60						
2W	1.1	55						
K140 - 3E	1.1	<10*						
1W	2.0	5						
2W	0.2	60						

To Mackay River

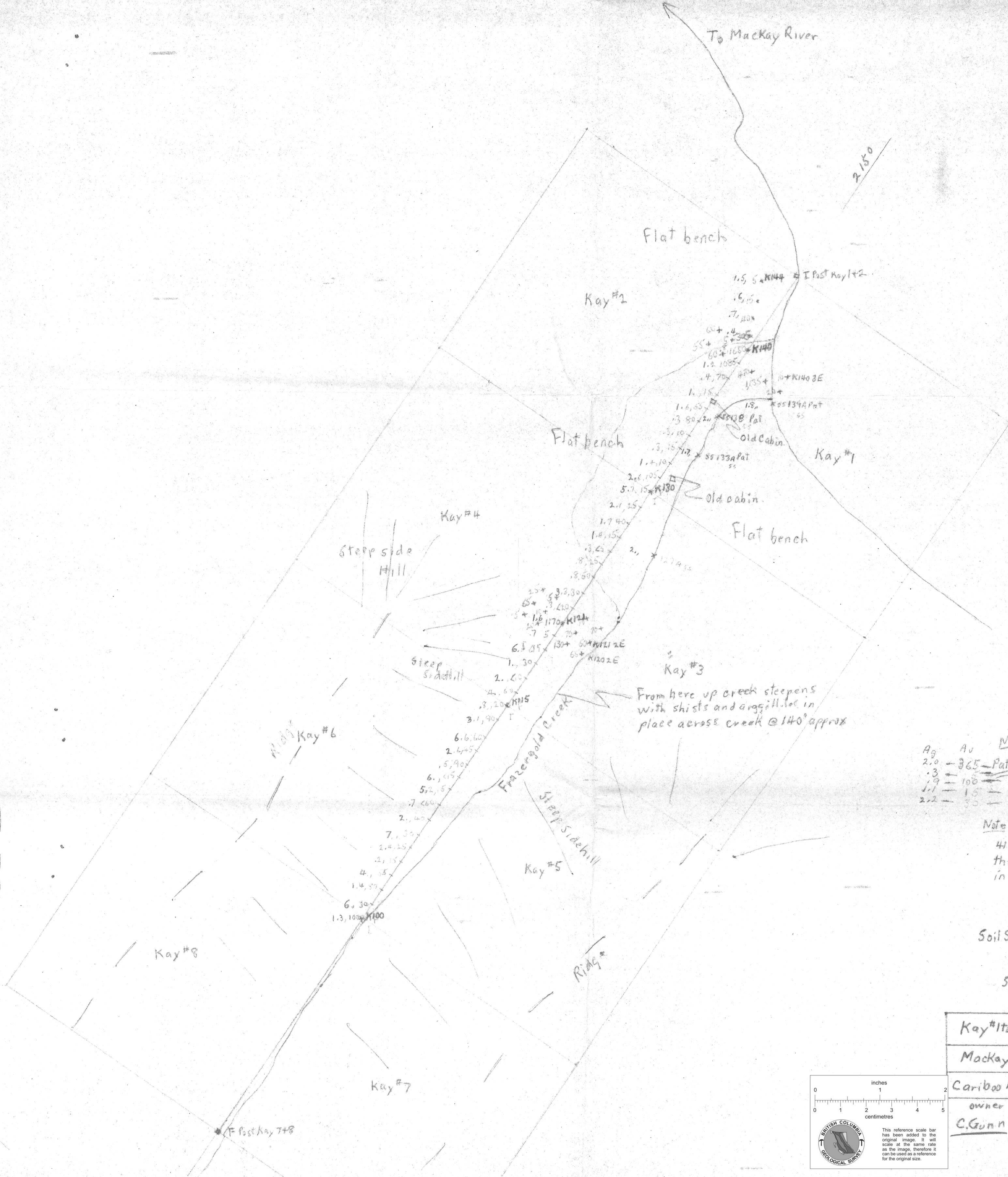
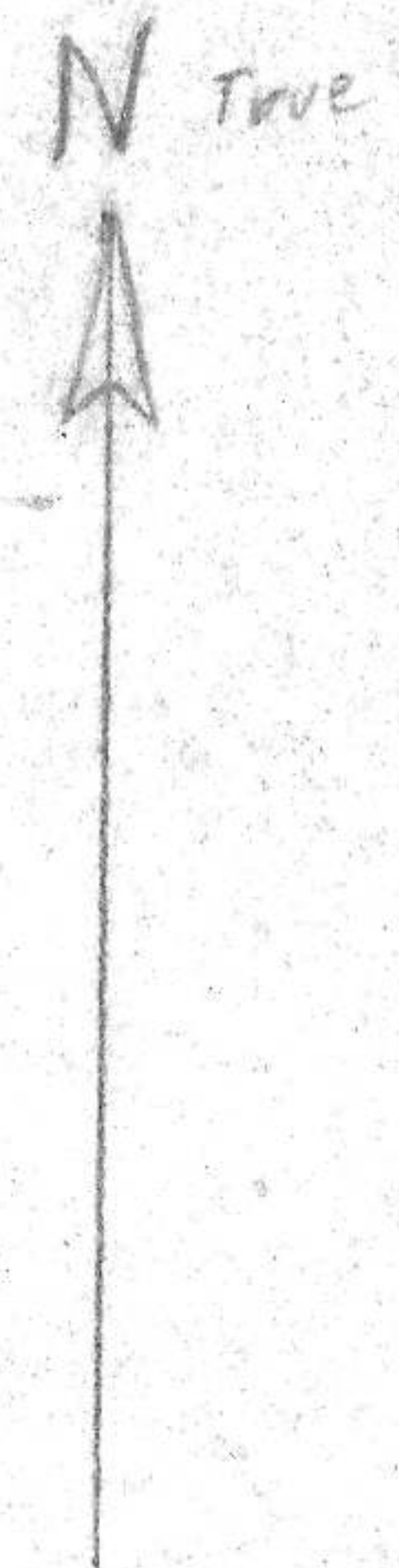

Ag	Au	Note
2.0	365	Pat 139 B - Grouse creek (slide)
.3	100	139 D - Eureka creek
1.1	15	139 E - Imperial creek
2.2	30	139 F - Eureka creek

Note Samples K100 to K140  
41 samples taken with shovel through blue crushed layer in grey soil

Soil Samples Ag, Au.

Scale 10cm = 500m

Kay #1 to 8 (Past) 1182/89	
Mackay Creek Area	
Cariboo M.D. 93A/7	Date Oct 15/79
owner C. Gunn	

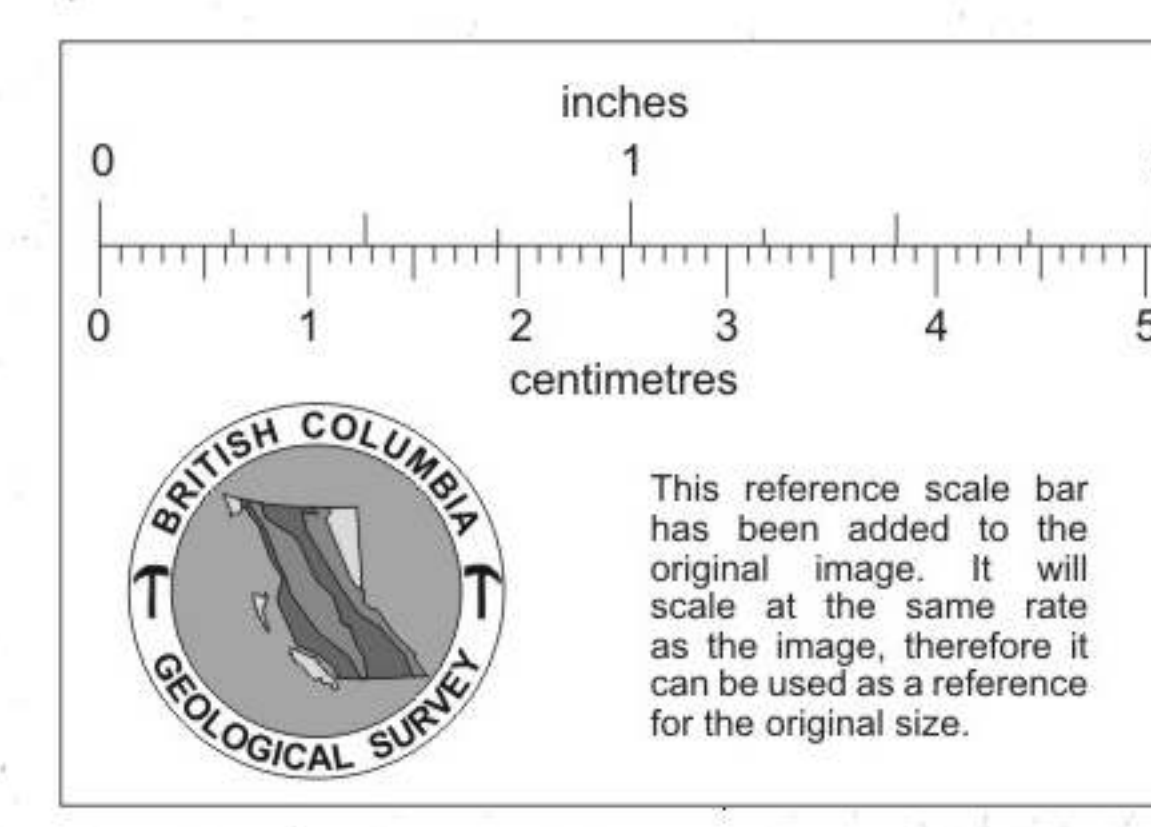

680506



Barrier Reef  
 Report 29-2217  
 G 121 to 144  
 Ag, Au

Ray #106260, 1182/89  
 Mackay Creek Area  
 Caribou Mt 93A/1  
 2000  
 Cairn Oct 15/29  
 Ray #110 8/29

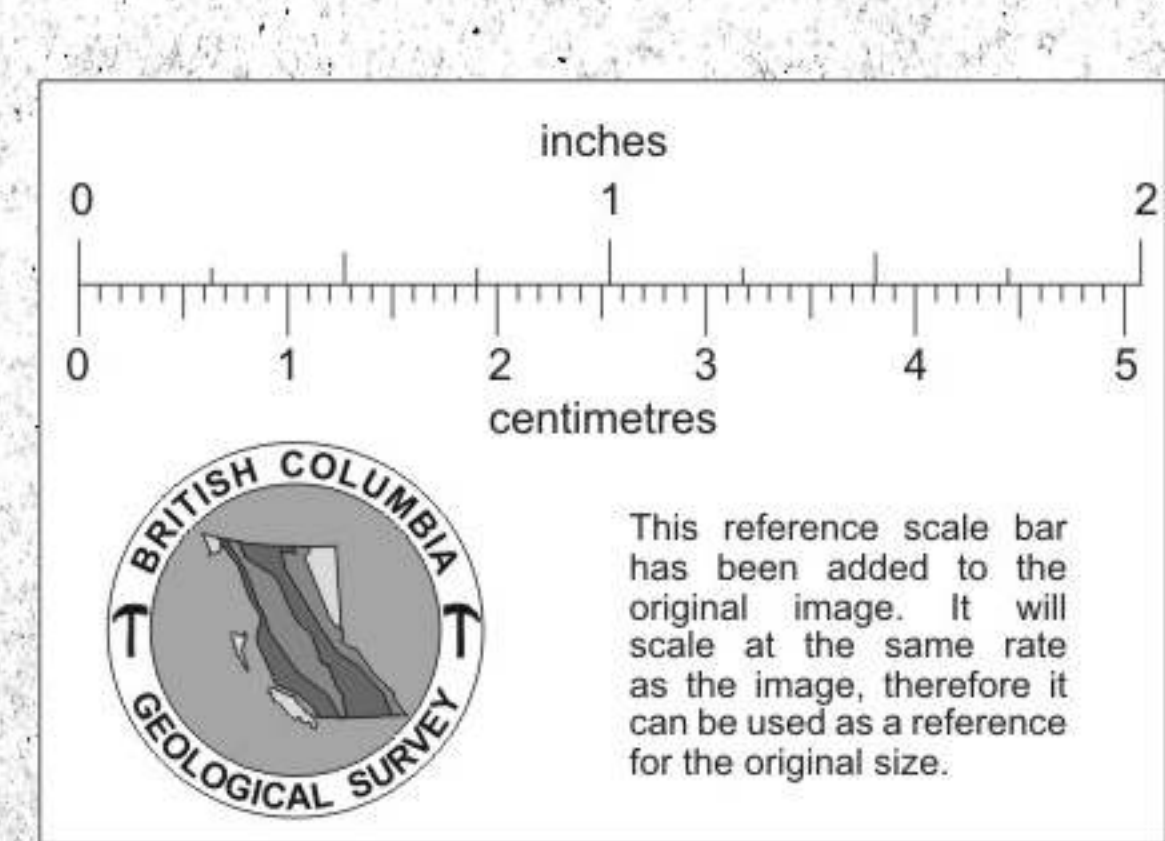

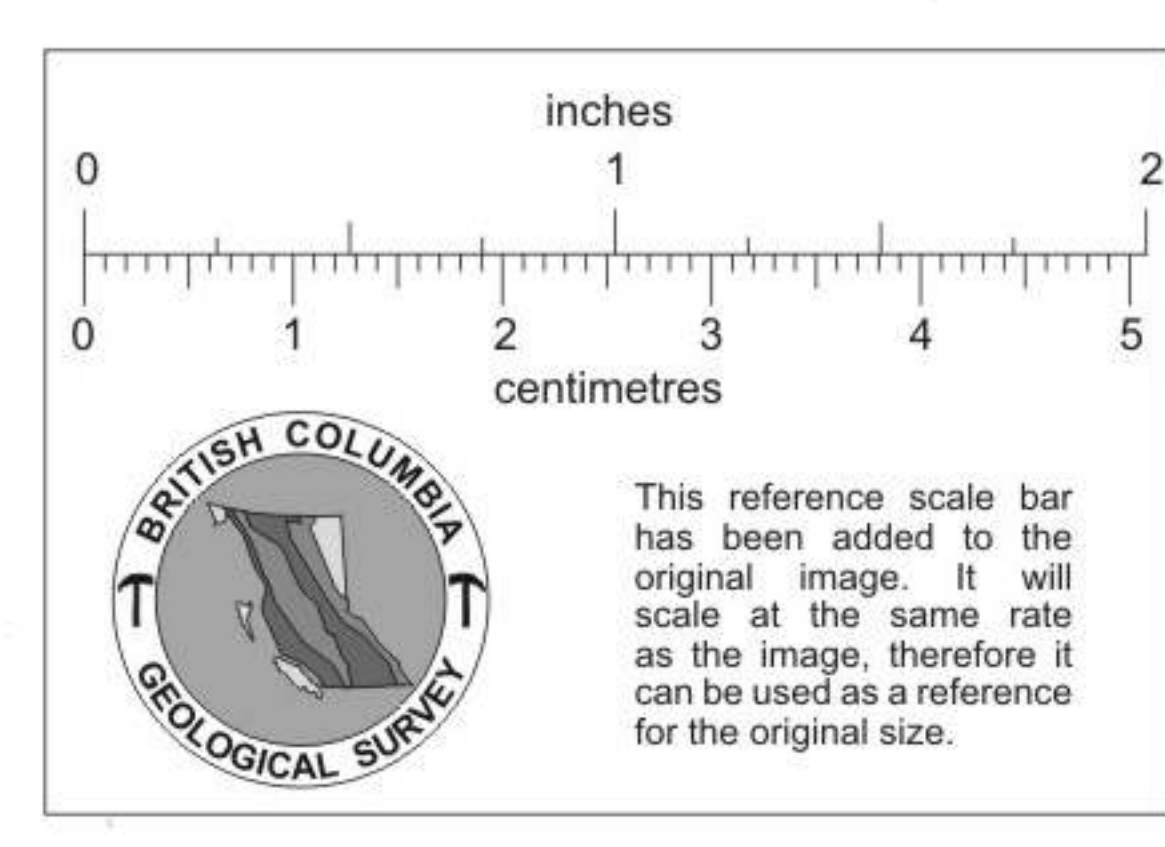

Map # 11686 (and 1182/89)	
Markay Creek Area	
Caribou M.D. 93A/7	
Scale	Date
C. Grant	Oct 15/79

1.3. 100 x 160

1.4 80

4.0 55

0.2 175

2.4 25

7.0 3

2.0 40

5.2 10

6.0 15

0.5 90

2.6

6.6

3.1 90

0.2 175

4.0 60

2.0 10

1.0 30

6.5

3.0 20

5\* 1.4

2.3 65 x 57

0.2 50

0.2 175

1.4 15

1.2 30

2.1 20

5.7 105

2.6 105

1.2 10

0.3 15

0.3 10

0.3 80

1.6 55

1.0 15

0.2 90

1.2 1085

2.4 60 x

1.1 55 x

0.2 60 x

0.7 150

1.5 5 x 114

2 Kay. 142

Old Cabin

x 133A ss G

x 138A ss G

x 139A ss G

x 127A ss G