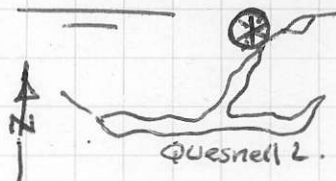

MAR 8/75

Cliff GUNN Williams L.Lead Zinc ProspectLocation - 2 mi N of N. arm of Quessnell  
Lake 93A. 5800 - 6000' ASLProspect: lead & zinc sulphides in  
Cunningham limestoneWork: Can Sup soil samplingGeology, ERA, I.P., drilling 3 holes 1200'  
#65,000 1972.

- Can sup included that strong lead anomalies were due to isomorphous substitution of lead for magnesium in Dolomite.

Can Sup Geol. - massive grey to pink alt  
& Mn  
LS. with bix? or eg? and  
"lumps" of galena.

- stringers of Galena in white dolomite LS.
- Some lt. green splintery

Anomally  
#1 2000' x 1250'  
#2 1000' x 1250'

Canex 1969

EM-16 survey - <sup>min.</sup> not traceable  
soil survey.

AFR. Comment

- Very strong concentrations of  
lead in Cunningham L.S.  
should be worth while checking  
this unit regionally.

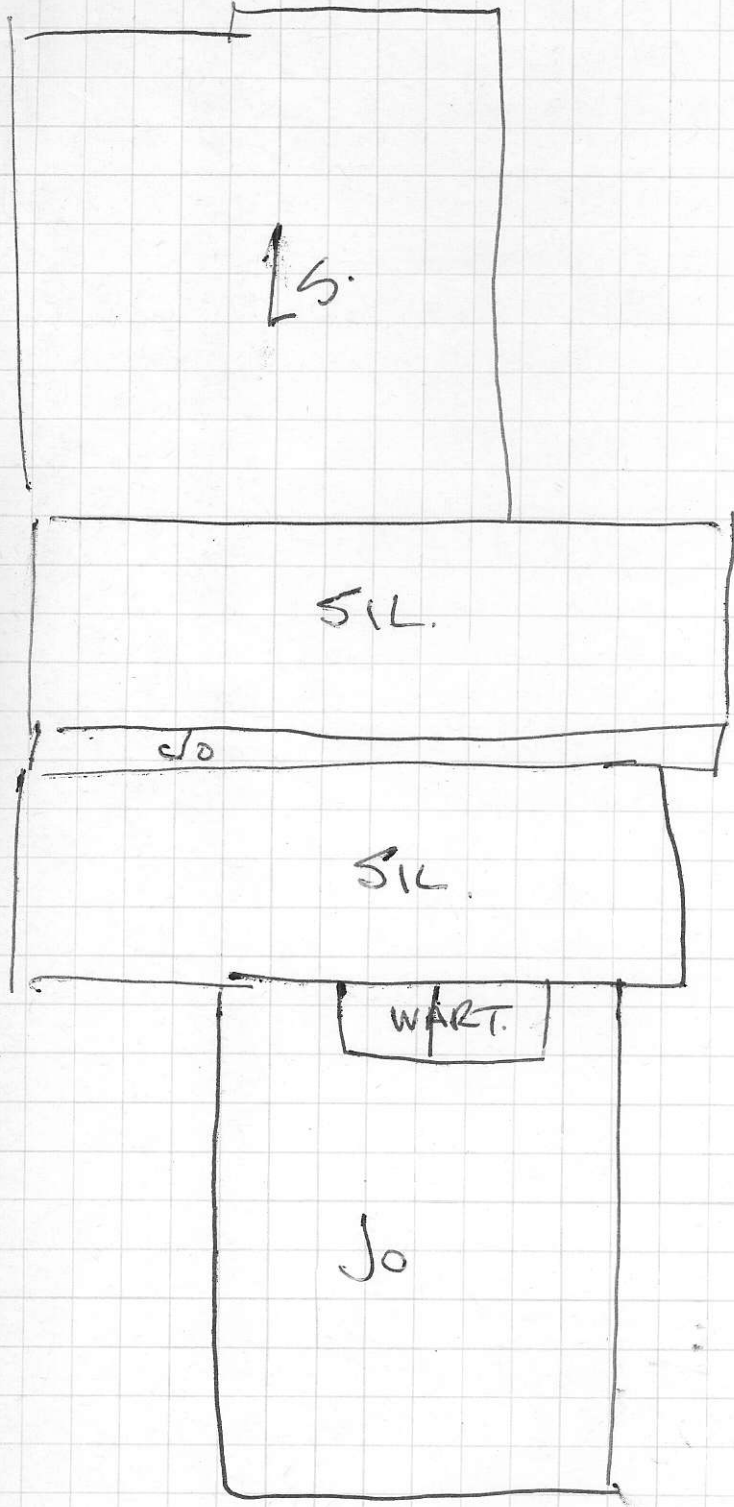

  
 1" = 1/2 mi

