

AFR- copy. —



ALBERT F. REEVE LIMITED

904 - 675 WEST HASTINGS STREET
VANCOUVER, B.C.
V6B 1N2
TELEPHONE: (604) 688-3584
FAX: (604) 688-0378

680205
82K/6E

August 25, 1994

Mr. Jim Bartlett
Odlum Brown Limited
P.O. Box 10012
1800 - 609 Granville Street
Vancouver, BC

Dear Jim:

Enclosed herewith is your file on the Poplar Creek project. I don't think that it is ready for a drilling program, which is the Westley objective.

I have also enclosed a copy of the 82K gold production records. There is a well defined gold district with more than 60 prospects recorded, 14 of which had some production. So far there hasn't been anything that shows size or continuity. The carbonate alteration as well as the occurrence of listwanite in some areas suggests that there are still possibilities of a big one.

Best of luck,

ALBERT F. REEVE LIMITED

Albert F. Reeve

AFR/am

Enclosures

Lucky Jack
1981
DOH .937 / 1.3m

ASSESSMENT REPORT
SOIL GEOCHEMICAL SURVEY
of
North Star, Y.R.U.,
Broken Hill and Coronation
Mineral Claims

50°26'N 117°10'W

Mining Division: Slocan

NTS: 82K/6E

P.J. Wojdak

February 1982

2' x 1/2' gold rich
1929 GUNNING
"Rich Pocket"
on Lucky Jack

- mobby mine 200' L.
Au's. 2.0 / .5 / .25 / .3 1.5 g/mt

North Star "gold rich
stringers"

Calumet & Hecla 25% Au

Gold park & Swede
Asp Au Stock work
325.0pt

Swede Stone 1.50pt
3 piec. 50% Au
\$3000 Au
mill at Carleton Place

Part 1
of 3

MINERAL RESOURCES BRANCH
ASSESSMENT REPORT
10,129

*Western Report
Poplar Creek Project*

*Nov 1980
10, 129, Part 1 of 3*

*Jim BARTLETT
ODLUM BROWN
8445369*

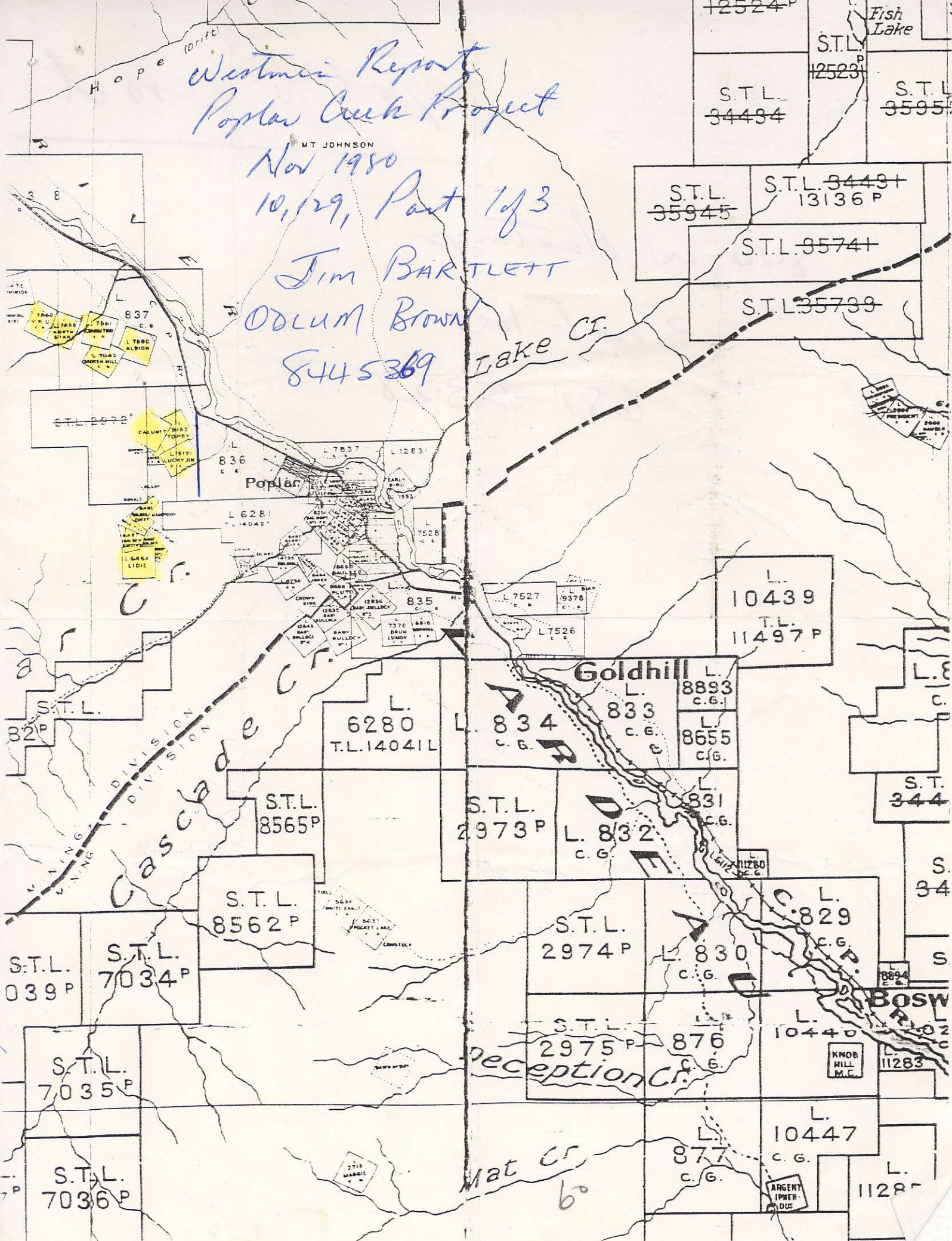

12524 P

S.T.L. 12523 P

Fish Lake

S.T.L. 34434

S.T.L. 3595

S.T.L. 35945

S.T.L. 3443+
13136 P

S.T.L. 9574+

S.T.L. 35739

S.T.L. 2072

836 C.G.

Poplar

L. 7837 L. 12831

L. 6281 T.L. 14042

L. 7528 C.G.

835 C.G.

L. 7527 T.L. 9378 C.G.

L. 7526 C.G.

L. 10439 T.L. 11497 P

Goldhill

L. 8893 C.G.

L. 834 C.G.

L. 833 C.G.

L. 8655 C.G.

S.T.L. 32 P

L. 6280 T.L. 14041 L

S.T.L. 8565 P

S.T.L. 2973 P

L. 832 C.G.

L. 831 C.G.

S.T. 344

S.T.L. 8562 P

S.T.L. 2974 P

L. 830 C.G.

L. 829 C.G.

S.T.L. 039 P

S.T.L. 7034 P

S. 34

S.T.L. 7035 P

S.T.L. 2975 P

L. 876 C.G.

L. 10440

11283

Deception Cr.

KNOB HILL M.C.

S.T.L. 7036 P

Mat Cr
60

L. 877 C.G.

L. 10447 C.G.

L. 11285

ARGENT IMPER-
DOL

REVELSTONE M.D.

SLOCAN M.D.

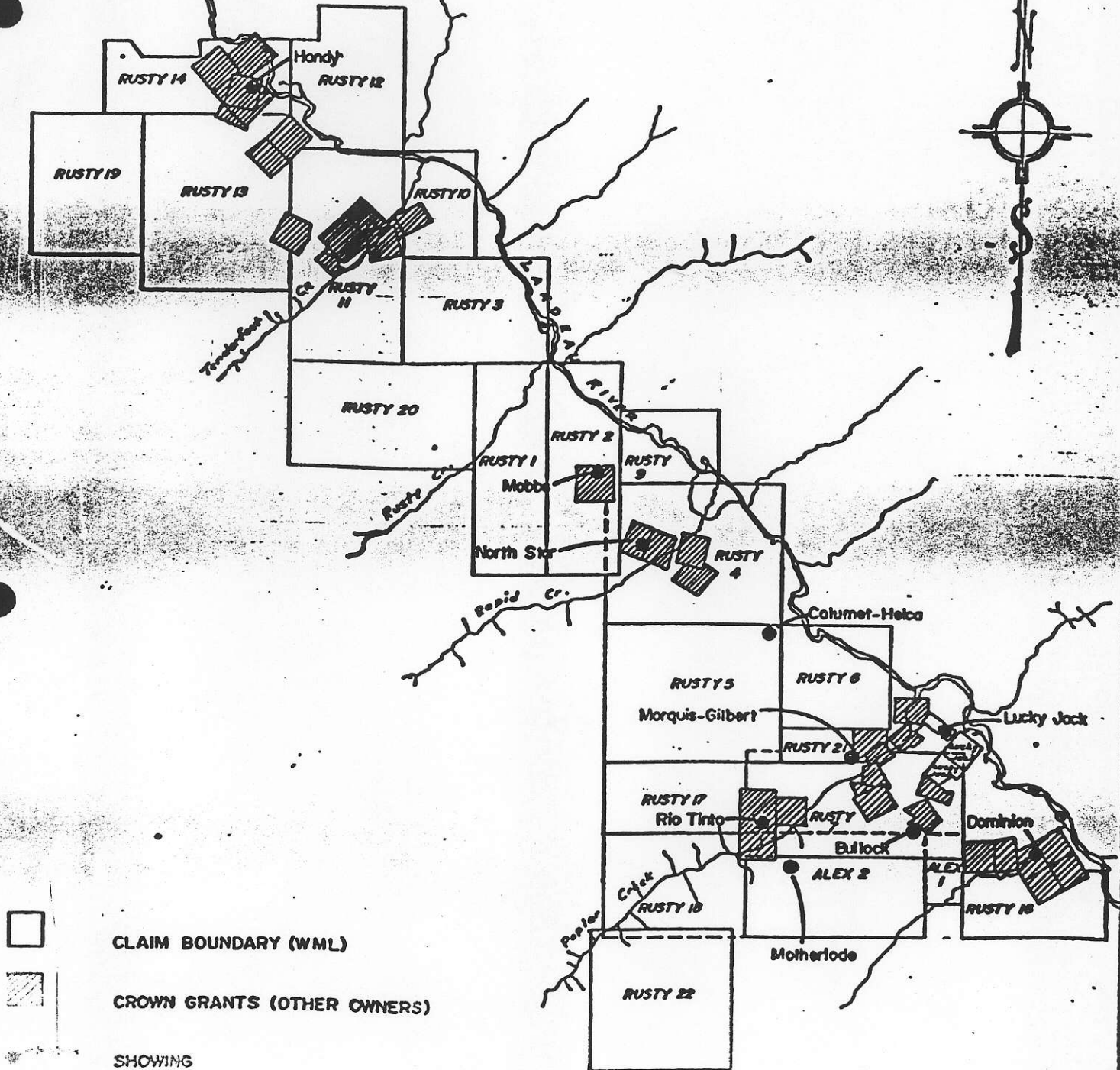
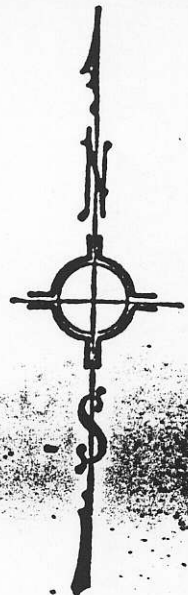





-  CLAIM BOUNDARY (WML)
-  CROWN GRANTS (OTHER OWNERS)
-  SHOWING
-  CLAIM NAME

FIGURE 2.

| | | | |
|---|------------------------|----------|---------------|
| WESTERN MINES LIMITED | | | |
| POPLAR CREEK PROJECT LOCATION MAP CLAIMS and SHOWINGS | | | |
| SCALE 1:40,000 <small>1000 0000 METERS</small> | | | |
| Date: Jan '81 | Drawn by: L. Connor | Revised: | WMS No. 82KLE |

RUN DATE: 08/25/94
 RUN TIME: 14:24:26

MINFILE / PC
 PRODUCTION REPORT
 GEOLOGICAL SURVEY BRANCH - MINERAL RESOURCES DIVISION
 MINISTRY OF ENERGY, MINES AND PETROLEUM RESOURCES

PAGE: 1
 REPORT: RGEN0200

| MINFILE NUMBER: 082KNW025 | | NAME: WINSLOW (L.8680) | | STATUS: Past Producer | |
|---------------------------|--------------|------------------------|--------------------------------|-----------------------|---------------------|
| Production Year | Tonnes Mined | Tonnes Milled | Commodity | Grams Recovered | Kilograms Recovered |
| 1941 | | | Silver Gold | 93 93 | |
| 1940 | 520 | | Silver Gold | 2,644 5,754 | |
| 1939 | 1,039 | | Silver Gold Lead Zinc | 4,354 7,776 | 216 13 |
| 1938 | 63 | | Silver Gold | 2,519 4,821 | |
| 1934 | 1 | | Silver Gold | 93 93 | |

SUMMARY TOTALS: 082KNW025

NAME: WINSLOW (L.8680)

| | <u>Metric</u> | <u>Imperial</u> |
|---------|---------------|-----------------|
| Mined: | 1,623 tonnes | 1,789 tons |
| Milled: | tonnes | tons |
| Silver: | 9,703 grams | 312 ounces |
| Gold: | 18,537 grams | 596 ounces |
| Lead: | 216 kilograms | 476 pounds |
| Zinc: | 13 kilograms | 29 pounds |

RUN DATE: 08/25/94
RUN TIME: 14:24:26

MINFILE / DC
PRODUCTION REPORT
GEOLOGICAL SURVEY BRANCH - MINERAL RESOURCES DIVISION
MINISTRY OF ENERGY, MINES AND PETROLEUM RESOURCES

PAGE: 2
REPORT: RGEN0200

| | | | | | |
|----------------------------------|------------------|-----------------------|-----------|-----------------|---------------------|
| MINFILE NUMBER: <u>082KNW032</u> | NAME: OPHIR LADE | STATUS: Past Producer | | | |
| Production Year | Tonnes Mined | Tonnes Milled | Commodity | Grams Recovered | Kilograms Recovered |
| 1932 | 12 | | Gold | 404 | |

SUMMARY TOTALS: 082KNW032 NAME: OPHIR LADE

| | <u>Metric</u> | <u>Imperial</u> |
|-----------|------------------|-----------------|
| Recovery: | Mined: 12 tonnes | 13 tons |
| | Milled: tonnes | tons |
| | Gold: 404 grams | 13 ounces ← |

RUN DATE: 08/25/94
 RUN TIME: 14:24:26

MINFILE / DC
 PRODUCTION REPORT
 GEOLOGICAL SURVEY BRANCH - MINERAL RESOURCES DIVISION
 MINISTRY OF ENERGY, MINES AND PETROLEUM RESOURCES

PAGE: 3
 REPORT: RGEN0200

| MINFILE NUMBER: 082KNW058 | | NAME: CROMWELL (L.13046) | | STATUS: Showing | |
|---------------------------|--------------|--------------------------|-----------|-----------------|---------------------|
| Production Year | Tonnes Mined | Tonnes Milled | Commodity | Grams Recovered | Kilograms Recovered |
| 1953 | 3 | | Silver | 187 | |
| | | | Gold | 62 | |
| | | | Lead | | 6 |
| | | | Zinc | | 9 |
| 1901 | 5 | | Silver | 3,017 | |
| | | | Gold | 746 | |
| 1900 | 6 | | Silver | 3,732 | |
| | | | Gold | 1,182 | |

SUMMARY TOTALS: 082KNW058

NAME: CROMWELL (L.13046)

| | Metric | Imperial |
|-------------------|-------------|------------|
| Mined: | 14 tonnes | 15 tons |
| Milled: | tonnes | tons |
| Recovery: Silver: | 6,936 grams | 223 ounces |
| Gold: | 1,990 grams | 64 ounces |
| Lead: | 6 kilograms | 13 pounds |
| Zinc: | 9 kilograms | 20 pounds |

RUN DATE: 08/25/94
 RUN TIME: 14:24:26

MINFILE / BC
 PRODUCTION REPORT
 GEOLOGICAL SURVEY BRANCH - MINERAL RESOURCES DIVISION
 MINISTRY OF ENERGY, MINES AND PETROLEUM RESOURCES

PAGE: 4
 REPORT: RGEN0200

| MINFILE NUMBER: 082KNW064 | | NAME: MERIDIAN | | STATUS: Past Producer | | |
|---------------------------|--------------|----------------|----------------|-----------------------|---------------------|--|
| Production Year | Tonnes Mined | Tonnes Milled | Commodity | Grams Recovered | Kilograms Recovered | |
| 1941 | | | Silver Gold | 124 373 | | |
| 1940 | | | Silver Gold | 124 249 | | |
| 1939 | | | Silver Gold | 1,555 3,857 | | |
| 1937 | | | Silver Gold | 156 529 | | |
| 1936 | 24,742 | 24,742 | Silver Gold | 44,944 85,502 | | |
| 1935 | 26,139 | 26,139 | Silver Gold | 69,173 168,050 | | |
| 1908 | | | Gold | 4,479 | | |
| 1907 | 4,400 | | Gold | 25,442 | | |
| 1906 | 7,212 | | Silver Gold | 17,138 59,407 | | |
| 1905 | 10,183 | | Gold | 67,494 | | |
| 1904 | 14,013 | | Silver Gold | 18,662 93,340 | | |
| 1903 | 2,074 | | Silver Gold | 13,623 35,177 | | |

SUMMARY TOTALS: 082KNW064 NAME: MERIDIAN

| | Metric | Imperial |
|-------------------|---------------|-----------------|
| Mined: | 88,763 tonnes | 97,844 tons |
| Milled: | 50,881 tonnes | 56,087 tons |
| Recovery: Silver: | 165,499 grams | 5,321 ounces |
| Gold: | 543,899 grams | 17,487 ounces ← |

Comments:

- 1941: Clean-up. 5 tons conc. shipped.
- 1940: Clean-up. 2 tons conc. shipped.
- 1939: Clean-up. 20 tons conc. shipped.
- 1937: Clean-up. 2 tons conc. shipped.
- 1936: 643 tons conc. shipped.
- 1935: 1077 tons conc. shipped.
- 1908: Conc. from 1907.

RUN DATE: 08/25/94
 RUN TIME: 14:24:26

MINFILE / pc
 PRODUCTION REPORT
 GEOLOGICAL SURVEY BRANCH - MINERAL RESOURCES DIVISION
 MINISTRY OF ENERGY, MINES AND PETROLEUM RESOURCES

PAGE: 5
 REPORT: RGEN0200

| MINFILE NUMBER: 082KNW076 | | NAME: GOLDFINCH (L.5654) | | STATUS: Past Producer | | |
|---------------------------|---------------------|--------------------------|--------------------------------|------------------------|----------------------------|--|
| <u>Production Year</u> | <u>Tonnes Mined</u> | <u>Tonnes Milled</u> | <u>Commodity</u> | <u>Grams Recovered</u> | <u>Kilograms Recovered</u> | |
| 1989 | 1 | 1 | Silver Gold | 118,244 29,804 | | |
| 1979 | 31 | 31 | Silver Gold Lead Zinc | 373 156 | 31 31 | |
| 1904 | 590 | 590 | Silver Gold | 622 4,665 | | |
| 1903 | 726 | 726 | Silver Gold | 4,976 16,205 | | |

SUMMARY TOTALS: 082KNW076

NAME: GOLDFINCH (L.5654)

| | <u>Metric</u> | <u>Imperial</u> |
|-------------------|---------------|-----------------|
| Mined: | 1,348 tonnes | 1,486 tons |
| Milled: | 1,348 tonnes | 1,486 tons |
| Recovery: Silver: | 124,215 grams | 3,994 ounces |
| Gold: | 50,830 grams | 1,634 ounces |
| Lead: | 31 kilograms | 68 pounds |
| Zinc: | 31 kilograms | 68 pounds |

Comments:

1989: Custom ore (tonnage unknown).
 1979: Bulk sample.

RUN DATE: 08/25/94
RUN TIME: 14:24:26

MINFILE / PC
PRODUCTION REPORT
GEOLOGICAL SURVEY BRANCH - MINERAL RESOURCES DIVISION
MINISTRY OF ENERGY, MINES AND PETROLEUM RESOURCES

PAGE: 6
REPORT: RGRN0200

MINFILE NUMBER: 082KNW101 NAME: SILVER DOLLAR STATUS: Past Producer

| Production Year | Tonnes Mined | Tonnes Milled | Commodity | Grams Recovered | Kilograms Recovered |
|-----------------|--------------|---------------|------------------------|-----------------|---------------------|
| 1947 | 6 | | Silver Lead Zinc | 98 | 13 10 |

SUMMARY TOTALS: 082KNW101 NAME: SILVER DOLLAR

| | Metric | Imperial | |
|-----------|----------------------|-----------|--|
| Recovery: | Mined: 6 tonnes | 7 tons | |
| | Milled: 98 grams | 3 ounces | |
| | Silver: 13 kilograms | 29 pounds | |
| | Lead: 10 kilograms | 22 pounds | |
| | Zinc: | | |

du.
NONE

RUN DATE: 08/25/94
RUN TIME: 14:24:26

MINFILE / PC
PRODUCTION REPORT
GEOLOGICAL SURVEY BRANCH - MINERAL RESOURCES DIVISION
MINISTRY OF ENERGY, MINES AND PETROLEUM RESOURCES

PAGE: 7
REPORT: RGEN0200

| | | | | | |
|---------------------------|-----------------|-----------------------|----------------|-----------------|---------------------|
| MINFILE NUMBER: 082KNW117 | NAME: FOGGY DAY | STATUS: Past Producer | | | |
| Production Year | Tonnes Mined | Tonnes Milled | Commodity | Grams Recovered | Kilograms Recovered |
| 1917 | 8 | | Silver Gold | 3,888 1,213 | |

SUMMARY TOTALS: 082KNW117 NAME: FOGGY DAY

| | <u>Metric</u> | <u>Imperial</u> |
|-----------|---------------------|-----------------|
| Recovery: | Mined: 8 tonnes | 9 tons |
| | Milled: 8 tonnes | 9 tons |
| | Silver: 3,888 grams | 125 ounces |
| | Gold: 1,213 grams | 39 ounces ← |

RUN DATE: 08/25/94
RUN TIME: 14:24:26

MINFILE / pc
PRODUCTION REPORT
GEOLOGICAL SURVEY BRANCH - MINERAL RESOURCES DIVISION
MINISTRY OF ENERGY, MINES AND PETROLEUM RESOURCES

PAGE: 8
REPORT: RGEN0200

| | | | | | |
|---------------------------|---------------------|-----------------------|------------------|------------------------|----------------------------|
| MINFILE NUMBER: 082KNW127 | NAME: GILMAN | STATUS: Past Producer | | | |
| <u>Production Year</u> | <u>Tonnes Mined</u> | <u>Tonnes Milled</u> | <u>Commodity</u> | <u>Grams Recovered</u> | <u>Kilograms Recovered</u> |
| 1933 | 1 | | Silver | 62 | |
| | | | Gold | 62 | |
| | | | Lead | | 22 |
| | | | Zinc | | 23 |

SUMMARY TOTALS: 082KNW127

NAME: GILMAN

| | <u>Metric</u> | <u>Imperial</u> |
|-----------|---------------|-----------------|
| Mined: | 1 tonnes | 1 tons |
| Milled: | tonnes | tons |
| Recovery: | | |
| Silver: | 62 grams | 2 ounces |
| Gold: | 62 grams | 2 ounces |
| Lead: | 22 kilograms | 49 pounds |
| Zinc: | 23 kilograms | 51 pounds |

RUN DATE: 08/25/94
RUN TIME: 14:24:26

MINFILE / pc
PRODUCTION REPORT
GEOLOGICAL SURVEY BRANCH - MINERAL RESOURCES DIVISION
MINISTRY OF ENERGY, MINES AND PETROLEUM RESOURCES

PAGE: 9
REPORT: RGEN0200

| | | | | | |
|---------------------------|----------------------------|-----------------------|-----------|-----------------|---------------------|
| MINFILE NUMBER: 082KNW159 | NAME: SILVER BELT (L.5695) | STATUS: Past Producer | | | |
| Production Year | Tonnes Mined | Tonnes Milled | Commodity | Grams Recovered | Kilograms Recovered |
| 1899 | 1 | | Silver | 4,137 | |
| | | | Gold | 31 | |
| | | | Lead | | 697 |

SUMMARY TOTALS: 082KNW159

NAME: SILVER BELT (L.5695)

| | <u>Metric</u> | <u>Imperial</u> |
|-----------|---------------|-----------------|
| Mined: | 1 tonnes | 1 tons |
| Milled: | 1 tonnes | 1 tons |
| Recovery: | | |
| Silver: | 4,137 grams | 133 ounces |
| Gold: | 31 grams | 1 ounces |
| Lead: | 697 kilograms | 1,537 pounds |

RUN DATE: 08/25/94
RUN TIME: 14:24:26

MINFILE / pc
PRODUCTION REPORT
GEOLOGICAL SURVEY BRANCH - MINERAL RESOURCES DIVISION
MINISTRY OF ENERGY, MINES AND PETROLEUM RESOURCES

PAGE: 10
REPORT: RGEN0200

| | | | | | |
|---------------------------|---------------------|-----------------------|------------------|------------------------|----------------------------|
| MINFILE NUMBER: 082KNW187 | NAME: LUCKY JACK | STATUS: Past Producer | | | |
| <u>Production Year</u> | <u>Tonnes Mined</u> | <u>Tonnes Milled</u> | <u>Commodity</u> | <u>Grams Recovered</u> | <u>Kilograms Recovered</u> |
| 1908 | 454 | | Silver | 373 | |
| | | | Gold | 1,555 | |
| 1904 | 8 | | Gold | 778 | |

SUMMARY TOTALS: 082KNW187

NAME: LUCKY JACK

| | | | |
|-----------|---------|---------------|-----------------|
| | | <u>Metric</u> | <u>Imperial</u> |
| Recovery: | Mined: | 462 tonnes | 509 tons |
| | Milled: | | |
| | Silver: | 373 grams | 12 ounces |
| | Gold: | 2,333 grams | 75 ounces |

RUN DATE: 08/25/94
RUN TIME: 14:24:26

MINFILE / pc
PRODUCTION REPORT
GEOLOGICAL SURVEY BRANCH - MINERAL RESOURCES DIVISION
MINISTRY OF ENERGY, MINES AND PETROLEUM RESOURCES

PAGE: 11
REPORT: RGEN0200

| | | | | | |
|----------------------------------|-----------------------|-----------------------|------------------|-----------------|---------------------|
| MINFILE NUMBER: <u>082KSE046</u> | NAME: BUNYAN (L.9096) | STATUS: Past Producer | | | |
| Production Year | Tonnes Mined | Tonnes Milled | Commodity | Grams Recovered | Kilograms Recovered |
| 1904 | 14 | | Silver Copper | 3,266 | 1,268 |

SUMMARY TOTALS: 082KSE046

NAME: BUNYAN (L.9096)

| | <u>Metric</u> | <u>Imperial</u> |
|-----------|-------------------------|-----------------|
| Recovery: | Mined: 14 tonnes | 15 tons |
| | Milled: tonnes | tons |
| | Silver: 3,266 grams | 105 ounces |
| | Copper: 1,268 kilograms | 2,795 pounds |

All
NONE

RUN DATE: 08/25/94
 RUN TIME: 14:24:26

MINFILE / pc
 PRODUCTION REPORT
 GEOLOGICAL SURVEY BRANCH - MINERAL RESOURCES DIVISION
 MINISTRY OF ENERGY, MINES AND PETROLEUM RESOURCES

PAGE: 12
 REPORT: RGEN0200

| MINFILE NUMBER: <u>082KSW037</u> | | NAME: HIGHLAND SURPRISE | | STATUS: Past Producer | | |
|----------------------------------|--------------|-------------------------|--------------------------------|-----------------------|---------------------|--|
| Production Year | Tonnes Mined | Tonnes Milled | Commodity | Grams Recovered | Kilograms Recovered | |
| 1942 | 27 | | Silver Gold | 653 373 | | |
| 1941 | 1,072 | | Silver Gold | 12,006 23,732 | | |
| 1940 | 357 | | Silver Gold Lead Zinc | 6,127 12,037 | 145 145 | |
| 1939 | 179 | | Silver Gold | 4,914 6,158 | | |
| 1938 | 268 | | Silver Gold | 6,065 8,647 | | |

SUMMARY TOTALS: 082KSW037

NAME: HIGHLAND SURPRISE

| | Metric | Imperial |
|-------------------|---------------|--------------|
| Mined: | 1,903 tonnes | 2,098 tons |
| Milled: | | |
| Recovery: Silver: | 29,765 grams | 957 ounces |
| Gold: | 50,947 grams | 1,638 ounces |
| Lead: | 145 kilograms | 320 pounds |
| Zinc: | 145 kilograms | 320 pounds |

RUN DATE: 08/25/94
RUN TIME: 14:24:26

MINFILE / pc
PRODUCTION REPORT
GEOLOGICAL SURVEY BRANCH - MINERAL RESOURCES DIVISION
MINISTRY OF ENERGY, MINES AND PETROLEUM RESOURCES

PAGE: 13
REPORT: RGEN0200

MINFILE NUMBER: 082KSW052 NAME: PROMESTORA (L.3788) STATUS: Past Producer

| <u>Production Year</u> | <u>Tonnes Mined</u> | <u>Tonnes Milled</u> | <u>Commodity</u> | <u>Grams Recovered</u> | <u>Kilograms Recovered</u> |
|------------------------|---------------------|----------------------|------------------|------------------------|----------------------------|
| 1956 | 8 | | Silver | 840 | |
| | | | Gold | 715 | |
| | | | Lead | | 84 |
| | | | Zinc | | 116 |

SUMMARY TOTALS: 082KSW052 NAME: PROMESTORA (L.3788)

| | <u>Metric</u> | <u>Imperial</u> |
|-----------|---------------------|-----------------|
| | Mined: 8 tonnes | 9 tons |
| | Milled: 8 tonnes | 9 tons |
| Recovery: | Silver: 840 grams | 27 ounces |
| | Gold: 715 grams | 23 ounces ← |
| | Lead: 84 kilograms | 185 pounds |
| | Zinc: 116 kilograms | 256 pounds |

RUN DATE: 08/25/94
 RUN TIME: 14:24:26

MINFILE / pc
 PRODUCTION REPORT
 GEOLOGICAL SURVEY BRANCH - MINERAL RESOURCES DIVISION
 MINISTRY OF ENERGY, MINES AND PETROLEUM RESOURCES

PAGE: 14
 REPORT: RGEN0200

| MINFILE NUMBER: 082KSW122 | | NAME: MARQUIS & GILBERT | | STATUS: Past Producer | |
|---------------------------|--------------|-------------------------|------------------------|-----------------------|---------------------|
| Production Year | Tonnes Mined | Tonnes Milled | Commodity | Grams Recovered | Kilograms Recovered |
| 1928 | 10 | | Silver Gold | 156 467 | |
| 1903 | 5 | | Silver Gold Lead | 124 187 | 95 |

SUMMARY TOTALS: 082KSW122

NAME: MARQUIS & GILBERT

| | Metric | Imperial |
|-------------------|--------------|------------|
| Mined: | 15 tonnes | 17 tons |
| Milled: | tonnes | tons |
| Recovery: Silver: | 280 grams | 9 ounces |
| Gold: | 654 grams | 21 ounces |
| Lead: | 95 kilograms | 209 pounds |