

RON BACON
372-7101

680195

B2K

469

REPORT

B2K/13E

- on the -

INDEPENDENCE GROUP OF CLAIMS

Revelstoke Mining Division

- for -

RON BACON,

6774 Blackwell Street,
Kamloops, B. C.

PREPARED BY:

KERR, DAWSON & ASSOCIATES LTD.,
#1-219 Victoria Street,
KAMLOOPS, B.C.

John R. Kerr, P. Eng.,
June 30, 1979.

INDEX

	<u>Page No.</u>
SUMMARY	1
INTRODUCTION	3
General Statement	3
Location and Access	3
Topography and Vegetation	4
Property	5
History	5
GEOLOGY	8
ECONOMIC POTENTIAL	10
RECOMMENDATIONS	13

LIST OF MAPS:

- | | |
|---------------|---|
| Figure #209-1 | - Location Map |
| Figure #209-2 | - Index Map |
| Figure #209-3 | - Surface Plan of Quartz Vein
with Sample Locations and
Assays. |

SUMMARY

The Independence Property consists of 5 contiguous crown-granted mineral claims under option agreement to Messrs. Ron Bacon and Bob Leighton. The claims cover a northwestern portion of a major structural feature and associated gold-bearing quartz veins. Limited production of gold is reported from the same vein on the Goldfinch claim adjoining the Independence Group to the southwest.

Limited exposures of the vein indicate a minimum strike length of 200 meters, and average width of 3.4 meters. Results of assays from samples collected across the full width of the vein indicate an average of .264 oz. Au/T, .95 oz. Ag/T, or a gross value of \$87.00/short ton (\$96.00/metric tonne). Based on the known strike length, the vein has a potential of 1,800 metric tonnes/vertical meter. The strike length of the vein is open to the northwest, and is unexplored at depth.

Two samples collected in a quartz stockwork system in the phyllitic wall-rock of the main vein

indicate .02 & .035 oz. Au/T. It is possible that a low-grade, large tonnage gold deposit could be developed.

An exploration programme consisting of diamond drilling, geological mapping, geochemistry and an E.M. Survey is recommended to develop the potential of both a vein deposit and large tonnage, low-grade deposit. Costs of the recommended programme are \$33,000.00.

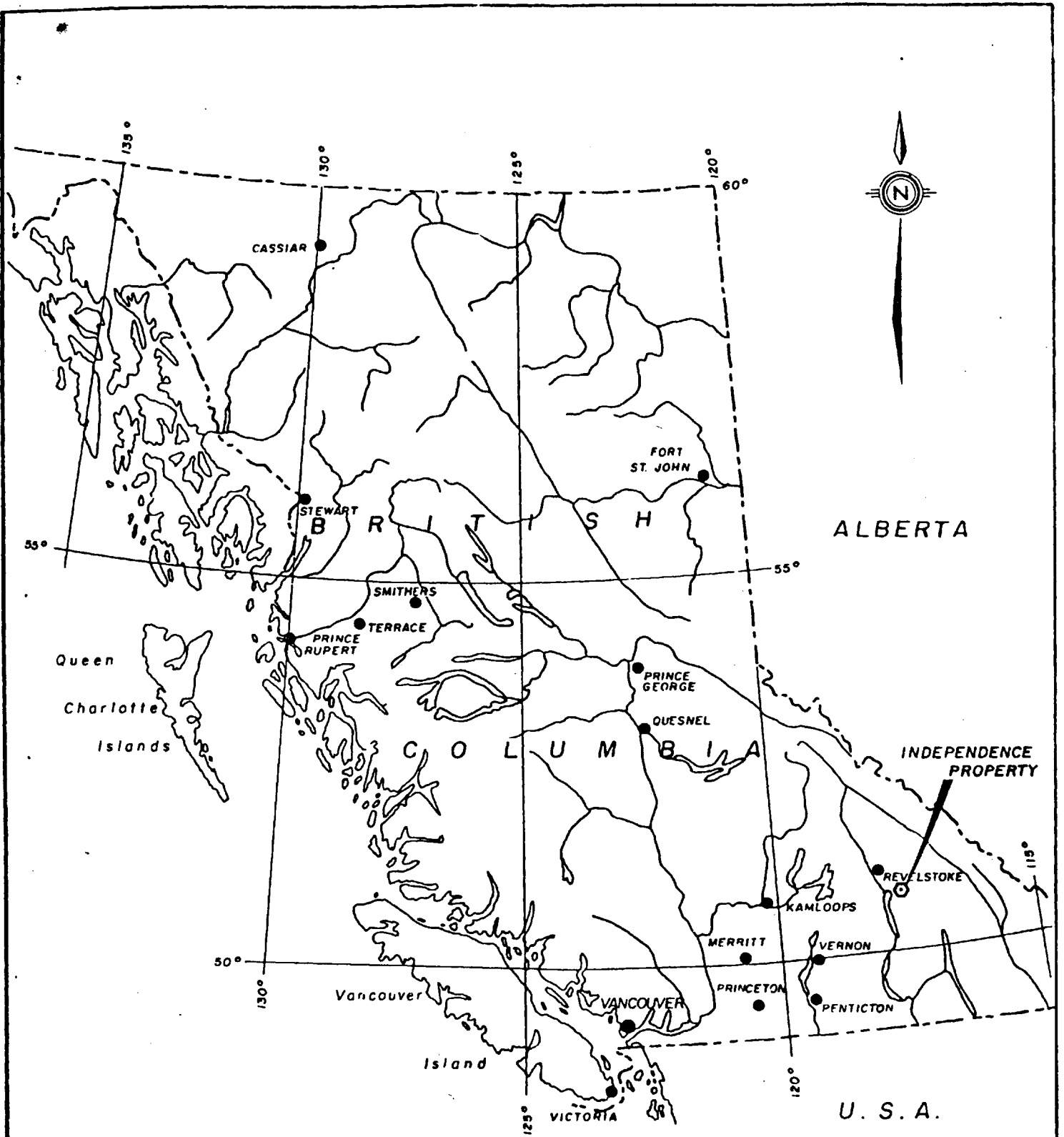

LOCATION MAP
INDEPENDENCE PROPERTY

REVELSTOKE MINING DIVISION, B.C.

Technical Work by: Kerr, Dawson & Assoc. Ltd.	Date: June, 1979.
--	-------------------

Scale: 1cm. = 87 km.	Dwg No. 209-1
----------------------	---------------

INTRODUCTION.

General Statement:

The Independence Group of crown-granted mineral claims are located in the northern portion of a favourable group of rocks of the Lardeau and Trout Lake valleys that have had a very successful history of mining of lead, zinc, silver, and gold. Messrs. R. Leighton and R. Bacon hold 5 crown-granted mineral claims under lease.

Mr. Bacon requested that I examine the property on June 12, 1979, and compile this report, outlining specific recommendations for continued work.

Location and Access:

The property is located 50 km. southeast of the city of Revelstoke, on the west side of the Incomappleux River, eight miles north of the old

settlement of Beaton at the head of Upper Arrow Lake. Geographic coordinates of the property are 50°49.5'N; 117°39.5'W, NTS-82K/13E.

Access is possible to the property by highway and well-maintained logging roads from Revelstoke, via Highways #23 and #31 south of Revelstoke, a distance of 60 km., and thence west and north along a well-maintained logging road, a distance of 25 km. to the property.

Topography and Vegetation:

The property is located in very precipitous terrain of the Selkirk Mountains, on the west valley wall of the Incomappleux River. The area of the claims form a small plateau at the 1070 m (a.s.l.) elevation on the eastern slopes of Mt. Comaplix. Terrain on the property is therefore quite moderate with overall relief in the order of 300 meters.

Vegetation on the property is typical dense Columbia River forests, consisting of cedar, fir,

spruce, hemlock, and poplar. Underbrush consists of thick alder and devil's club.

Property:

The Independence property consists of five contiguous crown-granted mineral claims in the Revelstoke Mining Division.

Golden Eagle	L12479	30.12 acres
Independance Fraction	L12480	20.84 acres
Dorothy	L12481	29.34 acres
Golden Standard	L12482	42.27 acres
Vimey Ridge	L12483	<u>34.55 acres</u>
TOTAL		<u><u>157.12 acres</u></u>

All claims are registered in the name of Richard Evans, under option agreement to Messrs. Bacon and Leighton. Taxes on the claims are current.

History:

Mining in the Lardeau and Trout Lake areas dates back to the nineteenth century. The old mining camp of Cambourne was established at the turn of the century as the result of gold being discovered

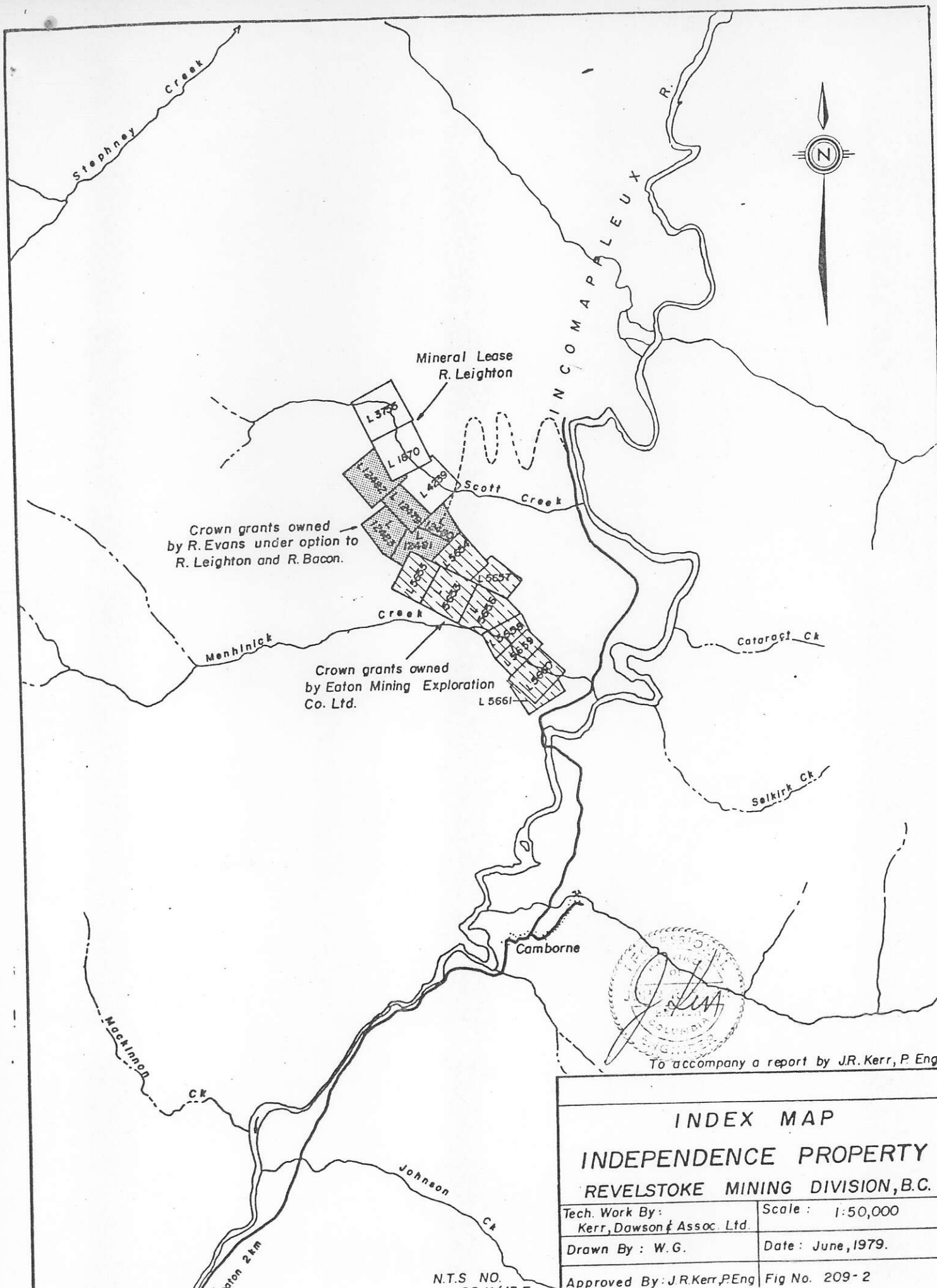

Crown grants owned by R. Evans under option to R. Leighton and R. Bacon.

Mineral Lease R. Leighton

Crown grants owned by Eaton Mining Exploration Co. Ltd.

To accompany a report by J.R. Kerr, P. Eng.

INDEX MAP	
INDEPENDENCE PROPERTY	
REVELSTOKE MINING DIVISION, B.C.	
Tech. Work By: Kerr, Dawson & Assoc. Ltd.	Scale: 1:50,000
Drawn By: W.G.	Date: June, 1979.
Approved By: J.R. Kerr, P. Eng.	Fig No. 209-2

N.T.S. NO.

and produced on Lexington Mountain, and in the immediate vicinity of Cambourne. Gold values were discovered in quartz veins on the west side of the Incomappleux River in 1901. This was believed to be the northwestern extension of the main vein system at Cambourne.

The Goldfinch Mining Company produced gold from quartz veins from 1903 to 1905 from what is now referred to as the Goldfinch claim, adjoining the Independence Group to the southeast. A forest fire destroyed all buildings and equipment in 1905, terminating all operations.

Intermittent phases of prospecting and development occurred during the period 1905-1935, with no reported production. History is rather vague as to the history of the Independence Group; however, was originally under ownership of a family named Rowland. Some of the early exploration was obviously in conjunction with the early operations on the Goldfinch claim. There is no reported production from the Independence Group.

In 1947, Mr. Richard Evans of Kamloops, B. C. purchased the five crown-granted claims forming the Independence Group and has held the property continuously to this date.

In 1976, Messrs. R. Leighton and R. Bacon entered into an option lease agreement with Mr. Evans, and have completed some limited trenching on the showing area.

GEOLOGY

The geology of the property area is well documented on the G.S.C. Open File Map #288, Geology of the Lardeau, West-Half, Area by P. B. Read.

The claim area is underlain by metamorphosed sediments of the Early Palaeozoic Lardeau Group. The Lardeau Group has been subdivided into six formations, three of which occur on or near the Independence Group of claims:

Broadview Formation: Grey and green phyllitic grit and phyllite.

Jowett Formation: Green phyllite and greenstone.

Sharon Creek Formation: Dark grey to black siliceous phyllite.

Most rocks examined on the property are described as a light-medium grey phyllite and probably fall into the Broadview Formation. Schistosity of examined outcrops indicate an average strike of 110° , dipping $75-80^{\circ}$ N.

The G.S.C. map indicates a major N45°W fault zone which traverses the Independence Group of claims. The trace of this fault approximates the location of the main gold bearing quartz vein and associated shearing as observed.

The main quartz vein on the Independence property was observed in two outcrops and as a large boulder. Measured attitudes of the vein indicate a strike of 315°; dipping 70°NE. Exposed widths of the vein are 4.3 m and 2.4 m at each outcrop location. Where the hanging wall of the vein is exposed, intense alteration, shearing and quartz veining is apparent over an additional 3 m. width, and is evidence of a major fault zone. Mineralization in the quartz vein is massive blebs of pyrite up to 20 cm. in diameter. No sphalerite or galena was observed; however, old reports indicate assays of both lead and zinc.

Outcrops adjacent to the main vein indicate abundant small lenticular veinlets, randomly oriented in a stockwork system.

ECONOMIC POTENTIAL

Figure #209-3 is a diagrammatic interpretation of the quartz vein showing sample locations and assay results.

Four samples were collected from the vein in Pit #1 area:

<u>Sample No.</u>	<u>Type of Sample</u>	<u>Au oz./T.</u>	<u>Ag oz./T.</u>	
I-06	Selected	.18	.10	(not used for average grade).
I-05	Chip/4.3 m.	.14	.26	
I-10	Grab Fresh Blast /4.3 m.	.13	2.20	
Avg.	<u>4.3 m.</u>	<u>.135</u>	<u>1.23</u>	\$51.00/Ton *
I-07	Chip/3.0 m.	.035	.11	
Avg.	<u>7.3 m.</u>	<u>.094</u>	<u>.68</u>	\$34.00/Ton *

One sample was collected from Pit #2 indicating the following values:

<u>Sample No.</u>	<u>Type of Sample</u>	<u>Au oz./T.</u>	<u>Ag oz./T.</u>	
I-02	Chip/2.4 m.	.475	.45	\$146.00/Ton *

* Based on gold value of \$300.00/oz and silver value of \$8.50/oz.

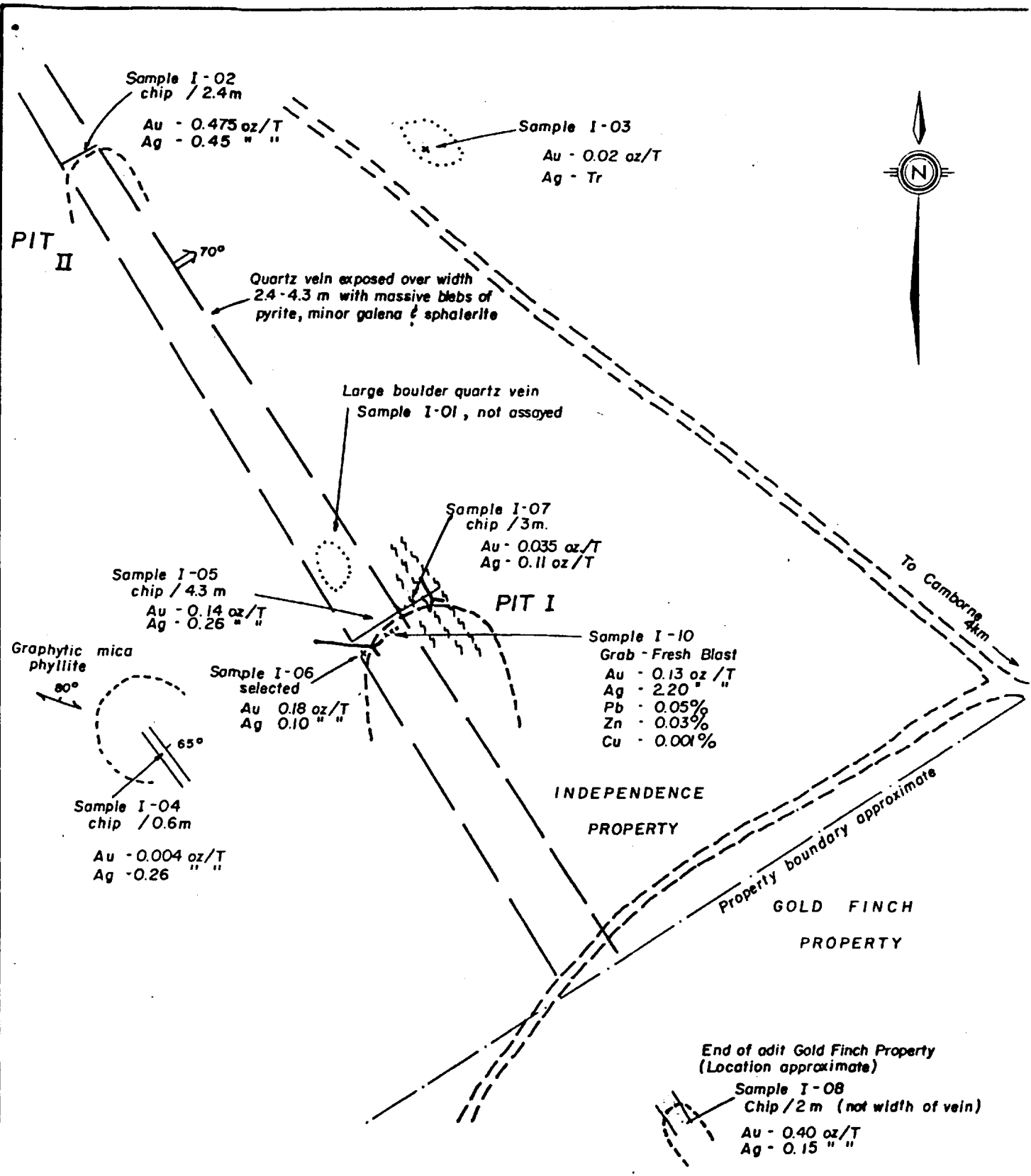

J. Kerr

N.T.S NO

To accompany a report by J.R. Kerr, P. Eng

SURFACE PLAN & ASSAY RESULTS	
INDEPENDENCE PROPERTY	
REVELSTOKE MINING DIVISION, B.C.	
Tech. Work By: Kerr, Dawson & Assoc. Ltd.	Scale: 1:1250
Drawn By: W.G.	Date: June, 1979.

A sample collected from a vein in the underground adit on the Goldfinch property indicated the following values:

<u>Sample No.</u>	<u>Type of Sample</u>	<u>Au oz./T.</u>	<u>Ag oz./T.</u>	
I-08	Chip/.6 m.	.40	.15	\$121.00/Ton.

This sample suggests that the quartz vein and gold values are persistent to the Goldfinch/Independence property line.

From the above exposures of the vein, a minimum strike length of 200 meters is indicated, with an average width of 3.4 meters. Limited sampling from exposures of the vein indicate a potential of 1,800 metric tonnes per vertical meter, valued at \$96.00/metric tonne (\$87.00/short ton).

Sample numbers I-03 and I-07 indicate low grade gold values, .02 & .035 oz./Ton respectively, in the wall rock, sample I-03 up to 40 m. distance from the vein. These samples indicate a potential of low-grade gold occurring over substantial widths.

Samples I-05, I-06, and I-10 were various types of samples collected from the quartz vein, at Pit #1. Sample I-06 was a selected sample of massive pyrite and assayed .18 oz. Au/T. Samples I-05 and I-10 were

representative samples over the full width of the vein, and assayed .14 and .13 oz. Au/Ton respectively. This would suggest that gold occurs evenly disseminated throughout the vein, and is not necessarily related to the sulphide content.

Further exploration is required to develop the full potential of either:

- (1). High-grade vein deposit
- (2). Low-grade, large tonnage deposit.

The recommended programme is oriented to evaluate the potential of both types of deposit.

RECOMMENDATIONS

PHASE I:

- (1). Stake approximately 1,200 acres of ground (20 claim units) to give adequate ground protection to the north, east, and west of the existing crown-grants.
- (2). Establish 25 km. of grid, with 30 meter detail over area of main showings. The baseline of the grid should project along the strike of vein, with crosslines extending 500 meters in a northeast and southwest direction.
- (3). Soil sampling at 30 meter intervals over vein area, and at 60 meter intervals over remainder of grid.
- (4). A VLF-EM survey over the entire grid area, readings at 30 meter intervals.
- (5). Geological mapping of the grid area.

- (6). 250 meters of NQ diamond drilling (3 holes)
to test the vein and wall-rock mineralization.
- (7). Compilation of data in report form.

The cost of Phase I is estimated to be
\$33,000.00, details outlined in Appendix A.

PHASE II:

The recommended programme for Phase II
would largely be contingent upon the results of Phase
I, however, would likely include detailed drilling
of the vein structure.

Respectfully Submitted By:

KERR, DAWSON & ASSOCIATES LTD.,



John R. Kerr

John R. Kerr, P. Eng.,
GEOLOGIST

Kamloops, B. C.,

June 30, 1979.

APPENDIX A

COST ESTIMATES

COST ESTIMATES

(1).	Claim Acquisition		\$ 1,500.00
(2).	Grid Preparation		2,000.00
(3).	Diamond Drilling (NQ) 250 meters @ \$70.00/m.		17,500.00
(4).	Supervision:		
	1 Geologist 14 days @ \$125.00/day	\$1,750.00	
	1 Assistant 7, days @ \$100.00/day	<u>700.00</u>	2,450.00
(5).	Geochemical Analysis and Assays		3,000.00
(6).	Truck Rental		500.00
(7).	Food and Camp costs, misc. purchases, equipment Rental, Travel, etc.		1,500.00
(8).	Report		1,500.00
(9).	~ 10% Contingencies		<u>3,050.00</u>
	TOTAL		<u><u>\$33,000.00</u></u>

APPENDIX B

ASSAY CERTIFICATES



Kamloops Research & Assay Laboratory Ltd.

GEOCHEMICAL ANALYSTS

2095 WEST TRANS CANADA HIGHWAY-KAMLOOPS, B.C. V1S 1A7
TELEPHONE 372-2784 TELEEX 048-8320

CERTIFICATE OF ASSAY

to Kerr, Dawson & Associates,
3 - 219 Victoria St.,
Kamloops, B. C.

Certificate No. K-2075
Date June 19, 1979.

I hereby certify that the following are the results of assays made by us upon the herein described chip samples

Kral No.	Marked	GOLD	SILVER	Cu	Pb	Zn				
		Ounces Per Ton	Ounces Per Ton	Percent	Percent	Percent	Percent	Percent	Percent	Percent
1	1 - 02	.475	.45	-	-	-				
2	1 - 03	.02	Tr	-	-	-				
3	1 - 04	.004	.26	-	-	-				
4	1 - 05	.14	.26	-	-	-				
5	1 - 06	.18	.10	-	-	-				
6	1 - 07	.035	.11	-	-	-				
7	1 - 08	.40	.15	-	-	-				
8	1 - 09	.03	.08	-	-	-				
9	1 - 10	.13	2.20	.001	.05	.03				

Tr denotes "trace"

NOTE:

Rejects retained three weeks
Pulps retained three months
unless otherwise arranged.

D. J. Ross
.....
Registered Assayer, Province of British Columbia

APPENDIX C

WRITER'S CERTIFICATE

JOHN R. KERR, P.ENG.
GEOLOGICAL ENGINEER

1 - 219 VICTORIA STREET
KAMLOOPS, B.C.

PHONE (604) 374-0544

CERTIFICATE

I, JOHN R. KERR, OF THE CITY OF KAMLOOPS, BRITISH COLUMBIA,
DO HEREBY CERTIFY THAT:

- (1). I am a member of the Association of Professional Engineers of British Columbia, and a fellow of the Geological Association of Canada.
- (2). I am employed by Kerr, Dawson and Associates Ltd., with my office at #1 - 219 Victoria Street, Kamloops, B. C.
- (3). I have practiced continuously as a geologist, since graduation from the University of British Columbia in 1964, with a B.A. Sc. in Geological Engineering.
- (4). I do not hold any interest direct or indirect to title of the Independence Group of crown-granted claims (as referred to in the text of the report).
- (5). This report is based on an exhaustive study of all available data, published and unpublished reports, and my examination of the property on June 12, 1979.
- (6). Permission is hereby granted to Mr. Bacon, to use this report for financing purposes, and to satisfy requirements of the Securities Commission, the Stock Exchange, and the B. C. Ministry of Mines.

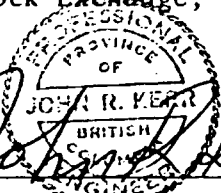
John R. Kerr

John R. Kerr, P. Eng.,
GEOLOGIST

Kamloops, B. C.,
June 30, 1979.

I-13/2

.02G

.11S

I-11/5

.005G

.11S

I-14/19'6"

.52

.65