

LEGEND

LITHOLOGIES

TERTIARY

PENTICTON GROUP

- 6 Dykes, sills and stocks
- 6a Syenite, potassic monzonite
- Biotite porphyries, pulaskites

TRIASSIC TO CRETACEOUS (NELSON, LEXINGTON INTRUSIVES?)

- 4 Quartz diorite to monzodiorite, local granodiorite. Plagioclase-hornblende porphyries common.

TRIASSIC

BROOKLYN FORMATION

- 2 Limestone and calcareous sandstone
2m recrystallized, marble.
- 1 Metavolcanics and related microdiorite (1m)
Andesitic fragmental rocks. Subvolcanic intrusions.
Note* some microdiorites are hornfelsed metavolcanics.

RAISE PITS

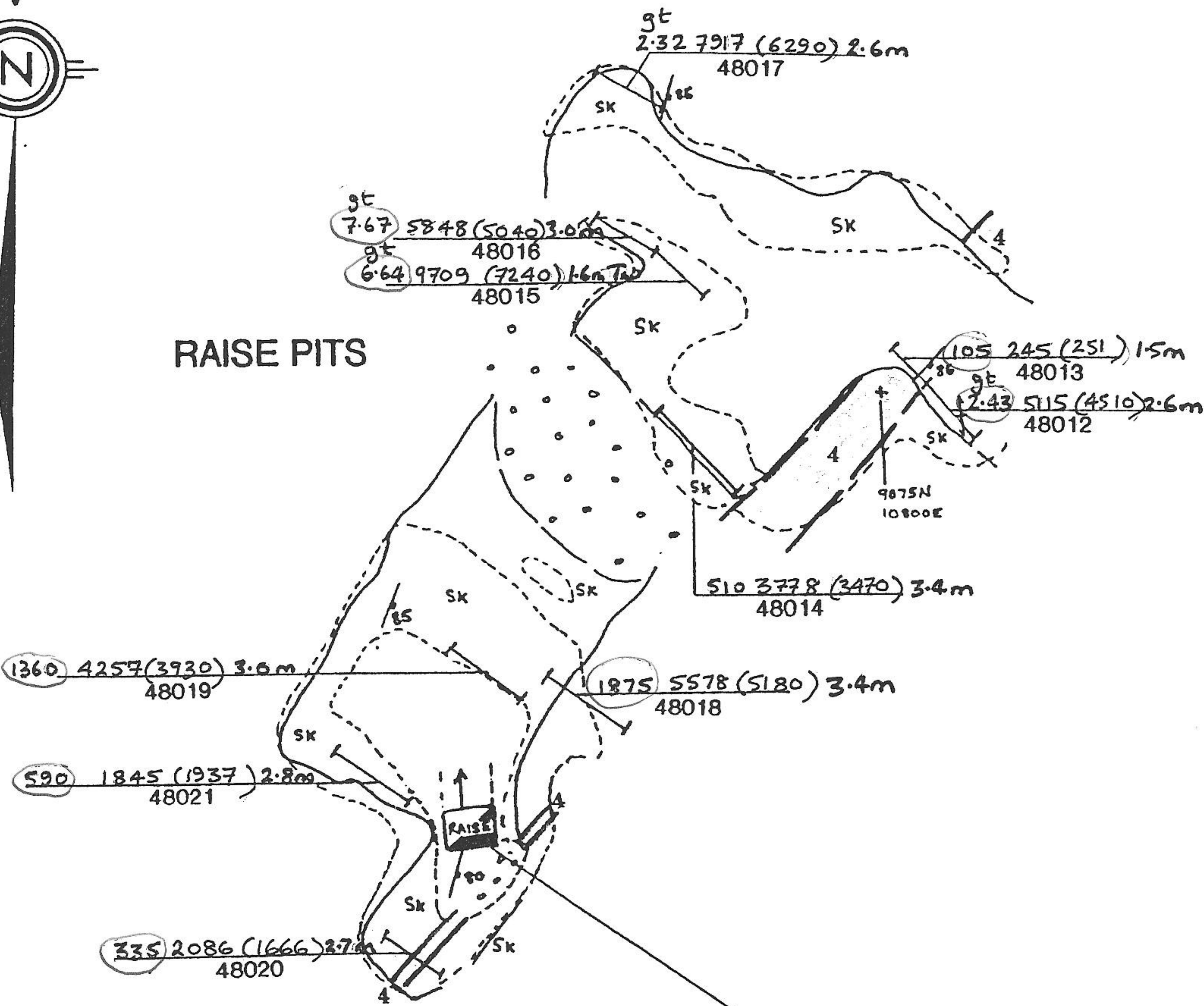

MAIN ADIT

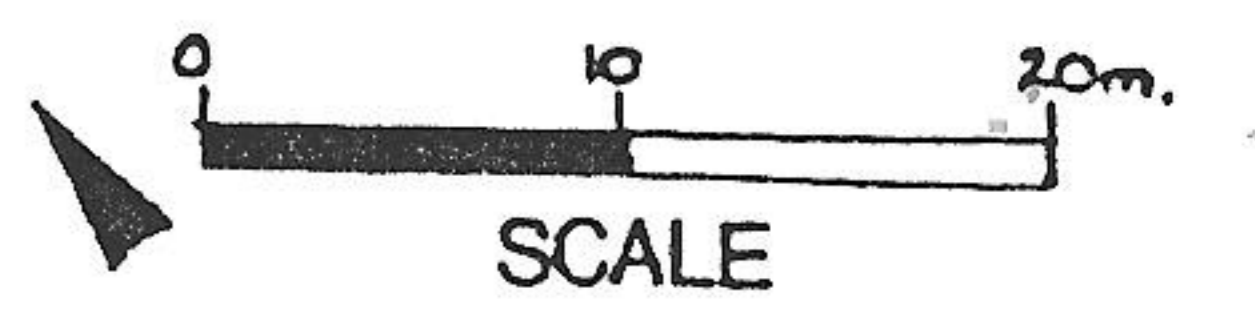
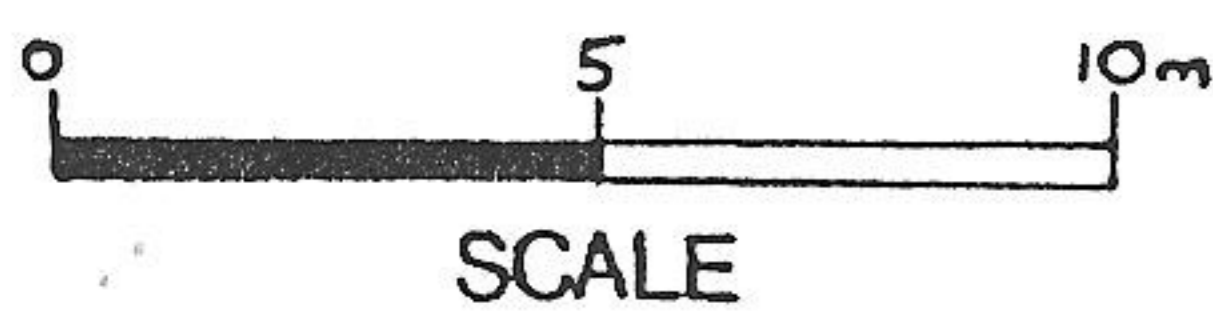
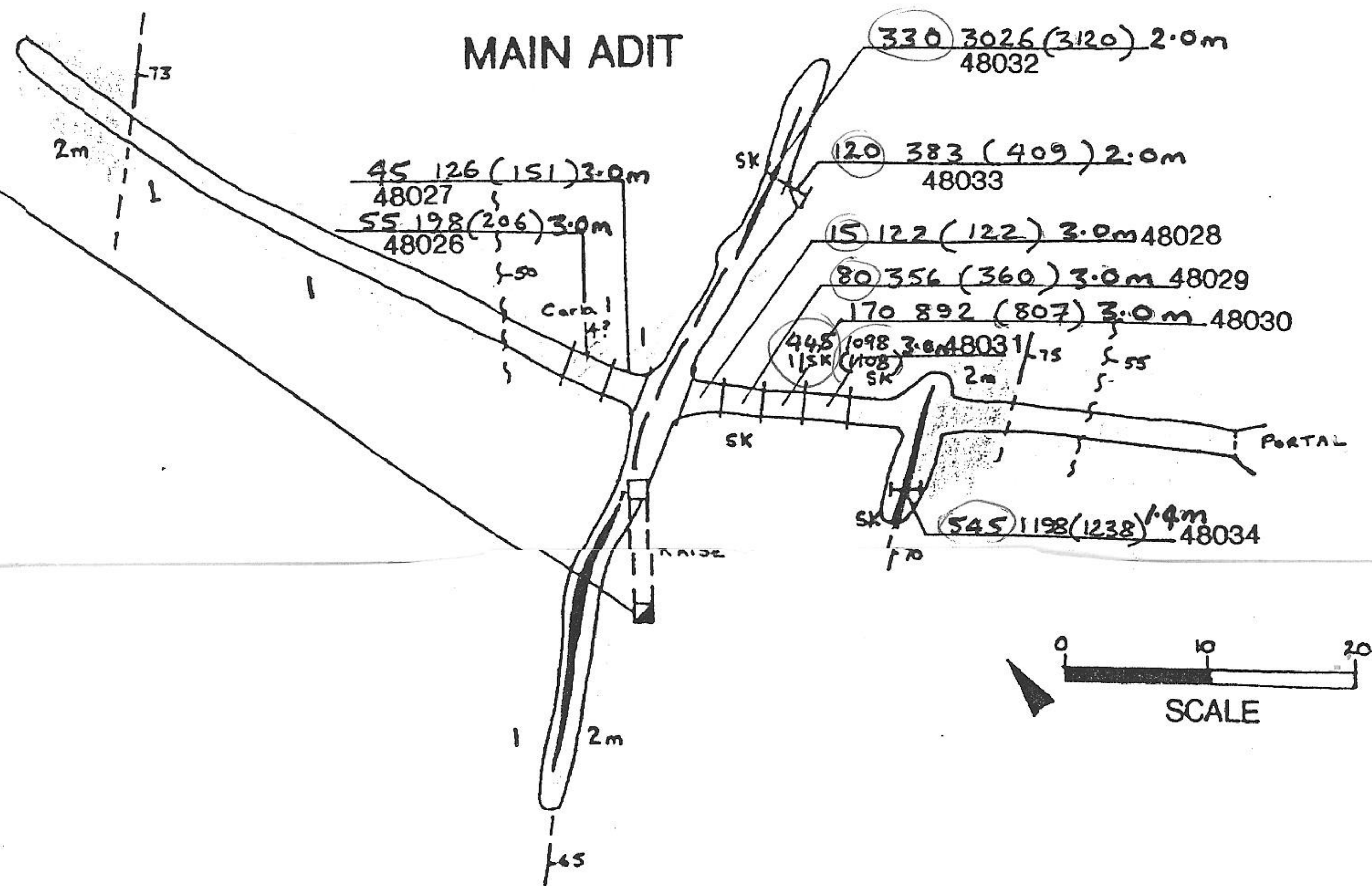

ROCK-CUT A

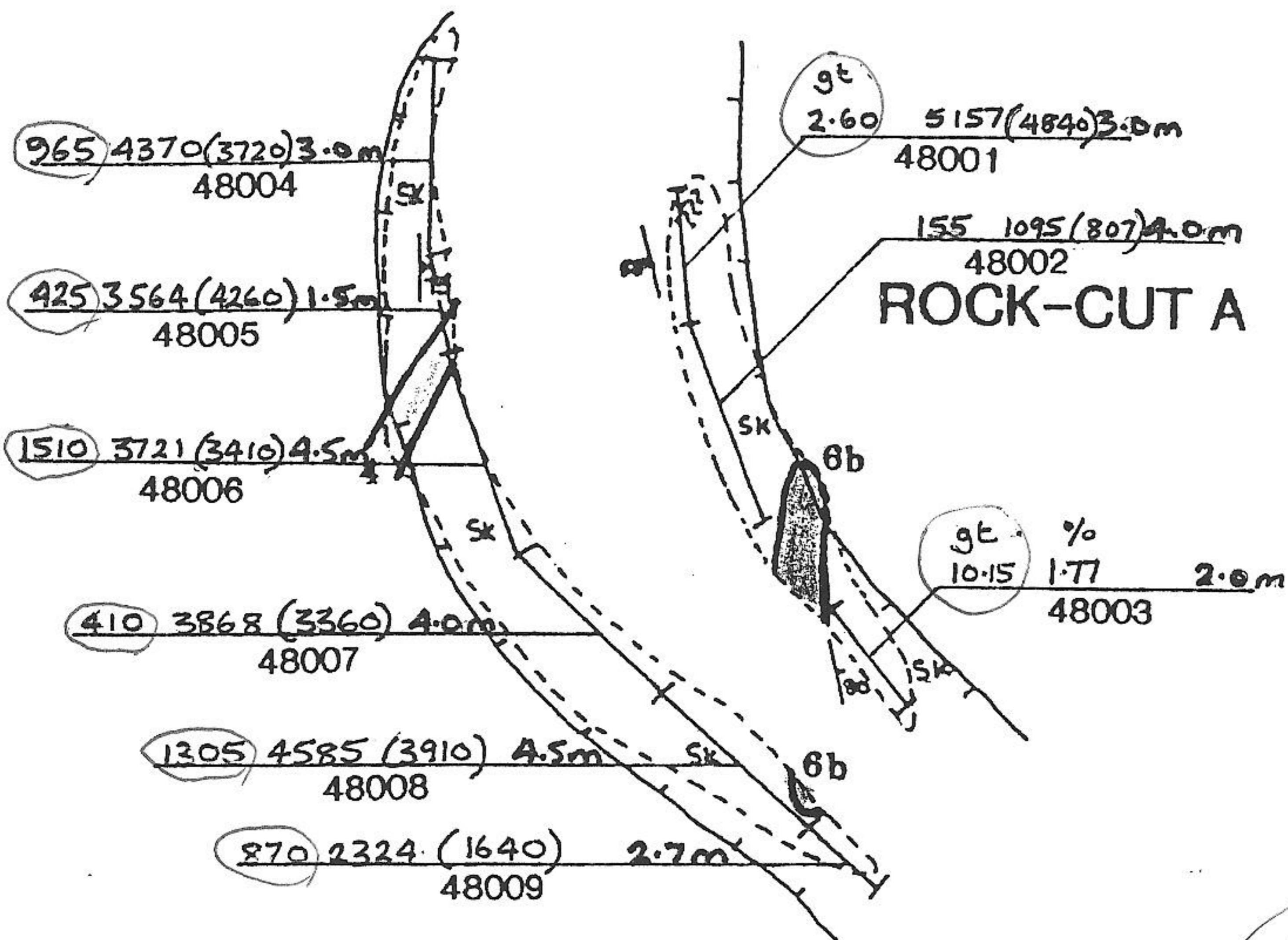

SAMPLING LEGEND

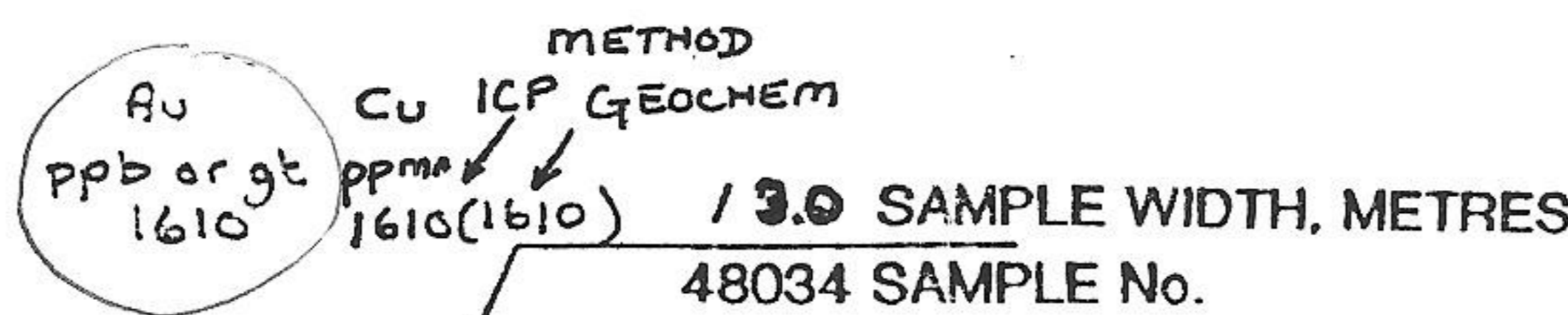

ALTERATION

- Calc-silicate (hornfels!)
Fine to fine medium grained. Basic assemblage is epidote and carbonate (calcite).

- Skarn
Medium to coarse grained. Various assemblages, most with some epidote and carbonate (calcite).

MINERALS

- G,g Garnet
- Px Pyroxene
- H Hematite
- Chl Chlorite
- M Magnetite
- Po Pyrrhotite
- Cpy Chalcopyrite
- Zn Sphalerite
- Gp Gypsum

ROCK-CUT B

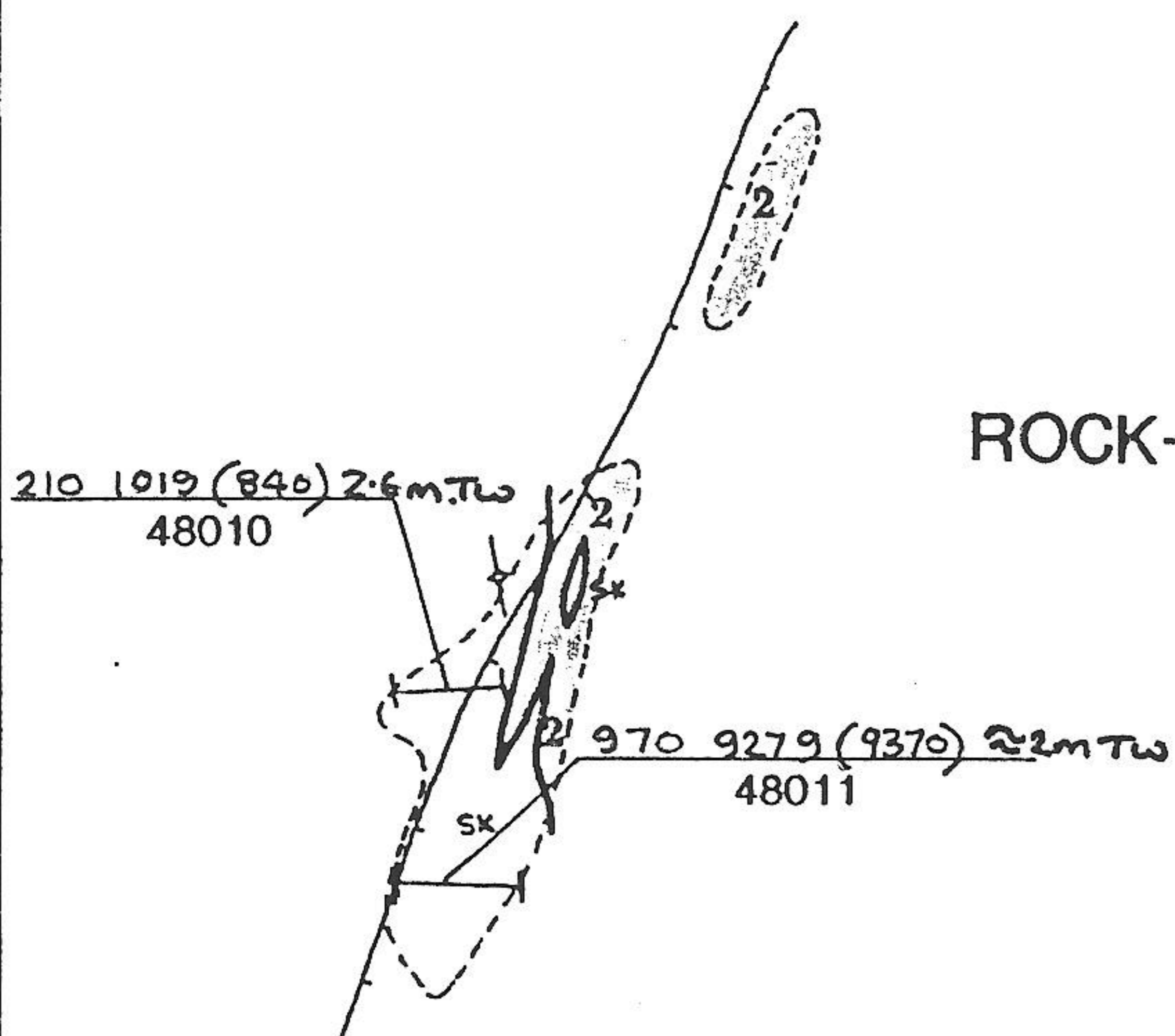

PLACER DOME INC.

THIMBLE MOUNTAIN PROJECT SEATTLE

PLANS OF WORKINGS

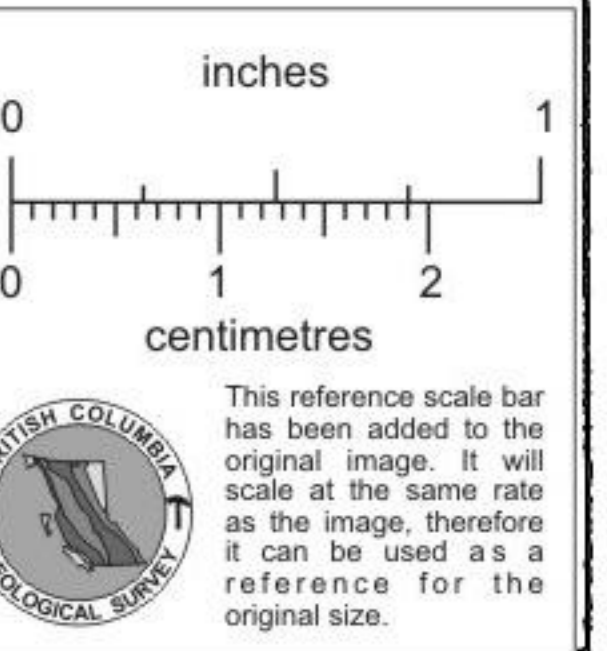

PREPARED BY: R.C.WELLS

680035

SEE GEOLOGICAL MAP FOR LOCATIONS

NTS 82F/1

NOV 1 1992