

Geologic Setting; and Sample Location

Max Group Mineral Claim
Omineca M.D., (93M/6E)

● massive sulphide Zones;
X bedding

1 — location; Sample: Max-1985
B — location, bulk Sample.

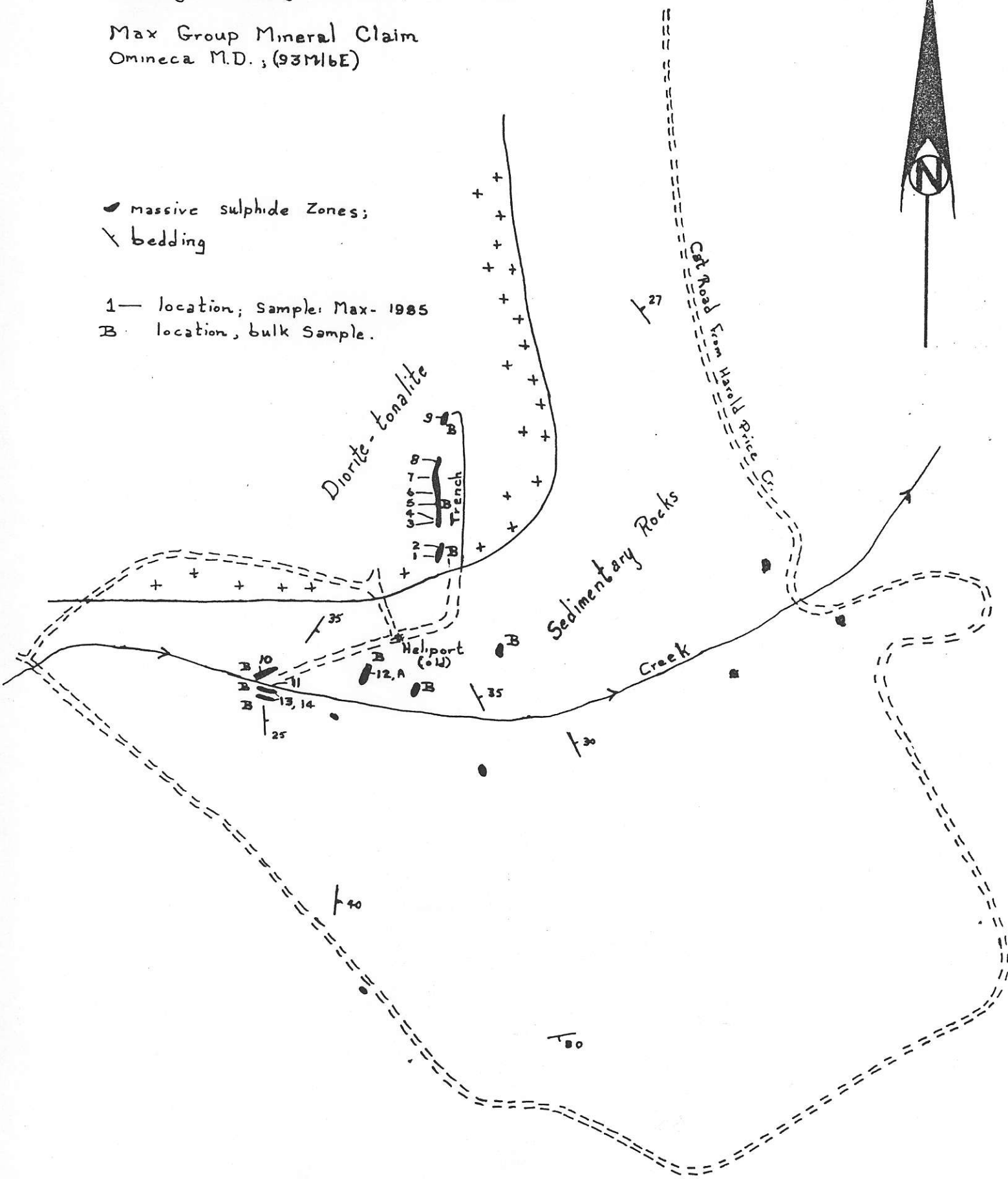

GEOCHEMICAL SAMPLING

Seventeen rock samples were collected from the various mineralized zones on the property to compare with samples collected by earlier workers. (See tables: Analysis 1985, Gold and Silver Assay and ICP, and table: Analysis 1977).

These samples showed significant values of silver, in association with lead, zinc, antimony, with lesser values in gold, arsenic and cadmium, and are similar to earlier reported values. Sample locations are shown on the accompanying sketch. Below is a sample description. Minerals present appear to be a sulphosalt (informally identified as jamesonite or boulangerite), sphalerite and pyrite, with lesser galena. Pyrrhotite, stibnite, marcasite and chalcopyrite have been reported. None of these accounts for the high silver values, ranging commonly from 10 to 70 oz./T. An unidentified silver mineral must be present in the mineral assemblage, and should be identified.

Sample Description

- Max 1. Disseminated pyrite (15%), minor sphalerite in argillic altered rock (Sediment).
- 2. Massive coarse grained pyrite and sulphosalt in highly weathered vein.
- 3. Gossan, deeply wathered, no sulphies present.
- 4. Sulphosalt needles laced through granular ankerite gangue, disseminated pyrite in argillic altered wall rock.
- 5A. Disseminations and blebs of sphalerite, pyrite and sulphosalt in gangue of ankerite and bleached rock.
- 5B. Bleached, pyritized wall rock.
- 6. Massive balck-jack sphalerite with sulphosalt in ankerite gangue.
- 7. Massive and fibrous sulphosalt, pyrite and sphalerite in ankérite gnague.

8. Gossan, completely weathered, no sulphides present.
9. Siderite and ankerite, thin sulphosalt seams.
10. Siderite and ankerite with massive sphalerite.
11. Massive banded sulphosalt, pyrite and ankerite.
- 11.5 Massive sulphosalt with minor pyrite and ankerite.
- 12A. Massive pyrite, sulphosalt with minor sphalerite, banded with ankerite.
- 12B. Massive sulphosalt and pyrite in ankerite.
13. Massive sulphosalt and pyrite in ankerite.
14. Massive pyrite, sphalerite, and sulphosalt in ankerite and argillic altered rock.