

675415
 Silence Lake
 82m/13

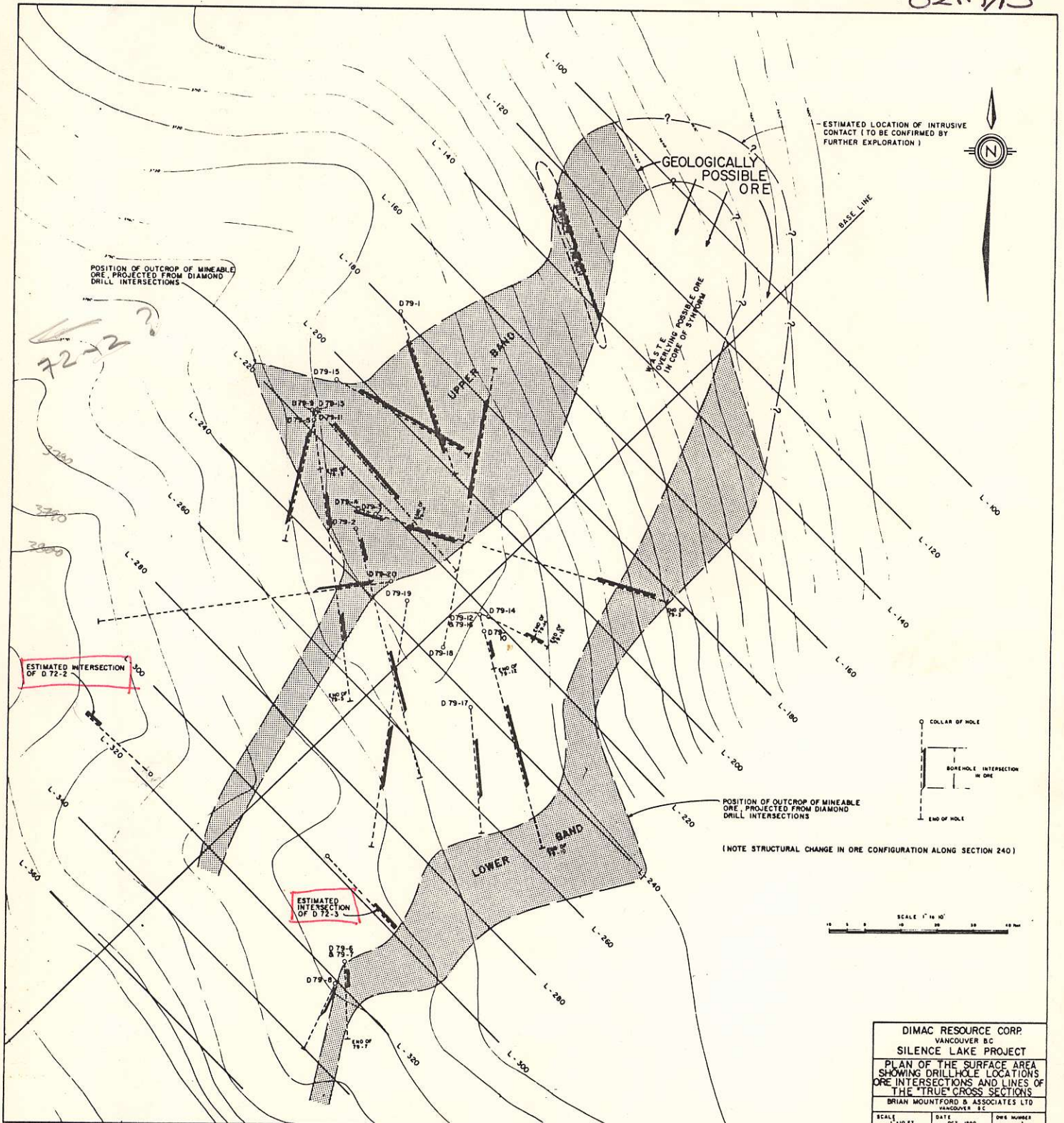

DIMAC RESOURCE CORP
 VANCOUVER BC
 SILENCE LAKE PROJECT
 PLAN OF THE SURFACE AREA
 SHOWING DRILLHOLE LOCATIONS
 ORE INTERSECTIONS AND LINES OF
 THE "TRUE" CROSS SECTIONS
 BRIAN MOUNTFORD & ASSOCIATES LTD
 VANCOUVER BC

SCALE	DATE	DWG NUMBER
1" = 10' FT	OCT. 1980	1

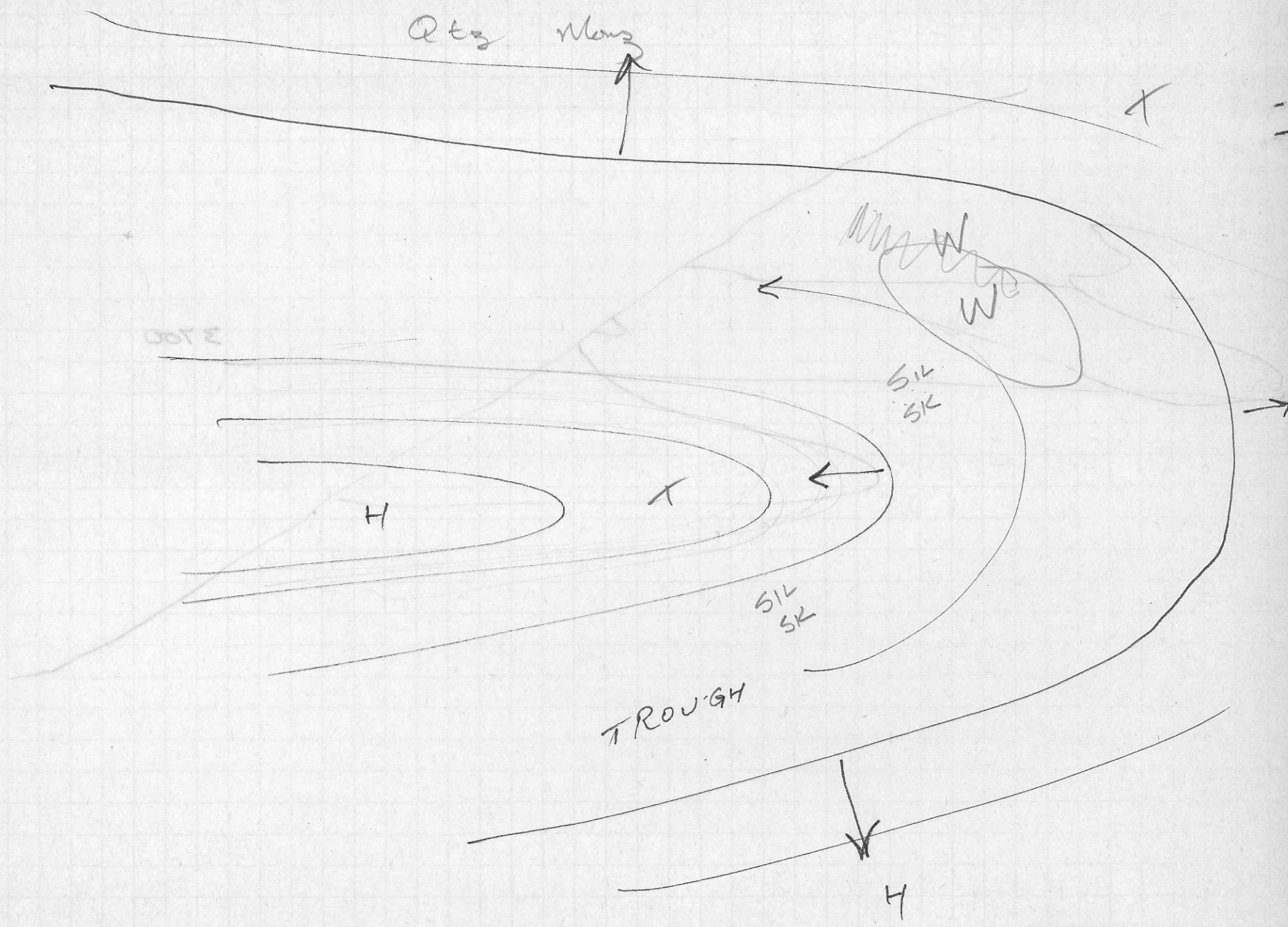

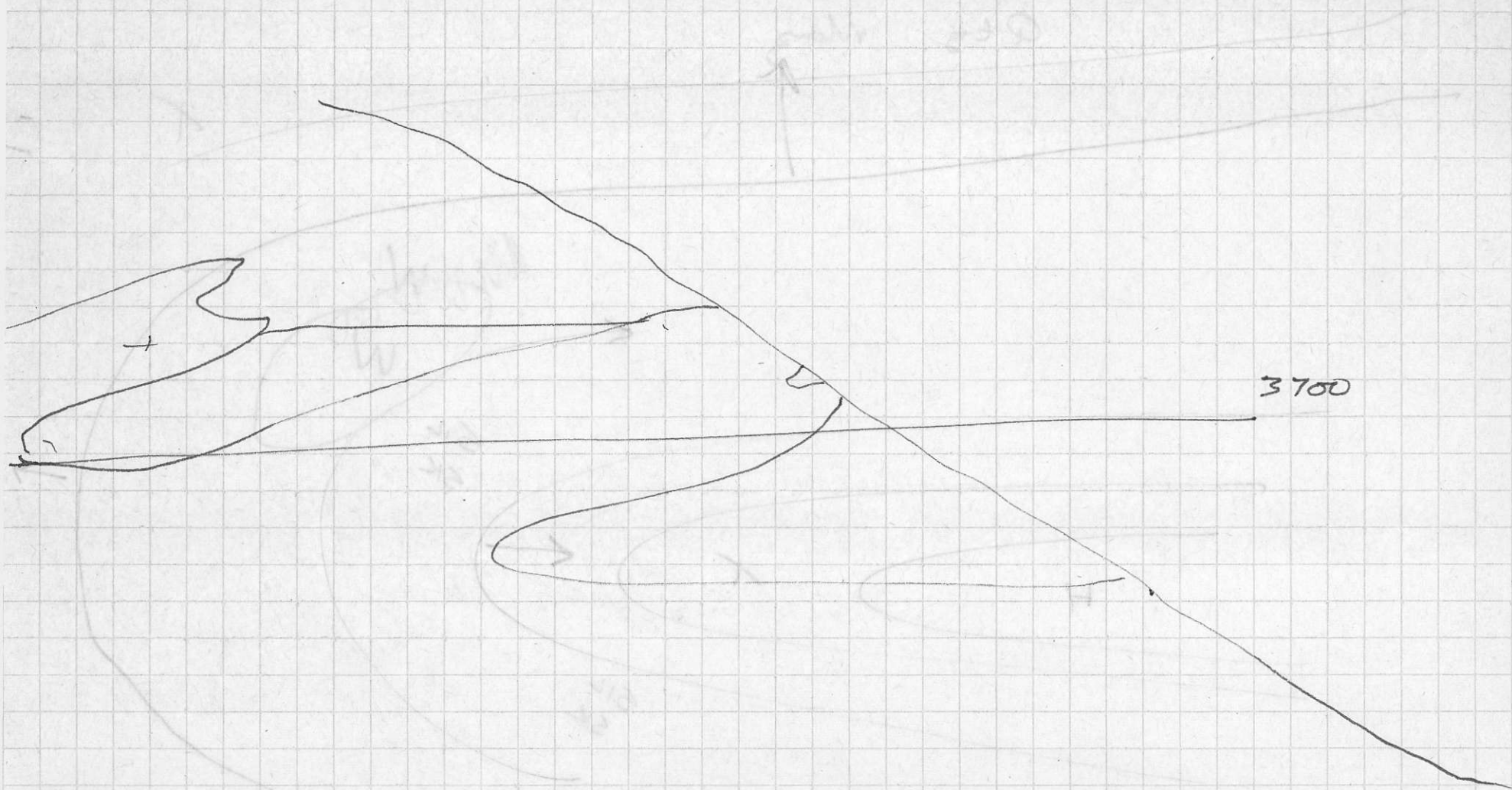

3700

ROUGH PLOT OF

SECTION ROUGHLY ALONG

L-300

DDH'S.
72-2, 3

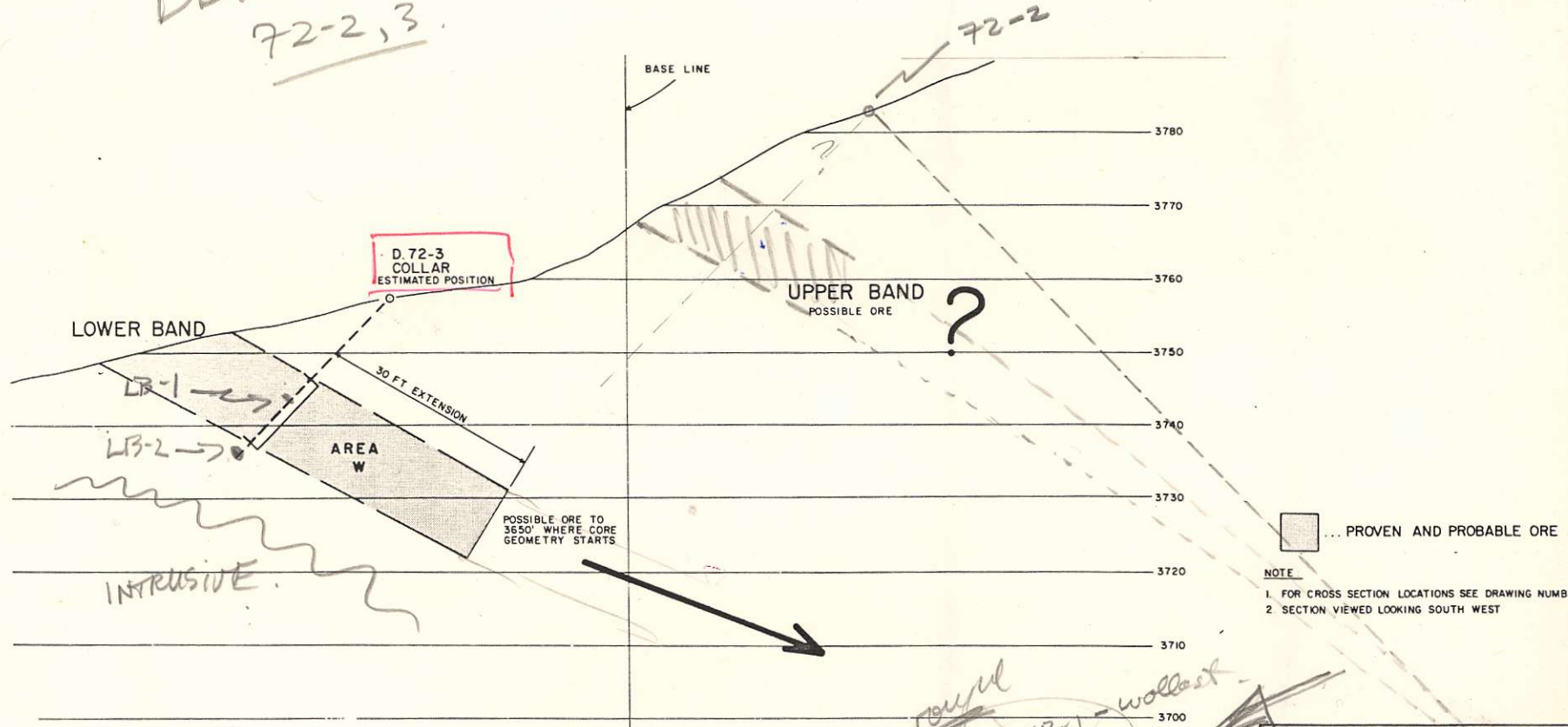

LOWER BAND

LB-1 →

LB-2 →

INTRUSIVE

D. 72-3
COLLAR
ESTIMATED POSITION

30 FT EXTENSION

AREA
W

POSSIBLE ORE TO
3650' WHERE CORE
GEOMETRY STARTS

BASE LINE

UPPER BAND
POSSIBLE ORE

?

72-2

3780

3770

3760

3750

3740

3730

3720

3710

3700

... PROVEN AND PROBABLE ORE

NOTE
1. FOR CROSS SECTION LOCATIONS SEE DRAWING NUMBER 3
2. SECTION VIEWED LOOKING SOUTH WEST

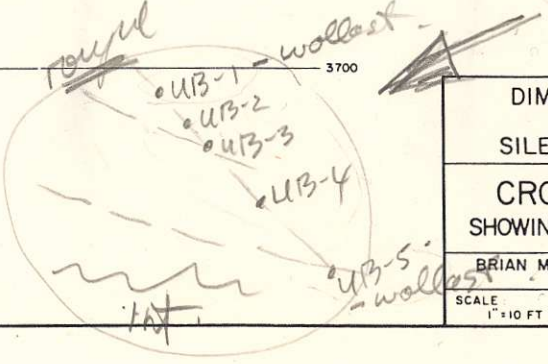

DIMAC RESOURCE CORP.
VANCOUVER B.C.
SILENCE LAKE PROJECT

CROSS SECTION 300
SHOWING MINEABLE ORE ZONES

BRIAN MOUNTFORD & ASSOCIATES LTD.
VANCOUVER B.C.

SCALE 1" = 10 FT DATE DWG NUMBER 11

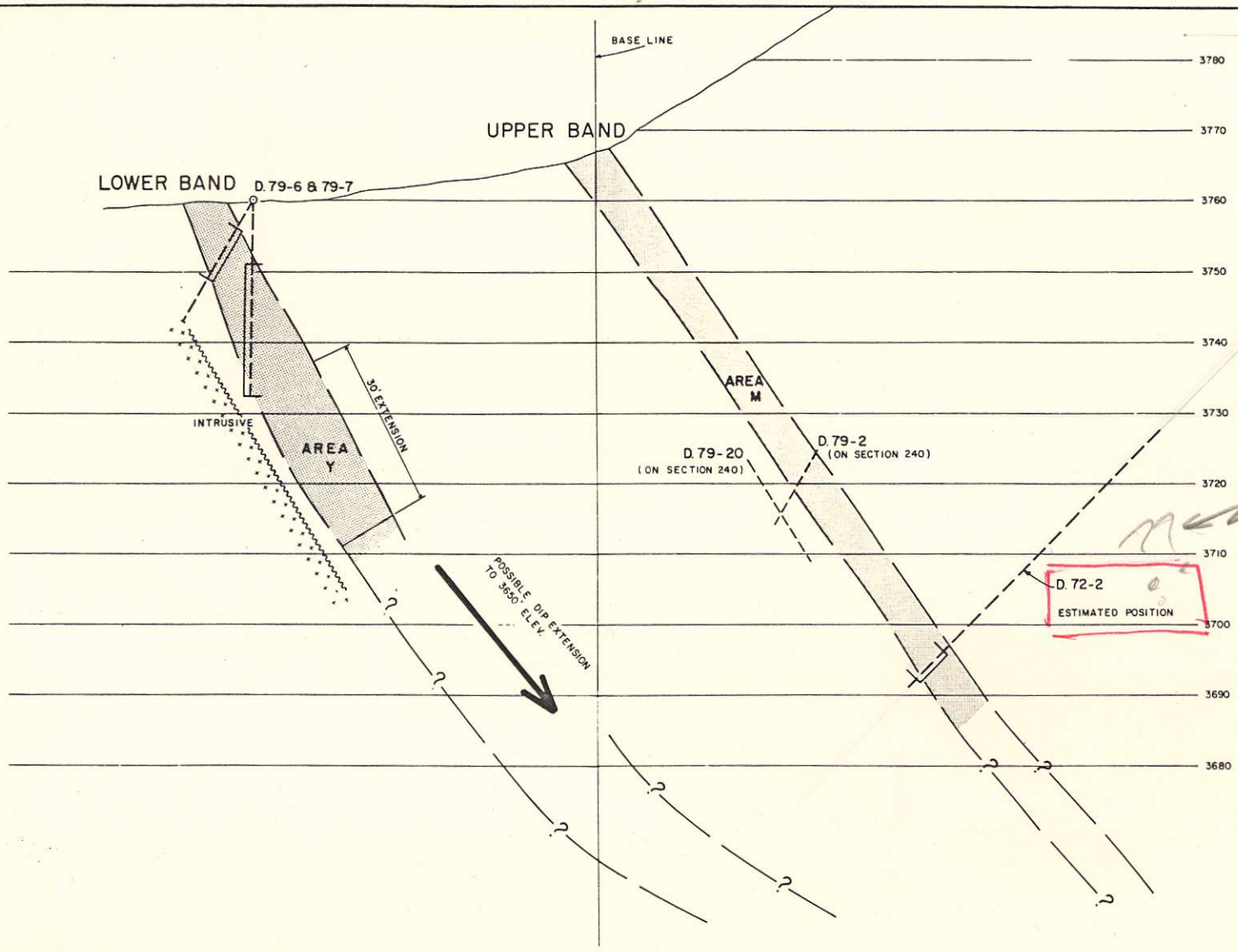

*seems to dip
wrong way - see
Draw #3*

... PROVEN AND PROBABLE ORE
 NOTE:
 1. FOR CROSS SECTION LOCATIONS SEE DRAWING NUMBER 3
 2. SECTION VIEWED LOOKING SOUTH WEST

DIMAC RESOURCE CORP. VANCOUVER BC SILENCE LAKE PROJECT		
CROSS SECTION 320 SHOWING MINEABLE ORE ZONES		
BRIAN MOUNTFORD & ASSOCIATES LTD. VANCOUVER BC		
SCALE 1" = 10 FT	DATE OCT, 1980	DWG NUMBER 12