

# Regional Resources Ltd.

720-800 W. Pender Street, Vancouver, B.C. V6C 2V6 (604) 684-2285 Telex 0451264

## NEWS

For Release: November 23, 1981

Contact: J. W. Stollery (604) 681-8381

*Colin: keep this available  
somewhere in your files*

### MIDWAY PROPERTY EXPLORATION RESULTS

Assay results have been compiled from surface trenches and 2,800 feet of drilling in 6 holes on the MIDWAY silver-lead-zinc (Ag-Pb-Zn) massive sulphide prospect 60 miles west of Watson Lake, Y.T.

Trench assays along a strike length of 120 feet of the Discovery zone showing yielded an average grade of 5.23% Pb-Zn and 1.4 oz/ton Ag over an average width of 5 feet.

Drilling results in the accompanying table and plan show that the Discovery zone has a true width of 15 to 36 feet grading up to 9.29% Pb-Zn and 2.52 oz/ton Ag. The Upper zone has similar grades over widths to 9 feet. The Lower zone varies from 3 to 7 feet wide, and in hole 3 grades 15.24% Pb-Zn and 14.14 oz/ton Ag over 7 feet. The intersections exhibit remarkably consistent silver values. Grades and widths suggest that an economic mineral deposit may exist. All zones are open to extension and additional zones probably occur.

Geochemical and geophysical anomalies indicate excellent potential to increase the deposit by several fold. Trenching has uncovered similar geology and mineralization one mile to the south. At least two other areas within the 85 square mile property have comparable characteristics.

Further exploration, including a substantial drilling program, will be undertaken in 1982 at a cost of up to \$2M.

The MIDWAY property, discovered in 1980 by Cordilleran Engineering on behalf of the Company, is under option to AMAX of Canada Limited. By 1984 AMAX will have earned a 60% interest after expending \$4M on exploration, paying the Company \$3.2M cash and granting the Company a 4% Net Smelter Return. In 1981 over \$1M was expended on exploration and \$200,000 were received in payments.

Regional Resources is listed on the Vancouver Stock Exchange under the symbol RGL.

Submitted on behalf of  
the Board of Directors

*John W. Stollery*  
John W. Stollery, P.Eng.  
Director

## MIDWAY PROPERTY

## SUMMARY OF DIAMOND DRILL RESULTS

	(feet) FROM - TO	INTERCEPT	TRUE WIDTH	% Pb	% Zn	Comb % Pb-Zn	oz/Ton Ag
<b>DDH MW 81-1</b>							
UPPER ZONE	110.6-115.8'	5.2'	4.8'	0.39	2.71	3.10	0.63
DISCOVERY ZONE	160.1-176.2'	16.1'	15.1'	0.36	6.98	7.34	1.83
	<u>or</u> 167.7-176.2'	8.5'	8.0'	0.36	9.69	10.05	2.00
LOWER ZONE	406.0-410.0'	4.0'	3.8'	3.62	6.24	9.86	4.38
<b>DDH MW 81-2</b>							
UPPER ZONE	159.0-160.4'	1.4'	1.3'	1.40	1.22	2.62	0.90
DISCOVERY ZONE	212.0-229.5'	17.5'	17.3'	1.05	3.51	4.56	2.89
	<u>or</u> 218.9-229.5'	10.6'	10.5'	1.07	5.11	6.18	3.06
LOWER ZONE	465.9-469.0'	3.1'	2.9'	1.70	3.02	4.72	2.91
<b>DDH MW 81-3</b>							
UPPER ZONE	145.1-154.7'	9.6'	9.2'	1.25	4.24	5.48	1.61
DISCOVERY ZONE	206.6-243.3'	36.7'	36.4'	1.49	4.52	6.01	2.02
	<u>or</u> 224.5-243.3'	18.8'	18.6'	2.58	6.29	8.87	2.85
<del>LOWER ZONE</del>	<del>373.1-381.1'</del>	<del>8.0'</del>	<del>7.7'</del>	<del>10.32</del>	<del>4.92</del>	<del>15.24</del>	<del>14.14</del>
	<del><u>or</u> 373.1-377.8'</del>	<del>4.7'</del>	<del>4.5'</del>	<del>16.48</del>	<del>6.91</del>	<del>23.39</del>	<del>22.59</del>
<b>DDH MW 81-4</b>							
UPPER ZONE	193.9-195.9'	2.0'	1.9'	0.45	12.70	13.15	1.78
DISCOVERY ZONE	257.2-275.6'	18.4'	17.7'	1.13	5.99	7.12	2.63
	<u>or</u> 267.4-275.6'	8.2'	7.9'	2.08	10.15	12.23	5.03
LOWER ZONE	N o L o w e r Z o n e						
<b>DDH MW 81-5</b>							
UPPER ZONE	117.1-123.0'	5.9'	5.6'	0.97	5.31	6.28	1.86
DISCOVERY ZONE	192.1-215.3'	23.2'	22.2'	0.67	8.62	9.29	2.52
	<u>or</u> 195.1-206.1'	11.0'	10.5'	1.14	12.22	13.36	3.97
LOWER ZONE	386.6-390.9'	4.3'	4.0'	0.84	1.81	2.65	1.24
<b>DDH MW 81-6</b>							
UPPER ZONE	230.4-241.1'	10.7'	10.4'	1.28	2.96	4.24	2.29
	<u>or</u> 234.7-237.9'	3.2'	3.0'	3.42	8.19	11.61	6.52
DISCOVERY ZONE	264.6-279.7'	15.1'	14.7'	0.42	1.64	2.06	1.26
LOWER ZONE	N o L o w e r Z o n e						

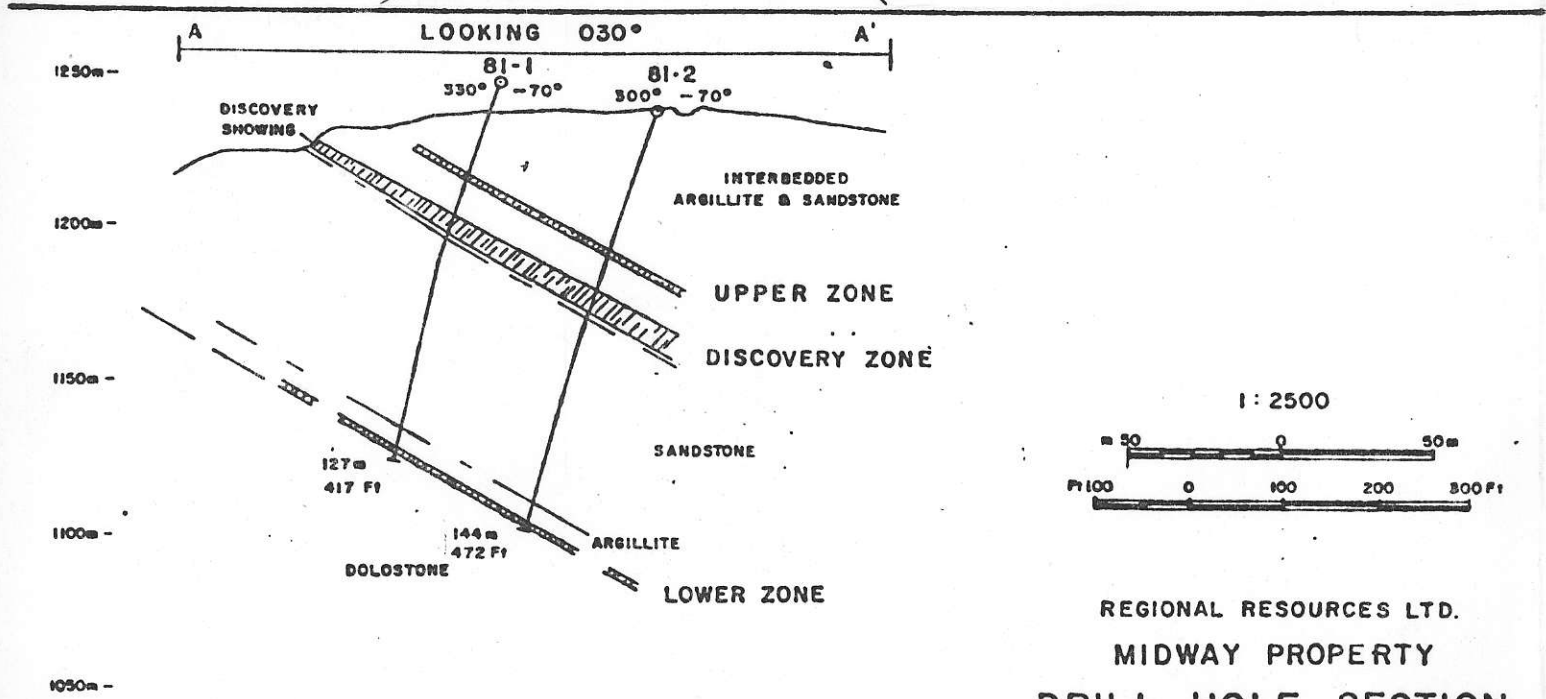
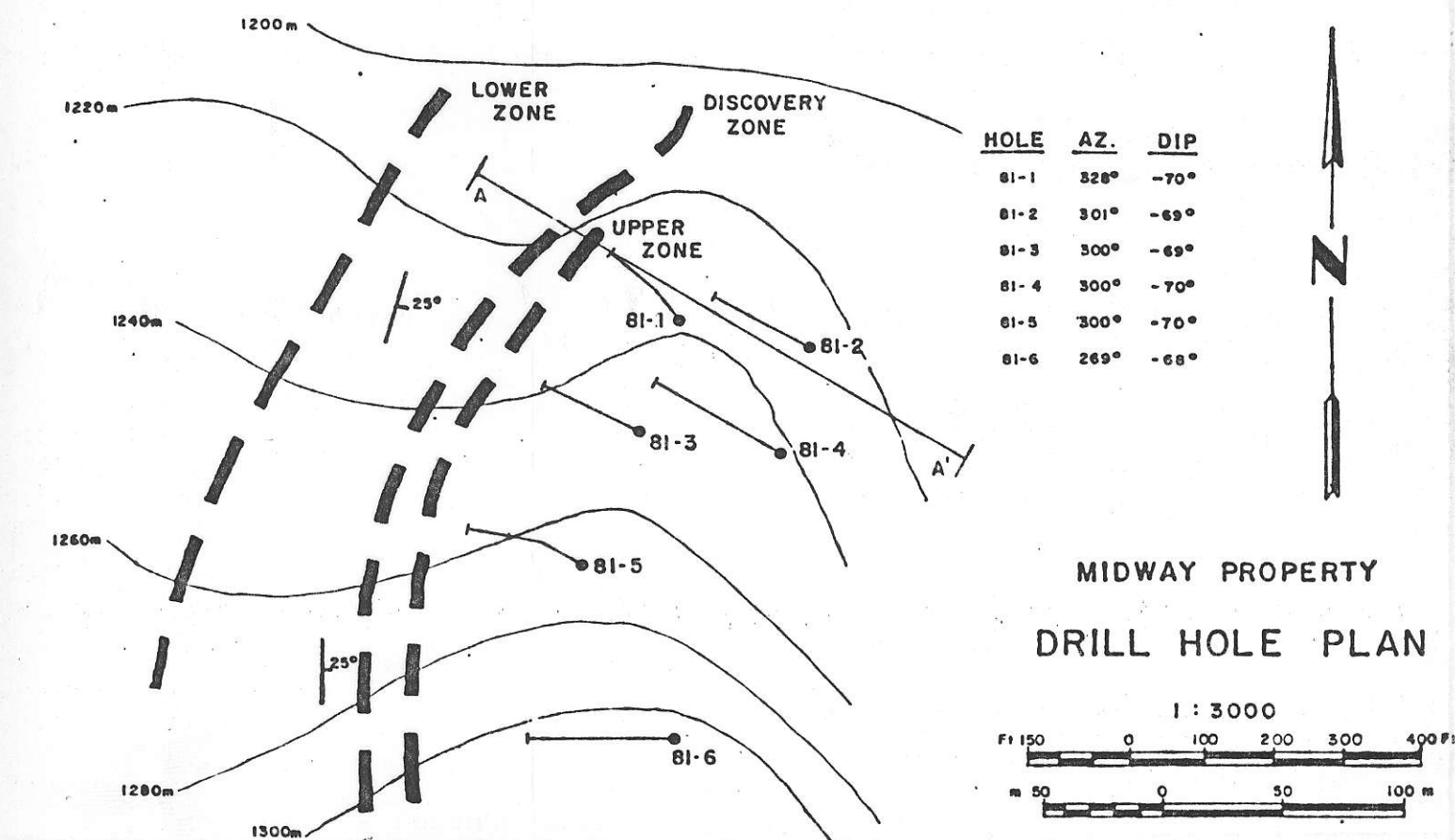
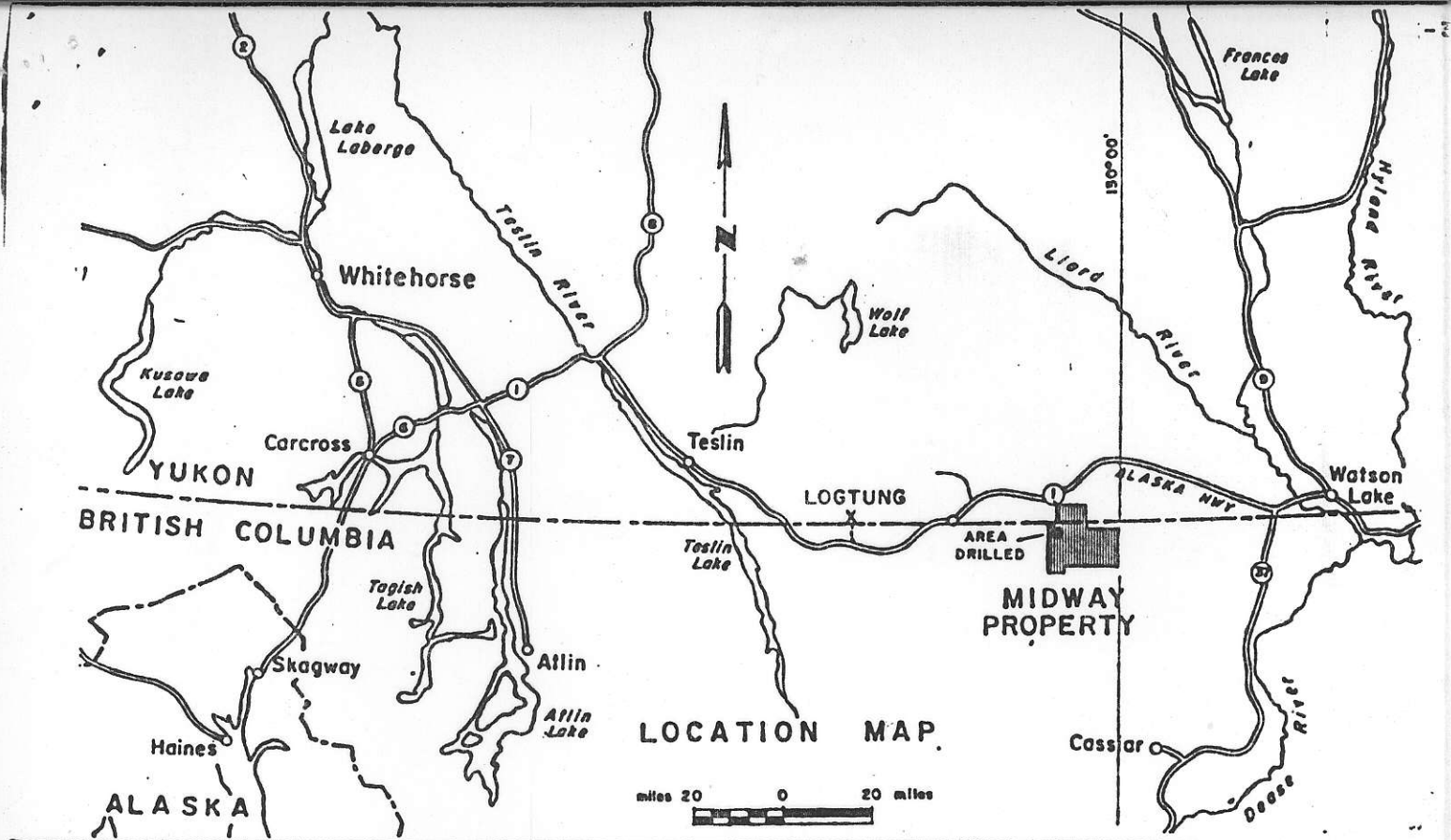

REGIONAL RESOURCES LTD.  
MIDWAY PROPERTY  
DRILL HOLE SECTION  
BY  
CORDILLERAN ENGINEERING  
NOV. 23 1981