

Silver Bell Tunnel

6150 elev.

18.1 15.6 2.1  
2.0

78°

80°

75°

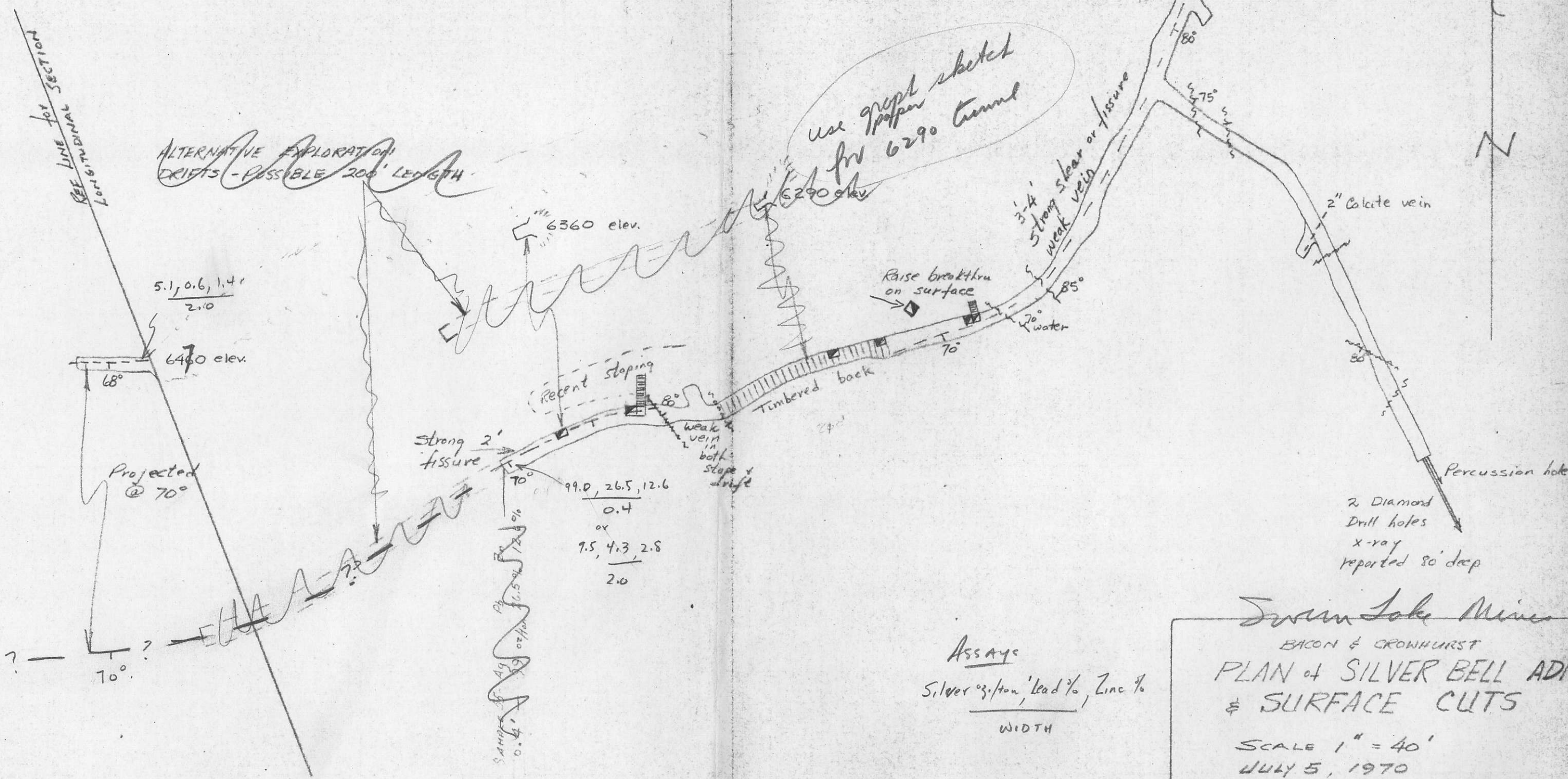

ALTERNATIVE EXPLORATION DRIFTS - POSSIBLE 200' LENGTH

5.1, 0.6, 1.4  
2.0

6400 elev.

68°

Projected @ 70°

70°

6360 elev.

6290 elev.

use drift sketched for 6290 tunnel

Raise breakthru on surface

3-4' strong shear or fissure weak vein

85°

70° water

Recent stoping

Timbered back

Strong 2' fissure

70°

99.0, 26.5, 12.6

0.4

or 7.5, 4.3, 2.8

2.0

Sample 49  
0.4%

Assays  
Silver %/ton, Lead %, Zinc %  
WIDTH

Silver Lake Mines  
BACON & CROWHURST  
PLAN of SILVER BELL ADIT & SURFACE CUTS

SCALE 1" = 40'

JULY 5, 1970

d.V.M. Additions by C. Campbell Sept 16, 1970.

674456

Fig 4