

N.B.C. Syndicate

PROPOSAL FOR SPECIFIC PROJECT
TEZZERON

674394

LIST OF ILLUSTRATIONS

<u>Figure</u>	<u>Title</u>	<u>Scale</u>
I	Index Map	1" - 20 miles
II	FAR Claim Group Silt Sample Results	1" - 1000'
III	TEZ Group Magnetometer Survey	1 - 200'
IV	TEZ Group VHEM Survey	1" - 200'
V	TEZ Group SE-600 Dip Angle Survey	1" - 200'
VI	HAT Group Magnetometer Readings and Geochemistry	1" - 200'

SPECIFIC PROJECT TEZZERON

Introduction:

Three claim groups were staked by the Syndicate in the Tezzeron Creek - Chuchi Lake area, where indications of copper mineralization and/or interesting geophysical results were obtained. See Figure I.

The claims lie in relatively flat, heavily drift covered areas. Access is by helicopter to two of these claim groups and by fixed wing aircraft to the third.

No outcrop has been found on two of the claim groups, while limited exposures on the third indicate a basic intrusive cutting sediments and volcanics and showing minor sulphide mineralization.

Description of Claim Groups:

FAR CLAIM GROUP - Figure II

Twenty claims cover the location of the former CAB and LIN claim groups explored by West Coast Mining and Exploration.

The FAR group covers two separate aeromagnetic highs. The more northerly appears to be completely covered by glacial drift. Soil samples taken at intervals across the width of the anomaly, gave only very low values for copper.

On the southern anomaly a limited picket line grid had been cut during a winter program. This appears to have covered an area of approximately 1000' x 1500', although other blazed lines occur beyond this grid and may be part of a larger grid cut at an earlier date.

Sites for two drill holes were found as shown in Figure II. Core from these holes was not seen by J.C. Stephen, but was located by a helper, who brought out two specimens. These specimens show considerable magnetite and minor pyrite and chalcopyrite.

Silt sampling in the area indicates the two creeks flowing across the magnetic anomaly, have an anomalous copper content. Significant values were found for 1000 feet upstream from the drill sites as shown on Figure I. Five other samples from these two creeks, also upstream from the drill sites, but which cannot be accurately plotted, ran from 114 to 180 ppm copper.

It is proposed that a camp be established this winter on the lake east of the claim group and a picket line grid be cut with lines at 400 foot intervals as shown on figure II. A magnetometer and EM survey should be carried out on these lines during the winter.

If the initial winter program should not provide definite drill targets, IP surveying should be considered and during the summer of 1969, limited soil sampling should be carried out by digging pits on the flanks of drumlins and ridges to expose the 'B' horizon. The apparently deep and extensive drift cover indicates that routine soil sampling would probably be of little value

Cost Estimate:

For 12 miles picket line, plus EM and magnetometer surveys.

<u>Labour</u> - 5 men @ \$25/day for 15 days	\$1875
<u>Food & Camp</u> - 5 men @ \$4 for 15 days	300
<u>Power Saw Charge</u> -	250
<u>Aircraft</u> - Fixed wing 6 hours @ \$80	480
<u>Mobilization & Transportation etc.</u> -	445
<u>Instrument Rental</u> - EM and Magnetometer -	<u>350</u>
	\$3700
<u>Contingencies</u> - 10%	<u>400</u>
	\$4100

The only practical means of access is by fixed wing aircraft or by helicopter.

TEZ CLAIM GROUP

Thirty claims cover an aeromagnetic anomaly near the headwaters of Tezzeron Creek. Near the southern extremity of this anomaly a sharp magnetic peak was located and extending northerly from this peak are a number of conductive zones indicated by EM survey. See Figures III, IV, & V.

The whole of the area of the aeromagnetic anomaly is covered by glacial drift. This appears to be deep - 40 feet or more in the area surveyed. Routine soil and silt samples were field tested only. No anomalous areas were indicated. A few fragments of volcanic rock containing minor pyrrhotite and chalcopyrite were found.

The geophysical results are interpreted as indicating a basic intrusive, or basic volcanic flows. They may be similar to volcanic rocks southeast of Witch Lake which contain pyrrhotite and chalcopyrite mineralization.

The EM results suggest that sulphide mineralization may be concentrated in these zones sufficiently to produce conductive bodies.

No immediate program is suggested. If IP surveys are to be carried out later on either the FAR or HAT groups, then IP should be done here as well, to further confirm the EM results.

The results so far obtained should be considered as indicating a possible drill target. Drilling should be planned in conjunction with work on the HAT and FAR groups.

For drilling purposes, access may be obtained either by helicopter to swamp areas at the north end of the picket line grid, or by cat trail approximately $2\frac{1}{2}$ miles long, to be constructed from the Manson Creek road.

HAT CLAIM GROUP

Forty-four claims cover a poorly delineated aeromagnetic anomaly on Hatdudatehl Creek. See Figure VI.

Ground investigation of this anomaly located an outcrop area containing minor pyrite, pyrrhotite and chalcopyrite mineralization. Some 24 special pits dug in the vicinity, exposed the 'B' soil horizon and a number of the soil samples taken gave anomalous values for copper. None of the soil samples taken in various other areas by routine methods at depths of 6" to 12", gave anomalous values.

There are indications of an EM anomaly in the swamp and creek area southwest of the mineralized outcrops. A picket line grid was started to the northwest on high ground, but anomalous readings were not obtained in that area.

It is proposed that a program of line cutting, magnetometer and EM surveying be carried out on these claims during the winter. The extent of part of the proposed program is indicated on Figure V. In addition the base line should be extended to the eastern limit of the claims and the magnetometer survey should be extended to cover the whole of the aeromagnetic anomaly on lines at 800 foot intervals.

Cost Estimate:

For 25 miles picket line plus EM and magnetometer surveys.

<u>Labour</u> - 5 men @ \$25/day for 25 days	\$3150
<u>Food & Camp</u> - 2 large tents @ \$185 = \$370	
5 men @ \$4 x 25 days = \$500	
Misc. supplies =	<u>\$130</u>
	1000
<u>Power Saw Charges</u> -	450
<u>Aircraft</u> - Helicopter 6 hours @ \$140	840
<u>Instrument Rental</u> - EM & magnetometer	700
<u>Mobilization & Transportation etc.</u> -	<u>560</u>
	\$6700
<u>Contingencies</u> - 10%	<u>700</u>
	\$7400

The only practical means of access at present is by helicopter.

Summary:

Three claim groups have been staked on aeromagnetic anomalies. Very little is known of the geology, but geophysical work is proposed on the HAT and FAR groups to provide information comparable with that available for the TEZ group. This initial program will require approximately 37 miles of line cutting, EM and magnetometer surveying at an estimated total cost of \$11,500.

Possible follow up programs of I.P. surveying and diamond drilling, should be considered after completion of this initial program.



N.B.C. SYNDICATE
 INDEX MAP OF
 PROSPECTING AREAS 1968

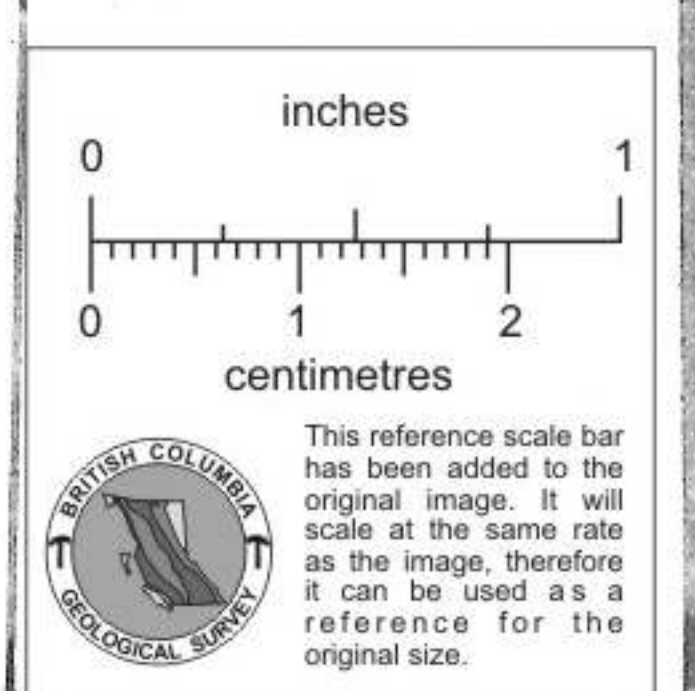

1" = 20 MILES
 DEC 1968

FIGURE 1

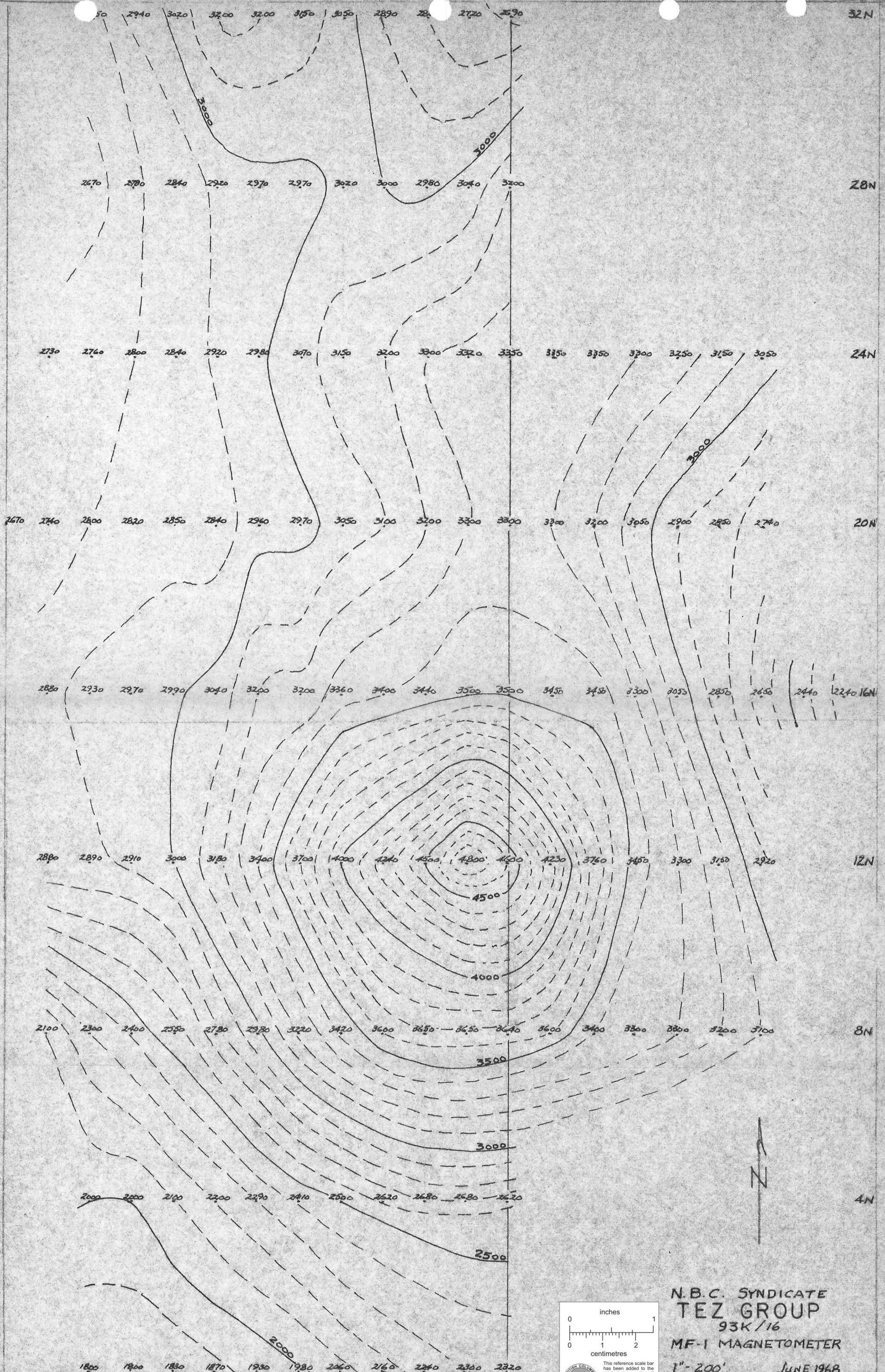

N.B.C. SYNDICATE
 TEZ GROUP
 93K/16
 MF-1 MAGNETOMETER
 1" = 200' JUNE 1968
 OPERATOR - R. SMITH

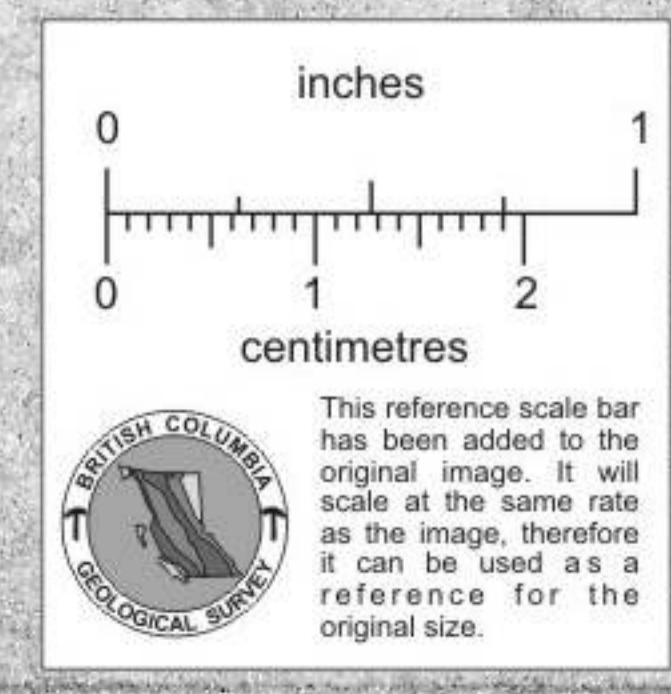
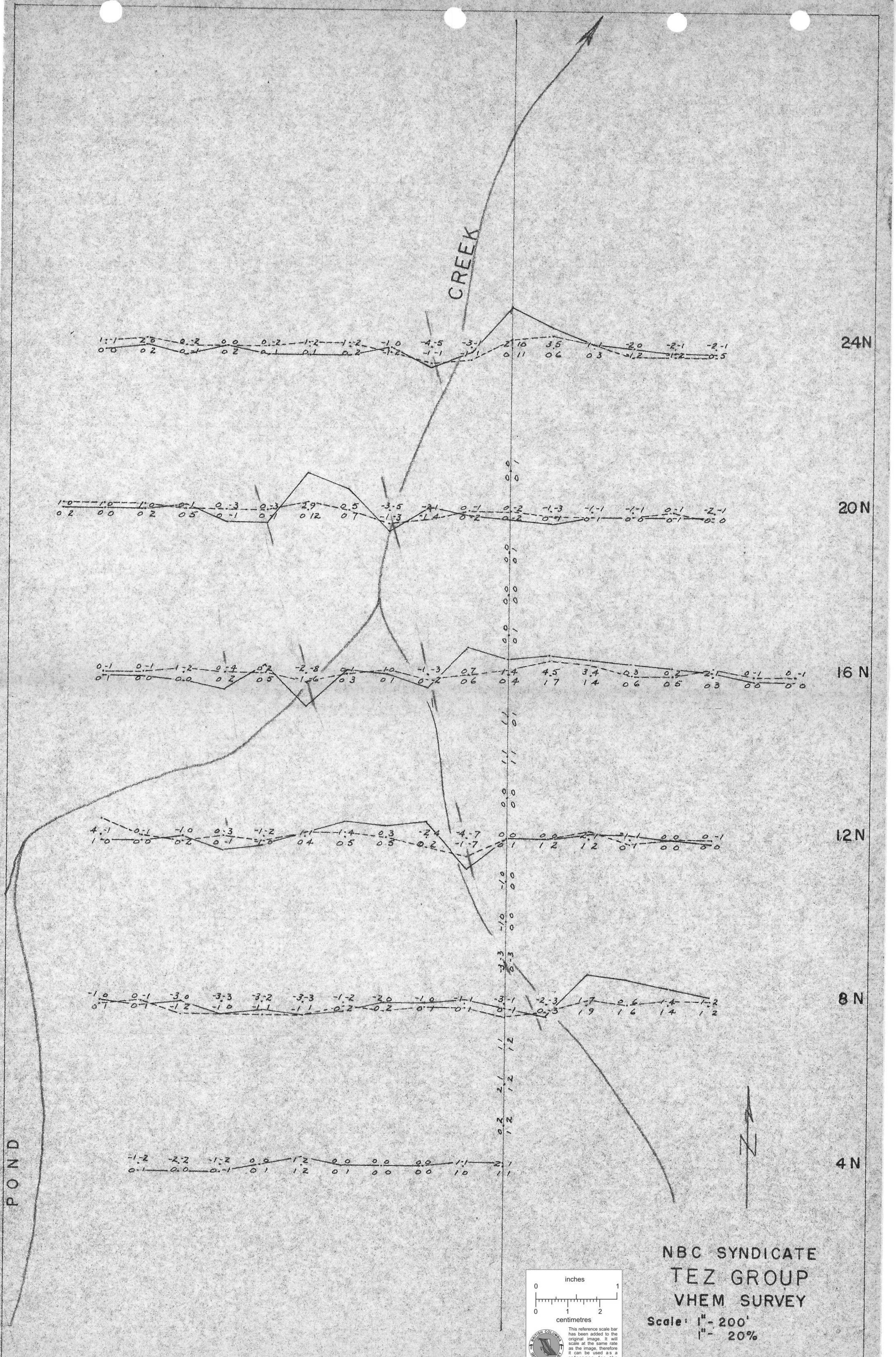

FIGURE III



1.1 2.8 0.2 0.0 0.2 1.2 1.2 1.0 4.5 3.1 2.10 3.5 1.1 2.0 2.1 2.1
 0.0 0.2 0.2 0.2 0.1 0.1 0.2 1.2 1.1 1.1 0.11 0.6 0.3 1.2 1.2 0.5

1.0 1.0 1.0 0.1 0.3 0.3 2.9 0.5 3.5 2.1 0.7 0.2 1.3 1.1 1.1 0.1 2.1
 0.2 0.0 0.2 0.5 0.1 0.1 0.12 0.7 1.3 1.4 0.2 0.2 0.4 0.1 0.5 0.1 0.0

0.1 0.1 1.2 0.4 0.2 2.8 0.1 1.0 1.3 0.7 1.4 4.5 3.4 0.3 0.2 2.1 0.1 0.1
 0.1 0.0 0.0 0.2 0.5 1.6 0.3 0.1 0.2 0.6 0.4 1.7 1.4 0.6 0.5 0.3 0.0 0.0

4.1 0.1 1.0 0.3 1.2 1.1 1.4 0.3 2.4 4.7 0.0 0.0 2.1 2.1 0.0 0.1
 1.0 0.0 0.2 0.1 1.0 0.4 0.5 0.5 0.2 1.7 0.1 1.2 1.2 0.1 0.0 0.0

1.0 0.1 3.0 3.3 3.2 3.3 1.2 2.0 1.0 1.1 3.1 2.3 1.7 0.6 1.4 1.2
 0.7 0.7 1.2 1.0 1.1 1.1 0.2 0.2 0.7 0.1 0.1 0.3 1.9 1.6 1.4 1.2

1.2 2.2 1.2 0.0 1.2 0.0 0.0 0.0 1.1 2.1
 0.1 0.0 0.1 0.1 1.2 0.1 0.0 0.0 1.0 1.1

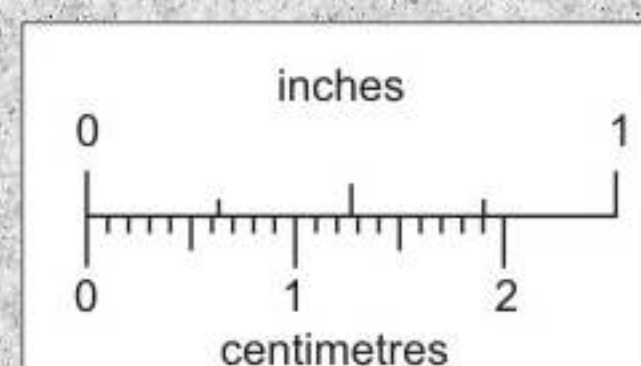

This reference scale bar has been added to the original image. It will scale at the same rate as the image, therefore it can be used as a reference for the original size.

NBC SYNDICATE
 TEZ GROUP
 VHEM SURVEY
 Scale: 1" = 200'
 1" = 20%

93K-16

FIGURE IV

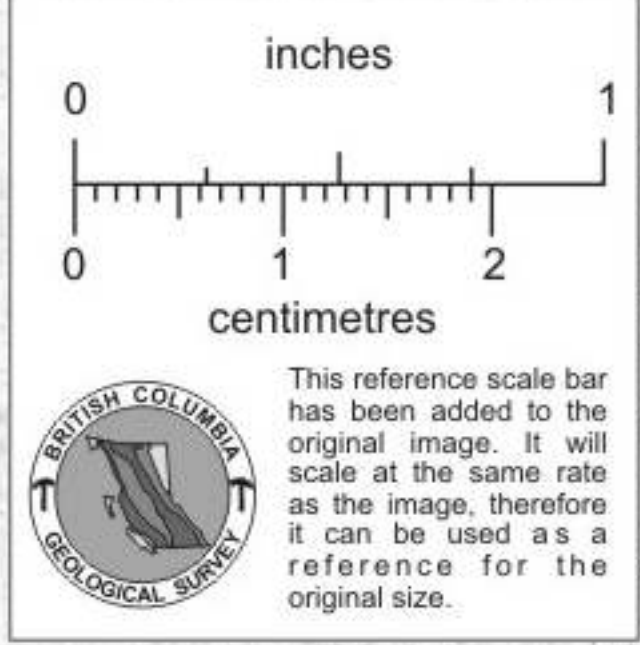
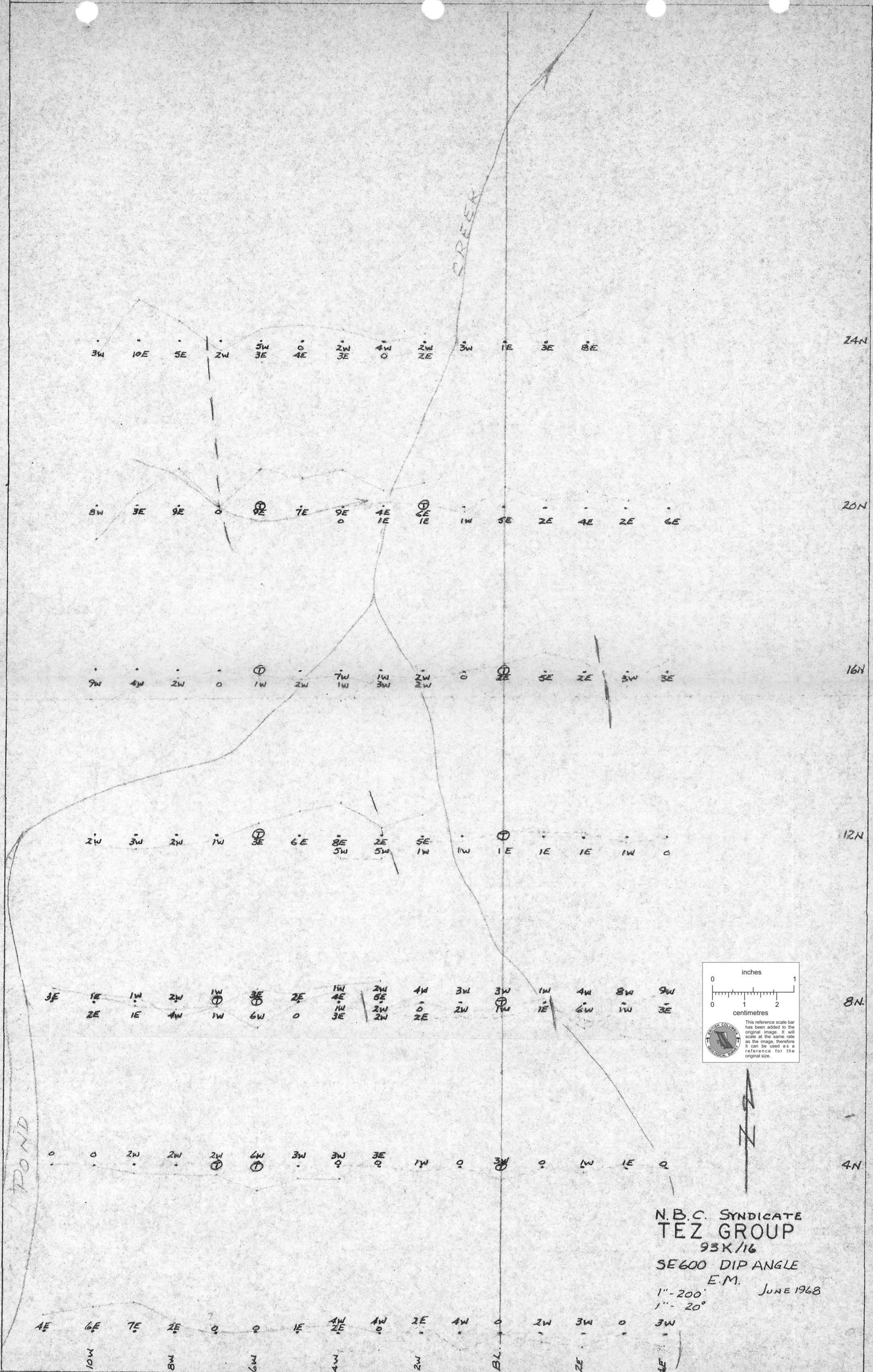

N.B.C. SYNDICATE
 TEZ GROUP
 93K/16
 SE600 DIP ANGLE
 E.M.
 1" = 200'
 1" = 20' JUNE 1968

FIGURE V