

□ - located claim posts

1) Final Post 529369
Ax 3 A.H. Grant
Sept 25 1968

2) Initial post 529366, 65
560°W Ax 29, 23
R, L
Final post 529363, 364
Ax 21, 22
L, R
Grant Sept 25/68

--- 'cat' trails



674305

□ - located claim posts

i) Final Post 529369
Ax 3 A.H. Grant
Sept 25 1968

ii) Initial post 529366, 65
560°W Ax 29, 23
R L

Final post 529363, 364
Ax 21, 22
L R
Grant Sept 25/68

--- 'cat' trails

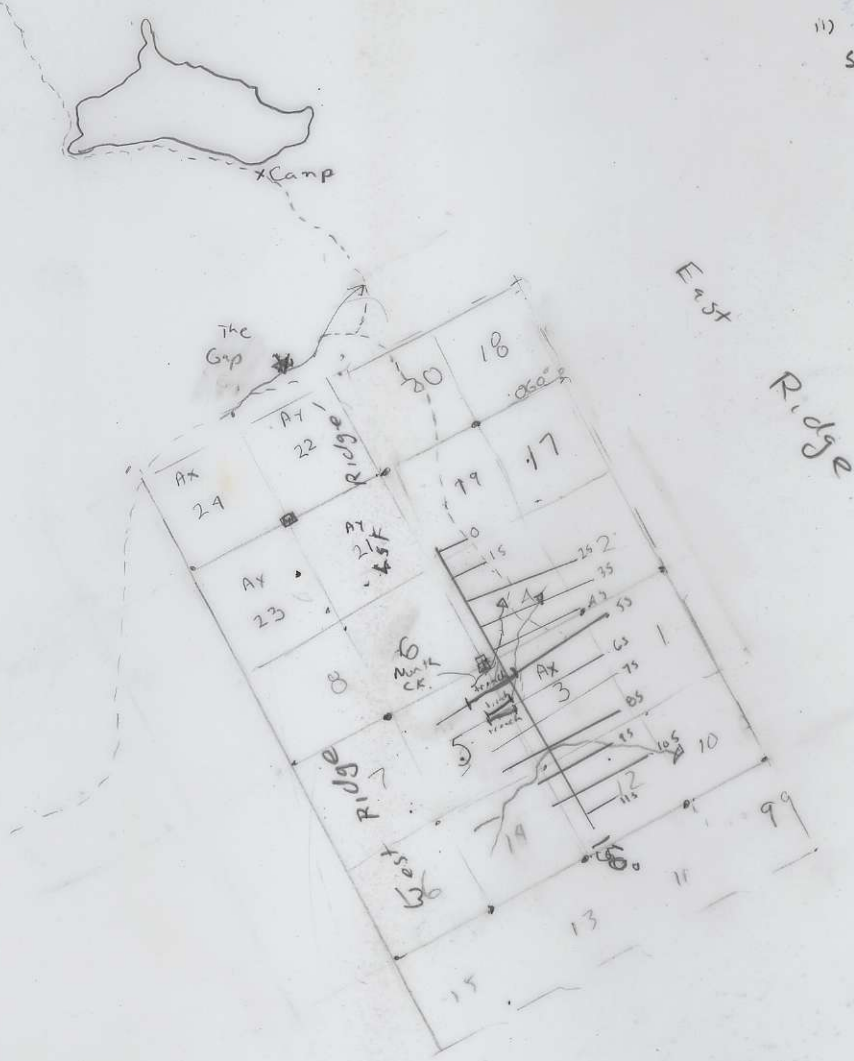

A_{AN}

Interred Location
of 'Ax' Claims

104 P II 5731-130

'Old Grid' Target

Heagy + Lawton

CASAU

August 1983

Overlay #2

674305

40°
60°
grey lst

gy
lst.

Lake
Camp

lst

lst

83 CT 205

83 CT
202

83CAX08

Sandy
lst

0.737968
0.83CAX03

tan sil lst
mat, 27, 29

0.737978

resistant
knob sil lst
+ 27, 29
Ca sil.

83CAX09
878008

buff
ss
to tan
dolo + sil

gy
lst

0.83CAX11

no
OL
2-cc-
epy - sil. flt.

32999C

Lower
Ca-Ba showing in ck.

32950C
737995
0.737978
0.737988

upper
Cal sil
in ck.

Trenches
silicified + veined
lst of bands Ca min.

no
OL
min
flt in ck

83CAX10

83CAX16

83CT201

N.B. - thinner
bedded than
West Ridge lst
may
be different
unit.

wt-weathering
lst

83
CS-G201

Lithology

- resistant, thick-bedded grey limestone, locally sandy beds
- tan, gravelly weathering, tan to black grey mottled (algal mats?) dolomite and x-titline dolomite (after lst?)
- grey blocky quartz arenite.

83 CT-G
206

83CAX11

yw or stained lst

83CAX15
83CAX14

tan dolomite
83CAX12
83CAX13

100' grey sandstone

83 CT-G
207

dolo, ss,
siltstone?

"Old Grid"
BC 5731-130
Aug 13-16/83
Heagy + Lawton
104 P/11
C AS AU

N
T
N

1" = 1/2 mi

1-30

BC 5731-130
104 P/11
C AS AU