

June 2nd / 73 Saturday J. SHEARER
CAMP CHARLIE

N. of old Fort Mtn

(7)

N. of cities Service 30 claims

Air Photo # - BC 1596:16 +

- Largest Lake

① - clcp overlooking Hook Lake

- Rhyolite - Fp phenocrysts

+ Rhy (speckled)

speckled Rhy is up the slope

from Rhy ↓ Fp phenocrysts

CAMP #1
674213

(Fp porph)

② Intensive Rhyolite Breccia

frag of Rhyolite

same as behind LK.

73-5-6-2-3

③ at bottom of hump
- massive Rhy

④ Tuff Breccia

73-5-6-2-4

⑤ almost at top of big hill
Andesite - Tuff - Breccia

Attitude of Tuff bed

007/45° W

- green Andesite on top of
- Tuff
- Hbl Andesite
- Volc Brx

⑥ - Angular block Andesite
Basalt?
at Top of Hill

73-5-6-2-⑨

⑦ Rhy at bottom of Hump,
V, (massive) light

⑧ Green Rhy apple green

73-5-6-2-⑩

⑨ Rhy - heavily stained
brown

just before final descent
to swamp's of large Ridge
near Big Lake,
+ Rhy Brx

June 2nd/73

V. SHEARER
CAMP CHARLIE

(10) on Big hump N of Big (8)

- Tuff at bottom
- Red Tuff - same as (5)
Large Block of Float?

(11) Tuff Bed at Top of Big Hill

320 / vert. poor exposure
No contact seen

Border on the N by a
sugary Tex Vg (Rhy)

CAMP #1

(12) along ridge to w
Vg Rhy porph cream/white

(13) 400' w of swamp before Big Ridge

Rhy Brx. red frags in
Rhy mtx with Q + F p phenos.

(14) Amyg And heading west from
Float? 13

(15) Another step of
Hungry And
500' 330° away from 14

(16) Red - Hungry - Tuff?
300' 330° from 15

(17) Tuff Bed
350°/vert? poor exposure
Near Lake

(18) Large Hill before LK
Red Tuff. large step

(19) outlet of #3 LK
- Rhy Porph - ^{other end of} _{Ang Fract} FP porph Bx
+ FP porph Bx large step

(20) Ridge on w side of LK
FP porph Bx
+ Rhy porph on inside

June 2nd/73 Saturday J. SHEARER
CAMP Charlie

(21) right on Large ^{part of} Swamp N-S
Tuff Breccia small step
+ Rhuy V₁ float?

June 1st 1973 Friday 6

checking out Andesite otcop.

Air photo # — BC 1596 — 49 + 50

① Large otcop of V_1

- Fine grained green Andesite forms the wall of Creek
- No mineralization - completely Barren

otcps plotted on Air photo.

claim line trending E.W. crosses creek just above CT 15

Float in creek — ss containing isolated corals?

Very Little otcop from creek to creek

May 31st / 73 - Glam post Locdoting
Thursday GO GROUP (over) 05
snowing

750 paces over to small creek
~1200 paces over to swamp "A"

Bear SE to hit IP Base Line

Chain Line crosses IP Base
Line at ~12200

Diagram on reverse →

Air photo # - BC 1596 : 14

1st flag on small creek
E2536

Sketch also on Air Photo
- BC 1596 : 14

Air photo

BC 1596:14

GO GROUP

staked 20/11/73

Citias Garque Minerals Corp.

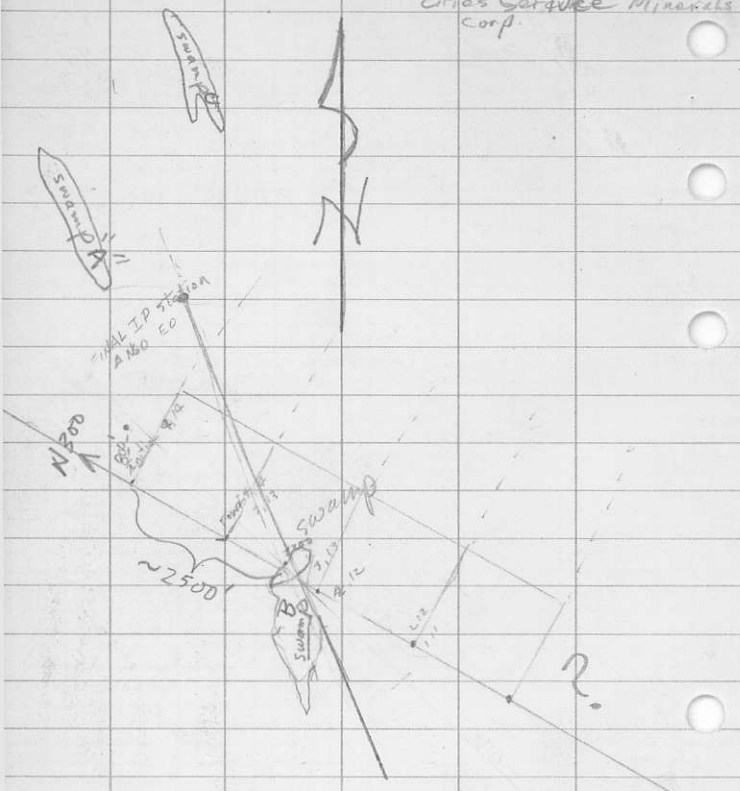

Claim Line running 300°

Most NW part is initial for 4, +14

approx 2500' up line from large Swamp

which both I.P. ^{Base} Line + Claim Line

pass through. (2200' station on I.P. ^{Base} Line)

(all claims thrown to the left)

May 30/73 SA SHEARER
CAMP



N. of Old Fort Mtn

N. of cities Service GO group
Air Photo # BC 1596:99, 48
South of #4 LK

① Rhyolite porph - large step

BF #8, 9, 10

500' N. of LK.

several diff. varieties of Rhy Porph
most common - leucocratic groundmass
+ rounded Qtz eyes
steep drop off to swamp

*

- minor py

- some Azurite

malacite noted (very minor)
(cupiferous py?)

② E of #4 LK - large step of
Fp porph Breccia.

May 29/73

J. SHEARER
CAMP CHARLIE

3

N. of OLD FORT Mtn

N. of CITIES SERVICE GO group

Air photo # - BC 15965150

Y-102 - small creek 320° only Logging
066 - creek - ALL organic - no sample
1500' s of Rd

060° - Large creek

- good sample
- 3500' from rd.

Y103, Y104, Y105

73-C-5-29-①

May 28/73 Monday

J. SHEARER
CAMP Charlie

2

N. of Old Fort Mtn

NW of Cities Service GO group

Air photo # - BC 1596:50,51

V-101, 120° small creek - see page
running onto logging road
also creek running down ^{old} logging
road but only road material for bed

- ① dcp of massive light coloured
Rhyolite on small Dome
- minor Pq. abundant Hematite

73-5-5-28-①

No Cu mineralization

- No dcp south of small
Dome

- several small creeks but all
are organic

May 27/73 - setup ^{J. SHEARER} camp ^{CAMP chair}
Sunday

N. of Old Fort Mtn.

Air photo # - Cities Service 90 claims
BC1596:50,51

small Rhyolite Dome #1

- (1) - Rhyolite - massive, aphanitic,
lococratic, some have a sugary tex.
some have weathered py xls. (very few)
Abundant Hematite stain
- apparently py has oxidized to Hem.
but some looks like primary
Hematite.

Flow structures appear to be horiz
striking ~ 270°

Each flow appears to differ slightly
from others.

The predominate Rhyolite Type

- ¹⁵ SA# ① - Light in colour, ^{white} brownish, with a minor
73-5-5-27 Light Hematite stain, There is
usually very trace amounts of
pyrite, cubic xln Py

An other common variety is exemplified by:

- SA# ②
73-5-5-27 This Rx has a spotted-speckled
appearance due to Hematite
blobs.
it is a light green in colour.