

ECHO # 11

approx. location of
Fort claims.

I.R. 20

BABINE LAKE

674143

BC 1596110

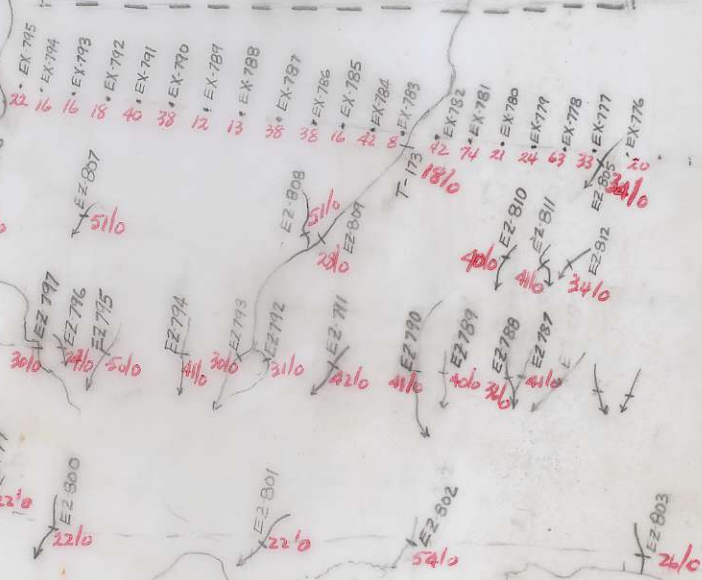

ECHO #11

SILTS & ROCKS

ROCKS:

- 1 - B8-25-1
- 2 - B8-25-2
- 5 - B8-25-2a (MINIOPY)
- 4 - B8-25-2b (CALCITE VEINS)
- 7 - B8-25-2c (AGLOM.)
- 3 - B8-25-3
- 6 - B8-25-4



FORT CLAIMS.

I.R.
20

McKENDRICK
IS.

I.R. 11



CAMP #11

ECHO

27/8/72.

"WHICH WAY DID THE BEARS GO" or "HOW WE WERE STRANDED IN 6 FOOT GRASS WITH A PACK OF HUNGRY TOADS"

TERRY:

(TO save on writing paper!)

CODE: (TO BE USED IN ALL SUBSEQUENT COMMUNICATIONS)

1a, 2, 3a W, 3a E, 3b W (SEE KEY BELOW)

4, 5a, 5b

2444701 (Bob)

795032 (Tom)

P.S. Thanks very much - really enjoyed living at the cabin & be able to go swimming - really nice

Anyway, we silted primarily out to west - most of the creeks were dry gullies but we took anything that even looked like it might have had water in it during the last 10⁶ years.

Most of the creeks disappeared up higher so we put a soil traverse with 400' spacing ~ 1000' south of the claims. Lots of vgh bush in the concentration area - no O.C. except on the east

west
+ north

borders of it (even in deep creek ravines - all overburden - we dug around a bit with the grub hoe). Found a bit of pyrite in one rock on the Hill claims north of camp but very minor - fairly large O.C. with py in a very small ~~area~~ area only. There has been quite a lot of staking in the ~~area~~ eastern part of the concentration area previous to the Hill claims - are there mag. anomalies or was it chiefly speculation after the discovery of Belle Granisle? - doesn't seem to be anything else ~~where~~ which would be cause for ^(over) ~~over~~ ^{I want my} ~~mommy!~~

KEY: 1a - nice camp - Thanks
2 - have done the usual
3a - silting W-west E-east
3b - soil traverse

1b - shitty comp - vgh, pulcs, I want my mommy!

4 - lots of overburden
5a - very little O.C.
5b - minor pyrite in O.C.

27/8/75

CAMP #11

②

stalking, ~~at least~~ on the surface - perhaps the geochem (will show up something which others have missed.

Also did a ~~lot~~ siting houses to east to finish covering the area - the boundaries of the Indian reserves were a bit uncertain so we sitted over to the edge of I.R. #11.

- the flags being hung in less ^{less} conspicuous places as we went farther east.

Alors, C'est ^{fini} fini pour p. cet an! (somewhat literal but we tried).

PPS. didn't see any bears - a disappointment - saw a cow & bull moose once though.

Thanks

Bob

[Faint, mostly illegible handwritten notes and bleed-through from the reverse side of the page.]

