

TCHENTLO

LAKE

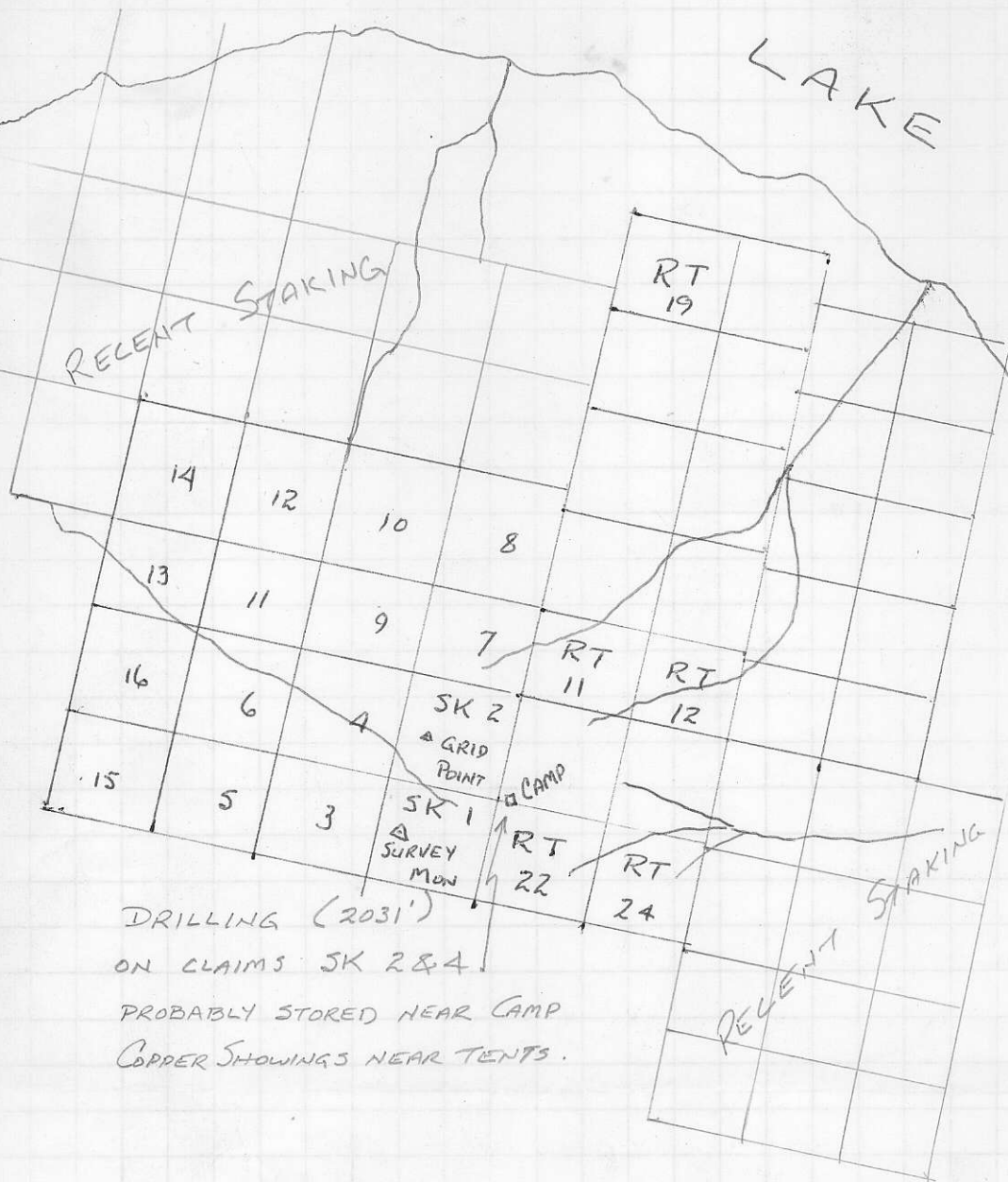

DRILLING (2031')
ON CLAIMS SK 2 & 4.
PROBABLY STORED NEAR CAMP
COPPER SHOWINGS NEAR TENTS.

NATION COPPER
WESTCOAST EXPLN
COPY OF SKETCH FROM
ASSESSMENT REPORT.
1" - 1/2 MILE (APPROX)
1969

674124

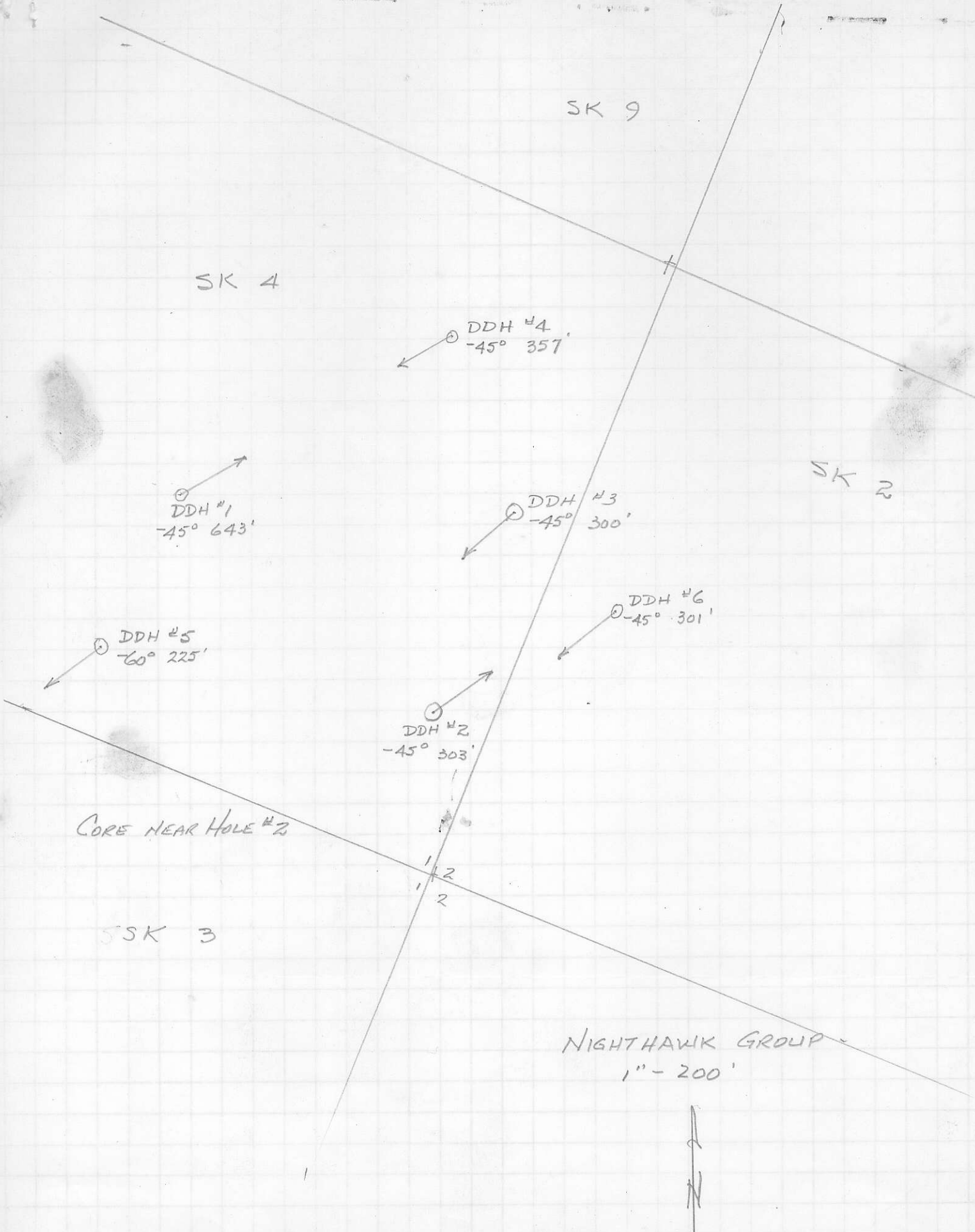

WEST COAST CORE
- LOG? "

DDH No 1

- 0-20 OVERBORDEN
20-47 W.G.B. 8-1-1
47-68 DIORITE?, EPIDOTE
AND K-FELDSPAR
ALTERATION,
68-170 W.G.B. 8-1-2, BLACK
FILLED FRACTURES
SOMETIMES
170-188 W.G.B. 8-1-3
188-475 W.G.B. 8-1-2
475-480 CALCITE RICH BAND
ALSO W.G.B. 8-1-3
480-590 W.G.B. 8-1-2
590-591 EPIDOTE BAND
591-642 W.G.B. 8-1-2
END OF HOLE.

DDH N^o 2

0 - 30 ¹ / ₂	NO CORE
30 ¹ / ₂ - 50 ¹ / ₂	OVERBURDEN FLOAT
50 ¹ / ₂ - 103	W.G.B. 8-1-2
103 - 115	W.G.R. 8-1-3
115 - 123	W.G.B. 8-1-2
123 - 133	W.G.B. 8-1-4.
133 - 143	W.G.B. 8-1-2.
143 - 147	W.G.B. 8-1-3.
147 - 177	W.G.B. 8-1-2
177 - 179	W.G.B. 8-1-3
179 - 211	W.G.R. 8-1-2
211 - 213	W.G.B. 8-1-4.
213 - 253	W.G.B. 8-1-2
253 - 258	W.G.B. 8-1-3
258 - 303	W.G.B. 8-1-2
END OF HOLE.	

DDH 3

0 - 12	OVERBURDEN
12 - 85	W.G.B. 8-1-2
85 - 93	W.G.B. 8-1-5
93 - 124	W.G.B. 8-1-2
124 FT -	1 INCH 20% CHALCO.

124 - 130

130 - 133 W.G.B. 8-1-4

@ 136, 142, 152 - EACH HAS
A 1/4" STRINGER OF CHALCO

133 - 180 W.G.B. 8-1-2

180 - 215 SPLIT FOR ASSAY

SOME CHALCO - SEE

W.G.B. 8-1-6'S

215 - 261 1/2 W.G.B. 8-1-2

261 1/2 - 263 MINOR CHALCO - SPLIT
FOR ASSAY.

263 - 287 W.G.B. 8-1-2

287 - 291 W.G.B. 8-1-3

291 - 301 W.G.B. 8-1-2

END OF HOLE.

DDH 4

0 - 9 OVERBORDEN

9 - 103 W.G.B. 8-1-2

103 - 108 W.G.B. 8-1-4

108 - 128 W.G.B. 8-1-2

128 - 155 MINOR CHALCO

MAYBE 15 STRINGERS
SPLIT FOR ASSAY

155-158 SOLID PYRITE
AND CHALCO - MOSTLY
CHALCO,

158-163 MINOR CHALCO

163-266 W.G.B. 8-1-2

266-267 W.G.B. 8-1-1

267-297 W.G.B. 8-1-2

297 - 1/4" STRINGER CHALCO

297-356 W.G.B. 8-1-2

END OF HOLE

DDH 5

0-33 OVERRURDEN

33-115 FELSPAR PORPHYRY,
W.G.B. 8-1-7

115-138 GOUGE - BLACKISH

138-225 W.G.B. 8-1-2

END OF HOLE

DDH 6

0-21 OVERRURDEN

21-53 W.G.B. 8-1-2

53-59 W.G.B. 8-1-4

59-133 W.G.B. 8-1-2

133-138 MINOR CHALCO-SPLIT

138-148 MASSIVE CHALCO-SPLIT
FOR ASSAY.

148-158 MINOR CHALCO-SPLIT
FOR ASSAY.

158-203 W.G.B. 8-1-2

END OF HOLE