

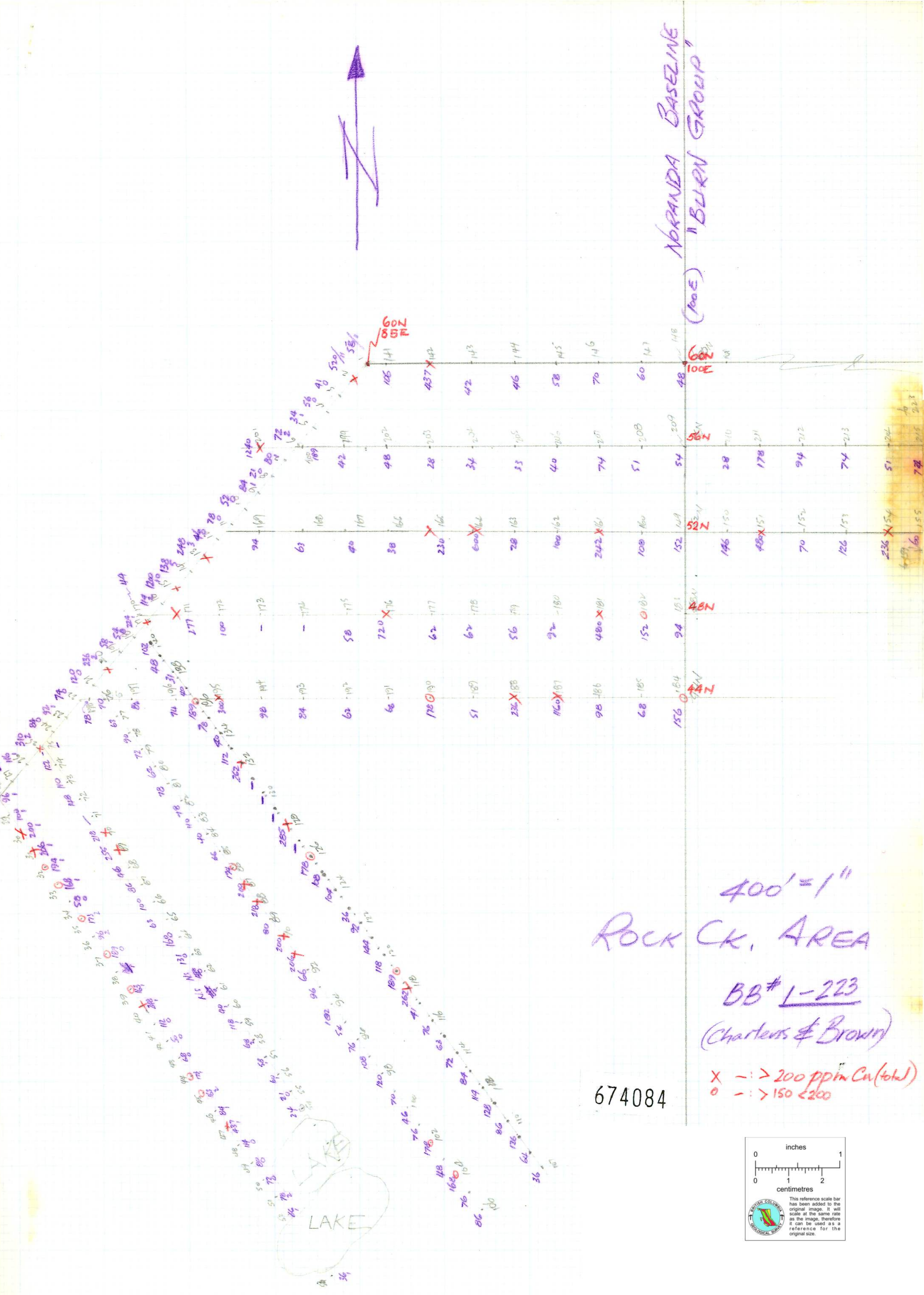

NORANDA BASELINE
(100E) "BLURN GROUP"



400' = 1"
ROCK CK. AREA
BB# L-223
(Charlens & Brown)
X - : > 200 ppin Cu (total)
O - : > 150 < 200

674084

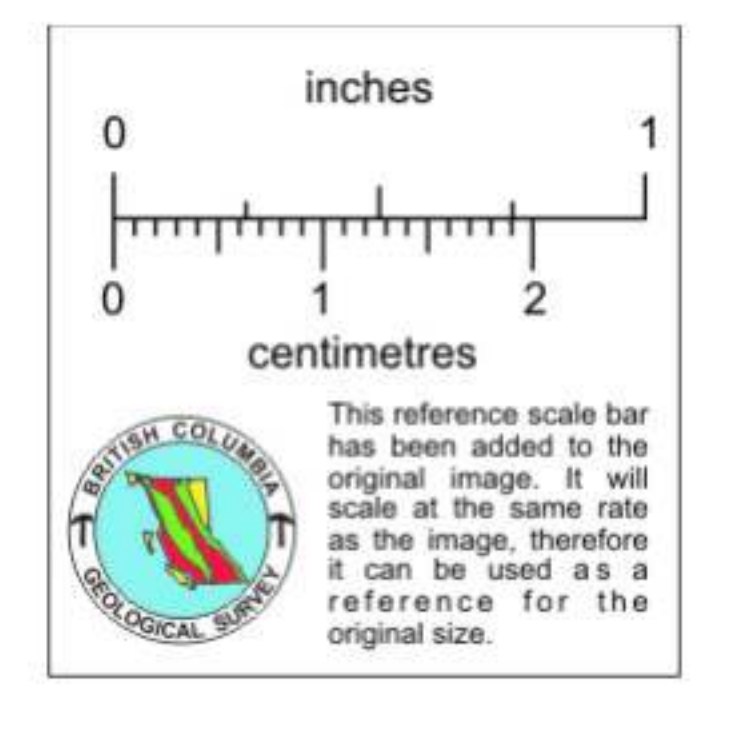

100	110	120	130	140	150	160	170	180	190	200
200	210	220	230	240	250	260	270	280	290	300
310	320	330	340	350	360	370	380	390	400	410
420	430	440	450	460	470	480	490	500	510	520
530	540	550	560	570	580	590	600	610	620	630
640	650	660	670	680	690	700	710	720	730	740
750	760	770	780	790	800	810	820	830	840	850
860	870	880	890	900	910	920	930	940	950	960
970	980	990	1000	1010	1020	1030	1040	1050	1060	1070
1080	1090	1100	1110	1120	1130	1140	1150	1160	1170	1180
1190	1200	1210	1220	1230	1240	1250	1260	1270	1280	1290
1300	1310	1320	1330	1340	1350	1360	1370	1380	1390	1400
1410	1420	1430	1440	1450	1460	1470	1480	1490	1500	1510
1520	1530	1540	1550	1560	1570	1580	1590	1600	1610	1620
1630	1640	1650	1660	1670	1680	1690	1700	1710	1720	1730
1740	1750	1760	1770	1780	1790	1800	1810	1820	1830	1840
1850	1860	1870	1880	1890	1900	1910	1920	1930	1940	1950
1960	1970	1980	1990	2000	2010	2020	2030	2040	2050	2060
2070	2080	2090	2100	2110	2120	2130	2140	2150	2160	2170
2180	2190	2200	2210	2220	2230	2240	2250	2260	2270	2280
2290	2300	2310	2320	2330	2340	2350	2360	2370	2380	2390
2400	2410	2420	2430	2440	2450	2460	2470	2480	2490	2500



BB#224-289

Cirque to West of Campsite Rock Ck. AREA.

(the grid north of BB#1-223) 400' = 1"

X: — > 200 ppm Cu (total)
 O: — < 150 ppm Cu (total)

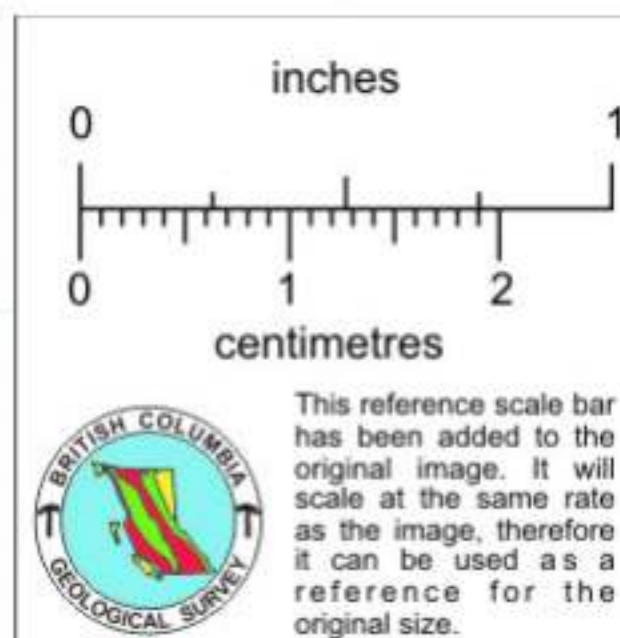

BB # 290 - 345

ROCK CK. AREA

(to North of BB# 224-289)

400' = 1"

X —: > 200 ppm Cu
O —: > 150 < 200 "

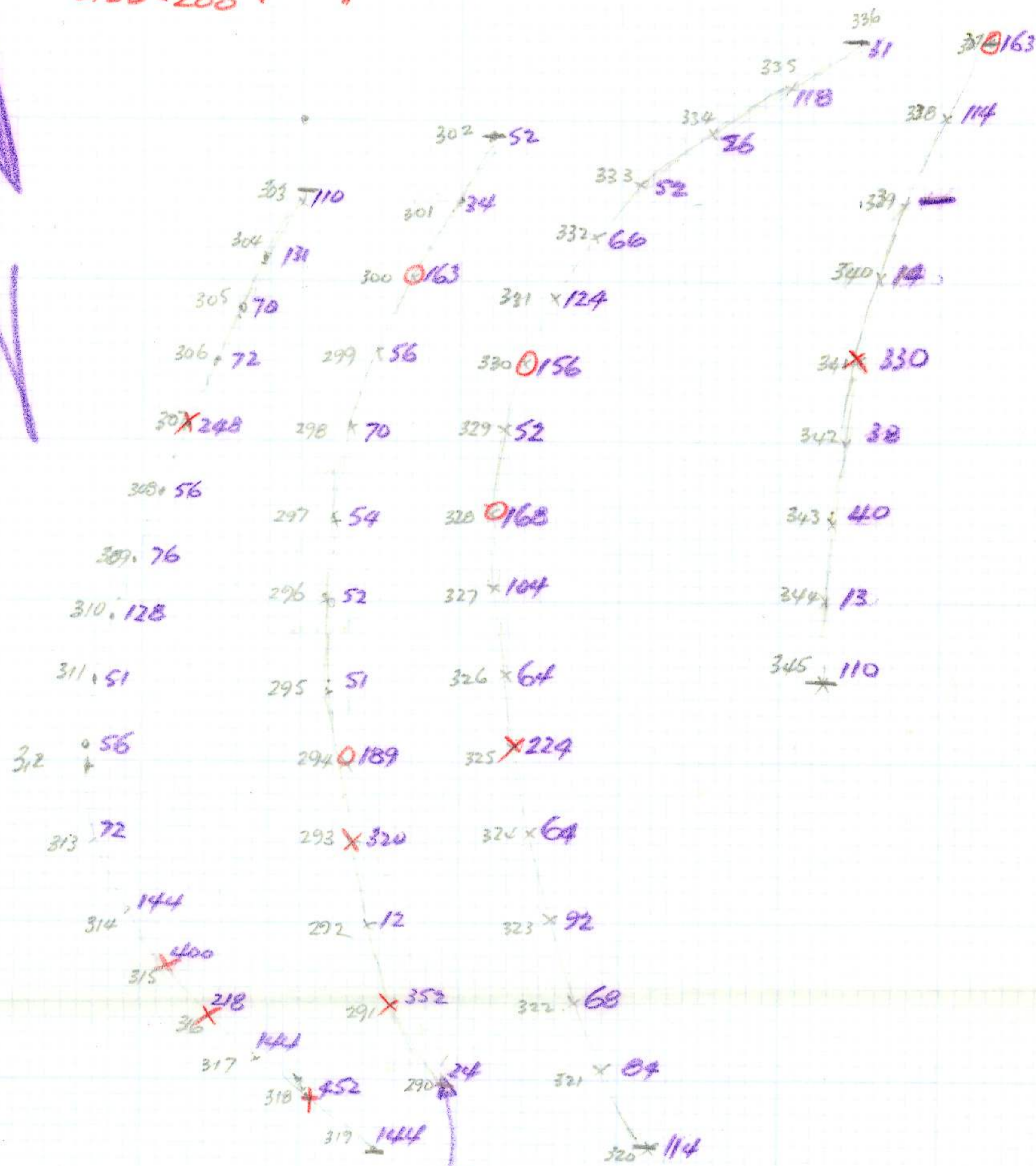

large unidentified curm

