

674071  
1971

CAMP AQUARIUS: COSMAT GROUP



BLACK, MASSIVE, VERY FINE GRAINED, OFTEN WITH HORNBLENDE PHENOCRYSTS,  
VOLCANICS



FINE TO MEDIUM GRAINED, HORNBLENDE AND FELDSPAR, APPROXIMATELY  
EQUAL IN TOTAL PERCENT, SOMETIMES GNEISSIC WITH EPIDOTE RICH LAYERS,  
FELDSPAR MAY BE IN BLEBS



MEDIUM GRAINED, DIORITE TO SYENODIORITE, K-SPAR AND EPIDOT ALTERATION  
MORE INTENSIVE IN SOME ZONES, SOMETIMES HIGHER IN MAFICS - HYBRID DIORITE



VERY COARSE GRAINED, HYBRID DIORITE, GNEISSIC

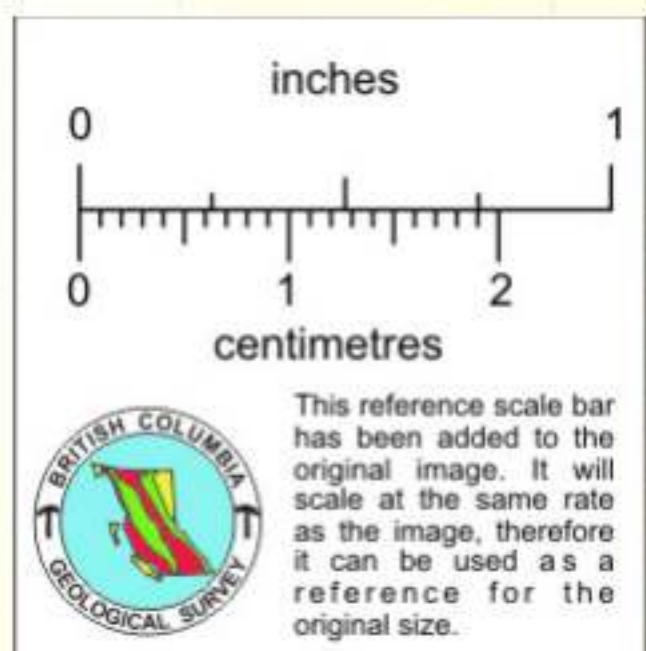

PRINTED ON CLEARPRINT 1000 H

PRINTED ON CLEARPRINT 1000 H

PRINTED ON CLEARPRINT 1000 H



# CAMP AQUARIUS: COSMAT GROUP

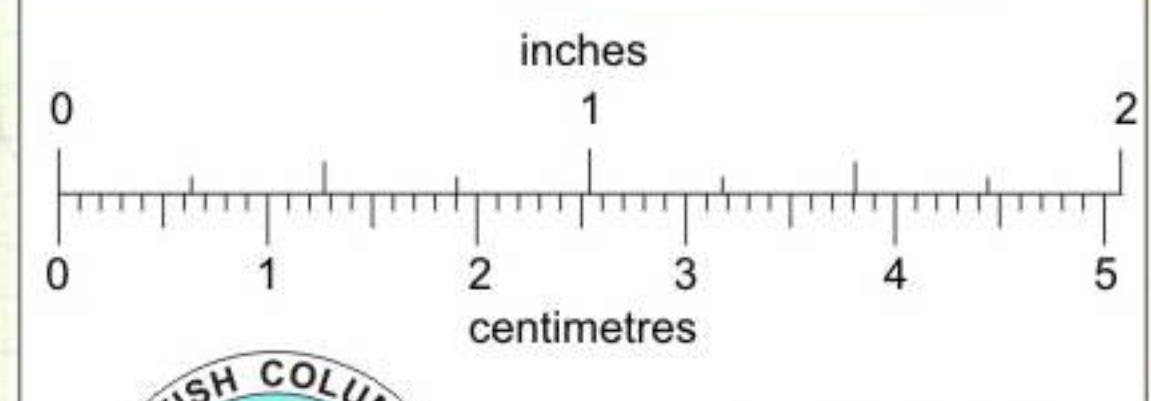

This reference scale bar has been added to the original image. It will scale at the same rate as the image, therefore it can be used as a reference for the original size.

T.W. JANES