

001595143

983793
- 983800

Shist 1-8
Sinta. 1-8 59-16.

Creek crossed
at 600' post
INIT 15-16.



674060
Prospectors
Report-Alpha
1972

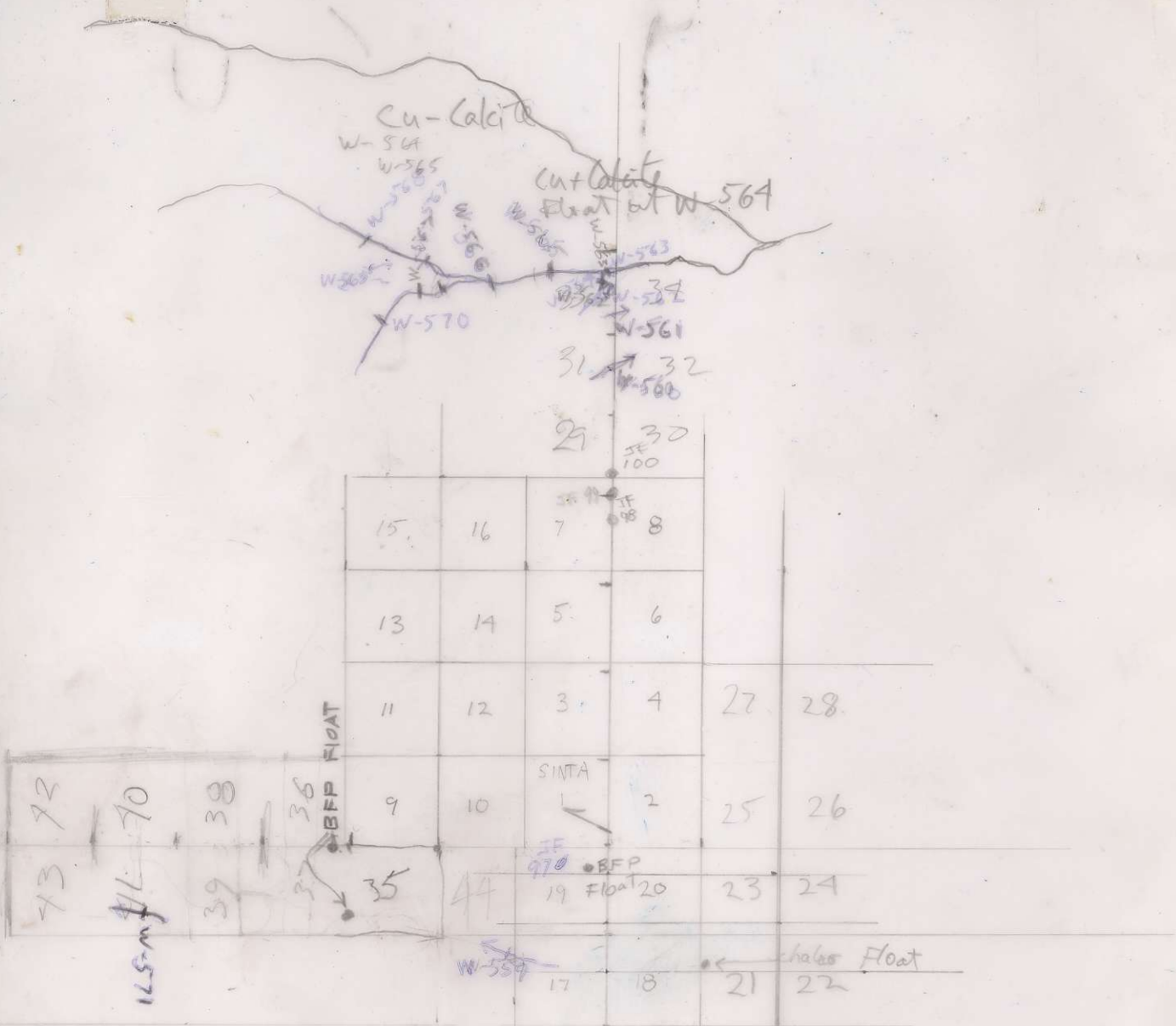

43 72
 41 70
 39 38
 37
 36
 BFP
 155 m
 W-571

~16000' R.

① JZ- 30,31
32,33



1595-82

① Note book page. 4



BC 1595-44