

673976
Sau Claims
104P/5E

August 6/83

Cam or Map.

I am sending the form for SAU to be recorded which is easier than sending a cheque to me. The map on reasprint is the one to be used when recording the claims. The map on lined paper shows where the TANYA 6 claim is on the claim map. The small 'x' shows where the post for TANYA 6 4N 4E was found.

Audrey said that there is no sign of flagging, blaying or a post for 4N 5E, which according to the map there shouldn't be anyway. She also states that if the claims (TANYA 6) are 5N 4E then the two eastern units of SAU are clear ground. According to the most recent claim map that we have (REC'D JULY 24/83) all of the ground covered by the SAU CLAIM GROUP should have been open.

Eleanor

M104P/SW

M104P/SE

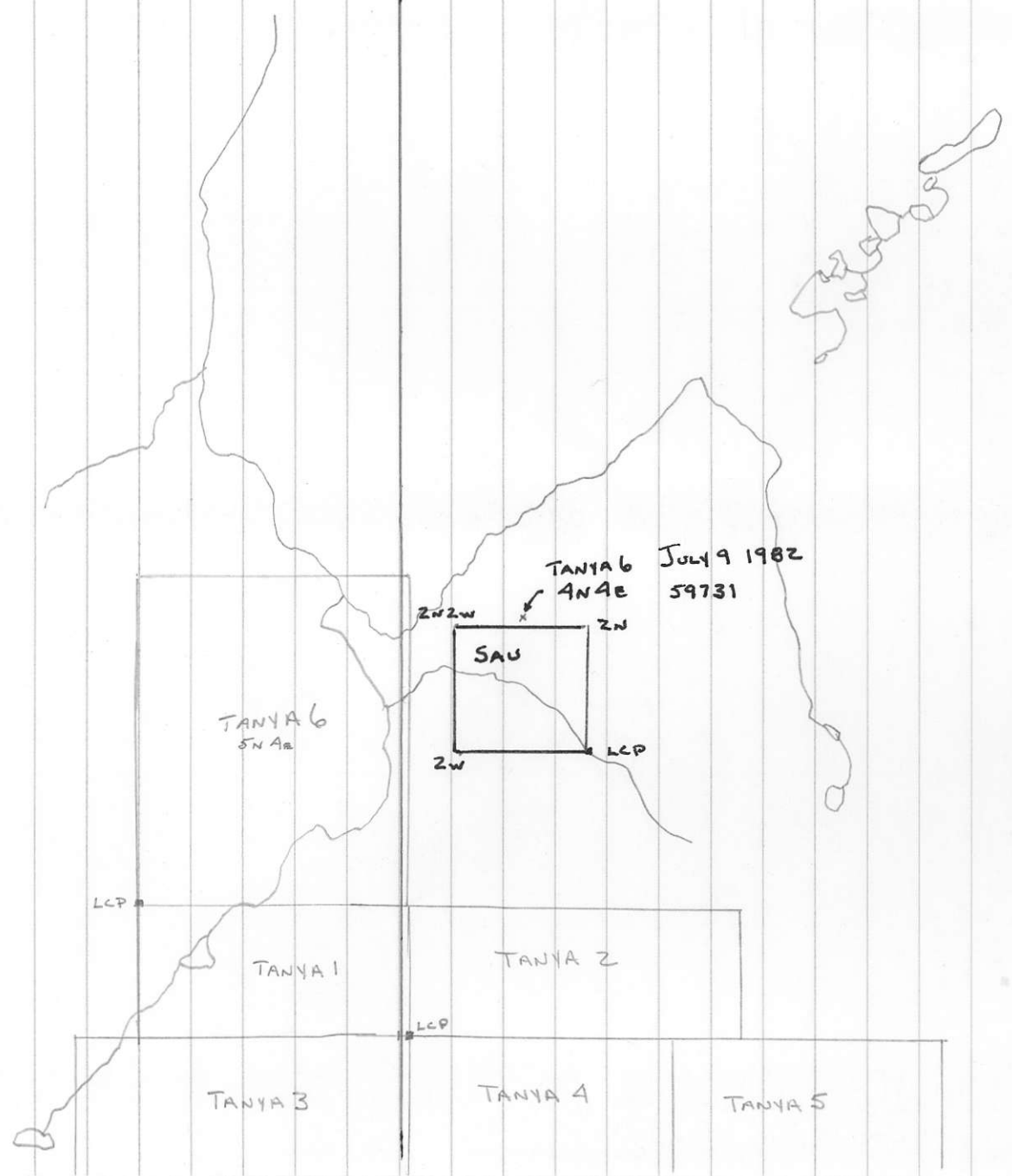

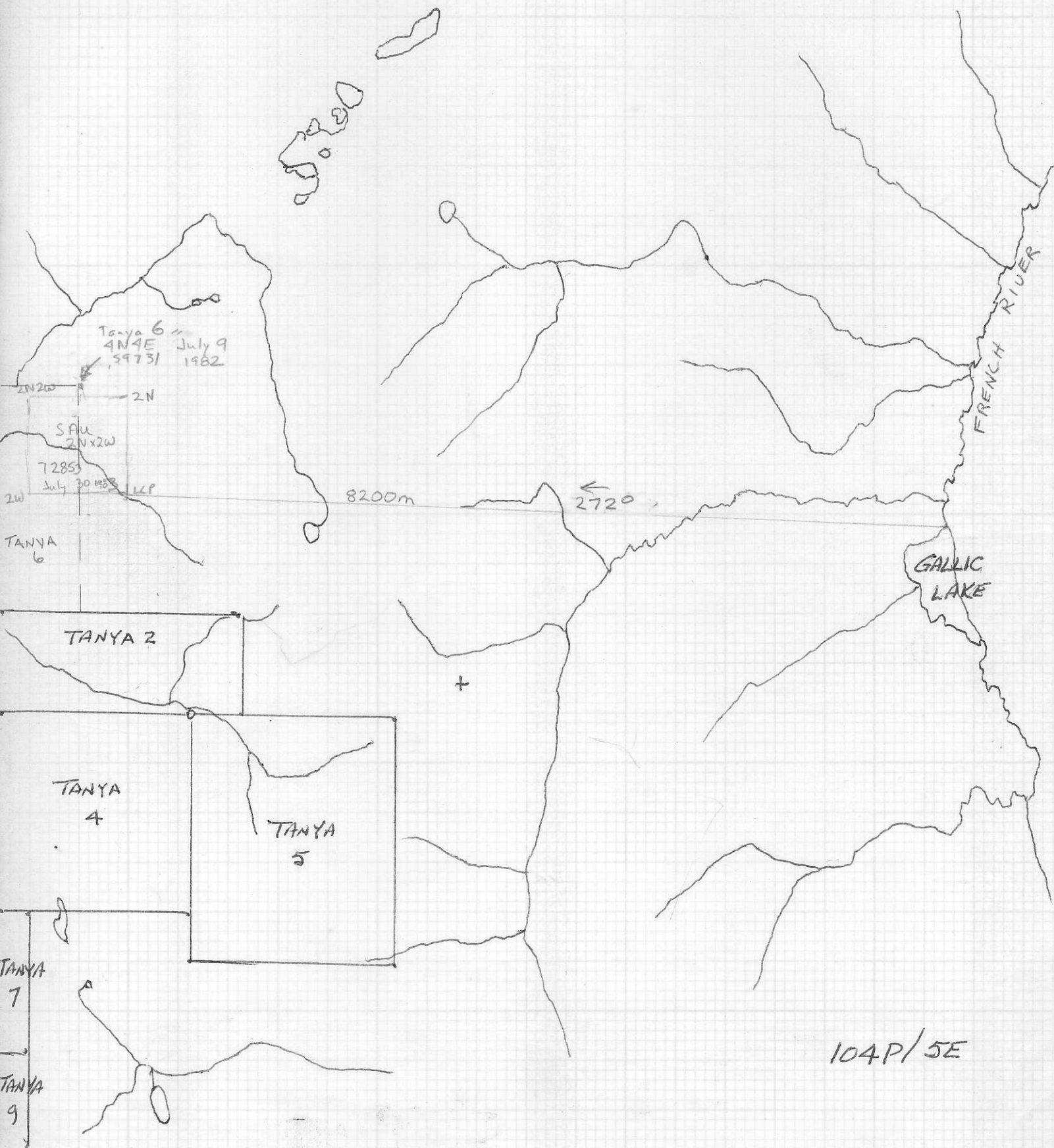
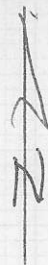

104P/5E