

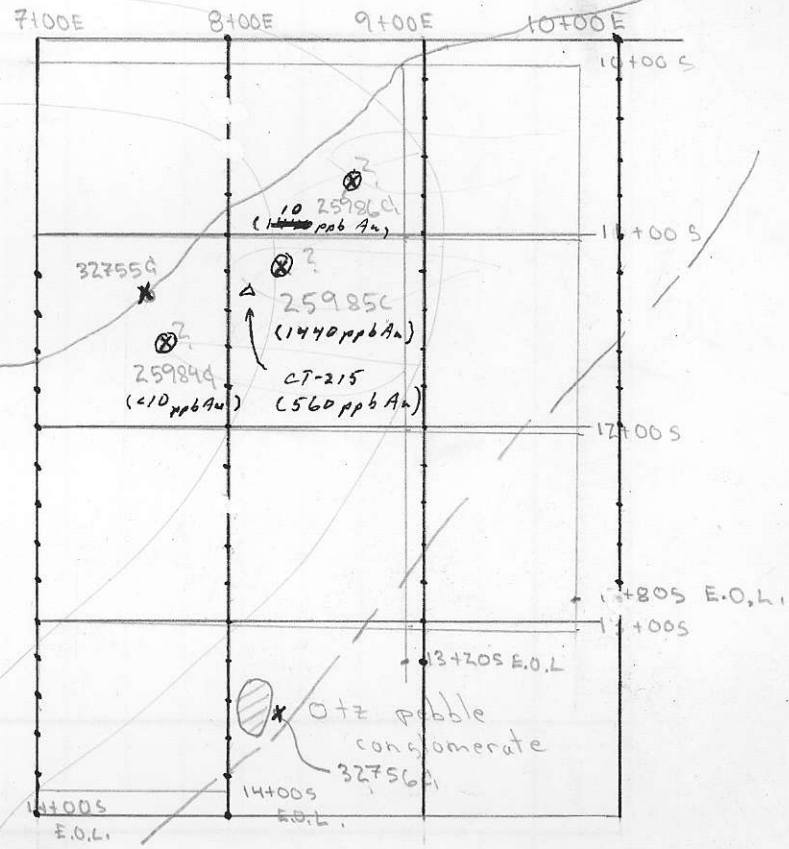

fine grain Alaskite

fine grain Alaskite * 32757C

CAMP
82 NXD
FU 101
Carvill Creek



Dix Claim #1

X possible sample locations

1" = 100m

o 1982 talus sample

o 1982 SILT SAMPLE (PANNED CONC.)

⊗ 1981 ROCK SAMPLE (APX. LOC'N)

Δ " TALUS " " " "

x 1982 ROCK SAMPLE

SAMPLER N. Silins / A. Candy

PROJECT Newex-Dix claims

NTS 104N-11

LINE 8+00E

DATE July 25/82

AIR PHOTO NO. 104N-11

SAMPLE NO.	LOCATION	Depth	Horiz	DESCRIPTION				SLOPE	VEG.	ADDITIONAL OBSERVATIONS OR REMARKS	ASSAYS				
				Colour	Part Size	% ORG.	Ph				Au	As			
'82-NXD	8+00E 10+00S	3"	/	br/gr	silty	low		gentle	grasses moss						
	10+20S	5"		L.br.	fine silty	low		gentle	no veg.						
	10+40S									n/s - no soil available.					
	10+60S									n/s "					
	10+80S	4"		gr/h	coarse	low		gentle	grass talus	taken by creek bed					
	11+00S	8"	A	dk br.	/	high		mod	"						
	11+20S	6"		br.	coarse peb.	med		mod.	"						
	11+40S	8"	A	dk br.	/	high		mod.	grasses mosses						
	11+60S	6"		br.	fine peb.	low		mod	"	5m past at frost bail					
	11+80S	7"		dk br.	peb. sand.	med		mod.	talus						
	12+00S	4"		tan	fine peb.	low		mod	mosses talus						
	12+20S	8"		dk br.	peb. sand	med		mod	talus						
	12+40S									n/s -> talus slope					
	12+60S	8"		L. br.	fine silty	Low		steep	grasses						
	12+80S	6"		br.	"	med		mod.	"						
	13+00S	7"		L. br.	silty sand	low		mod	mosses	no profile					
	13+20S	1"		tan	fine peb.	low		mod	talus						
	13+40S	6"		L. br.	f. silt	low		mod	mosses						
	13+60S	3"		br.	"	high		mod.	rocky	by outcrop					
	13+80S			L. br.	f. silt	low		mod	mosses						
	14+00S	3"		L. br.	"	med		gentle	grassy						

SAMPLER N. Silino / A. Candy

PROJECT Newex - Dix. Jaimo

NTS 104N-11

LINE 10+00E

DATE July 24/82

AIR PHOTO NO. _____

SAMPLE NO.	LOCATION	Depth	Horiz	DESCRIPTION				SLOPE	VEG.	ADDITIONAL OBSERVATIONS OR REMARKS	ASSAYS			
				Colour	Part Size	% ORG.	Ph				Au	As		
NXD -82	10+00E 10+00S	3-4"		gr/tan	coarse	low		mod.	mosses talus					
	10+20S	2-3"		gr/tan	fine	low		mod	"	taken from frost boil				
	10+40S	4"		br.	fine silty	med		mod	"					
	10+60S	6"		br.	"	med		"	"					
	10+80S	6"		green br.	"	low		"	talus	sample 5m past where it should				
	11+00S	4"		h. br.	coarse	low		mod	"					
	11+20S	4"		dk br.	lots of " peb.	med		"	"	taken 7m past				
	11+40S	4"		br.	coarse	med		mod	"					
	11+60S	10"		br/gr.	coarse + peb.	high		mod	talus					
	11+80S	6"		gr/br.	coarse	med		mod	"					
	12+00S	2-3"		tan	+ peb.	low		mod	"					
	12+20S									n/s				
	12+40S	3"		grey	clayish	low		mod	grasses					
	12+60S	6"		br.	coarse	high		mod	mosses					
	12+80S	2"		h. br.	v. fine	low		mod	mosses grasses					

