

1-21-7

- 1-21-7 - Dark grey green fine crystalline volcanic
- 2-21-7 - Coarse brownish purple white + pink feldspar, hornblende porph - young?
- 3-21-7 - Fg grey andesitic feld porph - very small white feld phenos
- 4-21-7 - Purplish red + green c.g feld hornblende porph - syenite?
- 5-21-7 - Fg. grey green andesite
- 6-21-7 - Purplish grey amygdaloidal vol - pinkish amygdalites
- 7-21-7 - Porphyritic buff reddish syenite
- 8-21-7 - Finer grained phase of 4-21-7

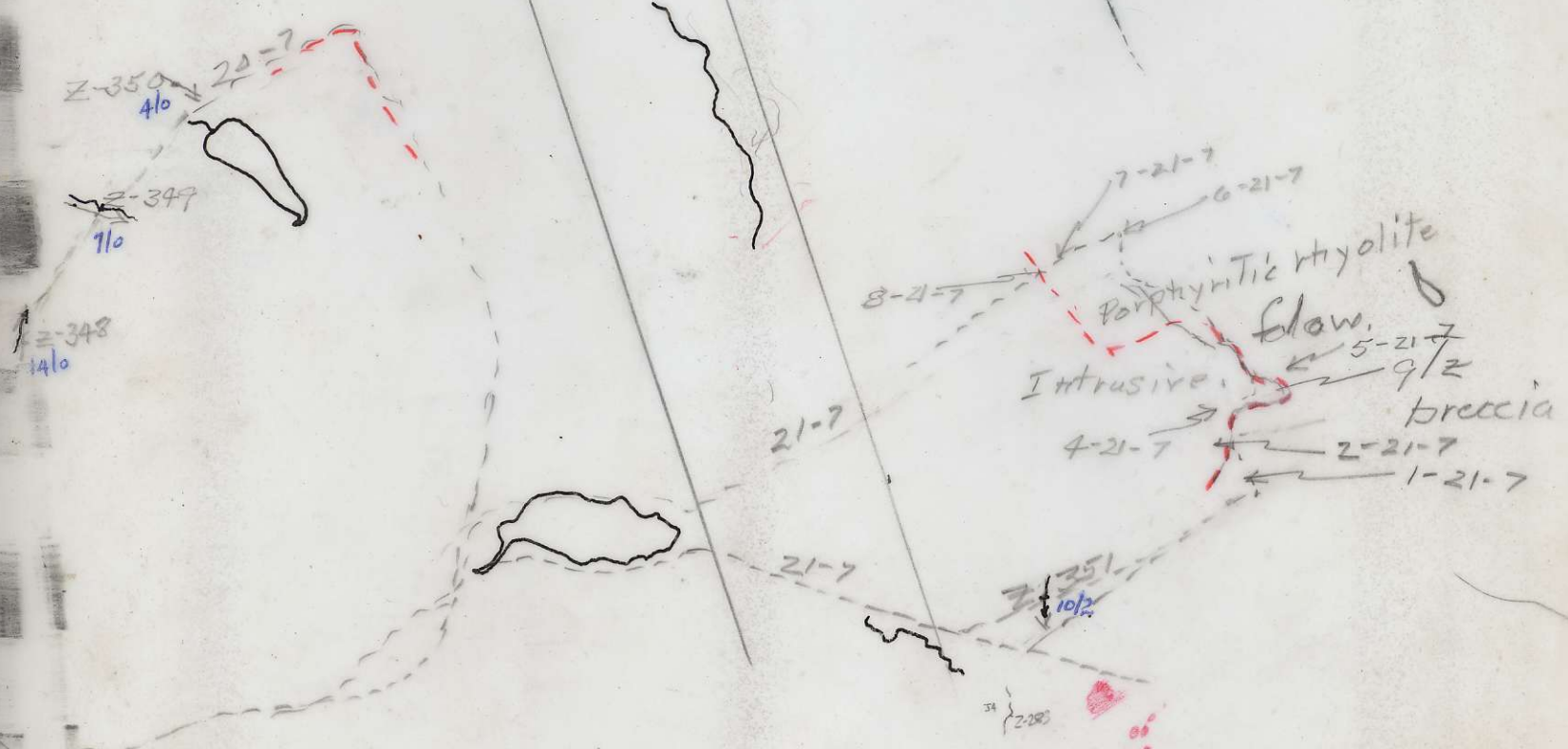

Check 93L

1972

673758

BC 5420-086