

Indian Res. #15
Ture 7-14

673565

92L/10

Claims must be tied by direction and distance to at least one, preferably more than one, topographical feature, or to a land lot, section, township, or other recognizable point on printed maps of the district. Relationship of previously located claims should also be shown.

N.B. — The sketch for a group of claims may be placed on one affidavit.

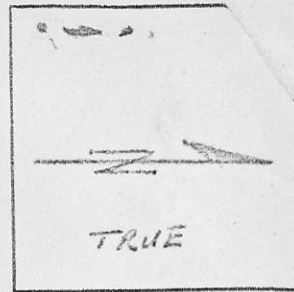

INDICATE NORTH
(True or Magnetic)

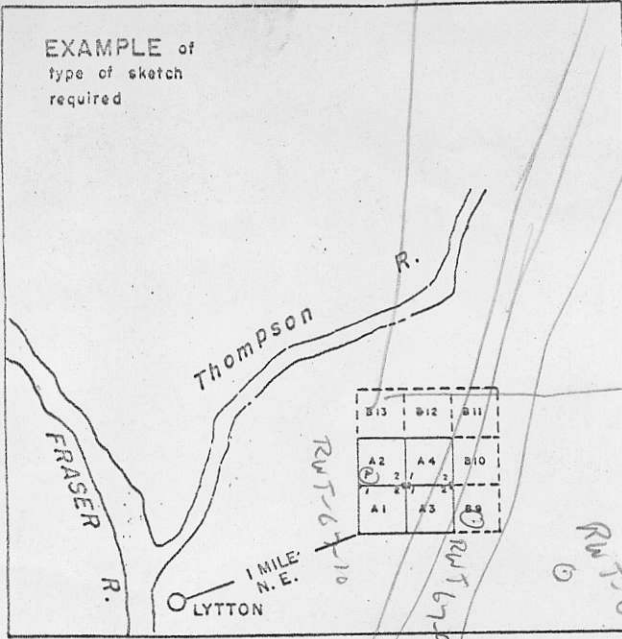

ONE INCH = 1000 FEET.

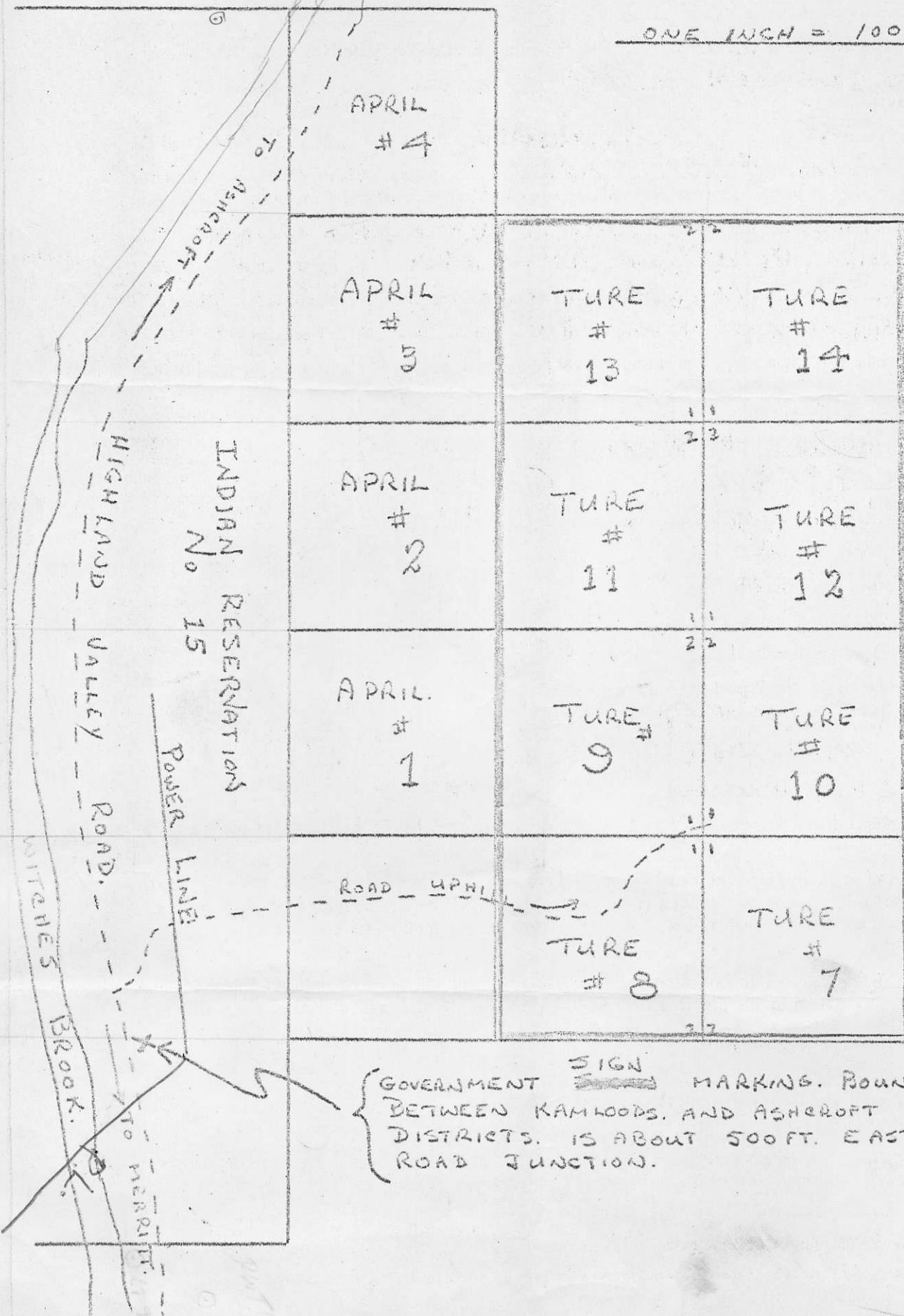

GOVERNMENT SIGN MARKINGS. BOUNDARY BETWEEN KAMLOODS AND ASHCROFT FOREST DISTRICTS. IS ABOUT 500 FT. EAST OF ROAD JUNCTION.