

673259
Robb Lake
94B, G

July 10th, 1972.

Mr. Gordon Leliever,
715 - 159 Bay St.,
Toronto, 1, Ontario.

Dear Gordon:

Thank you for your letter of July 5th and cheque for \$300. Your attached claim sketch, although not too accurate, does indicate the location of the CRAN and SIKA claim groups which I have checked out with the appropriate people.

The CRAN group does have 52 mining claims and the SIKA group does have 96 claims. The claim numbers, not the record numbers, are shown in the attached sketch (the record numbers will be issued sometime in the future).

With respect to geology, the CRAN group is largely in a valley at elevations below 4500'. Sidenius Creek, a tributary of the Sikanni Chief River, flows northeasterly across the claims from the southwest corner to the northeast corner of the group. The claims are underlain by the Besa River formation of Upper Devonian Age. The carbonate unit of Middle Devonian Age underlies the Besa River at an unknown depth; it is the carbonate unit that is the prospective formation and, in suggesting the program below, we are directing our attention first to finding out the depth of the carbonate unit.

On the SIKKA group the carbonate unit outcrops well on the western half of the property. It also outcrops to some extent on the eastern part of the property and hence a considerable part of the property as a whole encompasses the prospective formation. Thus, in contrast to the CRAN group, an entirely different program is recommended. It involves a geological reconnaissance which includes methodical prospecting and soil sampling, where applicable.

Below we suggest phased programs for both groups of claims, which we consider to be well located. In both instances, however, Phase 2 is based entirely on whether the results of Phase 1 are favourable or not. In other words, it is possible that Phase 2 may not be justified.

COST ESTIMATE

CRAN

Phase 1 - Seismic Refraction Survey

Field work, 8 miles @ \$750/line mile	\$6,000
Explosives, instrument rental, etc.	750
Interpretation and report (seismic)	2,000
Mobilization and demobilization	7,000
Supervision	<u>1,500</u>
	<u>\$17,250</u>

Phase 2 - Diamond Drilling

(if Phase 1 indicates a shallow depth for the upper surface of the Middle Devonian).

5000 ft. of AQ wireline drilling at \$10/ft.	\$50,000
Mobilization, demobilization	10,000
Transportation (mainly helicopter)	10,000
Geology, engineering, supervision and possibly assaying	<u>5,000</u>
	<u>\$75,000</u>
	<u>\$92,250</u>

SIKA

Phase 1 - Geological Reconnaissance

Prospecting, geology, soil sampling @ \$150/claim	\$14,400
Mobilization, demobilization	7,200
Supervision	<u>1,500</u>
	<u>\$23,100</u>

Phase 2 - Diamond Drilling

5000 ft. of AQ wireline drilling at \$10/ft.	\$50,000
Mobilization, demobilization	10,000
Transportation (mainly helicopter)	10,000
Geology, engineering, supervision and possibly assaying	<u>5,000</u>
	<u>\$75,000</u>
	<u>\$98,100</u>

You inquire whether we would be interested in carrying out programs on claim groups you own in the Robb Lake area. We certainly would as we feel that we have a considerable familiarity with the geological situation. We would delegate the actual daily work to reputable service companies and charge a modest fee, as shown above, for laying out the program and supervision.

Please advise if there is anything we have not made clear in the above.

Respectfully submitted,

BACON & CROWHURST LTD.

W.R. Bacon, Ph.D., P.Eng.

P.S. I include sketches of the claims involved in the CRAN and SIKA Groups.

Gordon Leliever

SUITE 715 - 159 BAY STREET

New Address:

TORONTO 1, ONTARIO

208 Emby Street
Streetsville, Ont.

826-1069

~~867-3563~~

5th July 1972

Mr. W. Bacon
Bacon & Crowhurst Ltd.
1055 West Hastings Street - Ste. 1720
VANCOUVER, B.C.

Dear Mr. Bacon:

In regard to our telephone conversation as of the above date please find a retainer's fee for \$300.00 so that an account in my name and associate companies will have an identification as far as you and your firm are concerned.

As of June 28th I acquired a group of 52 mining claims in the Liard Mining Division of British Columbia. These claims are known as the Cran Group. I also acquired a group north of the Cran Group and tied onto the east side of Canadian Superior Oil and known as the Sika Group for a total of 96 claims.

Our agent and solicitor in British Columbia is Mr. John K. Campbell to whom I understand you are known. He can fill you in with the above descriptions and possibly claim numbers. The 52 claims are fully paid for and the 96 claims should be paid in full very shortly. However, the allocation of these claims will be made by myself after I receive an actual claims map from Mr. Campbell, but in the interim I would request a letter from you as to the location of both these groups, or as far as geology is concerned, and a recommendation as to approximately how much money should be spent for the two independent groups and also an indication from you as to whether or not your firm would be interested in carrying out the programs for whatever companies are allocated to these groups.

Trusting to hear from you shortly,

Yours truly,

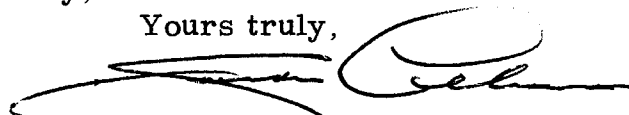
Gordon Leliever

on?

Mr. W. Bacon

5th July 1972

P.S.

Please find enclosed the proper spelling of various companies that will probably acquire claims in this area so that you may have this as a reference.

G.L.

Seaway Base Metals Limited

Colleen Copper Mines Limited

Copperville Mining Corporation Limited

Melville Mines and Industries Limited

Nordic Industries Limited

Hodden Grey Mining and Explorations Limited

Northville Explorations Limited

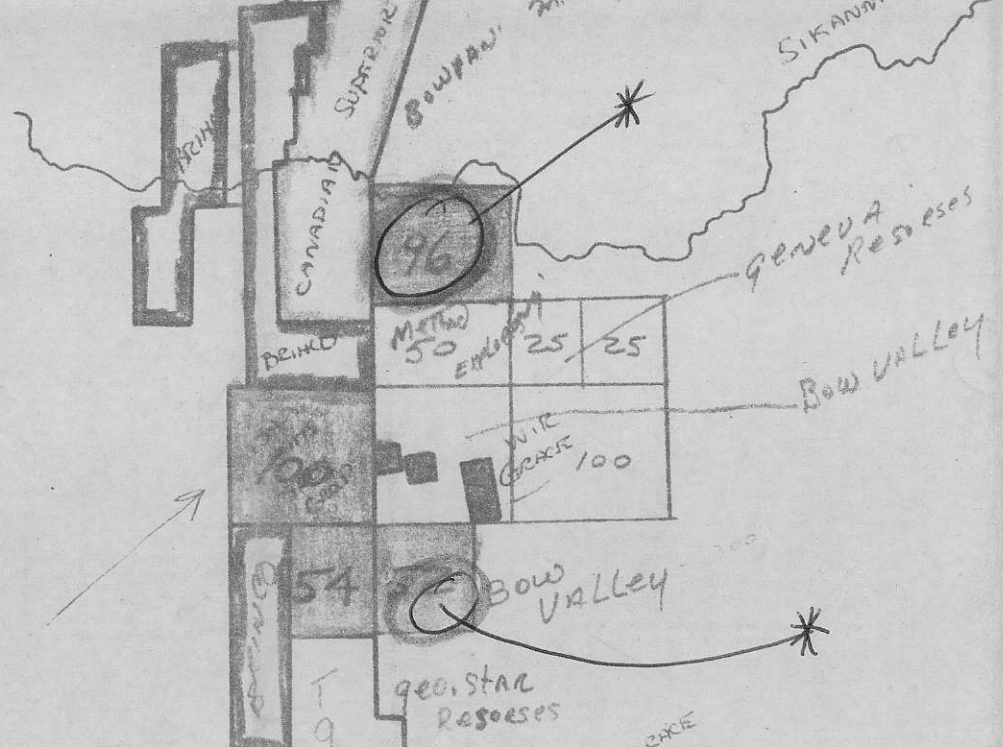
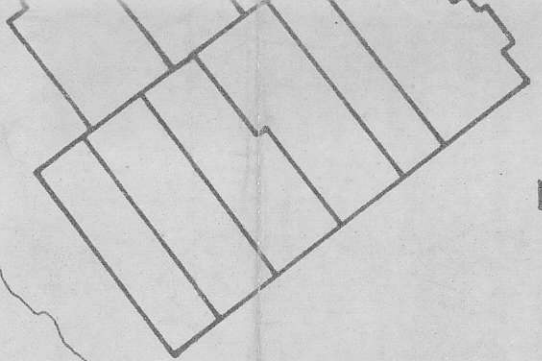

 Pioneer Cons
 Mining PR

