

672935

LAC MINERALS LTD.
CLAIMS SUMMARY

CLAIM: HANK Property

LOCATION: 13 kilometers west of Hwy 13, 370 kilometers north of Kitwanga, B.C. (junction of Hwy 13 and Hwy 16).

ACCESS: Helicopter

EXPENDITURES: \$ 2,914,700. to December 1989

TARGET: Epithermal Au, Ag deposits.

GEOLOGY: Upper Triassic, Stuhini Group andesite and trachyte volcanics, flows and associated epiclastics overlain by Middle Jurassic Spatsizi Group fossilized sandstones and conglomerates. This sequence is postdated by Tertiary(?) aged pyritic, felsitic brecciated flow dome complex(?) or sill. Poorly displayed bedding and contacts show a general NE-SW striking and shallow SE dipping sequence.

ALTERATION: The Stuhini Group andesitic rocks host two large sericite-carbonate-pyrite alteration zones. Both trend roughly sub-parallel to the host volcanics but tend to dip at steep angles to the SE. The dimensions of the (geographically) upper and lower alteration zones are 2 to 3 kilometers long and 150 to 200 meters thick. The Tertiary(?) felsite is pyritic and completely kaolinized and silicified.

All the known mineralization is hosted in the upper and lower alteration zones.

-2-

MINERALIZATION:

The upper alteration zone is generally broken into three segments. The NE segment has < 2.5% pyrite, minor silicification and erratic enhanced elemental values in Au, As. The central segment or 'Hot Spot' hosts two areas of carbonate-quartz-barite stockwork veins with associated gold. Tentatively, two small open pits have been outlined containing the following geological reserves:

200 Pit*

Reserves 269,000 Tons @ 0.13 oz/Ton Au
Waste-Ore Ratio 4.3:1.0

440 Pit*

Reserves 238,000 Tons @ 0.067 oz/Ton Au
Waste-Ore Ratio 4.2:1.0

* Using 0.024 oz/Ton Au cut-off; maximum pit depth of 50 m.

The SW segment of the upper alteration zone has 1-2% pyrite with extensive areas of enhanced gold values and minor amounts of carbonate veining. The best surface trench values were 462 ppb Au over 115.0 meters. The best drill hole from 1988 returned 0.93 g/t Au over 24.0 m (D.D.K. 88-11).

The lower alteration zone hosts carbonate-quartz-barite veins with associated polymetallic minerals. The veins are discrete, or more commonly associated with stockwork systems and shears.

Gold and silver values are associated with sphalerite, galena, chalcopyrite and tetrahedrite.

These polymetallic veins and stockworks have been subdivided into 11 distinct zones, based on 25 drill holes which have probed 2200 meters of strike length. The system is open to the NE, SW, at depth, and needs detail infill drilling.

-3-

MINERALIZATION (cont'd):

Some of the best lower alteration zone intersections include:

DDH 87-3 16.83 g/t Au, 166.4 g/t Ag over
3.40 m T.W.** (Creek 5 C zone)

DDH 88-4 13.39 g/t Au, 132.3 g/t Ag over
5.88 m T.W. (Creek 5 Deep zone)

DDH 88-6 66.19 g/t Au, 530.0 g/t Ag over
1.10 m T.W. (Creek 5 Deep S zone)

DDH 89-11 12.00 g/t Au, 257.2 g/t Ag over
2.38 m T.W. (Creek 8B zone)

** T.W. (True Worth)

SUMMARY OF WORK:

1983: stake Hank 1,2,3 claims; soil, rock, stream sediment sampling and geological survey.

1984: stake Hank 4 claim; trenching of alteration zones along creeks; soil pits; 4 D.D.H. (288.1m).

1985: geology; petrographic study; I.P. geophysics; 46 D.D.H. (4209.3m) in 'Hot-Spot' area.

1987: I.P. geophysics; geology; 46 D.D.H. (1048.2m) in upper and lower alteration zones.

1988: 23 D.D.H. (4736.0m.) in upper and lower alteration zones.

1989: detail geology and structural study of lower alteration zone; 11 D.D.H. (1610.5 m) in lower alteration zone.

1990: On June 29, 1990, LAC Minerals signed an option agreement with Carmao Resources who subsequently drilled 5 holes totalling 1464.3 m. While the alteration zones were intersected, no significant values were returned. The property was returned to LAC on March 29, 1991.

-4-

LAC Minerals Ltd.
Claim Status

HANK PROPERTY, Hankin Peak Area

Claim Name	Record Number	Units	Expiry Date	NTS	Mining Div	Owner
HANK 1	2691	18	03-10-01	104G/1W,2E	Liard	100%LAC
HANK 2	2692	20	03-10-01	104G/1W,2E	Liard	100%LAC
HANK 3	2693	20	03-10-01	104G/2E	Liard	100%LAC
Hank 4	3209	10	10-12-99	104G/1W	Liard	100%LAC

(endfile: mem0106)

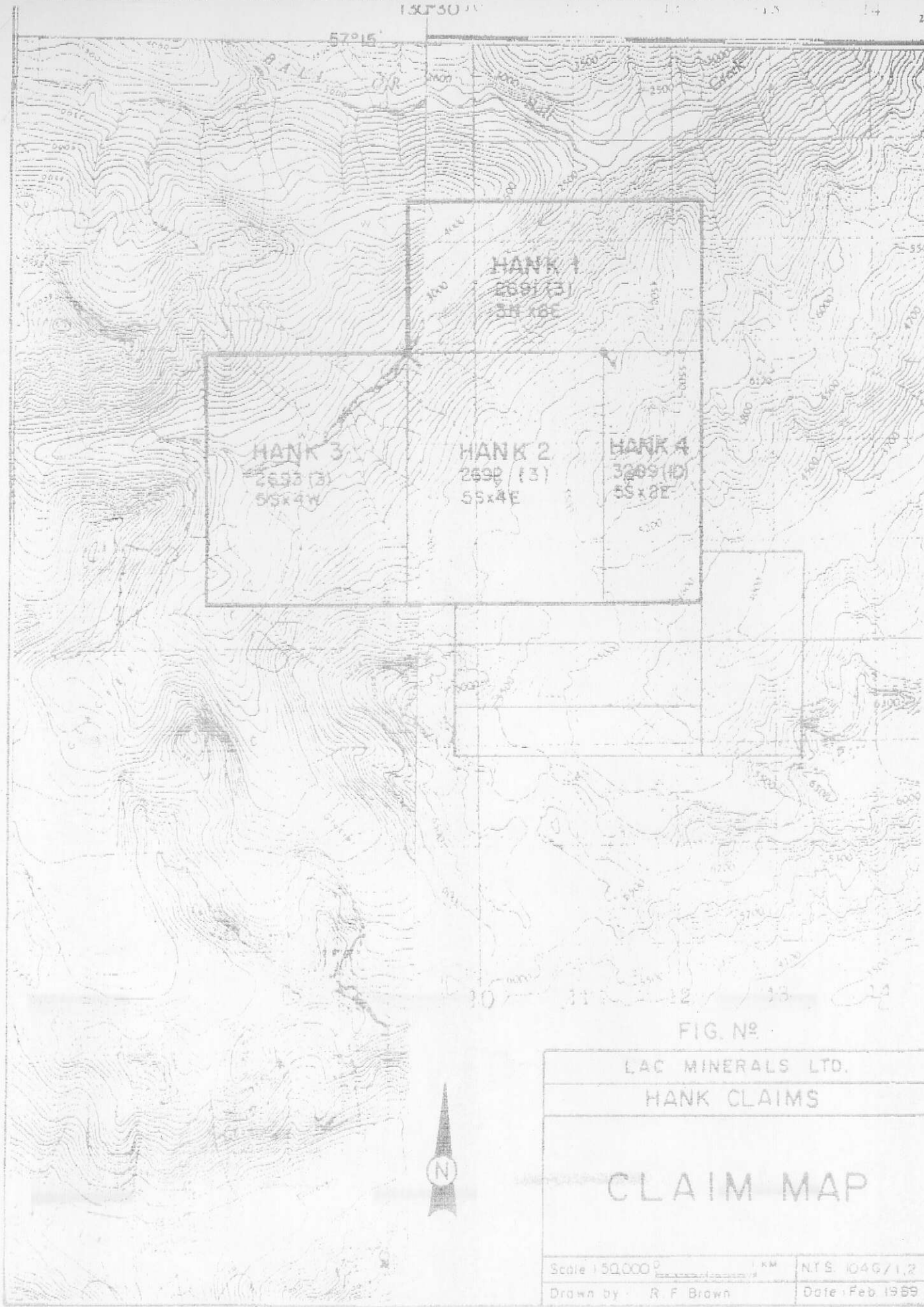

FIG. N°

LAC MINERALS LTD.
 HANK CLAIMS

CLAIM MAP

Scale 1:50,000	NTS 1046/1,2
Drawn by R. F. Brown	Date Feb 1989