

BIN

July 21st 1978

V<sub>B</sub> Basalt  
black, fine grained  
10% qtz filled  
vesicles  
RHYOLITE fractured at 45° dipping  
comply east west  
dipping north 30°  
on ventral or south  
Local well developed  
columnar jointing

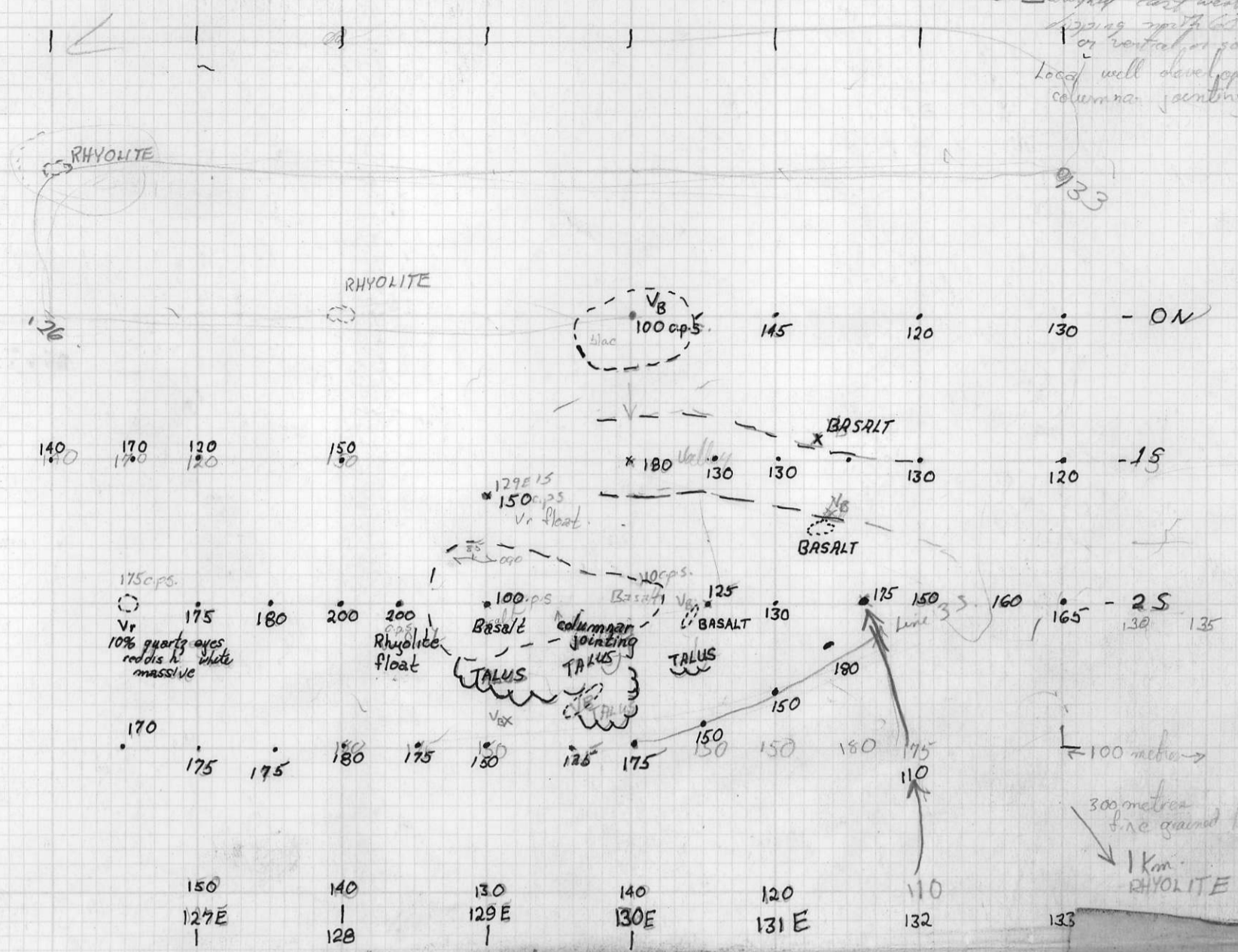

July 21st 1978

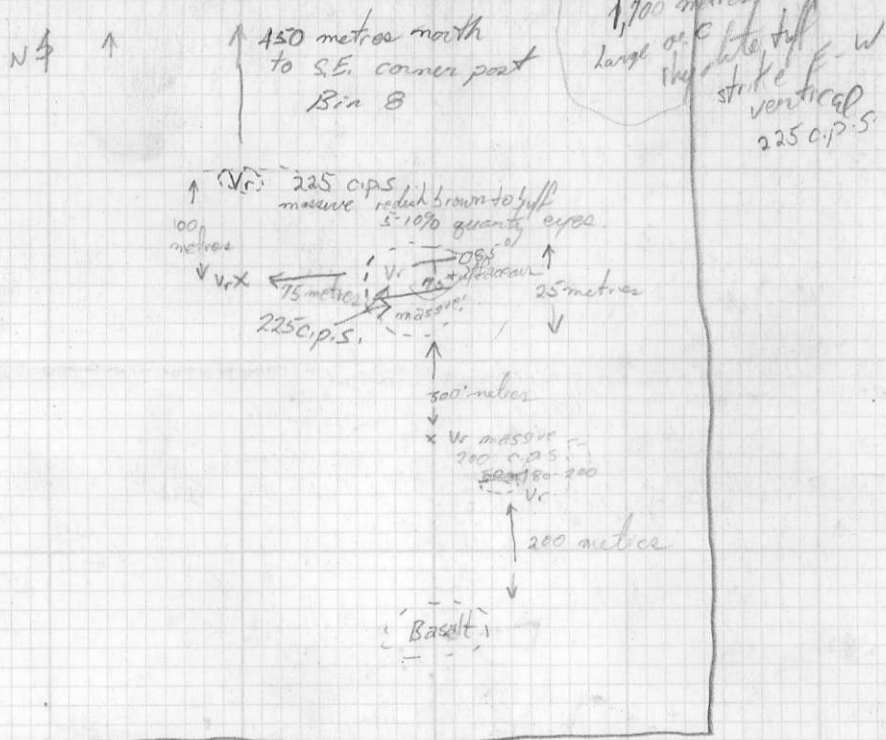
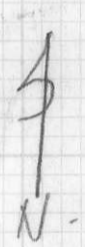

July 22nd Bin east

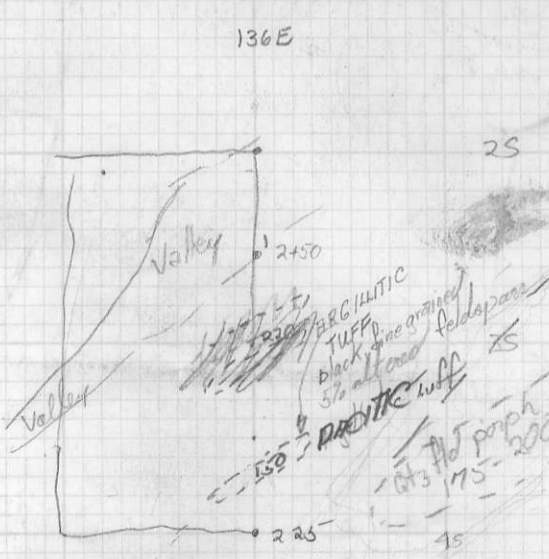

672743