

July 6th, 1969.

Mr. W.F. Knox,
President,
Ajax Mercury Mines Ltd.,
685 - #2 Bentall Centre,
Vancouver, 1, B.C.

Dear Mr. Knox:

Re: OK Falls - Proposed Virgo Claim Option
from E. Niddery - OK Falls

As requested by you, I visited the Virgo claim group on June 30th with the Niddery's. From the map, you will see the claims lie immediately north of the Lynx group. A large ridge running N-S terminates on Virgo claim #10, dropping off to an area of overburden cover and low relief. Outcrop on the ridge showed the coarse grained syenite, typical of the Lynx claims, and on Virgo 10 is a small showing of bornite with malachite stain, similar to the showings on the more southern claims.

Little or no bedrock is evident on the rest of the Virgo claims, 1-25; heavy float does not give an accurate indication of underlying rock type in that a variety of 3-4 rock types can be located within very few feet.

I did not see the claims on the east side of Allendale Lake due to the shortage of time after the northern examination.

I would recommend that Ajax option the northern group of Virgo claims to ensure coverage of the syenite plug; and at the same time give serious consideration to optioning the Agate, Doll, and Tammy claims, as bornite and malachite mineralization is present in this area also.

Yours truly,

BACON & CROWHURST LTD.

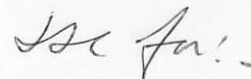

W.R. Murton

WRM/ic
cc: J.J. Crowhurst

c/c W.R.M.

EXAMPLE of type of sketch required

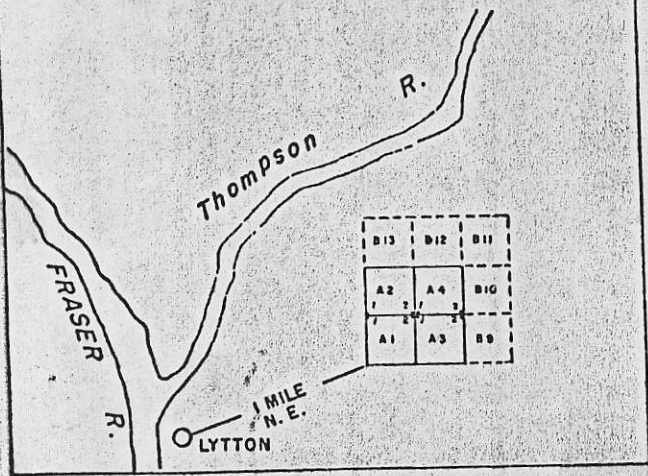

Claims must be tied by direction and distance to at least one, preferably more than one, topographical feature, or to a land lot, section, township, or other recognizable point on published maps of the district. Relations of previously located claims should also be shown.

N.B. — The sketch for a group of claims may be placed on one affidavit.

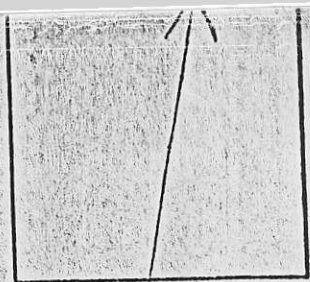

INDICATE NORTH (True or Magnetic)

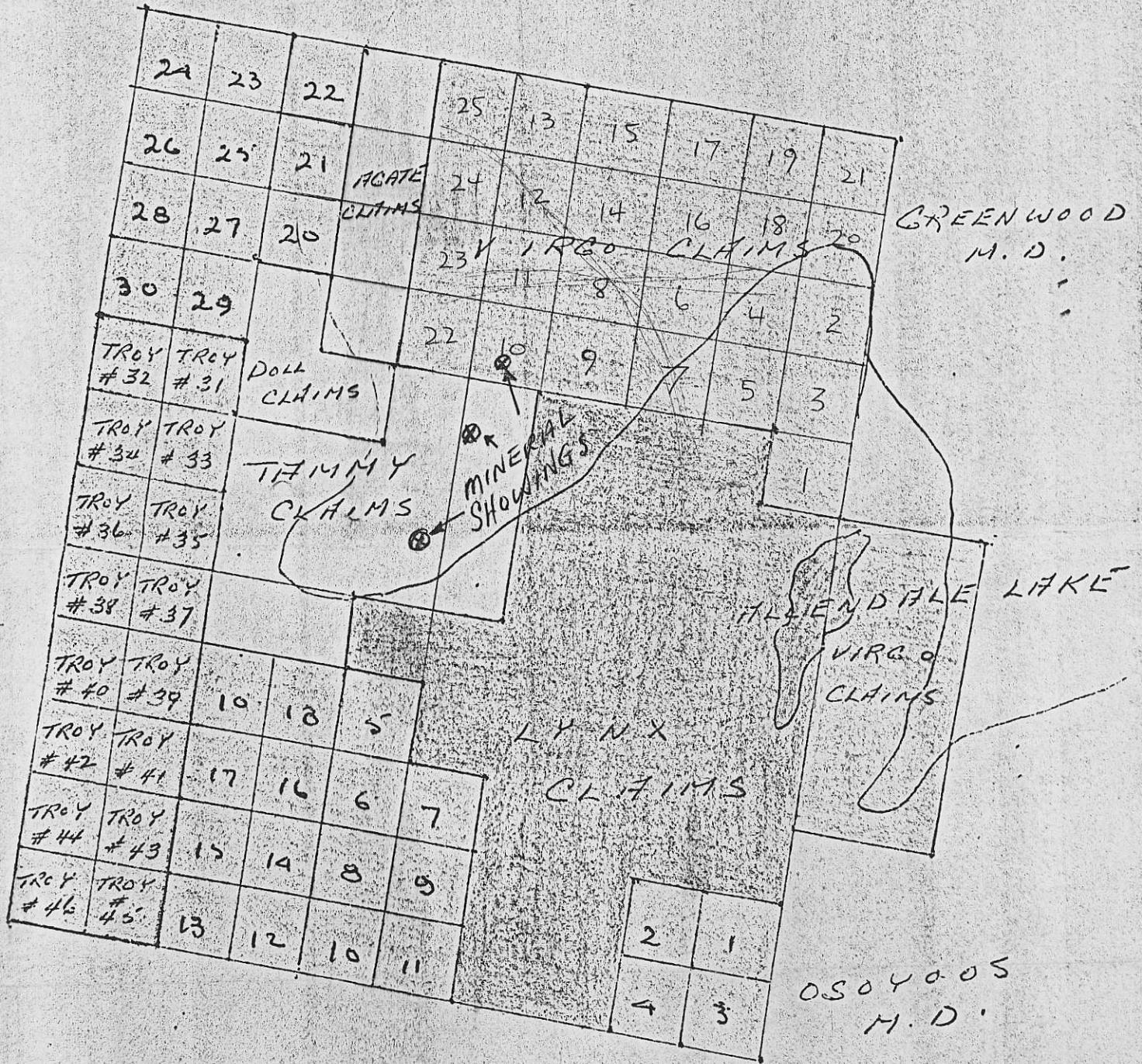

TROY 1 TO 46 - STAKED BY AJAX.

LYNX CLAIMS (33) ON OPTION TO AJAX.

VIRGO CLAIMS - ON HOLD FOR AGREEMENT WITH AJAX.

MR. W. Knox - Pres

Ajax Mercury Mines Ltd.,

685 - #2 Bentall Centre,

Vancouver, 1, B.C.

July 6/69

Dear Mr. Knox:

Re: ~~AXAX~~ MERCURY - OK FALLS - PROPOSED VIRGO
CLAIM OPTION FROM B. NIDDERY - OK FALLS

At the request of Bill Knox I visited the Virgo claim group on June 30 with the Nidders. From the map, you will see the claims lie immediately north of the Lynx group. A large ridge running N-S terminates on Virgo claim #10, dropping off to an area of overburden cover, & low relief. Outcrop on the ridge showed the coarse grained syenite, typical of the Lynx claims, & on Virgo 10 is a small showing of bornite with malachite stain, similar to the showings on the more southern claims.

Little or no bedrock is evident on the rest of the Virgo claims, 1-25; & heavy float does not give an accurate indication of underlying rock type in that a variety of 3-4 rock types can be located within very few feet.

I did not see the claims on the east side of Allendale Lake due to the shortage of time after the northern examination.

I would recommend that Ajax option the northern group of Virgo claims to ensure coverage of the syenite plug; & at the same time give serious consideration to optioning the Agate, Dell, & ^{TAMMY} Tammy claims, as bornite & malachite mineralization is present in this area also.

Yours truly,
BACON & CROWHURST LTD.

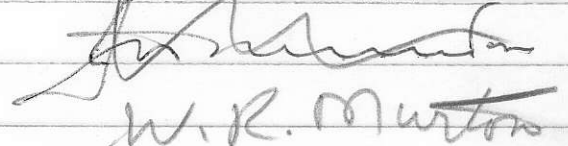
W.R. Murton

W.R. Murton

cc. W.R. Murton

a file