

672535

Aug 7/88

OLIVER to ASTRO 32

Check wades to NE

Up Profers Cr Rd + walk across
face of hill to east.Near or first crossed - black
chert - white glite change?

Pieces of loose + core box

Picked up 3 specimens. Nothing
much of interest.North to Twin lakes white l. just 725.7
(Observatory just)Entrance to St Andrews Golf strand
to (gravel pit?)

729.1

Road to east pickets

729.6

Pet Cemetery

731.6

North to Oropus Cr Rd 643.5 ? forest
 Up trail to bird cattle ground 644.2 ?
 Back to o.c. - Sample
 Then to highway - 645.2 ?
 Took sample partly from corner, partly by
 side of hwy.
 The to Willow Brook Rd (East) 646.2
 East to corner → N 646.9
 N to Jack Green Lake Rd Myrtle 647.3
 Lake at 650.3

$$\begin{array}{r} 362 \\ 288 \\ \hline \end{array}$$

ASTRO 32

SAMPLE 32-1 BLACK QTLITE WITH FINE

WHITE QTZ STRINGERS + MINOR FINE FRACTURES

SLIGHTLY RUSTY

SAMPLE 32-2 RUSTY QUARTZITE WITH LIMONITIC

HEMATITE

CAVITIES + FRACTURES, LIMONITE PAINT

ON MANY FRACTURES

SAMPLE 32-3 QTZ BRECCIA? HIGHLY SILICEOUS

MAINLY QUARTZ, HEMATITE, LIMONITE +

MINOR MANGANESE DENDRITES ON FRACTS

Back to ~~Main Property Rd~~ 616.6
 Just south of Power (MAIN) line
 Onto Main Rd at small power line 617.5

Put on E Side of Rd on CG
 Rusty frag gtz / cubic py - about only
 one in dump rocks generally barren
 granites

From approx. S. Boundary Rd 620.3
 To Drive at 621.2

Back to White Lake Rd 625.5
 Inct left - Sawmill 629.5

Inct on Small Power line 630.4

went left crooked - Inct 631.6 small pile

Burnell Lake at 633.0

Rec Site at 633.2

Back to Hwy 637.1

Turn off & left 638.4

ADIT @ 250° - X Cut No vein seen

Dump contains white gtz with minor cubic
 py, little sericite, minor epidote? or
 fine crystalline chlorite. Fragments granite
 have thin frozen veins white gtz.

Rock at adit - coarse, pinkish granite

SAMPLE (ADIT)

Back to Hwy at 638.6

N to Secret Rd 640.6

Road back to S on W side Hwy 642.2

0.3 km to right turn thru fence

In at Shaw Dr → West 578.7
 to Corner at Manery Dr 579.9
 SW to Main Rd 580.4
 W to Daly Drive 581.0

→ Short Street to NE & back to Rd 581.5
 In at Upper Bench Rd + Karamess Hwy 586.6
 In at Upper Bench + Lowe Rd 595.5

Base of Range to ~~the~~ East appears discolored
 & has small trails - Prospects ??

End of Pavement along A 597.0
 Blind Creek Turn 605.3 ←

Madden Pexley Inlet 607.8
 Split in Rd before Power line 608.2

Along Power line east block & line to gas line 608.9
 with branch Rd east. Lake to NE

Scrambles back & up gas line

To Madden L. Rec. Site 609.8?

Back to vole remnant, alt int, hem circ 610.1 *Tamp*

To branch Rd east 610.6 ←

east to jct + oc granite / vol remnant

(A) Rocks south around dry pond to Jct 611.6

Stop at top steep slope S of power line 613.3

& back to SW on grassy trail End 613.9

Back at 614.7

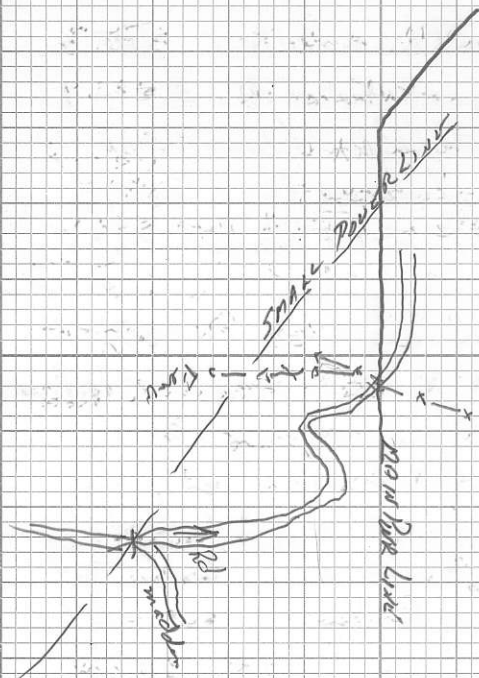

High Point, gasoline? 569.6

Black Creek turn 569.9

Intersection Main + Small Power line 571.6

Then small trail up to west of road

Fences + gas line 572.3

Road just 572.9

Ridge's Base to N + W.

End of trees - more open valley 574.8

Switchback on Creek 0.3, crossing
with rusty veg + tree line

576.9

577.9

Start pavement

Back to White L Rd Tavin L Rd Jct	515.3
Observatory Sign + Rd Jct	521.0
Fairview White L / Green L Rd Jct	528.4
" " / Secret Rd	532.7
" - / Jct Sign Ave	539.7

AUG 6

Oleiver

551

Fairview White L / Jct	559
------------------------	-----

Coats Drills + RC ? drill holes	563.3
---------------------------------	-------

at sheeps dump site on W Side Road

Side road to left near top of hump	564.3
------------------------------------	-------

Gate points Rd	564.9
----------------	-------

Back to humps	565.4
---------------	-------

Cattle guard + Fence line E-W?	566.1
--------------------------------	-------

Small road to left	567.1
--------------------	-------

Small power line + road to right	567.2	Madden Riple
----------------------------------	-------	--------------

Main power line	567.5	See sketch
-----------------	-------	------------

Marron Valley Rd	445.9
Asperant Valley SW Ranch Hse	457.5
Tapered Green Mtn Rd	457.0
Fourleg L	459.5
Greenh Rd	461.8
Trancl SW	
Apex Alpine jnct	469.0
Zone rusty oxidized + hematite	480
Highway	483.6 ⁵
Road to cut at 483.6 marked No Thru Rd	
Start Twin L. Rd	490.3
Westview Rd No Exp	492.8 around lake
went to	493.5 ends
Back to Twin L. Rd	494.1
+ To jnct / White L. Rd	495.1
Turn west (right)	
Fork w road	495.6
Corner right to take No Thru	496.2 EASTVIEW Rd
To end at	497.0
Back to Road	497.8 + trail to west
Fork at	499.0 Took lfr side
Start Horn Creek Forest Rd	
Rusty zones	499.7
Switch backout	502.4 and 504.2
Power Line @	505.5
Turned around in high open logged area	506.1

ASTRO PROV

AUG 5

W Ed Yellow L. 362.8

Sheep Creek Rd (Yellow Lake Rd?) 366.2

Road forks at 370

Cross tiny creek at 371.1

Turned back at 372.4

Pine + little poplar - logged area. Road continues. No rocks of interest.

Back to Hwy @ 378.3

Marion Valley Rd 382.7

Sign Protection Indian Bend No Trespass ^{Hwy} JUNCT 370

380 Cherry Ave - Highway Dept 408 km

"Chris" ? assures me Marion Valley Rd is a public road.

Back to Hwy Just 421 km

White Lake Rd 422.0 km

Central Okanagan Falls 427.6

Missed noting White L. Rd 4?

Turned left onto White L. Rd & to 435

Turned right at Pet Cemetery

Card marked Private Property 435.8

Get White L. Rd 436.7

Back to Hwy 438.7

Turn Left on 3A 439.4

Veering on S side of Rd 442.6