

671879
Maggie

CLINTON AREA

92 I/14 93 P/3

The Bethlehem MAGGIE property covers Cache Creek volcanics intruded by a biotite quartz porphyry. This intrusive may be of Triassic age.

The mineralization is west of the highway approximately below the creek and, below and east of, the old adits near the south end of the gossan on the west side of the valley.

The zone occurs at the north end of a magnetic low area at the intersection of ① a zone of lows trending NNW and ② an indefinite ridge of magnetic highs trending east.

A somewhat similar intersection occurs on sheet 92 I/14 in the extreme NW corner.

A disruption of the magnetic lows occurs at the NE corner of the Bonaparte Indian Reserve three miles north of Cache Creek.

A relatively broad magnetic low occurs on sheet 92 P/3 north of Wohlleben Lakes. This may be caused by (a) a granitic intrusive, or (b) a sedimentary basin.

These three areas should be checked for ① granitic intrusives ② hydrothermal alteration, ③ geochemical anomalies.



6

Bethlehem Claim Holdings

5

4

23082	CRO	
17		
11E		
0	80234E	80304E
5	CRO	CRO
1	77476	80307E
1	CRO	CRO
16		
3	77478	80303E
3	CRO	CRO
14C		
20B		
10	80304E	
3C	CRO	
15		

77595	77597(0)	77599(0)	77601(0)	77603(0)	77605(0)	77607(0)
ALEX	ALEX	ALEX	ALEX	ALEX	ALEX	ALEX
95	97	99	101	103	105	107
77596	77598(0)	77600(0)	77602(0)	77604(0)	77606(0)	77608(0)
ALEX	ALEX	ALEX	ALEX	ALEX	ALEX	ALEX
96	98	100	102	104	106	108
77588	77586(0)	77584(0)	77582(0)	77580(0)	77578(0)	77576(0)
ALEX	ALEX	ALEX	ALEX	ALEX	ALEX	ALEX
88	86	84	82	80	78	76
77587	77585(0)	77583(0)	77581(0)	77579(0)	77577(0)	77575(0)
ALEX	ALEX	ALEX	ALEX	ALEX	ALEX	ALEX
87	85	83	81	79	77	75
77586	77584(0)	77582(0)	77580(0)	77578(0)	77576(0)	77574(0)
ALEX	ALEX	ALEX	ALEX	ALEX	ALEX	ALEX
63	65	67	69	71	73	
77562	77560(0)	77558(0)	77556(0)	77554(0)	77552(0)	77550(0)
ALEX	ALEX	ALEX	ALEX	ALEX	ALEX	ALEX
62	64	66	68	70	72	74
77558	77556(0)	77554(0)	77552(0)	77550(0)	77548(0)	77546(0)
ALEX	ALEX	ALEX	ALEX	ALEX	ALEX	ALEX
59	60	58	56	54	52	50
77557	77555(0)	77553(0)	77551(0)	77549(0)	77547(0)	77545(0)
ALEX	ALEX	ALEX	ALEX	ALEX	ALEX	ALEX
57	57	55	53	51	49	
77537	77535(0)	77533(0)	77531(0)	77529(0)	77527(0)	77525(0)
ALEX	ALEX	ALEX	ALEX	ALEX	ALEX	ALEX
37	39	41	43	45	47	
77538	77536(0)	77534(0)	77532(0)	77530(0)	77528(0)	77526(0)
ALEX	ALEX	ALEX	ALEX	ALEX	ALEX	ALEX
38	40	42	44	46	48	
77534	77532(0)	77530(0)	77528(0)	77526(0)	77524(0)	77522(0)
ALEX	ALEX	ALEX	ALEX	ALEX	ALEX	ALEX
36	34	32	30	28	26	
77535	77533(0)	77531(0)	77529(0)	77527(0)	77525(0)	77523(0)
ALEX	ALEX	ALEX	ALEX	ALEX	ALEX	ALEX
35	33	31	29	27	25	
77511	77509(0)	77507(0)	77505(0)	77503(0)	77501(0)	77499(0)
ALEX	ALEX	ALEX	ALEX	ALEX	ALEX	ALEX
11	13	15	17	19	21	23
77522	77520(0)	77518(0)	77516(0)	77514(0)	77512(0)	77510(0)
ALEX	ALEX	ALEX	ALEX	ALEX	ALEX	ALEX
12	14	16	18	20	22	24

ARTICHO

SEE MAP 92 I/14E

3

2

1

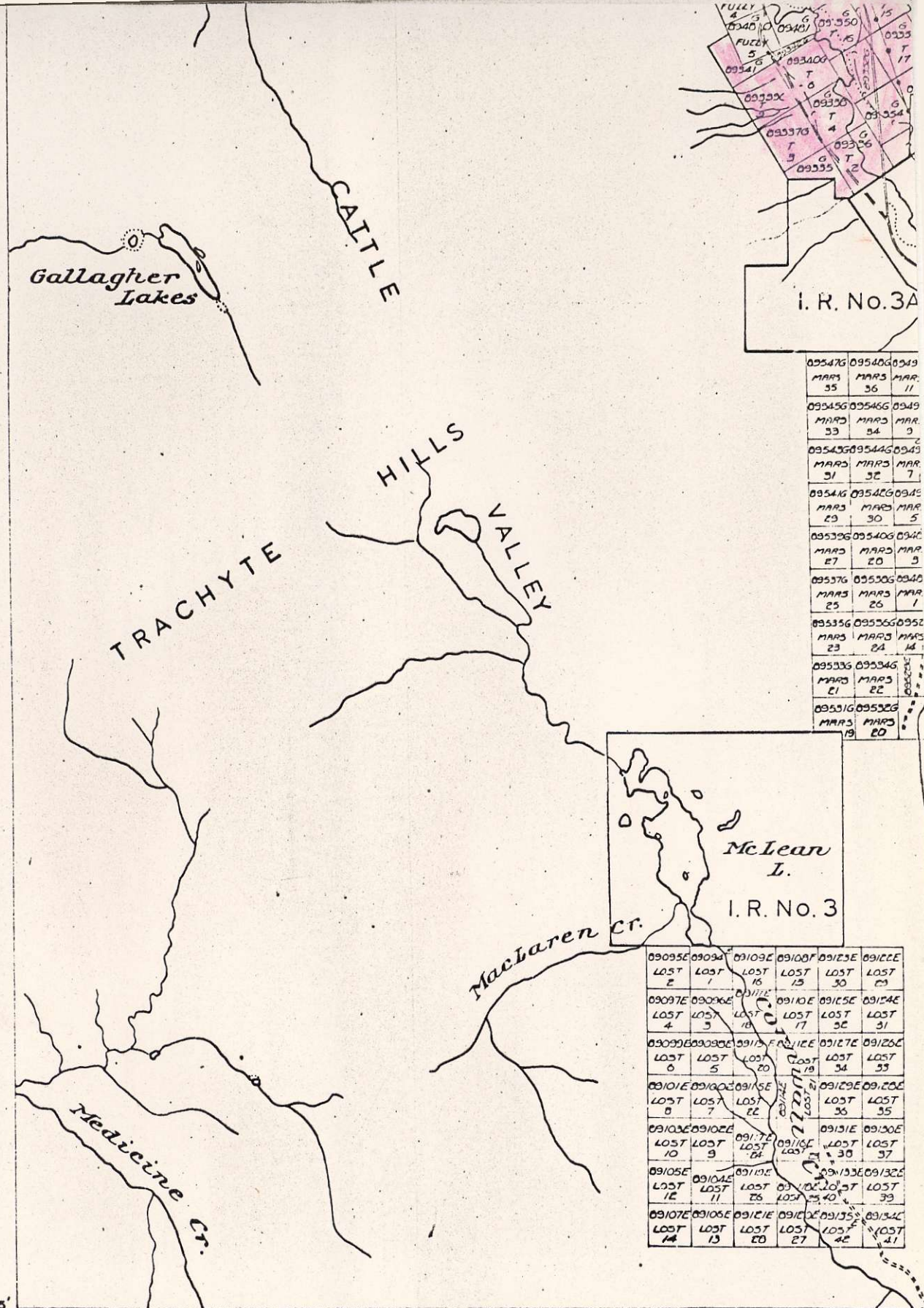

I. R. No. 3A

095476	095406	09549
MAR 35	MAR 36	MAR 11
095456	095466	0949
MAR 53	MAR 54	MAR 9
095436	095446	0943
MAR 31	MAR 32	MAR 7
095446	095426	0945
MAR 29	MAR 30	MAR 5
095396	095406	0946
MAR 27	MAR 28	MAR 3
095376	095306	0940
MAR 25	MAR 26	MAR 1
095356	095366	0952
MAR 23	MAR 24	MAR 14
095336	095346	
MAR 21	MAR 22	
095316	095326	
MAR 19	MAR 20	

McLaren I. I.R. No. 3

09095E	09094E	09109E	09108E	09123E	09122E
LOST 2	LOST 1	LOST 16	LOST 15	LOST 30	LOST 29
09097E	09096E	09110E	09109E	09124E	09123E
LOST 4	LOST 3	LOST 17	LOST 16	LOST 31	LOST 30
09099E	09098E	09111E	09110E	09125E	09124E
LOST 6	LOST 5	LOST 18	LOST 17	LOST 32	LOST 31
09101E	09100E	09112E	09111E	09126E	09125E
LOST 8	LOST 7	LOST 19	LOST 18	LOST 33	LOST 32
09103E	09102E	09113E	09112E	09127E	09126E
LOST 10	LOST 9	LOST 20	LOST 19	LOST 34	LOST 33
09105E	09104E	09114E	09113E	09128E	09127E
LOST 12	LOST 11	LOST 21	LOST 20	LOST 35	LOST 34
09107E	09106E	09115E	09114E	09129E	09128E
LOST 14	LOST 13	LOST 22	LOST 21	LOST 36	LOST 35
09109E	09108E	09116E	09115E	09130E	09129E
LOST 16	LOST 15	LOST 23	LOST 22	LOST 37	LOST 36
09111E	09110E	09117E	09116E	09131E	09130E
LOST 18	LOST 17	LOST 24	LOST 23	LOST 38	LOST 37
09113E	09112E	09118E	09117E	09132E	09131E
LOST 20	LOST 19	LOST 25	LOST 24	LOST 39	LOST 38
09115E	09114E	09119E	09118E	09133E	09132E
LOST 22	LOST 21	LOST 26	LOST 25	LOST 40	LOST 39
09117E	09116E	09120E	09119E	09134E	09133E
LOST 24	LOST 23	LOST 27	LOST 26	LOST 41	LOST 40

50°45'

121°30'

TO SOUTH SE

For up-to-date information on claims in any area you should apply to the Mining Recorder for the Mining Division concerned.

DEPARTMENT OF MINES AND VICTORIA
MINERAL CLAIM

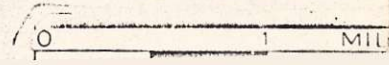

LILLOOET
KAMLOOPS

M.E.
M.D.

L 3533
L 3535
L 3537
L 3539
L 3538
L 3536
L 3534
M 41
M 47

6

Forward
Gulch

51

4

SEE MAP 92 I/13 E

I.R. No. 2

Hat
Creek

Carquile

Carquile

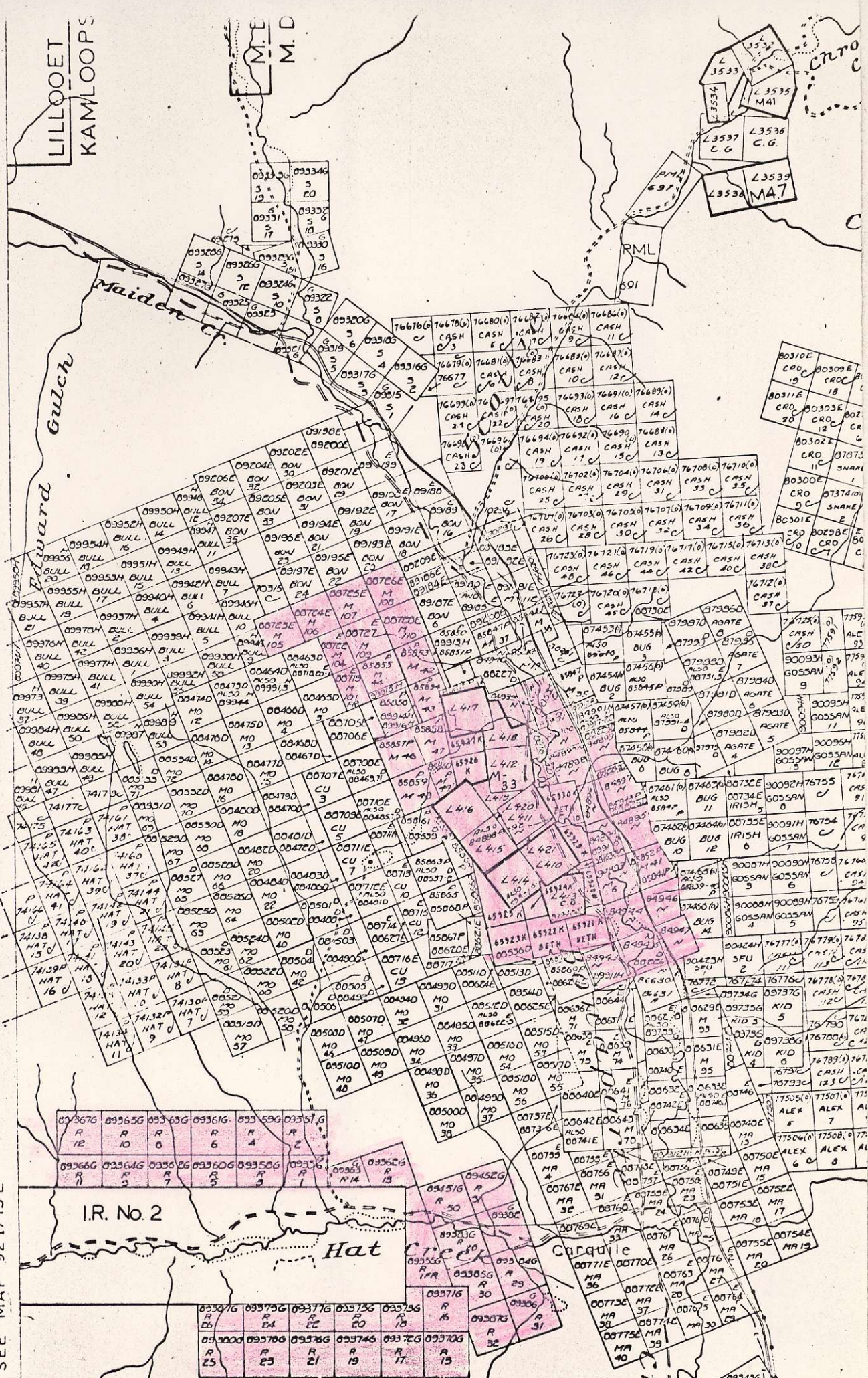

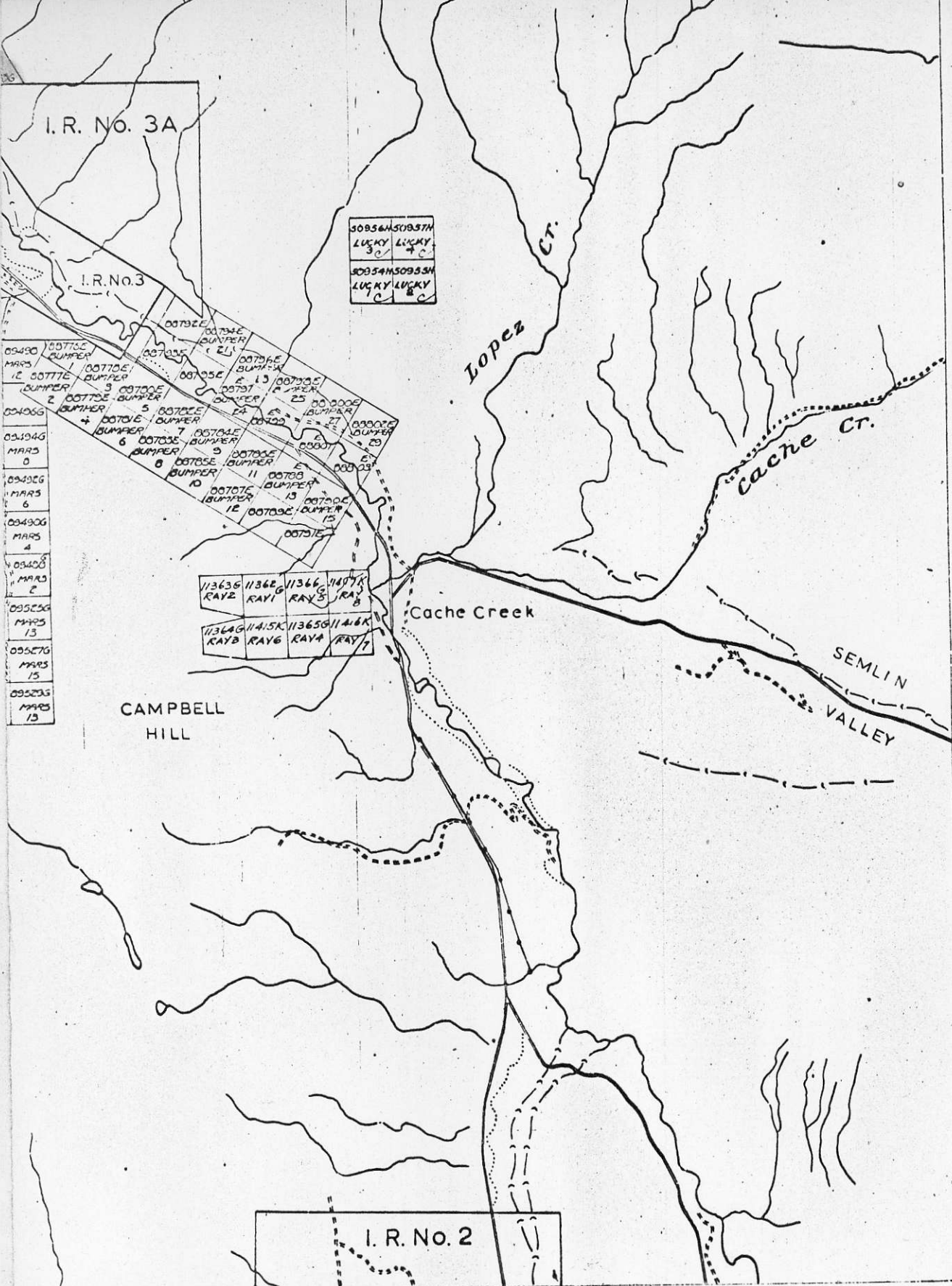

09490	00775C	BUMPER
MARS	1	
09491	00776C	BUMPER
MARS	2	
09492	00777C	BUMPER
MARS	3	
09493	00778C	BUMPER
MARS	4	
09494	00779C	BUMPER
MARS	5	
09495	00780C	BUMPER
MARS	6	
09496	00781C	BUMPER
MARS	7	
09497	00782C	BUMPER
MARS	8	
09498	00783C	BUMPER
MARS	9	
09499	00784C	BUMPER
MARS	10	
09500	00785C	BUMPER
MARS	11	
09501	00786C	BUMPER
MARS	12	
09502	00787C	BUMPER
MARS	13	
09503	00788C	BUMPER
MARS	14	
09504	00789C	BUMPER
MARS	15	

11363	11364	11365	11366
RAY2	RAY1	RAY3	RAY4
11367	11368	11369	11370
RAY5	RAY6	RAY7	RAY8

MAP 92I/11W

121° 15'

50° 45'

PETROLEUM RESOURCES
IA, B.C.

MAP 92I/14W (M)

This map is prepared to serve as a guide to the positions of located mineral claims and Placer Mining Leases only. Unsurveyed claims and leases are plotted from locators' sketches and are not guaranteed. Letters C.G. indicate claim is Crown-Granted. Symbol 'C' indicates claim has forfeited.

29/12/70

92I/14W (M)