

Legend

- Veins --- cte veins
5mm
- ① barren coarse gr. cte vein 1 cm wide
 - ② same 2 cm wide avg
 - ③ 3 cm wide avg bits at 27m on claim
 - ④ 3.5 cm wide
 - ⑤ 1/4 cm wide 17 2/3° E
 - ⑥ 7/10, 2cm, 3-4' long
 - ⑦ no orient'n
 - ⑧ 1cm wide rusty cte vein
 - ⑨ 75-90cm width of vein 20cm of abundant galena on footwall side with minor sphal, silicification, followed by (thick hanging wall) 50cm of highly altered (punky) black Mn stained and rusty orange vein material (altered sphal, galena) super friable
 - ⑩ trend of vein 258/835 - foot ck adj. to footwall of vein, altered gfp, minor Mn staining, rusty
 - ⑪ 266/90
 - ⑫ 1cm gtz-cte vein
 - ⑬ sil, Mn stained, rusty spot, some cte, 3cm wide 262/90
 - ⑭ 15cm wide bx vein 273/90 - small cte vein in centre w/ gfp altered bx in dark Mn stained matrix - less bx further up, up to 40cm wide
 - ⑮ 261-15cm wide see ⑫
 - ⑯ 250/90 25cm wide cte veining, trend 250° heavy Mn staining assoc w/ silicification, some gfp frags
 - ⑰ 250/70-755 same as ⑯ 50cm
 - ⑱ 276/85N 15cm, 3cm cte vein surrounded by sil, Mn, sil, rusty faults

I. g. blue to purplish natrv
buff to slightly rusty weath surface
4% black 1-3mm mica flakes
20% fsp phenocrysts white & slightly
60% gtz
5% sil phenos
fsp phenos of iron weathered → kaolined.

small, rounded gtz
filler mainly in argon weathered gfp float
some altered gfp - argon
diabase dyke r. - argon

0'
-25'
-50'
-75'
-100'
-125'
-150'
-155'
-175'
-180° = 25'
-200'
-26-30'

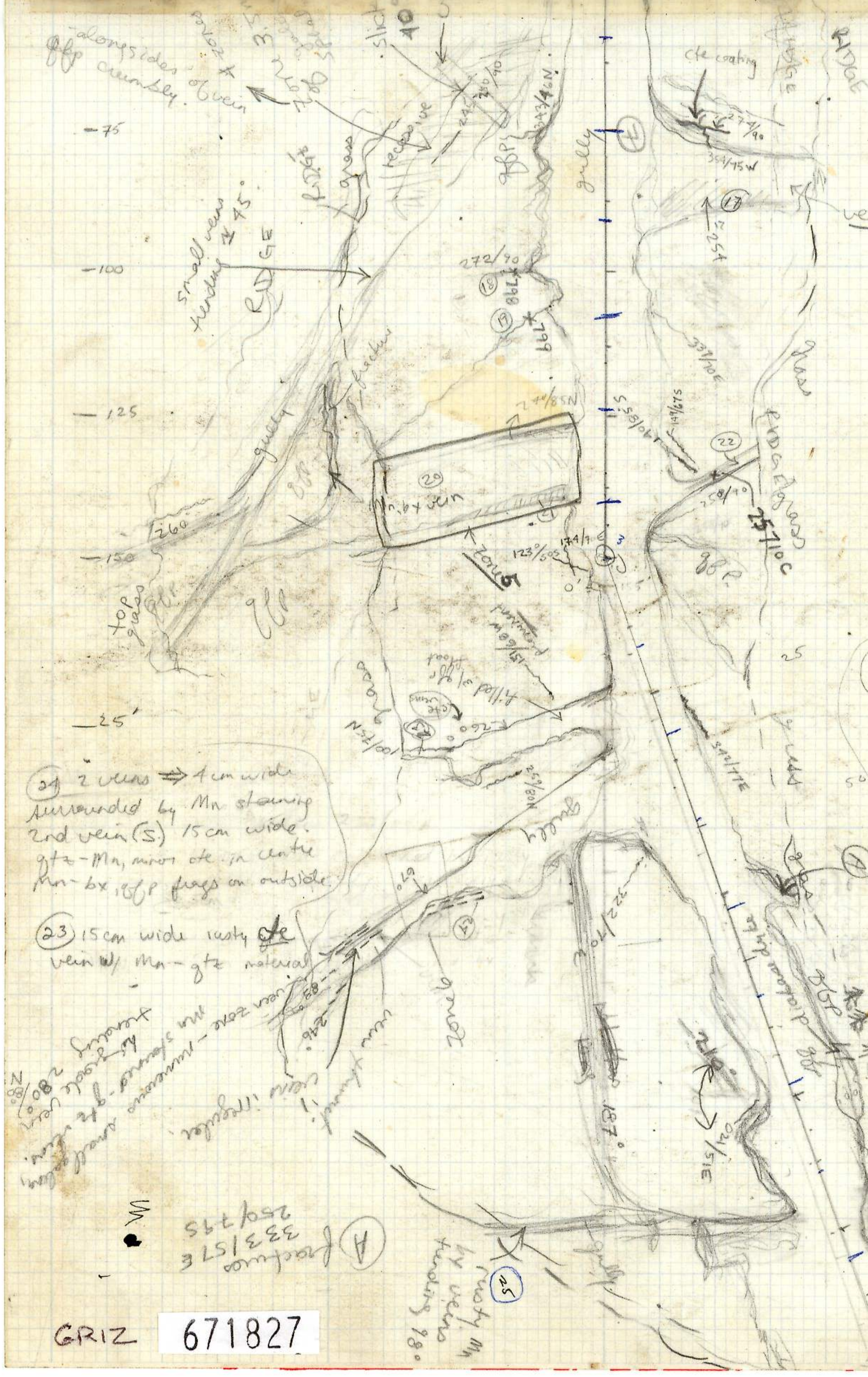

Aug 8+9/81

off by page
Mn-gtz matrix
3' of altered, crumbly
gfp
1' vein sil, Mn, small
rusty area.

- ⑱ 2cm wide sphal vein rusty
- ⑲ vein zone 4.
- ⑳ 260/90, 3cm wide sphal-cte ± 2cm cte in centre.
- ㉑ Zone 5 3m wide 270/85N
- ㉒ 10-15cm at base - heavily Mn stained - some gfp frags. - two centre of zone, vein has 2.5cm gtz rich vein material some Mn - trends S., 2m of gfp - 40cm vein with 10cm gtz zone on HW side, with 15cm gfp in centre, 15cm Mn, 5cm gfp, 2.5cm gtz side - footwall soft, sugary very friable gfp cub. - light yellow-pinkish gtz w/ rusty altered 1/2 cm gfp frags.
- on HW before gtz vein 5cm zone of Mn III FW Mn zone. 1/2cm cte vein beside HW.
- ㉓ vein zone trending 250/85N FW - 15cm g. of Mn stained bx, rusty, v. lightly altered gfp - friable.
- 30cm gtz minor cte vein, heavy, Mn stained, buff weath, sticks out in relief, with 5cm of gfp in centre from HW - 5cm of sil Mn stained bx

Aug 9/10, 1981
PLAN 1:300

⑳ 2 veins → 4cm wide surrounded by Mn staining 2nd vein (S) 15cm wide. gtz-Mn, minor cte in centre Mn-bx, gfp frags on outside.

㉑ 15cm wide rusty cte vein w/ Mn-gtz material

⑳ 2 veins → 4cm wide surrounded by Mn staining 2nd vein (S) 15cm wide. gtz-Mn, minor cte in centre Mn-bx, gfp frags on outside.

⑳ 2 veins → 4cm wide surrounded by Mn staining 2nd vein (S) 15cm wide. gtz-Mn, minor cte in centre Mn-bx, gfp frags on outside.

⑳ 2 veins → 4cm wide surrounded by Mn staining 2nd vein (S) 15cm wide. gtz-Mn, minor cte in centre Mn-bx, gfp frags on outside.

GRIZ 671827