

671634

REPORT
on
PROPOSED DIAMOND DRILLING PROGRAM
1969

for
ALVIJA MINES LTD.

by
R.W. PHENDLER, B.Sc., P.Eng.

Vancouver, B.C.

March 20th, 1969.

ALVIJA MINES LTD.

On March 14th, 1969, the property of Alviija Mines Ltd. was visited with the purpose of examining and sampling some recently discovered mineral showings and to survey drill sites for the coming diamond drilling program.

The accompanying sketch map shows the locations of diamond drill holes A1, A2, A3 and A4, which were drilled in 1968. Drill holes B1, B2, B3 and B4 are also shown. These holes were laid out on the ground and are to be drilled in the next few months.

The purpose of the 1969 drilling program is to complete fill-in drilling on the principal mineral showing, to check for a northerly extension on this zone and to check for depth possibilities of the new North showing.

The following chip samples were taken during the examination:

<u>Sample No.</u>	<u>Area</u>	<u>Width</u>	<u>% Cu</u>	<u>Oz./ton Ag</u>
9358	North showing	15'	0.18	0.14
9359	" "	15'	0.18	0.22
9360	" "	2'	0.06	0.02
9361	" "	5'	0.19	0.12
9362	Chris Zone	15'	0.63	0.26
9363	" "	10'	0.31	0.25

The Chris Zone lies about 2500' to the east of the principal showing on an unsurveyed cat road. The width is 25.0' and shows speckled chalcopyrite in a fracture zone within purplish, medium-grained andesite. Quartz veining with epidote alteration is predominant and the zone warrants additional prospecting.

Drill holes B1, B2 and B3 should be drilled to 500' each. Drill hole B4 should be drilled to 300' and the remaining 700' of the proposed 2500' program should be where results from the first four holes dictate, either south of hole B4 (about 150') or north of B3.

All recently completed cat roads should be surveyed and mapped on a scale of 100' to 1".

Respectfully submitted,
BACON & CROWHURST LTD.

R.W. Phendler, B.Sc., P.Eng.

RWP/ic

299-6466

	<u>hw.</u>	<u>Ag</u>
9358	0.18	0.14
9359	0.18	0.22
9360	0.06	0.02
9361	0.19	0.12
9362	0.63	0.26
9363	0.31	0.25

255-8488 } - Alvisa

ALVISA MINE, LTD

On March 14 1969 the property of Alvisa Mines Ltd was visited with the purpose of examining and sampling some recently discovered mineral showing and to survey drill sites for the coming diamond drilling program.

The accompanying sketch map shows the locations of diamond drill holes A1, A2, A3 and A4, which were drilled in 1968. Drill holes B1, B2, B3 and B4 are also shown. These holes were laid out on the ground and are to be drilled in the next few months.

The purpose of the 1969 drilling program is to complete fill-in drilling on the principal mineral showing, to check for a northerly extension on this zone and to check for depth possibilities of the new North showing.

The following chip samples were taken during the examination:

<u>Sample No</u>	<u>AREA</u>	<u>WIDTH</u>	<u>% Cu</u>	<u>Oz/Ton of Ag</u>
9358	NORTH SHOWING	15'	0.18	0.14
9359	"	15'	0.18	0.22
9360	"	2'	0.06	0.02
9361	"	5'	0.19	0.12
9362	CHRIS ZONE	15'	0.63	0.26
9363	"	10'	0.31	0.25

The Chris zone lies about 2500' to the east of the principal showing on an unsharved cat road. The width is 25.0' and shows speckled chalcopyrite in a fracture zone within purplish, medium-grained andesite. Quartz veining with epidote alteration is predominant and the zone warrants additional prospecting.

Drill hole B1, B2 and B-3 should be drilled to 500' each. Drillhole B-4 should be drilled to 300' and the remaining 700' of the proposed 2500' program should be where results from the first four holes dictate, either south of hole B-4 (about 150') or north of B-3.

all recently completed cut roads should be surveyed and mapped on a scale of 100' to 1".

Respectfully submitted

Baca & Cronhurst, Ltd

R. W. Pender



X Grab Sample 9360
0.06% CU, 0.02 OZ. AG - 2.0'

Sample 9361 Malachite Specks
0.19% CU, 0.12 OZ. AG
- 5.0'

Sample 9359 - 0.18% CU, 0.22 OZ. AG - 15'

Sample 9358 - 0.18% CU, 0.14 OZ. AG - 15'

North Showing

WATER
2200' EL.

ALVIJA MINES LTD. (N.P.L.)
TERRACE, B.C.

PLAN OF SHOWINGS, 1968 DRILL HOLES,
PROPOSED DRILL HOLES, AND RECENT SAMPLING

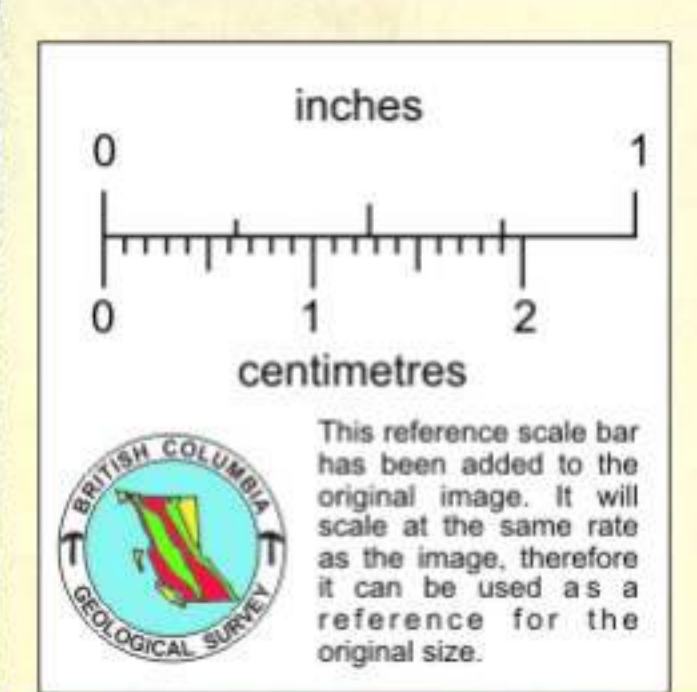

SCALE: 1" = 100'

MARCH 14, 1969

BACON & CROWHURST LTD.