

OPINION RE THE NICK OF TIME  
AND COPPER CHIEF CLAIMS

April 23rd, 1946.

The property of the Hedley Mascot Gold Mines Limited is located on the westerly slope of Nickel Plate Mountain, in the Similkameen Mining Division of B. C.

The claims owned and leased by the company lie west of the Kelowna Exploration property and in the same geological province. The geology of the mountain has been described by Camsell and Bostock of the Dominion Geological Survey, and the ore deposits in detail by Billingsley and Hume in 1941, and Dolmage and Brown in 1945. These deposits, generally speaking, are tabular-like masses. The ore bodies consist of gold-bearing sulphides disseminated in skarn and altered limestone, with a general dip about 30° to the west. The limestone and skarn have been cut by porphyry dykes and sills, and it is along these dykes and sills in the skarn that the ore bodies generally occur.

The particular claims under discussion, namely the Nick of Time and Copper Chief, owned by the Pollock Mines Ltd. and James Fraser Campbell and leased to the Hedley Mascot Mining Company, are located west of the Mascot Fraction, but separated from the latter by the Morning Claim and Copper Cleft Claim of the Kelowna Exploration Group, the minimum separation distance being about 100 feet. The relative positions of the claims are shown on the attached sketch plan.

The dip of the formation is from the Mascot into the Nick of Time, and it has been shown by the geologists of the two properties that the ore bodies have followed the dip from the Kelowna Exploration, through the Mascot, into the Nick of Time. This is illustrated by the cross-section sketch attached.

Entry to the Mascot Fraction was made first from the Copper Chief Claim - the 4800 level - then a lower tunnel was driven from the Nick of Time Claim - 4300 level - and later the 3700 level was driven from the Czar claim, and through the Zeerust Claim. A number of diamond drill holes were also driven.

Ore was located in a short cross cut from the main 3700 ft. level, not far from the boundary between the Nick of Time and the Morning claim of the Kelowna Exploration Group, where an exposure of 31 feet was made. Fifteen feet of this averaged 1.70 oz. gold per ton. Diamond drill holes cut the ore below the level, and samples of intersections are as follows:- At 75 feet below the level, 17½ feet averaged 1.20 oz. per ton. A continuation of this ore 100 feet below the level averaged 1.26 oz. over 9.5 feet, and another intersection near the footwall of the zone, and about 130 feet below the level, gave 0.25 oz. over a width of 6 feet. The dip of the favourable formation, as shewn on the accompanying section, would carry this ore below the 3700 ft. level, and the major portion of the tonnage from this claim will come from the ground below this level.

No ore has been located on the Copper Chief claim, but the Kelowna Company is working on the Copper Cleft and Climax Claims, and any ore on these claims should dip into the Copper Chief at least 1000 feet below the 4800 level.

No estimate can be made of the tonnage available on the two claims, but there can be no doubt that ore underlies the 3700 level on the Nick of Time claim, and indications are that the tonnage extracted will equal, if not exceed, the amount produced from the Mascot Fraction.

The Mascot Fraction produced 572,000 tons of ore from an area of 7.8 acres. The gross value was \$7,072,938.00, at \$16.00 per ton, and dividends paid up to December, 1943, amounted to \$1,209,554.00

There is a greater area on the Nick of Time under which the ore zone may extend, which is one of the reasons for the assumption that the Nick of Time will produce a larger tonnage than the Mascot. Then there is the possibility of the Copper Chief being productive, and the work now being done on the Kelowna ground lends support to the opinion that this claim will also produce an important tonnage.

While there is very little ore exposed on either of these two claims, their worth lies in the position they occupy relative to the Mascot Fraction and the Kelowna Exploration ground. The ore bearing formation dips into the Nick of Time from the Mascot Fraction and the Morning claim, and any ore found on the Copper Cleft will dip into the Copper Chief.

For the above reasons, I consider the claims under consideration very valuable, and have been astonished to find that the Mascot Company only held them under lease. Why the Company did not obtain an option for outright purchase at the time they negotiated the lease, I cannot understand.

Respectfully submitted,

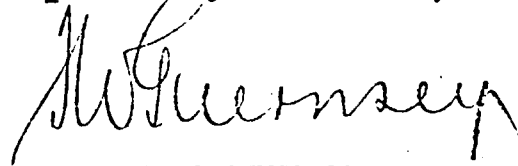

F. W. GUERNSEY

Vancouver, B. C.  
April 23rd, 1946.

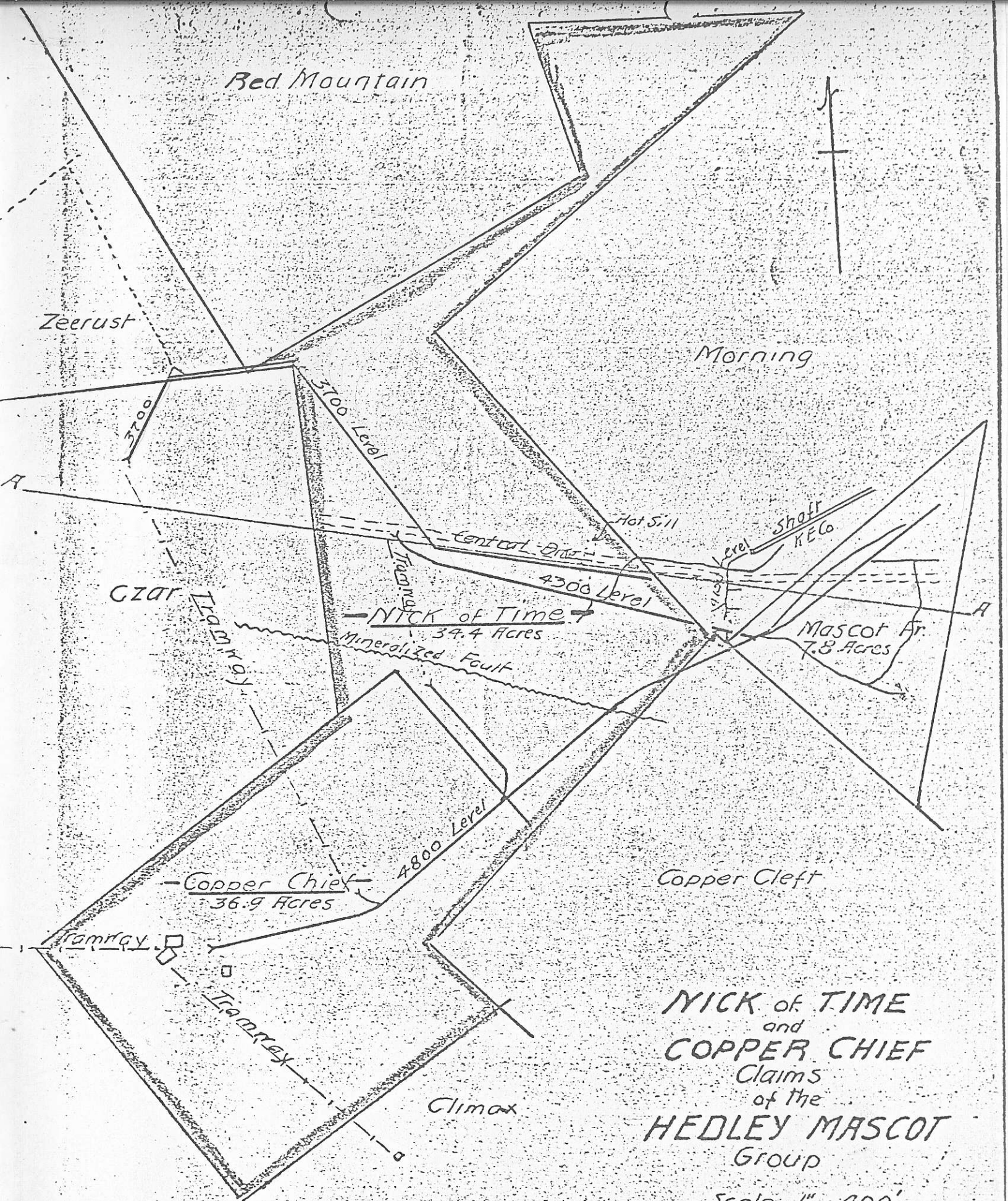

**NICK of TIME**  
and  
**COPPER CHIEF**  
Claims  
of the  
**HEDLEY MASCOT**  
Group  
Scale 1" = 400'

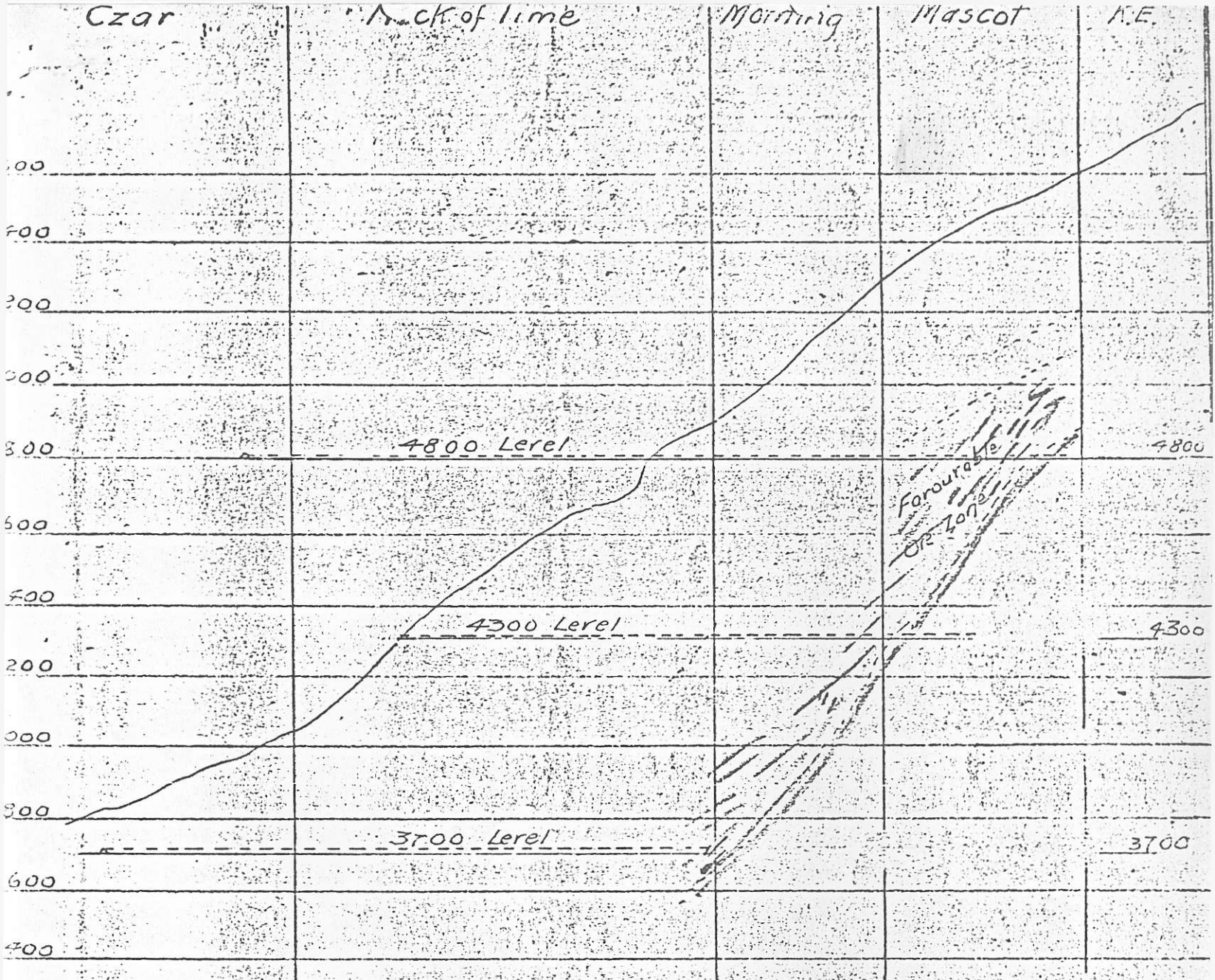

- Limestone
- Skarn
- Porphyry
- Ore

Section A-A  
 — NICK of TIME —  
 and  
 — COPPER CHIEF —  
 Claims  
 of the  
 — HEDLEY MASCOT —  
 Group  
 Scale 1" = 400'