

671262

Jean 93N/2  
J.W. Project AUG 16/70

LINE 224W

70N - 78N with minor creek  
at 76N

Hit CL at 224W 82+40N

10' E of L 16W ON ✓

Brg on Picket Line 27°

L 124 1+25N on CL at 4+60 Chani  
channeling on 23+40 W on sampling  
Creek at 25W

#1 - JW 57, 58 at 28W. in ~~an~~ some  
open area black spruce

L 8W 075N on CL @ (800-85) = 715' E of ✓  
post +

4 800 on CL is 20' W of creek

at Tag 5 is red tag 915'

00E 00N of sample grid at #1 JW 53-54

L 00E 6N Creek

14N Cornerburn on E Side Creek

18N Creek  
28N #1 - JW 25-26

#1 - JW 27-28 at ADW ~~001~~ II 00W 000

From #1-25, 26 CL @ 105° 250' to Creek

At 800' paced east tag L 8E 28N

(11) 40' E to probable OC micaceous  
granite. Spent 140' step N  
Small creek at 1000?

# 1. Jul 23, 24 at 1420' in Creek  
 +930' Strip old timber line at 100'  
 1250' ? 15 post at 50' E of small Creek  
 Then 300' to edge green timber - 50'  
 to small burn opening then green timber

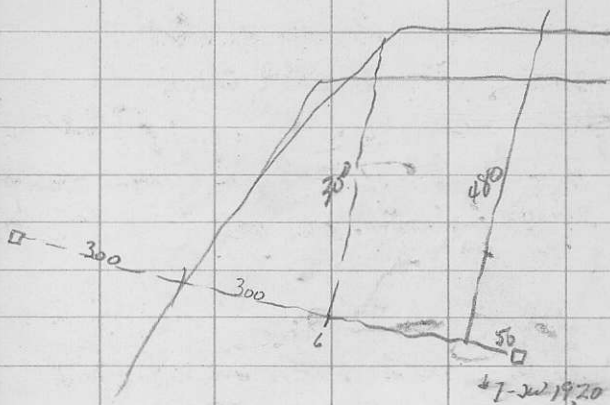

From #1 Jul 19-20 200' to small creek  
 at 800' pass 850' N25E to opening  
 on edge burn

At 650' on way back Sample 248E 32N  
 CL at 248E 30+25N Thence 75'  
 to 7000 (5) on CL  
 Creek at 10+70  
 Creek at 12+65

#1 JW 17, 18 at about 13+80'

Gully @ 80'

Post at about 13+70

Sample on ridge south of pond (550' S of post) L64E 28N

64E 11+70N Creek

8N swampy creek

L41E - on 20'E of 8 on CL

L56E - 080N on CL 130' E of #1 JW 45, 46

Post is 40' N of E end narrow creek

Set JW-83 on creek 300' W of #1 JW 45, 46

L48E ON is 600' E of #1 - JW 47-48 ✓

Set JW 81 on creek 250' W of #1 JW 47-48 ✓

L32E ON at 400' E of #1 JW 49-50 ✓

JW 80+ Trail start at creek 300' E of #1 JW 49-50 ✓

JW 79 on creek 50' E of #1 - JW 49-50 ✓

JW 78 on creek 1150' E of #1 - JW 51-52 ✓

L24E ON at 1000' E of #1 - JW-51-52 ✓

JW-76? at 800' E of " -

JW-76 at 600' E of " -

Good game trail

JW 75 at 500' E of " -

L16E ON at 200' E of " ✓

L 82 020N at 9+50E of #1 JW 53-54

JW 74 @ 7+60E of #1 - JW 53-54

Main creek at 224W 55+50N

CL at 54+75N 300' E of #1 JW 85-86

Aug 17/70

Creek on 28NBL at 201+50W.

206W on edge heavy bush

28N - 212W at sample 12W 40N

28+50N, 224+15W = Sample 24W 42N

28N 232+10W = " 32W 42N

27+90N 239+90W = " 40W 42N

Thence 300' S on line + 40' W to

(12) rubble under tree root - Fresh c.g.

biotite granodiorite - <sup>fairly</sup> strong magnetic  
grey to slightly pinkish, somewhat porphyritic  
appearance on weathered surface, slightly  
altered hornblende

Sample 40W 36N near NW edge camp

Thence to 40W 36N + 60' S to base ridge

(13) at 245° + 95° - oc similar to (12)

fairly strong mag.

Sample 31W 9N about 50' W of line oc of g

pale grey green to dark green vol. Can't see  
massive andesite.

Thence NW over vol oc to ~~the~~

+ up N side in oc vol with minor

(14) skarn - epidote pop off

Circled around noses of ridges in  
skarn area to relatively unaltered  
vol 100' W of 44W 20N

OC west of 44W 28N altered - fine chales  
L 48W 26N OC area black fg vol  
dmp. slightly porph., jointing  $035^{\circ}$ - $040^{\circ}$   
Minor pyrite.

Aug 18/70

Out past old Alpha camp +  
west on CL - 40W ON at 200'  
E of #1 SW 59+60 in black spruce  
+ pine. Post on SE side very small  
creek opening. Then 400' west to  
small opening 100' E of second growth.  
in burn L48W ON on edge burn  
56W ON in burn 50' E of #1 SW 61-62 ✓  
(Just claim only 1200' ? 1000'?)

Very small E-W gully 40' N of post. + 100'  
W - edge older bush, orange flag at 300'  
Orange flag marked (4) at 500' - apparent  
gradual NW site larger timber.  
L64W ON at 750' W of post. ✓

Orange flag at 900' on SE edge dense  
bush off very low rise to SE

Post #1 SW 63, 64 at 1300' in  
dense spruce

255  
13A  
13

#1300' W of #1 SW 63-64 on granular  
mg horrible granodiorite - crumbly.  
Fair to weak mag. Sharp jointing  
at 160° + 260° #1 Post SW 65-66 at  
1350' Creek at 225'

at 350' W of post L88WON in SW  
at Tag 5.

From next post 400' ? to soil line 104WON  
in opening in black spruce

130' post " 112WON

870' post " L 120WON

Thence 330' to post on crest drift ridge

Post missed at about 1350' from post  
on contact.

SW 65 - 200' ? E of v. 33, 34

L 40W 28N near orange flag on SW side  
drier slope about 50' W of " 31-32

AJ-3 - 200' E of post



AUG 18/70

On Jean Marie pad  
2 x 5 gal naphtha  
2 x 5 gal 30 oil  
7 JP-4  
4 # 2 gas  
3 100/130 av  
5 empty

BS  
 41  
 Gordon  
 (2)

HK  
 VL  
 HD  
 150  
 HP  
 321

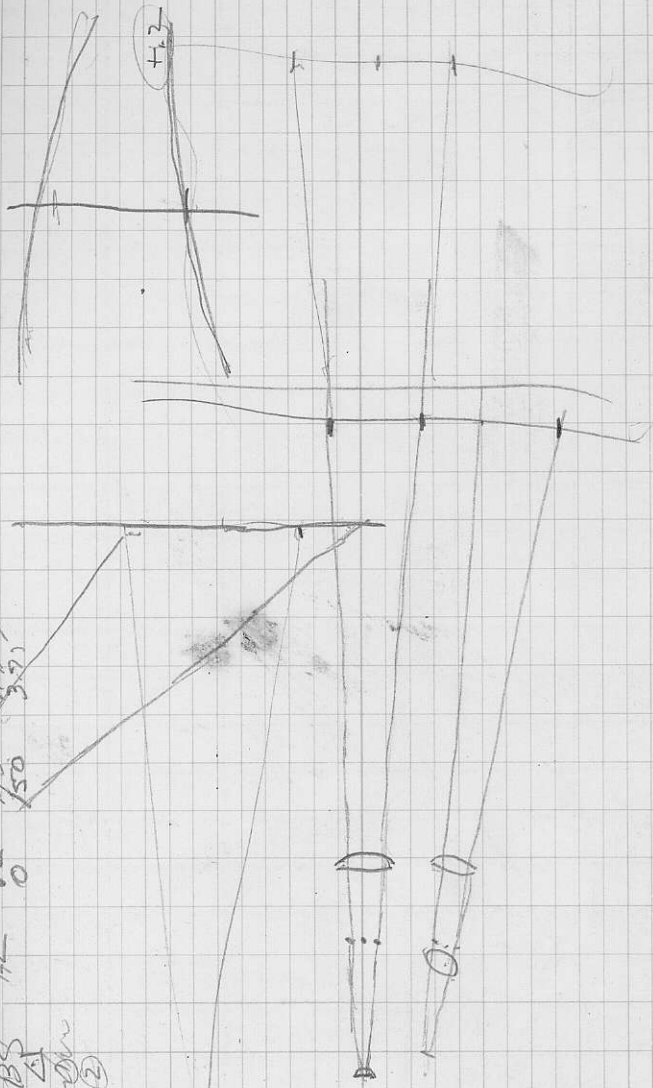

PAUL LUNDGREN

400  
212  
300

General

FOR BEAN PUMP MODEL NO 818-5.5

SERIAL NO 123559

- ✓ CUPS & LINERS
- ✓ 1 COMPLETE CARBURETOR
- ✓ 1 HEAD GASKET FOR PUMP MOTOR

FOR HYDRO PUMP MODEL C 5210

OR C 5200 =

- ✓ 8 PUMP VALVES

FOR DRILL MOTOR WISCONSIN 2 cyl

CARBURETOR KIT. ✓

SEDIMENT BOWL + BRACKET ✓

MISC ✓ 12 BITS

12 HOSE CLAMPS (TRIDON) SCREW

1/2 DOZ. 1/2" NIPPLES

1/2 DOZ 3/4" NIPPLES

1 PHILLIPS SCREW DRIVER

✓ THREE SHEETS

HAYWIRE

PLYWOOD FOR SMALL STACK

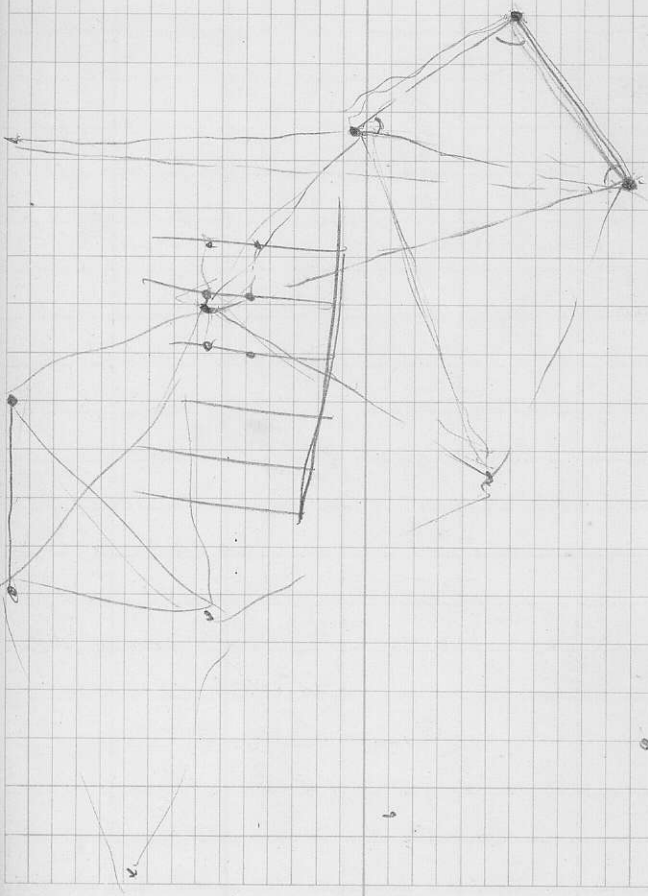

9

2

AUG 19/70

JEAN GROUP

56N B.L. EXTENSION = 11200' @ 150' 318

18 LINES x 4000' = <sup>72000</sup>5280 B/mile @ 90' 1224

18/4 = 4.5  
72  
28 days x 2 men x 4/d = 224

16 x 5280 = 84480  
4000

2104

1609

8400

1440

28

16

8

301475

18 x 4000

224

6 x 2000

1369

3 men x 16 = 48/d

124

5280

28

3000

84000

3000

CPA 28<sup>th</sup>

Plywood ✓

C + J Hamill

Mail

Terry + Dave ✓

Drillpans up tomorrow ✓

2 Kilpers ✓

9 Clarke

Tickets ✓

Lefebvre

Bob H. Hedden

Party money

Air money

Mark boats go by Rover

Shoe polish ✓

Towel

Dubbin ✓

Sample books ✓

✓ ~~Thermal~~

Core sampler

Shipping dates

# PLYWOOD FOR DRILL SNACK

10 - 8'x4' SHEETS 3 PLY.

55  
 55  
 275  
 275  
 3025

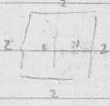

Walker Talkie  
 Core splitter

95  
 95  
 475  
 855  
 9025

19  
 420  
 3.1417  
 90

28 27530

Core Dia 1.1"

Bit Dia 1.9"

X Sec Area Core  $\pi (.55)^2 = 0.95 \text{ in}^2$

X Sec Area Hole  $\pi (.95)^2 = 2.83 \text{ in}^2$

W Groups

AUG 23/70

John Clark's Birthday

Line 168W

52N - 46N - ~~W~~ + Spruce ~~W~~

45N - 38N Buckbrush

Wet 41N-40N

Very small creek at 38N flows N

11 to line + wet across line

Same creek 20' E of 36N

80' E of 33N

at 167+60W 28N

168W 27+70N

168W 25N - 150' E to small creek in brood

Gully

168W 22+65N CLAIM LINE Post #1, W 107, 108

40' TO THE WEST (SOIL 32E 30N)

SMALL CREEK 135' TO THE EAST

CREEK 170' WEST OF POST (4-4)

168W 20+70N Frogs mg 'purplish-greenish

granodiorite - weakly magnetic - spotty

Low ferrous mag - biotite - feldspar lathes

and pinkish grey mg. granodiorite - higher

qtz, higher ferrous mag 30% - slightly

chloritized hornblende + biotite fair

strong mag.



Soil 32E 28N - at 168+20W, 20+35N

19+50 Base steeper slope swamping to SW

Soil 32E 26N at 168+15W 18+20N

168W 18N Bully 45' W

(16) 168W 17N 200 mg grey to pinkish grey

granules. 30% mafic, bitited chb-  
limbade. Very minor specks chales

Relatively flat E dipping fract -

One with 1-1 1/2" pink feld + gtz

(16A) filling - vuggy along middle with minor  
chales + bitited.

AUG 24/70

Night shift in 6 AM. Day shift out 8 AM

- (17) Line 164W 16+70 N oc' white granodior  
mg. relatively fresh hornblende, some  
biotite fairly strong mag. 30% mafic  
Inclusion in dry grey altered vol.  
OC at base sharp ridge -  
Thence along base ridge to west  
130' to soil 36E 34N

From OC on east side line 164W  
40' East + 30' S to oc similar rock  
on slope. - Steep slope crosses  
to 160 W 27+50N.

AUG 24/70

J. W. CLAIM GROUP

DDH J14-1 BRG S 25° W - 45°

MOVED IN BY JET RANGER AUG 21, SET

UP AUG 22, STARTED CASING AUG 22,

CASING TO 18' AUG 23. DAY SHIFT.

DRILLED TO 37'. NIGHT SHIFT DRILL TO 89'

0-18 CASING

18-32 REPRESENTED BY 7 1/2' CORE. GENERALLY  
BADLY BROKEN. FRACTURES AT 10° hematite  
30° calcite, 60° fresh barren  
45° - minor chales, malachite  
GREY, M-C G. GRANODIORITE, INDISTINCT  
FELDSPAR CRYSTALLIZATION, CHLORITIZED  
HORNBLEND. Relatively strong mag

32-33.5 0.75' Broken core. Medium mag.  
Bright pinkish mg granodiorite. Pink  
due to hematite, Fract 0° - minor  
chales - 45° minor chales.

33.5-35.6 0.1' core fragment. Fract 0° - minor  
chales. As 32-33.5'

35.6-36 0.4' broken core. Specks chales

36-37 1.0' core Mg granodiorite - Feldspar  
amorphous, becoming slightly pink

4.7' Core

Hematite on fractures.

Fine scattered cpy, no. Main cpy on fract  
at  $40^\circ$

37-38 0.5' Core Increased pink in field paper  
Fine seams cpy <sup>PM</sup> at  $20^\circ + 70^\circ$ . Minor  
Mo.

38-39.5 - 1.3' Somewhat broken core. Pink field +  
minor chules fract  $2''$ . Thence  
greenish grey with little hematite.  
Angillia.

39.5-41 - < 1.0' Core Similar to 38-39.5 with  
several flat fractures / hematite +  
barren. One  $\frac{1}{2}''$  seam pink field  
+ cpy at  $35^\circ$  to core

41-42 > 1.0' core starts greenish grey - pink  
field increasing to pale pink rock  
end of section. Flat fract with  
hematite. Fine scattered cpy Mo last  
 $\frac{2}{3}$  section Barren fract  $40^\circ - 60^\circ$

42-45 - 2.4' Core somewhat broken.  
Greenish to buff to pink highly altered  
- angillia - Fracts  $40^\circ$  barren,  
 $40^\circ$  opposite way carbonate + cpy  
 $60^\circ$  Mo. At about 44'  $2''$  muddy

6.2' Core

like seams Mo. at 60° to core Two  
others of no width at 60° between  
44-45'

Fine scattered cpy Mo in chlorite  
remnant of mafics.

45'-47' 1.5' Somewhat broken - slightly fresher  
appearance. Slightly pink to  
greenish grey. Little scattered fine  
cpy Mo.

47'-49' 1.3' Core Broken - Similar to 45'-47'

49-52.5 3.0' Core less broken, Fresher  
appearance, slightly pinkish grey.  
Fractures from 20° - 60° not well  
developed. Minor scattered cpy Mo.

52.5-54 4.3' Core. Badly broken. Grey to  
slightly pinkish. Rare specks Mo cpy.

54-55 0.7' Core Broken. Slightly pinkish-grey  
Barren.

55-56.5 1.0' Core, 56.5-57.5 0.5' Core

57.5-58.5 1.0' Core, 58.5-60.0 1.5' Core

Above sections slightly pinkish grey  
mg. 30% mafics (hornblende) strongly  
chloritized - Barren. Core  
more solid + complete after 57.5'  
Fract at 15°, 40° 60° Somewhat

49' Core

- 60-62.5 - 2.2' Core Similar greenish diorite
- 61-62 40% pink feldspar at  
50% in several bands. with  
light cpy no seam over 1" in middle
- 62.5-65 2.5' fairly solid core. My greenish  
grey to purplish green diorite.  
Chloritized hornblende? Very minor  
scattered cpy
- 65-69.5 4.5' Core - last half broken.
- 65-66.2 - Irregular flat fract - scattered  
cpy, Mo.
- 66.2-67.2 - Pink feld, little carbonate on  
seams + fract 45° and 60° with  
84 cpy
- 67.2-69.5 Broken, bleached, chloritized  
fract at 45° + 60°. Mo on fract  
at 60°. Some carbonate, little  
pink feld + hematite. Strong  
seam muddy Mo at 68' at 60°
- 69.5-72.5. Somewhat broken chloritized. Fract  
along core. Hematite + carbonate  
6" bleached zone at end section  
Little moly on small fragments -  
probably from fract at 60°
- 73.5-75 10' <sup>Core</sup> Broken core, argillie, chloritized

very minor. No copy on few pages.

Bees

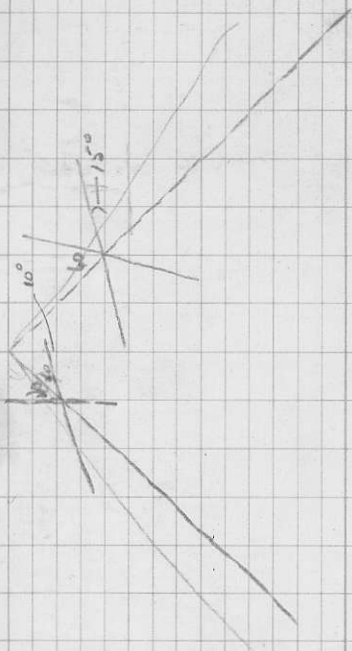



# SLUDGE

- No 12651 113-122 - represents last half  
of footage - start of sludges
- 12652 122-136 - Pink color + most  
mineral in 1<sup>st</sup> third of run
- 12655 150-157.5 - Excess washing
- 12660 177-182 - Two full holes sludge  
from 5' run.
- 12656 - Part of 12657 - Cancelled.

NMA - Beaver at mouth Jean  
Marie 3-4PM Sept 2

Jeanie to bring ① Dry  
② beer  
↑  
Jan - ready for Jet Ranger  
Sept 2.  
- Phone Lundgren for  
① destination of drill + crew.  
② Want to use Russell's to  
truck to pick up drill  
- Russell to arrange  
barge to meet Jet Ranger  
at mouth Jean Marie Creek  
Truck to pick up gear at  
Nation Lakes early Sept 3

Don Buchanan flew J8 + Paul  
Stenerson from F5J to Jean West.  
Picked up samples + core splitter  
from Jean pad #2 for JW +  
took St Germain out - fired.

Aug 27

Don Wiehe took out camp Bravo  
+ Charlie plus John Clark from  
Alpha to meet Beaver + Beestcraft  
on lake - to F5J - Moved  
Falconbridge camp in - (Colin  
Campbells showing on Klawli Creek?)  
Picked up J8 + Paul to F5J.

In AM saw St Germain had  
drilled only 2 feet. on Aug 26 PM.  
Left note with Floyd giving night  
shift only 4 hours.

Larry Charteris confirmed  
St Germain sleeping.  
Flawed part of boxes JW - 1 core  
to F5J to go to Vancouver by  
River. Mother flaggate  
sent out to go to Toronto?

AUG 29 / 70

Floyd Everson + Paul Stevenson  
started hole JW-2 N25E -50°  
0-15' casing. Drilled to 51'

Gordon Kachkowskii + Les Adams  
on night shift.

Losing sludge from base of  
casing - said to be 2-3' in rock.

\* Paul Stevenson on Coates payroll  
as helper

\* Gordon Kachkowskii on as runner