

Extremely large field  
phenas.

occasional Chalchopyta  
found out area

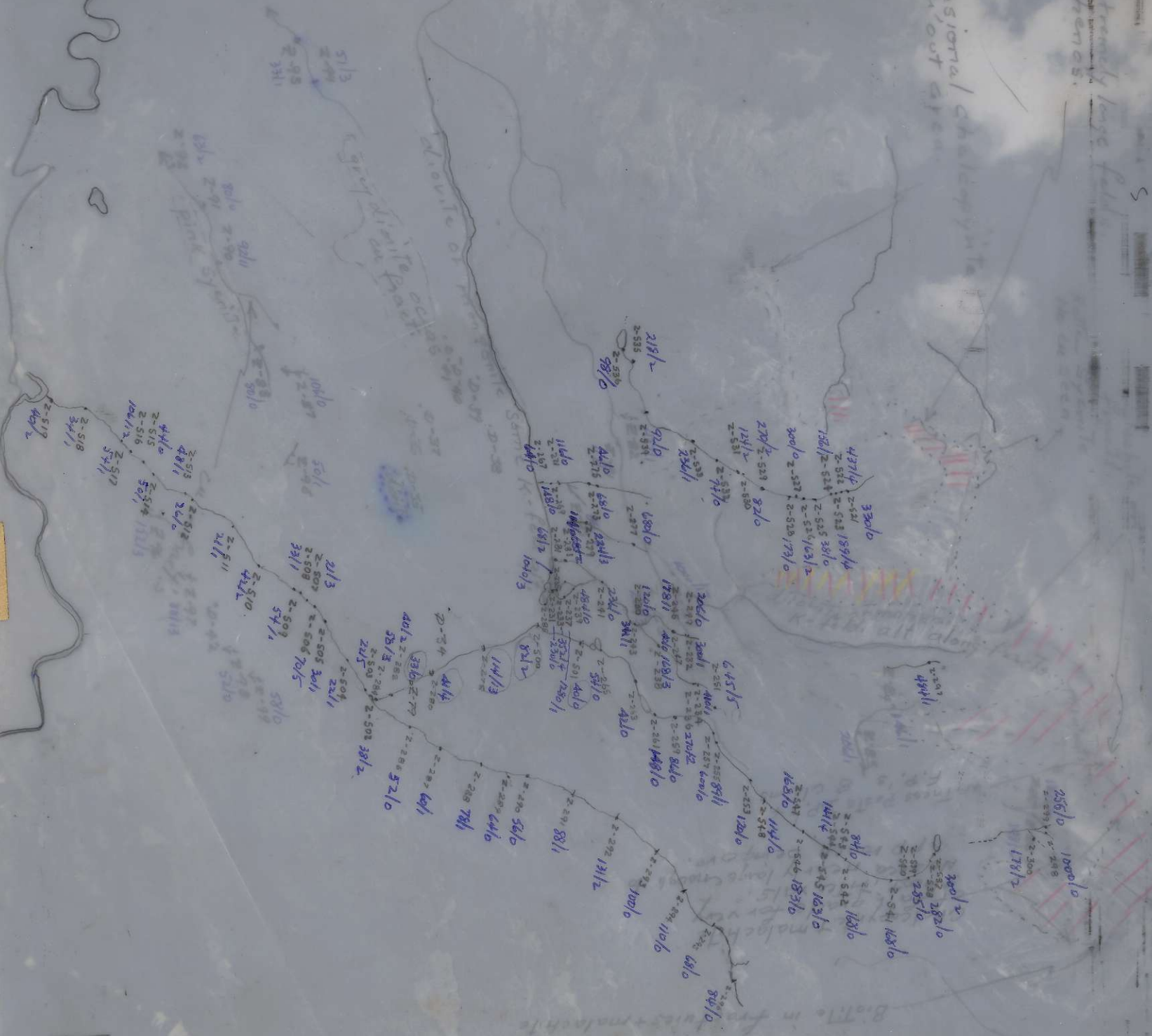

BC 2187:69

670310

Biotite in fractures + malachite

Chalcopyrite + malachite  
of fair grade for very  
short intervals.  
No area nearly large enough to  
approach being ore.

Witness Posts I.P.'s +  
F.P.'s & claims

N-Camp

malachite on  
fractures.  
Rotten Syenite  
No Cu seen

Extremely large fields.  
Phenocr.

occasional chalcopyrite  
throughout area.

