

AUGUST 13-16 1983

OLD GRID ~~GEAR~~ TARGET

JAMES LAWTON

670098

AUGUST 14 1983

TALUS-SOIL SAMPLE 83 CT-6201

brown 0% organics 4" deep steep  
fine to medium some small stones  
Taken on left wall going upstream  
of a creek.

1- silicified limestone - black in colour  
with quartz veins running through.  
has carbonate deposits on surface. Brown ones  
and red ones

83 CT-6202

brown 5% organics 4" deep medium  
fine to medium some small stones moss

83 CT-6203

light brown 0% organics surface  
medium noveg. fine some small stones

1a- another silicified limestone but one  
which is lighter, a lot lighter than  
one

AUGUST 15 1983

SOIL SAMPLE 83 CSG 201

brown 8" deep 20% organics taken  
on the side of a bank moss and  
buck brush

TALUS SAMPLE 83 CT-G 204

light brown 5% organics surface medium  
slope no veg. (slight moss) fine  $\rightarrow$  coarse lots  
and lots of pebbles

ROCK SAMPLE 83 41212C

brown rusty weathered mineral in carbonate  
venite throughout fractured o/c of limestone  
o/c approx 100 ft long by 30 ft wide. The  
long direction is uphill

TALUS SAMPLE 83 CT-G 205

light brown 0% organics surface medium  
no veg. fine  $\rightarrow$  coarse lots of pebbles

SILT SAMPLE 83 CZ-G 201

sandy light brown 0% organics ~~was~~ taken in  
middle of dried up stream bed very  
fine.

AUGUST 16 1983

TALUS SAMPLE B3 CT-G 206

rusty brown 0% organics surface

medium slope fine some small stones  
noug.

B3 CT-G 207

light brown 5% organics surface medium

fine moss - some some pebbles

$$10 = 11$$

$$D = 4$$

$$14 \} = 1$$

$$15 = 9$$

$$16 \}$$

$$7 = 5$$

$$30 \}$$

$$19 \} = 21$$

$$20 \}$$

$$28 = 9$$

$$25 = 12$$

$$26 = 23 = 22 = 24 = 29 = 27 \} = 29$$

265 min

498

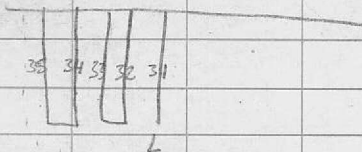

August 13/83 Heavy A50  
104P 11 'Old Grid'

Plt along rd entrance, volcanic  
basalt, grey lat <sup>massive</sup>  
old volc (F-C), <sup>qtz</sup> ss, dolc (ok)

32949C - mal - az - cpy - cc  
being qtz vein material  
just on Base line just S  
of 2 line to N - several  
pieces w Cu mineralization

Gully showing - 32950C -  
chip sample along face  
for 15 m ~~over~~ over  
qtz - bu - sil lat blocks  
+ mal - az - Mn Fe oxides  
(lighter area)

bedding (1-2m beds) ~ 160/35° W  
Fault at back of gully 059° N  
- main showing appears to  
be ~ 30cm wide zone  
along bedding then

expands along a steep ~~down~~ <sup>east</sup>  
 dipper fault

strike not clear  
 width max at least 3m

likely 4-5m. - few other narrow  
 veins w trace of rutting.

Double seen only in vein  
 U course wt to lt gy.

let - clear grey v.f. <sup>v.f.</sup> ~~stall~~  
 south, sandy, sparry beds

vein not really very obvious  
 from + 20m.

additional vein flt at head  
 of gully in addition  
 goes up slope

- work on vein appears to

be hand "tramping" +

sampling + drill foot - blisters?

no indicator of recent work.



2 Posts just NE of show

524369 Final Post (#2)

AX #3

A.H. Groat

Sept 25 1968

Other tags missing (but not)

Upper Show ~ 100 m  
up the gully end of  
DIL.

10m wide (apparent)  
qtz veins ~ 160°/ster  
(parallel to bedding)

bottom + 1m vent  
exposed high grade  
massive galena ± malachite  
stained 73795B R x

upper area + with low  
qtz + sil lat ± trace  
of ml, ag, gal, cpy, cc  
IWK limit, the limit

- Composite sample sent for  
high grade sulfide 73795B

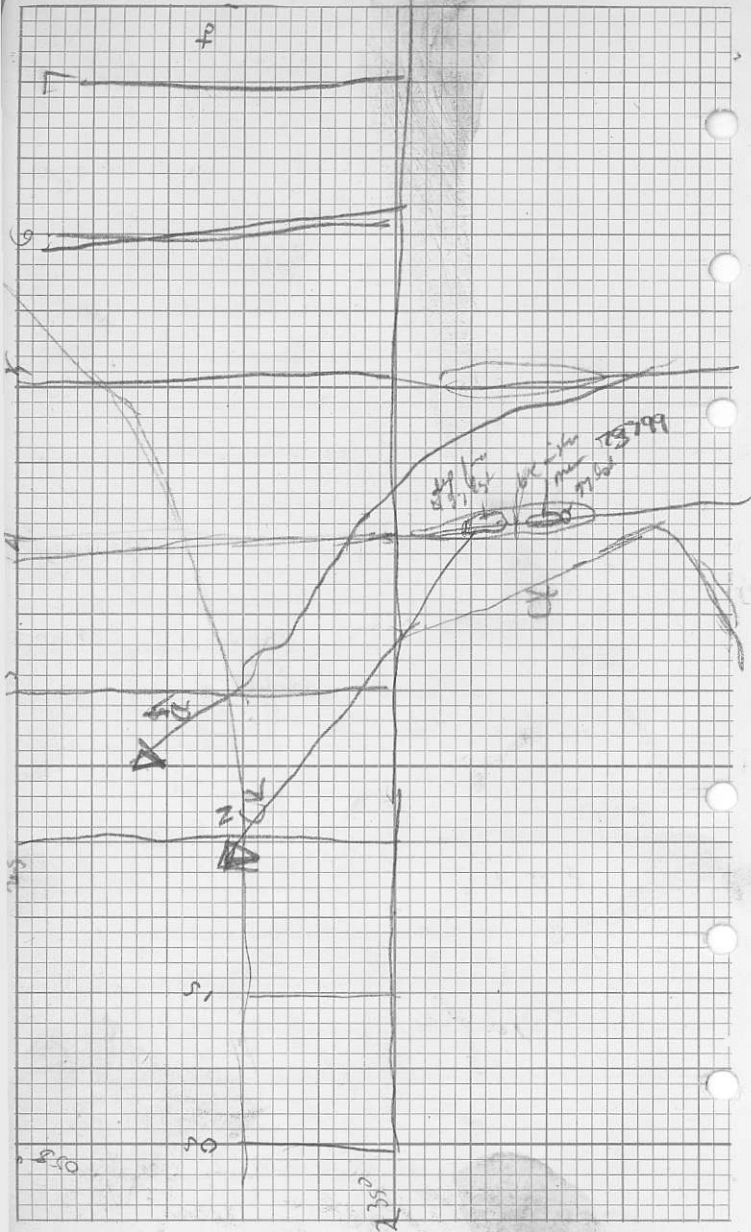

Post by CK drawing N  
to LK for saddle  
between West Ridge + East Ridge  
S 60°W - line survey

Initial Post 5 24 366, 65

A.H. Great Ax 29, 23

Sept 25/68 R L

Final Post 5 24 363, 364

Ax 21, 22

( $\curvearrowright$  edge of tree line on west side)

Silt X 09 from stream by 15 +  
1m, slow, 5cm deep, flat + tan  
dolomite fls

ADK sample - 1m qtz vein  
w mat, H??

SS - anal, mo?

CTII - yw Fe oxide stain fracture  
in east dolo

COA - " yw-red soil

note: A qtz flk in dolo, qtz lat  
N 40/30° E, way to S

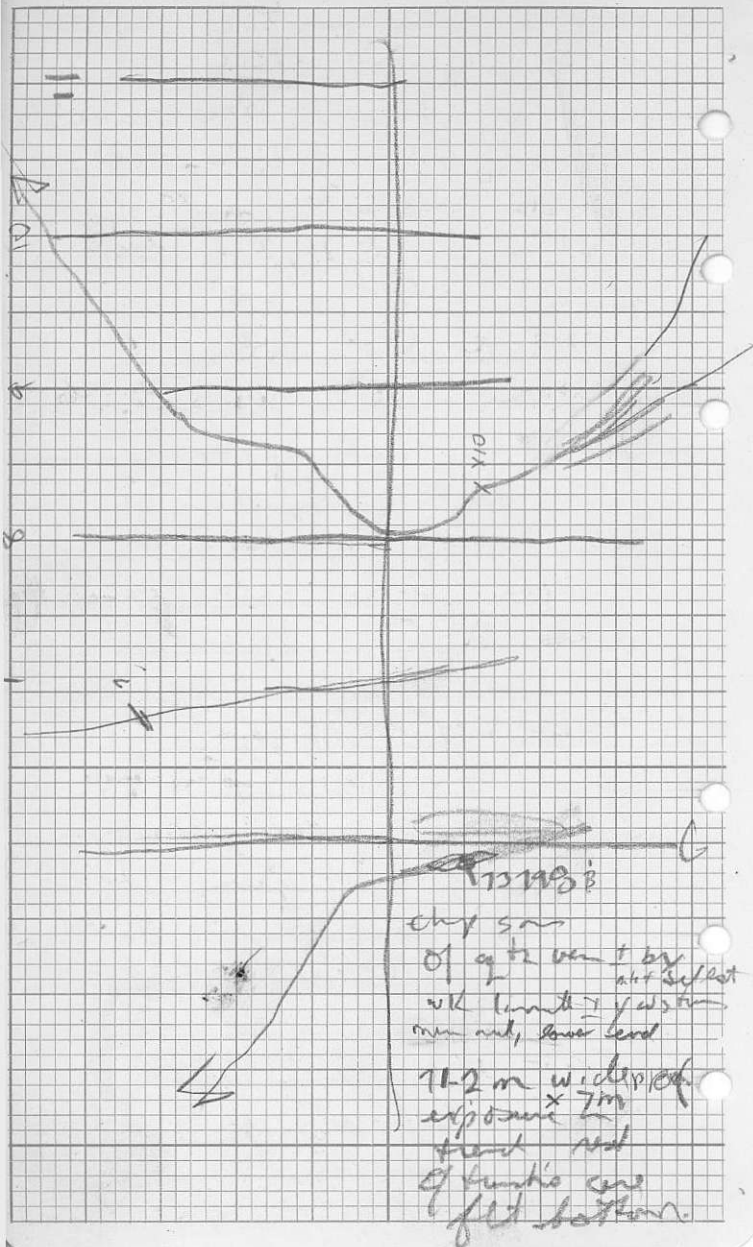

Aug 19/83 Neagy, ASD

109P 11 Old. Grid

X-08 1m wide dry ck 1st, dolo, ss, ves, sy, v. l. fgn

51-1 grey f.g. clean 1st

in dry ck bed just

below gravel bank on N side

Old's of surf down 1st

Frame 1m calc/dolo  
series

- Spaced vert cleaving  $\approx 160^\circ$

- massive thick bed

cliffs 20m very open  
entirely ?

on last ridge top of gaps -

cleaving  $\approx 160^\circ / V$  to steep W dips

$\pm$  2mm - 10 mm calc, dolo vein

local calc  $\pm$  gtz fine veins

1 vein  $\pm$  traces of iron oxides,

micritic cp/ - ~~cp/~~ -

73796C

CAC03 - dk or-br soil, for 1m

on calc - dolo  $\pm$  mal  $\pm$  ery ags

73797B - sample of subcryst  
zone w rare trace of py, mal  
also possible barite

forms resistant knob  
appears to be 2020' ?  
up to 2m wide narrow white  
silic 1st/ven but generally  
erect sil 10m in a 10m  
w ledge.

X10 SCK just below  
true line at start of  
qtz - mal - py - sil  
(also qtz - mag - hematite)

73799B - chip sample  
20m along trend.

2m yellowish atx by

3m wt brown sil "

5m hematite ± thin mal, py

10m wt to qtz qtz ± barite  
erect sil 1st gray? hematite spots  
thin mal, py. (1 1/2 cm)

Aug 15/83 109 P11 Old 6...

Heavy A52

thick bedded grey ls above  
ridge top top peaks  
open folds on top of ridge  
dipping east on east side  
of ridge  
tan to beige (± yw-red Fe oxides)  
dolomite below - gravelly talus

X11 2m dry, 1/6r,  
uns, carb flt. (notly, 1st)

X12, 13 1m as above  
flt largely dolo, 1st  
more ss

X14, 15, 16. also

Aug 16/83

grey ls ore around  
lake no altn. or  
interest

Aug 19-26/83

EAGLE 2 Clear

CACT 21 2x5m zone  
near FC cuts alt., with gtz.

lg <sup>wt</sup> gtz vein (25cm ±)

OSO%V to E+W.

(A ⊥ to strike of F.C. zone)

(T+250 E)

CT 32 - FC <sup>mod + py</sup> cuts zone end  
end of strike like

Along 1cm spaced clearing

in holes + gtz vein + rare py, gal

X24 .2m SK stain

CT 33 - stain F.C. zone  
below 25/54 post

py rare cpy, mang, aspy