

GEOCHEMICAL REPORT
EASY, ON, BP AND BW CLAIM GROUPS
LAT. 55°07'N, LONG. 127°20'W
E. D. DODSON - MACDONALD CONSULTANTS LTD.
FALCONBRIDGE NICKEL MINES LIMITED
JUNE 23 - AUGUST 15, 1970

Apr. 24/71

R. B. Band
D.H. Brown, P. Eng.

92-L-36

GEOCHEMICAL REPORT

ON THE

EASY, ON, BP AND BW

CLAIM GROUPS

ALBERTA M.D.

N.T.S. 92-L-36

Lat. 55° 07'N Long. 127° 20'W

Vancouver, B.C.

April 24, 1971

Dr. R.B. Band

CONTENTS

	<u>Page</u>
Introduction	1
Location and Access	2
Method of Survey	2
Laboratory Techniques	3
Geology	4
Results and Interpretation	5
Easy Group	6
On Group	6
BP Group	7
BW Group	7
Conclusions and Recommendations	8
Statements of Work: Easy Group	9
On Group	10
BP Group	11
BW Group	12
Statement of Qualifications	13
Figure #1 - Invoice #1068 - MacDonald Consultants Ltd. ...	Following page 13
Figure #2 - Invoice #1083 - MacDonald Consultants Ltd. ...	" " "
Figure #3 - Invoice #1112 - MacDonald Consultants Ltd. ...	" " "

ILLUSTRATIONS

Map 160-70-12	Location Map	Following page 1
160-70-13	Silt Geochemistry, Easy Claim Group	In pocket
160-70-14	Silt Geochemistry, On Claim Group	" "
160-70-15	Soil Geochemistry, On Claim Group	" "
160-70-16	Soil and Silt Geochemistry, BP Claim Group	" "
160-70-17	Soil and Silt Geochemistry, BW Claim Group	" "

GEOCHEMICAL REPORT ON THE
EASY, ON, BP AND BW CLAIM GROUPS

92-L-3

Introduction

During the summer of 1970 the Kyuquot Syndicate carried out a geochemical silt sampling and reconnaissance program over part of the Kyuquot Peninsula, Vancouver Island. Indications of mineralization were noted at several localities during the initial stages of this reconnaissance. The Easy, On, BP and BW claim groups were staked to cover these indications and subsequent silt and soil sampling was concentrated on these mineral claims.

The reconnaissance program on the Kyuquot Peninsula generated a total of 1,700 silt samples. Of these, 385 samples were collected on the Easy claim group, 115 samples on the On claim group, 12 samples on the BP group and 12 samples were collected over the BW claim group. In addition, soil samples were collected on a grid pattern over selected portions of the On, BW and BP groups. This detailed sampling produced totals of 94, 70 and 55 soil samples respectively from the On, BP and BW claim groups. All soil and silt samples were analyzed for copper and zinc. Selected samples from the Easy claim group were also analyzed for molybdenum. The geochemical results for the above are plotted on maps 160-70-12 to 17.

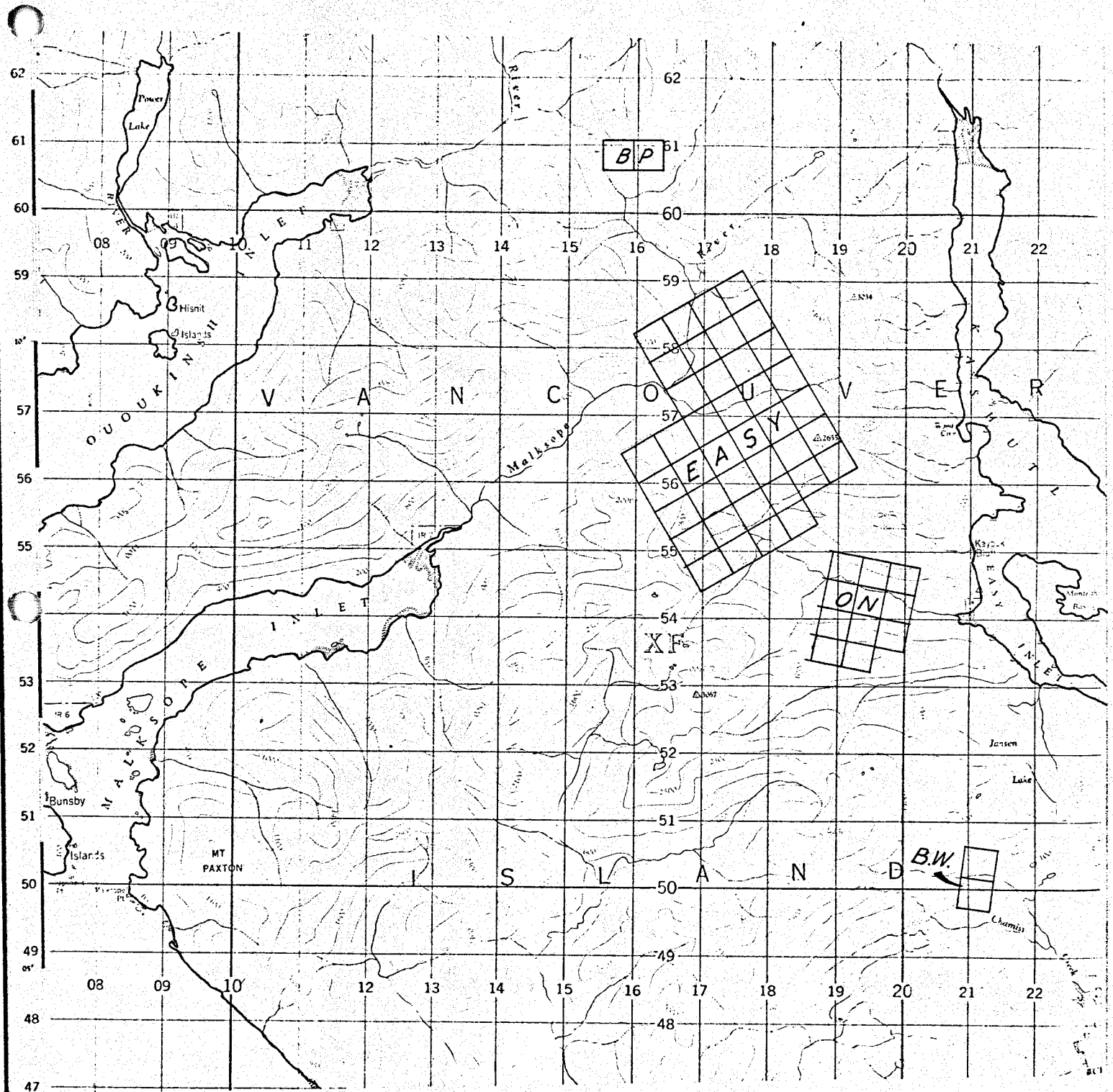

LOCATION OF CLAIM GROUPS 'EASY', 'ON', 'BP' & 'BW'
KYUQUOT PENINSULA, VANCOUVER ISLAND, B.C.

Location and Access

The claim groups described in this report are located on the Kyuquot Peninsula, on the west coast of Vancouver Island, 95 miles west of the town of Campbell River. As there is no direct road connection to the Kyuquot Peninsula, access to the properties is by chartered float plane, landing at Easy Inlet, and thence by logging road and trail. Alternatively, access to Easy Inlet can be gained by small boat from the nearby logging settlement at Fair Harbour, a journey of 10 miles. A scheduled float plane service operates daily between Fair Harbour and Tahsis, with connections to Vancouver. The precise locations of the individual claim groups are shown on map 160-70-12.

Method of Survey

Silt samples were collected along all streams draining the mineral claims at intervals of 500 feet. By sampling all recognizable drainage channels, a detailed sampling network was obtained over each claim group. The silt samples were taken from the active stream sediment in the centre of the drainage channel. The samples were immediately placed in water-resistant paper packets on which the following information was recorded: sample number, date, grain-size, colour and organic content of the sample. Sample site locations were recorded on specially prepared topographic base maps at a scale of 1 inch to 1,000 feet.

Detailed soil sampling was subsequently carried out over selected portions of the On, BP and BW mineral claim groups. For the On group

a 4,500 foot base line, aligned N 100°E, was laid out with chain and compass. Perpendicular grid lines were turned off this base line at intervals of 500 feet, and soil samples were collected at intervals of 200 feet along these lines. For the BP claims, a 1,500 foot north-south base line was laid out and perpendicular grid lines turned off at intervals of 200 feet. Soil samples were then collected along these lines at a spacing of 200 feet. In the case of the BW claims, the 800 foot long base line was aligned N100°E and grid lines were turned-off at intervals of 200 feet. The sample spacing along the grid lines on the BW claims was 100 feet.

Soil samples were taken from the B horizon, at a depth of approximately 12 inches using grub hoes. The soil samples were placed in water-resistant paper packets on which the following information was recorded: sample number, line number and footage, date, sampling depth, horizon, colour and moisture content.

All samples were shipped to Vancouver for analysis by the Falconbridge geochemical laboratory.

Laboratory Techniques

The samples were dried in a gas-fired hot air drier and hand screened through 80 mesh standard nylon screens. The minus 80 mesh portion of the dried sample was analyzed for copper and zinc by standard geochemical techniques. In addition, selected samples from the Easy claim group were analyzed for molybdenum using standard geochemical methods.

Copper and zinc were determined by standard atomic absorption techniques, following digestion of the sample for one hour with boiling 10% nitric acid. Molybdenum was determined by fusing 250 m.g. of sample with alkaline flux to render the molybdenum soluble. The fusion was leached with demineralized water and an aliquot of the leach liquor treated with 2.5 percent solution of hydroxylamine hydrochloride in hydrochloric acid and one percent zinc dithiol solution. After shaking to develop the coloured molybdenum complex, the samples were compared with previously prepared standards to obtain the molybdenum concentration.

Geology

The portion of the Kyuquot Peninsula under consideration is underlain chiefly by sedimentary and volcanic rocks of the Bonanza Group. The Lower Bonanza consists predominantly of calcareous sediments, including light and dark limestones and skarns. The Upper Bonanza is predominantly volcanic and includes both intermediate flows and intermediate to acid pyroclastics. The Bonanza Group in this area has a regional east-west strike and dips to the south at angles ranging from 25° to 55°.

In the immediate vicinity of Kashutl Inlet the Bonanza rocks are intruded by a medium-grained syeno-diorite plug. Further west in the vicinity of the Malksope River, the Bonanza sediments are cut by a quartz porphyry minor intrusion. The age relationship between these intrusions is not clear.

The area is transected by the Mahatta Fault, a major north-west trending fault zone.

The Easy claims were sited to cover a zone with widespread but minor chalcopryite and pyrite. Mineralization is associated with quartz veining in both volcanics and sediments.

The On claims were sited to cover an extensive skarn zone containing minor disseminated sphalerite.

The BP claims cover a showing with chalcopryite, hematite and magnetite in a shear zone in dark calcareous sediments. The BW claims were located to cover an exposure of dark green andesite containing minor disseminations and veinlets of chalcopryite.

Results and Interpretation

In interpreting the stream sediment data from the various mineral claim groups the following threshold levels, based on the 1,700 silts collected over the Kyuquot Peninsula, were used:-

	Regional Background	Weakly Anomalous	Anomalous	Range	Mode
Cu	<75	75-150	>150	5-488	20-30
Zn	<150	150-300	>300	10-2160	70-80
Mo	<3	3-4	>4	1-11	<2

The results for the individual claim groups are discussed in turn below.

Easy Group (Map 160-70-13)

Anomalous copper values (up to 448 ppm) are concentrated in the northern portion of the claim group. Values in the southern section are almost all in the regional background concentration range, the exception being a low order anomaly in the south-west, represented by two samples only.

Anomalous zinc values show a broadly similar distribution, with highly anomalous samples (up to 2,160 ppm Zn) concentrated in the northern half of the claim group. As in the case of copper, zinc values in the southern half of the group are almost all in the regional background range. An exception to this is a low order zinc anomaly in the south-west corner of the group.

The molybdenum data show a low order anomaly broadly coincident with the copper and zinc anomalies in the north of the claim group. Molybdenum values in the southern portion of the claim group are entirely in the background range.

On Group (Map 160-70-14 & 15)

The silt data reveal only a low order zinc anomaly (maximum 317 ppm Zn) over the On claim group. The copper content of the silts is entirely in the background range.

The soil grid was sited to cover the inferred extension of the skarn zone which forms the host rock in the initial sphalerite showing. The soil results are not encouraging since only a single sample is anomalous for zinc (349 ppm Zn) and copper values are uniformly low (maximum 30 ppm Cu).

BP Group (Map 160-70-16)

The silt data for the BP claims show background copper and zinc values.

The soil results are not encouraging since only a single sample is weakly anomalous for copper (108 ppm Cu). All other values are in the background concentration range for both copper (maximum 40 ppm Cu) and zinc (maximum 63 ppm Zn).

BW Group (Map 160-70-17)

The silt data for the BW claims show a single weakly anomalous copper value (94 ppm Cu). The remaining silt samples have background copper and zinc contents.

The soil results for the BW grid are not encouraging. A single soil sample has a weakly anomalous copper content (85 ppm Cu), the remaining values being in the background range for both copper and zinc.

Conclusions and Recommendations

1. On the basis of the geochemical data the Easy claim group appears to have the greatest potential for mineralization. It is recommended that future exploration effort be concentrated on these claims, and that initially particular attention be paid to the area of anomalous copper, zinc and molybdenum outlined in the north of the claim group. A combined soil sampling and detailed prospecting program is recommended in order to evaluate this anomaly.

2. The results for the On, BP and BW claims are not encouraging, and no further geochemical work is recommended on these claims.

Vancouver, B.C.

April 24, 1971

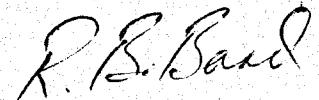

R. B. Band

DOMINION OF CANADA:
PROVINCE OF BRITISH COLUMBIA.
To Wit:

In the Matter of

Geochemical Report on
EASY GROUP mineral claims.

I, D. H. Brown

of #500 - 1112 West Pender Street, Vancouver 1, B.C.

in the Province of British Columbia, do solemnly declare that the following work was done:

MacDonald Consultant Charges - Easy Group Portion

	June Labour Costs - 120 1/8 days	- \$6,931.25	
	Expenses	- <u>1,720.79</u>	<u>\$8,652.04</u>
June 23-30/71	Labour Costs) - 1/4 (\$8,652.04)		\$2,163.01
	Expenses)		
July 1-31/71	Labour Costs - (124 1/2 days)	- 7,591.25	
	Expenses	- <u>1,559.82</u>	9,151.07
Aug. 1-15/71	Labour Costs - (34 3/4 days)	- 2,045.00	
	Expenses	<u>1,491.12</u>	<u>3,536.12</u>
			<u>14,850.20</u>
Geochem. = 70% of Time	187 days		or <u>10,395.14</u>
	130.9 days		
Easy Group Survey =	$\frac{385}{1700} \times 130.9 = 29.62$ days	or	$\frac{385}{1700} \times 10,395 =$
			\$ 2,354.50
Collection cost per silt sample for use on BP and BW claims			
	$= \frac{2354.50}{385} =$	\$6.12/sample.	

Falconbridge Charges - Easy Group Portion

June 23-26/70	Dr. R. B. Band	4 days @ \$100.00/day	= \$400.00	
	Mr. K. H. Christensen	4 days @ \$55.00/day	= 220.00	
	Mr. C. Dyakowski	4 days @ \$45.00/day	= <u>180.00</u>	800.00
Easy Sample Analysis:	227 samples Cu., Zn., Mo. @ \$3.50/ea.		= \$794.50	
	158 samples Cu., Zn. @ \$1.50/ea.		= <u>237.00</u>	<u>1,031.50</u>
				<u>\$ 4,186.00</u>

And I make this solemn declaration conscientiously believing it to be true, and knowing that it is of the same force and effect as if made under oath and by virtue of the "Canada Evidence Act."

Declared before me at the City
of Vancouver, in the
Province of British Columbia, this
day of 1971, A.D.

.....
A Commissioner for taking Affidavits within British Columbia or
A Notary Public in and for the Province of British Columbia.

DOMINION OF CANADA:
PROVINCE OF BRITISH COLUMBIA:
To Wit:

In the Matter of

Geochemical Report on
ON GROUP mineral claims.

I, D. H. Brown

of #500 - 1112 West Pender Street, Vancouver 1, B.C.

in the Province of British Columbia, do solemnly declare that the following work was done:

MacDonald Consultant Charges - On Group Portion

	June Labour Costs - 120 1/8 days	- \$6,931.25	
	Expenses	- 1,720.79	\$8,652.04
June 23-30/71	Labour Costs)	- 1/4 (\$8,652.04)	\$ 2,163.01
	Expenses)		
July 1-31/71	Labour Costs	- 7,591.25	
	Expenses	- 1,559.82	9,151.07
Aug. 1-15/71	Labour Costs	- 2,045.00	
	Expenses	- 1,491.12	3,536.12
			<u>14,850.20</u>
Geochem. = 70% of Time - 187 days = 130.9 days			<u>10,395.14</u>
On Group Survey - $\frac{115}{1700} \times 10,395.14$			= \$ 702.70

Falconbridge Charges - On Group Portion

On Group Sample Analysis = 115 stream seds. Cu., Zn.			
94 soil samples Cu., Zn.			
209 analyses @ \$1.50			= 313.50
			\$ 1,016.20
			=====

And I make this solemn declaration conscientiously believing it to be true, and knowing that it is of the same force and effect as if made under oath and by virtue of the "Canada Evidence Act."

Declared before me at the City
of Vancouver, in the
Province of British Columbia, this
day of 1971, A.D.

A Commissioner for taking Affidavits within British Columbia or
A Notary Public in and for the Province of British Columbia.

DOMINION OF CANADA:
PROVINCE OF BRITISH COLUMBIA.
To Wit:

In the Matter of

Geochemical Report on
BP GROUP mineral claims.

I, D. H. Brown

of #500 - 1112 West Pender Street, Vancouver 1, B.C.

in the Province of British Columbia, do solemnly declare that the following work was done:

MacDonald Consultant Charges - BP Group Portion

	June Labour Costs - 120 1/8 days	- \$6,931.25	
	Expenses	- <u>1,720.70</u>	<u>\$8,652.04</u>
June 23-30/71	Labour Costs) - 1/4 (\$8,652.04)		\$ 2,163.01
	Expenses)		
July 1-31/71	Labour Costs - (124 1/2 days)	- 7,591.25	
	Expenses	- <u>1,559.82</u>	9,151.07
Aug. 1-15/71	Labour Costs - (34 3/4 days)	- 2,045.00	
	Expenses	- <u>1,491.12</u>	<u>3,536.12</u>
			<u>14,850.20</u>
Geochem. = 70% of Time - 187 days = 130.9 days			<u>10,395.14</u>
Collection cost per silt sample = $\frac{2354.50}{385}$ = \$6.12/sample.			
20 silt samples @ \$6.12/sample			\$ 122.40
Special Soils Grid Survey - July 30/70:			
70 soil samples	B.C. Way	1 day @ \$65.00/day = \$65.00	
June 27/70	B.G. Payne	1 day @ \$40.00/day = <u>40.00</u>	105.00
Sample Analysis	90 samples Cu., Zn. @ \$1.50/ea.		<u>135.00</u>
			\$ 362.40
			=====

And I make this solemn declaration conscientiously believing it to be true, and knowing that it is of the same force and effect as if made under oath and by virtue of the "Canada Evidence Act."

Declared before me at the City
of Vancouver, in the
Province of British Columbia, this
day of 1971, A.D.

A Commissioner for taking Affidavits within British Columbia or
A Notary Public in and for the Province of British Columbia.

DOMINION OF CANADA:
PROVINCE OF BRITISH COLUMBIA.

In the Matter of

Geochemical Report on
BW GROUP mineral claims.

To Wit:

I, D. H. Brown

of #500 - 1112 West Pender Street, Vancouver 1, B.C.

in the Province of British Columbia, do solemnly declare that the following work was done:

MacDonald Consultant Charges - BW Group Portion

	June Labour Costs - 120 1/8 days	- \$6,931.25	
	Expenses	- <u>1,720.70</u>	<u>\$8,652.04</u>
June 23-30/71	Labour Costs) - 1/4 (\$8,652.04)		\$ 2,163.01
	Expenses)		
July 1-31/71	Labour Costs - (124 1/2 days)	- 7,591.25	
	Expenses	- <u>1,559.82</u>	9,151.07
Aug. 1-15/71	Labour Costs - (34 3/4 days)	- 2,045.00	
	Expenses	- <u>1,491.12</u>	<u>3,536.12</u>
			<u>14,850.20</u>
	Geochem. = 70% of Time - 187 days = 130.9 days		<u>10,395.14</u>
	Collection cost per silt sample = $\frac{2354.50}{385} = \$6.12/\text{sample}$		
	12 silt samples @ \$6.12/sample		\$ 73.44
	Special Soils Grid Survey - July 29/70:		
	55 soil samples B.C. Way 1 day @ \$65.00 = \$65.00		
	B.G. Payne 1 day @ \$40.00 = <u>40.00</u>		105.00
	<u>Falconbridge Charges</u>		
	Sample Analysis: 67 samples Cu., Zn. @ \$1.50		<u>100.50</u>
			<u>\$ 278.94</u>
			=====

And I make this solemn declaration conscientiously believing it to be true, and knowing that it is of the same force and effect as if made under oath and by virtue of the "Canada Evidence Act."

Declared before me at the City
of Vancouver, in the
Province of British Columbia, this
day of 1971, A.D.

A Commissioner for taking Affidavits within British Columbia or
A Notary Public in and for the Province of British Columbia.

FALCONBRIDGE NICKEL MINES LIMITED

1112 WEST PENDER STREET

VANCOUVER 1, B. C., CANADA

TELEPHONE: 682-6242

TELEX: 04-5938

April 24, 1971

The Chief Mining Recorder,
Omineca Mining Division,
Smithers, B.C.

Dear Sir:

Re: Statement of Qualification

This is to certify that the geochemical work done on the Easy, On, BP and BW claims was done under my supervision.

The silt sampling program was carried out by McDonald Consultants Ltd., under the direction of Mr. E.D. Dodson. Mr. Dodson is a Professional Engineer registered in the Association of Professional Engineers of the Province of British Columbia and the Yukon Territory.

Mr. K.H. Christensen has been instructed by Falconbridge geochemist, Dr. R.B. Band, in geochemical survey techniques, and is a fully qualified field geochemical operator.

Mr. C. Dyakowski was instructed in the field by Falconbridge geochemical operators, and is qualified as a geochemical sampler.

The analyses and evaluation of the results were done under the direction of Dr. I.L. Elliott, Chief Geochemist, and Dr. R.B. Band, Assistant Geochemist for Falconbridge Nickel Mines Limited. Doctors Elliott and Band received their Doctorates from the Royal School of Mines, Imperial College, London, England.

Yours very truly,

FALCONBRIDGE NICKEL MINES LIMITED

D.H. Brown, P.Eng. (B.C.)

MACDONALD CONSULTANTS LTD.

SUITE 12 - 425 HOWE STREET, VANCOUVER 1, B. C.

160
60% Allocation
20% Fuel + Prov.
20% Claim Station

June 30, 1970

Job No. 291

Invoice No. 1068

Falconbridge Nickel Mines Ltd.
1112 West Pender Street
Vancouver 1, B. C.

PROFESSIONAL SERVICES - Re: Kyuquot Syndicate

Reimbursement of Staking Costs - 'H' Claim Group \$ 1,688.47 ✓

MayRe: Geology, Prospecting, Camp Set-Up and Travel

E. D. Dodson	9 1/3 days @ \$150.00/day	\$ 1,400.00 ✓
J. P. Henry	3 1/4 days @ \$80.00/day	260.00 ✓
J. E. Stockwell	1/4 day @ \$60.00/day	15.00 ✓
I. Gummeson	13 days @ \$50.00/day	650.00 ✓
B. Payne	13 days @ \$40.00/day	520.00 ✓
S. Timmins	13 days @ \$55.00/day	715.00 ✓
B. C. Way	13 days @ \$65.00/day	845.00 ✓

JuneRe: Geology, Prospecting and Silt Sampling

E. D. Dodson	6 days @ \$150.00/day	\$ 900.00 ✓
I. E. Gummeson	29 days @ \$50.00/day	1,450.00 ✓
B. Payne	26 days @ \$40.00/day	1,040.00 ✓
G. H. Seale	1/8 day @ \$50.00/day	6.25 ✓
S. P. Timmins	30 days @ \$55.00/day	1,650.00 ✓
B. C. Way	29 days @ \$65.00/day	1,885.00 ✓
		<u>6,131.25</u>
		\$13,024.72

EXPENSES: - May

E. D. Dodson, Expenses	\$507.95 ✓
B. C. Way, Expenses	52.19 ✓
E. D. Dodson, Expenses	10.26 ✓
J. P. Henry, Expenses	.40 ✓
Minister of Finance	5.25 ✓
Island Airlines Ltd.	376.80 ✓
Minister of Finance	25.00 ✓

cont'd. . .

June 30, 1970
 Job No. 291
 Invoice No. 1068

EXPENSES: (cont'd)

J. P. Henry, Expenses	\$ 3.94 ✓
Dept. of Mines	6.00 ✓
Island Air	25.80 ✓
Vernon Clarke Office Supply Ltd.	25.15 ✓
Photo Copies - 107 only 8½ x 11 @ 15¢	16.05 N.R.
Truck Rental - 3 days @ \$15.00/day	45.00 "
- Mileage - 17 miles @ 12¢/mile	2.04 "
Distribution of Head Office	250.00 "
	<u>\$1,351.83</u>

June

Receiver General of Canada (Radio Licenses)	\$ 40.00 ✓	
H. Wober, Expenses	5.40 ✓	
Distribution of Head Office	474.50 x N.R.	
B. C. Telephone Co.	13.90 ✓	
Gordon Coats Petrographic Service	9.00 x N.R.	
B. C. Way, Expenses	267.37 ✓	
Island Air	54.00 ✓	
B. C. Way, Expenses	651.76 ✓	
B. C. Telephone Co.	11.45 ✓	
Bondar-Clegg & Co. Ltd.	108.00 ✓	
Island Air	79.30 ✓	
Equipment Rental	6.11 N.R.	\$ 3,072.62
	<u>1720.79</u>	<u>\$16,097.34</u>

PAID
 JUL 3 1 1970

[Signature] 160
 Approved for Payment
 Date _____
 Note _____

160 E2	965840	
160 B2	321947	
160 A2	321947	
TOTAL	1609734	
ORDERING OFFICE	FILED	
<i>[Signature]</i>	<i>[Signature]</i>	<i>[Signature]</i>

MACDONALD CONSULTANTS LTD.

SUITE 12. 425 HOWE STREET, VANCOUVER 1, B. C.

July 31, 1970
 Job No. 291
 Invoice No. 1083

[Handwritten Signature]
PAID
 SEP 10 1970
 Date _____

Falconbridge Nickel Mines Ltd.
 1112 West Pender Street
 Vancouver 1, B. C.

PROFESSIONAL SERVICES FOR JULY, 1970

May (Not Previously Billed)

B. C. Way 3 days @ \$65.00/day \$ 195.00

July

E. D. Dodson	8 1/2 days @ \$150.00/day	1,275.00
I. Gummesson	29 days @ \$50.00/day	1,450.00
V. Matiation	1/4 day @ \$45.00/day	11.25
B. G. Payne	25 days @ \$40.00/day	1,000.00
G. H. Seale	4 1/2 days @ \$50.00/day	225.00
S. Timmins	27 days @ \$55.00/day	1,485.00
B. C. Way	30 days @ \$65.00/day	1,950.00

124 1/4

PAID	SEP 10 1970	\$7,591.25
------	-------------	------------

EXPENSES:

B. C. Airlines	\$153.45 ✓	
Delta Hotel - Tahsis Inn	15.00 ✓	
Island Air	291.90 ✓	
VanCah Reproductions	57.00 ✓	
Western Technical Supply	17.38 ✓	
E. D. Dodson, Expenses	13.99 ✓	
E. D. Dodson, Expenses	33.85 ✓	
B. C. Way, Expenses	197.35 ✓	
Petty Cash	11.25 ✓	
B. C. Way, Expenses	228.04 ✓	
Photo Copies - 28 only @ 15¢ 8 1/2 x 11	4.20 ✓	
White Prints - 13 sq. ft. @ 7¢ sq. ft.	.91 ✓	
1 doz. H & 2H Pencils	3.00 ✓	
Distribution of Head Office	532.50	1,559.82

\$9,151.07

*70% Graham
 30% Ser. Resp.
 20% Admin. Sels*

MACDONALD CONSULTANTS LTD.

SUITE 12 . 425 HOWE STREET, VANCOUVER 1. B.C.

August 31, 1970.
 JOB NO. 291
 INVOICE NO. 1112

Falconbridge Nickel Mines Ltd.,
 1112 West Pender Street,
 Vancouver 1, B.C.

ORIGINAL
~~PURCHASING~~
~~PURCHASING~~

RE: PROFESSIONAL SERVICES FOR AUGUST 1970

Collating data at Kyuquot and demobilization.

E.D. Dodson - 1 day @ \$150.00/day	\$ 150.00
J. Gummeson - 2 days @ \$50.00/day	100.00
B. Payne - 11 1/2 days @ \$40.00/day	460.00
G. Phelps - 1 day @ \$100.00/day	100.00
G.H. Seale - 1 3/4 days @ \$50.00/day	87.50
S. Timmins - 11 1/2 days @ \$55.00	632.50
B.C. Way - 11 days @ \$65.00/day	715.00
Less: J. Gummeson - 4 days overcharged in July @ \$50.00	(200.00)
	<u>\$ 2,045.00</u>

EXPENSES

B.C. Way - expenses	\$ 199.94 (Some items identical art)
B. Payne - expenses	29.65 ✓
B.C. Way - expenses	67.05 ✓
Air West Airlines	112.80 ✓
B.C. Airlines	39.00 ✓
Island Airlines	545.80 ✓
M.M. Supplies	101.64 ✓
Guarantee Union	18.75 ✓
Hertz Truck Rental	96.68 ✓
B.C. Telephone	7.35 ✓
Canova Products	130.66 ✓
Imperial Oil Ltd.	15.83 ✓
Ed Richardson Ltd.	37.94 ✓
Seigel Associates Ltd.	70.00 ✓
Imperial Oil Co.	18.03 ✓

70% 160 E2 Geochem.
 30% 160 B2

PAID
 OCT 9 1970

160 B2	1,060.84
160 E2	2,475.28
TOTAL	3,536.12
CODING	LIBRA

1,491.12

\$ 3,536.12

P.O. No.	DATE	AMOUNT	REMARKS	INITIALS	SIGNATURE
	Bl.		ack		

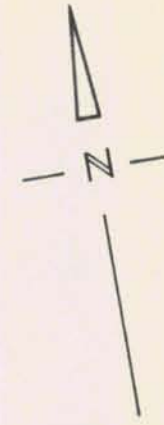
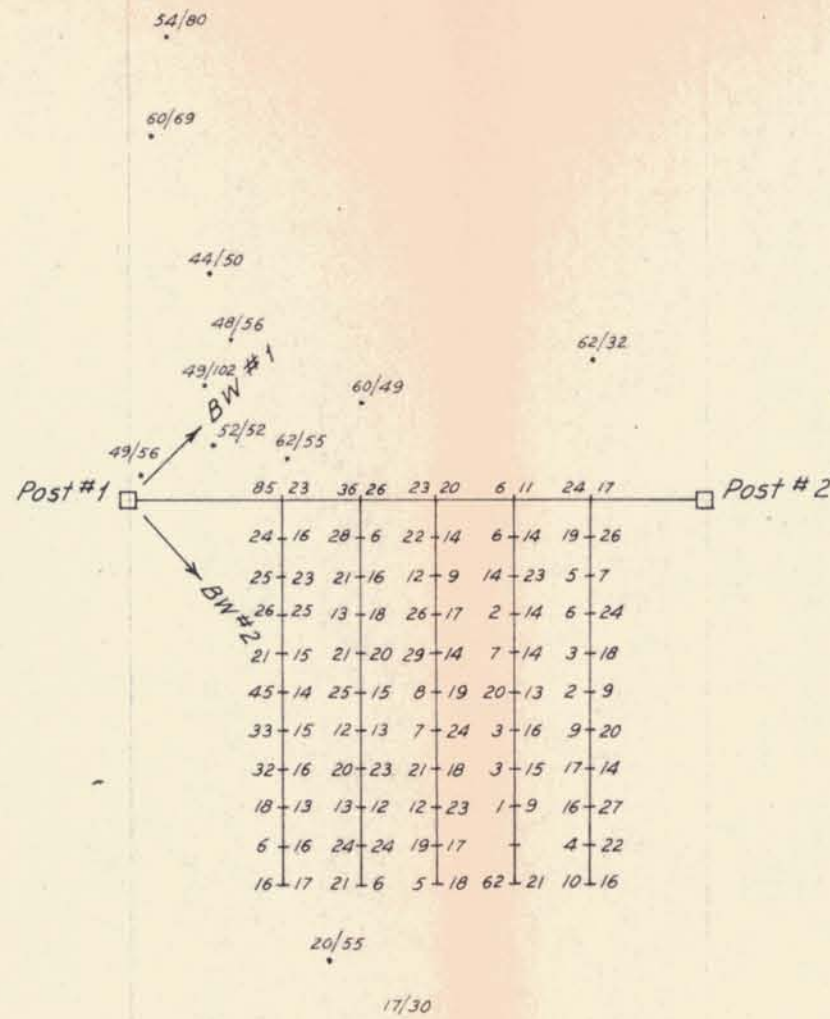

Key

Cu | Zn (in p.p.m.)

SOIL AND SILT GEOCHEMISTRY
'BW' CLAIM GROUP

FALCONBRIDGE NICKEL MINES LTD.

PROPERTY: BW CLAIMS

LOCATION: KYUQUOT PENINSULA

TYPE OF MAP: Soil and Silt Samples

BASED ON:

DATE OF WORK: June, July, 1970

DATE: Dec. 1970

DRAWN BY: H.G.T.

0 500 1000



SCALE: 1 INCH TO 500 feet

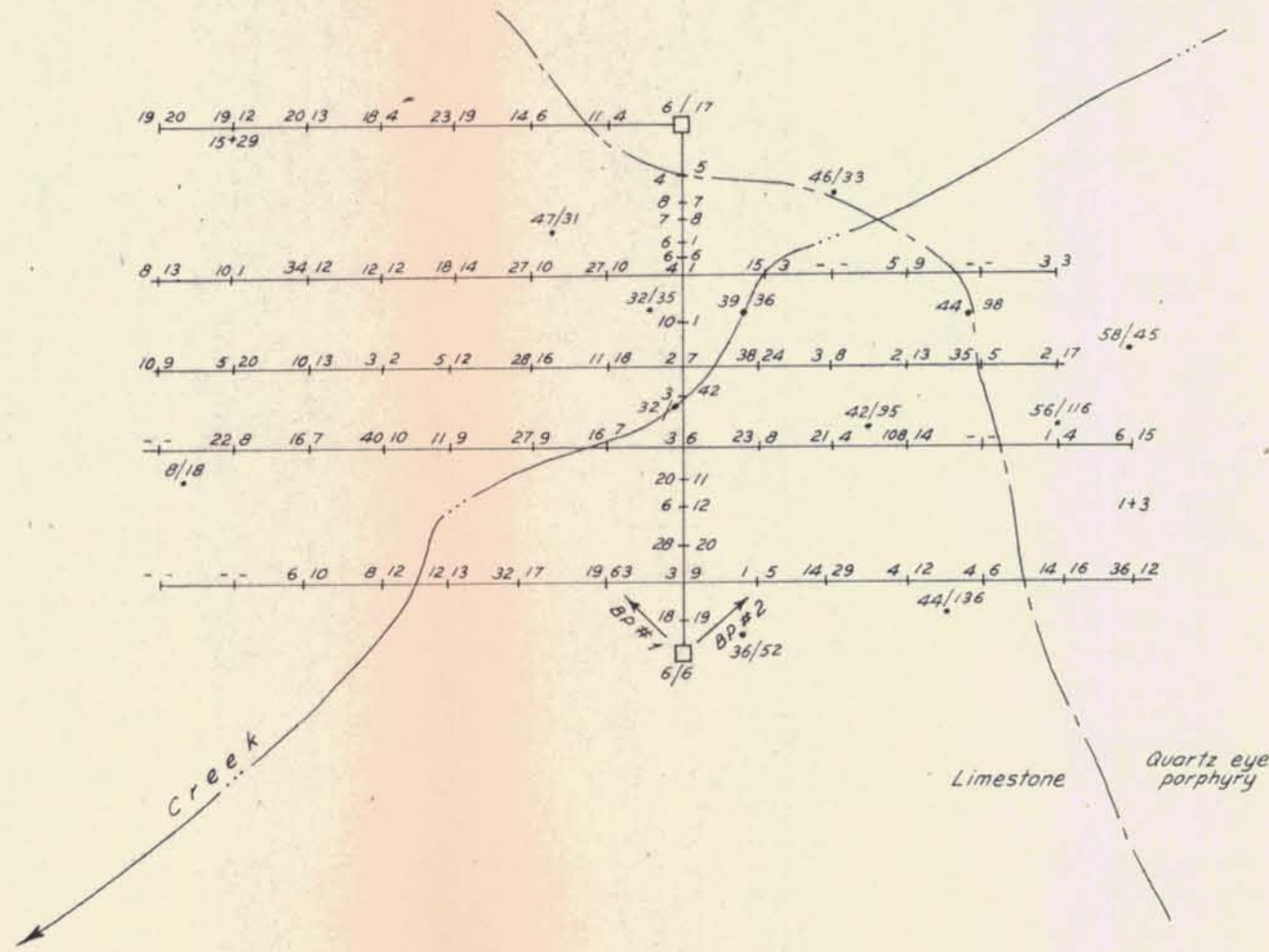
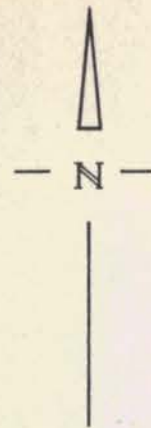

Key
Cu, Zn (in p.p.m.)

SOIL AND SILT GEOCHEMISTRY
BP GROUP

FALCONBRIDGE NICKEL MINES LTD.

PROPERTY: BP CLAIMS

LOCATION: KYUQUOT PENINSULA

TYPE OF MAP: Soil and Silt Samples

BASED ON:

DATE OF WORK: June, July, 1970

DATE: Dec. 1970

DRAWN BY: H.G.T.

0 500 1000

SCALE: 1 INCH TO 500 feet

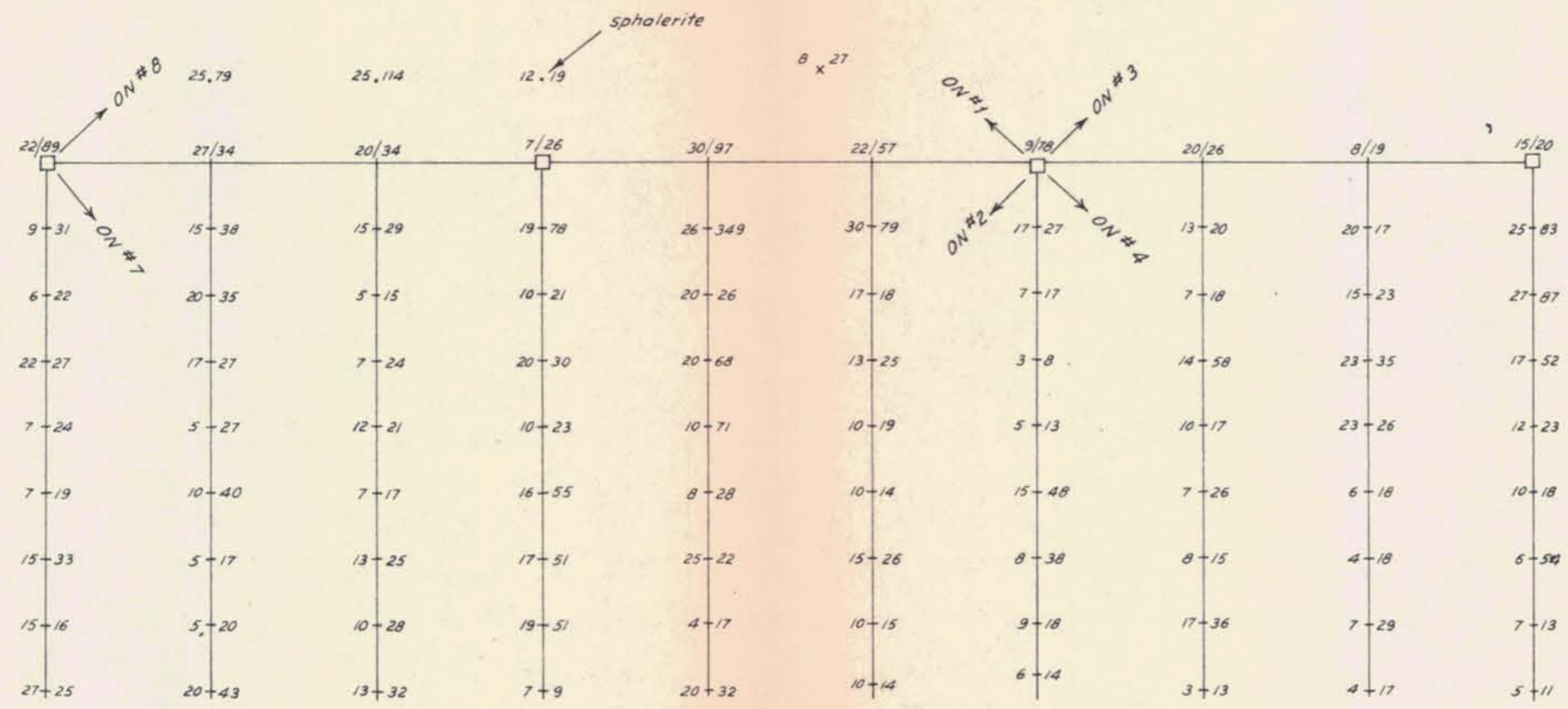

Key
Cu+Zn (in p.p.m.)

SOIL GEOCHEMISTRY
'ON' CLAIM GROUP

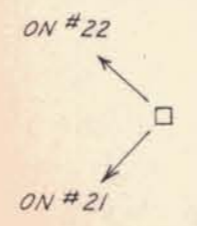
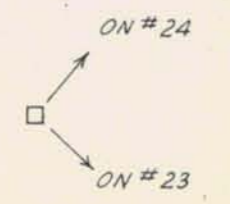

FALCONBRIDGE NICKEL MINES LTD.

PROPERTY: 'ON' CLAIMS

LOCATION: KYUQUOT PENINSULA

TYPE OF MAP: Soil Sample

BASED ON:

DATE OF WORK: June, July, 1970

DATE: Dec. 1970

DRAWN BY: H.G.T.

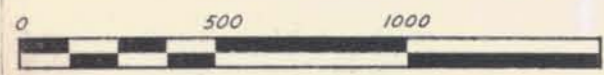

SCALE: 1 INCH TO 500 feet

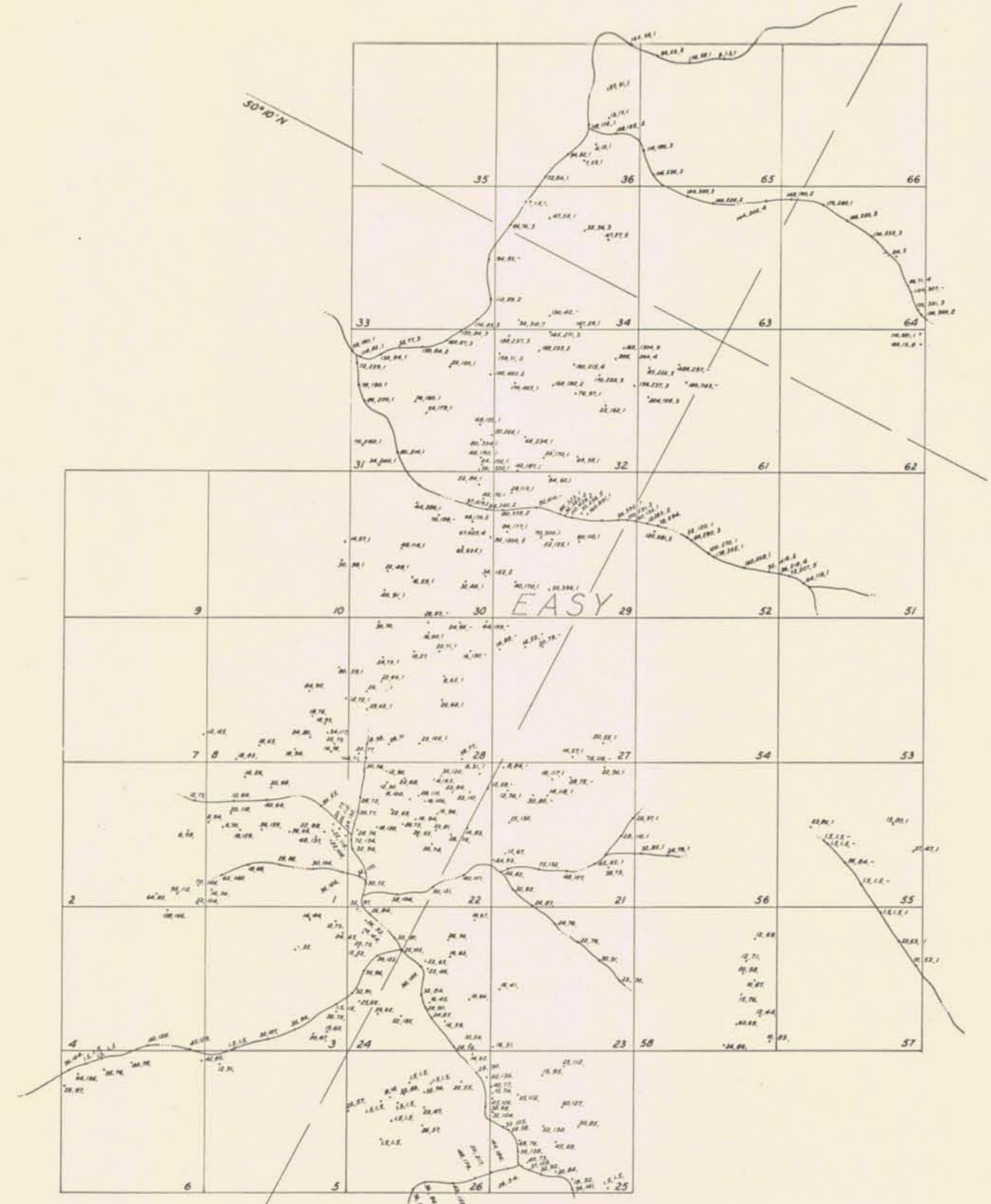

Silt Geochemistry, Easy Claim Group

160-70-13

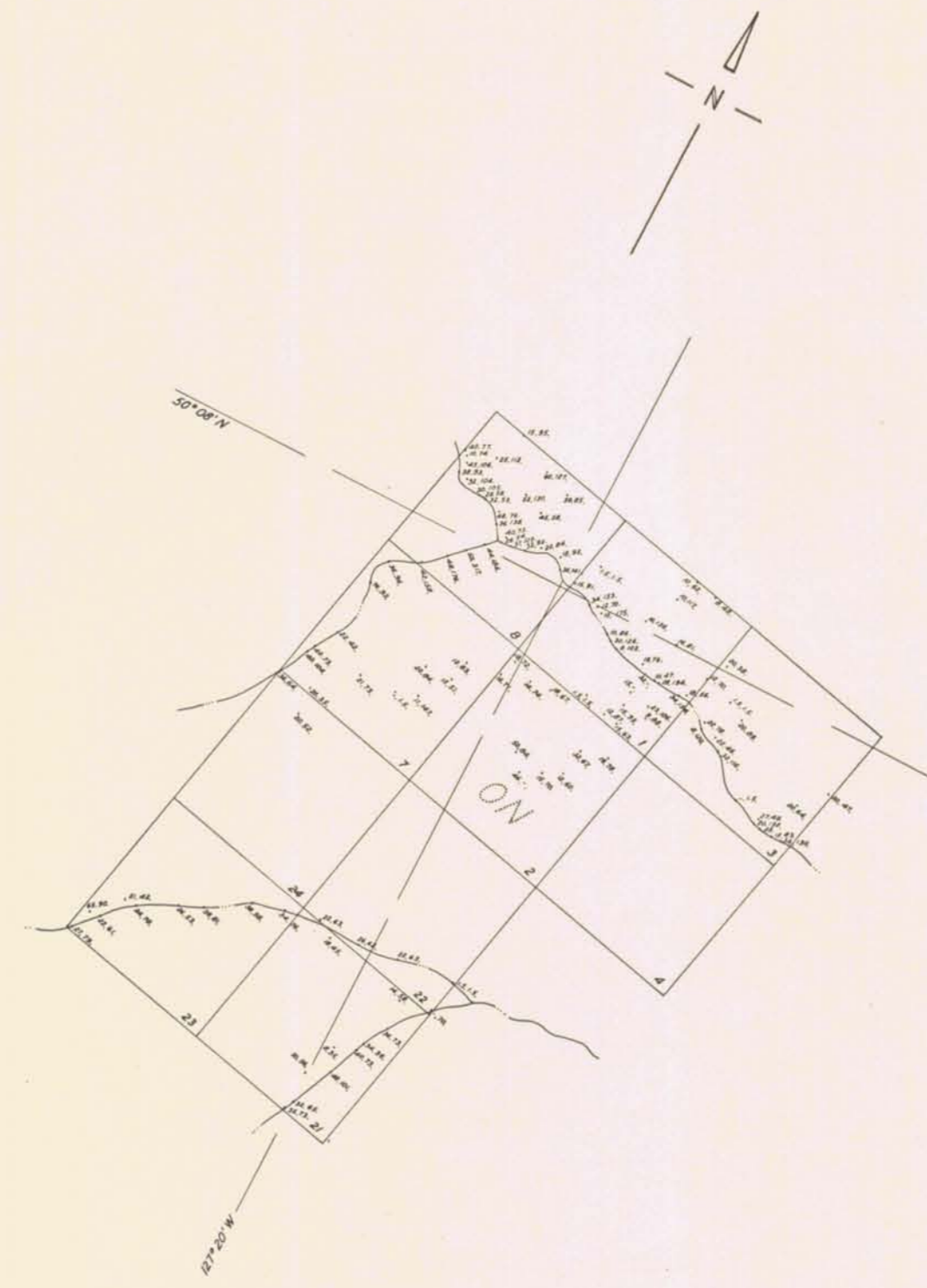

Silt Geochemistry, On Claim Group

160-70-14

LEGEND
 - M. No. 1
 - Cu, Zn, Mo (in ppm)

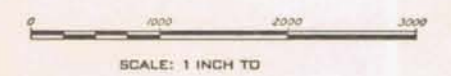

FALCONBRIDGE NICKEL MINES LIMITED		
PROPERTY:		
'EASY' AND 'ON' CLAIM GROUPS		
LOCATION:		
KYUQUOT PENINSULA, VANCOUVER IS., B.C.		
TYPE OF MAP:		
GEOCHEMISTRY		
WORKING PLACE:		
BASED ON:		
DATE OF WORK: June, July, 1970	MAP REF. NO.:	FIG. NO.:
DRAWN BY: G.T.	160-70-13 & 14	
DATE: Dec. 1970	N.T.S. NO.:	97-L-3W