

FIGURES 2, 7 TO 17

GEOLOGICAL SURVEY

BAY PROPERTY
(BAY 1, 2, 5-7, 11-16)

KAMLOOPS MINING DIVISION,

BRITISH COLUMBIA

NTS 82M/4
51°06' N, 119°47'W

20/2

Owners: COMINCO LTD. and
WESTMIN RESOURCES LTD.

Operator: KID CREEK MINES LTD.

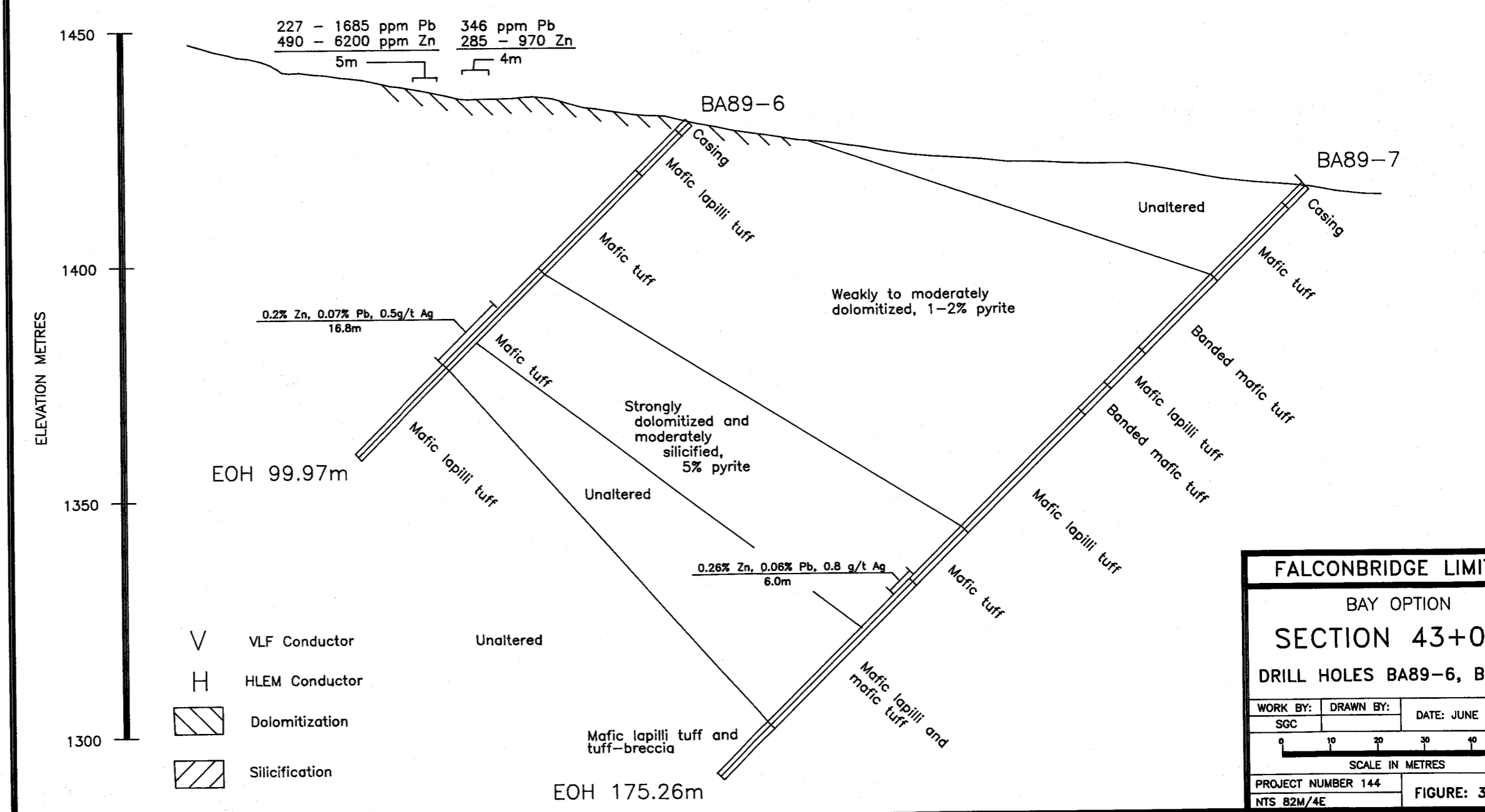
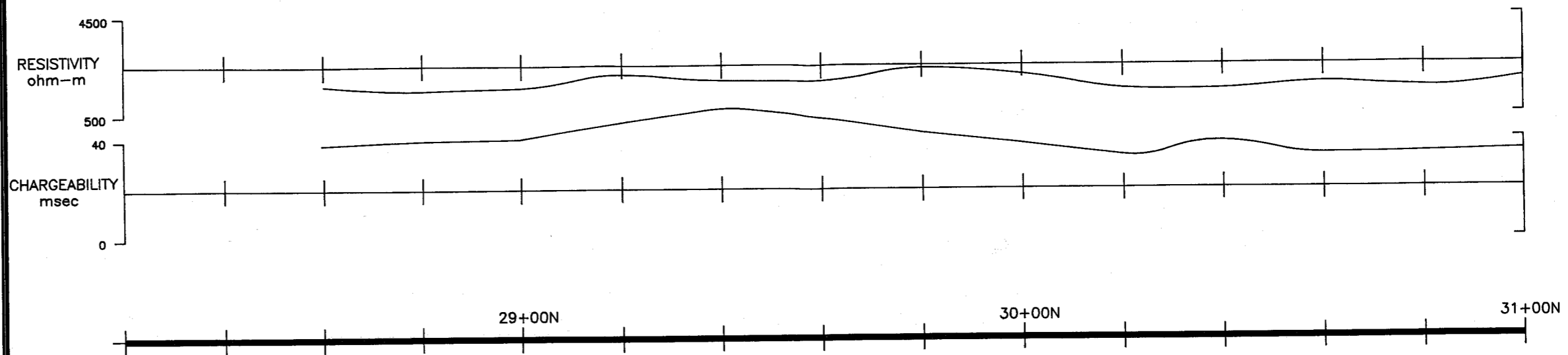

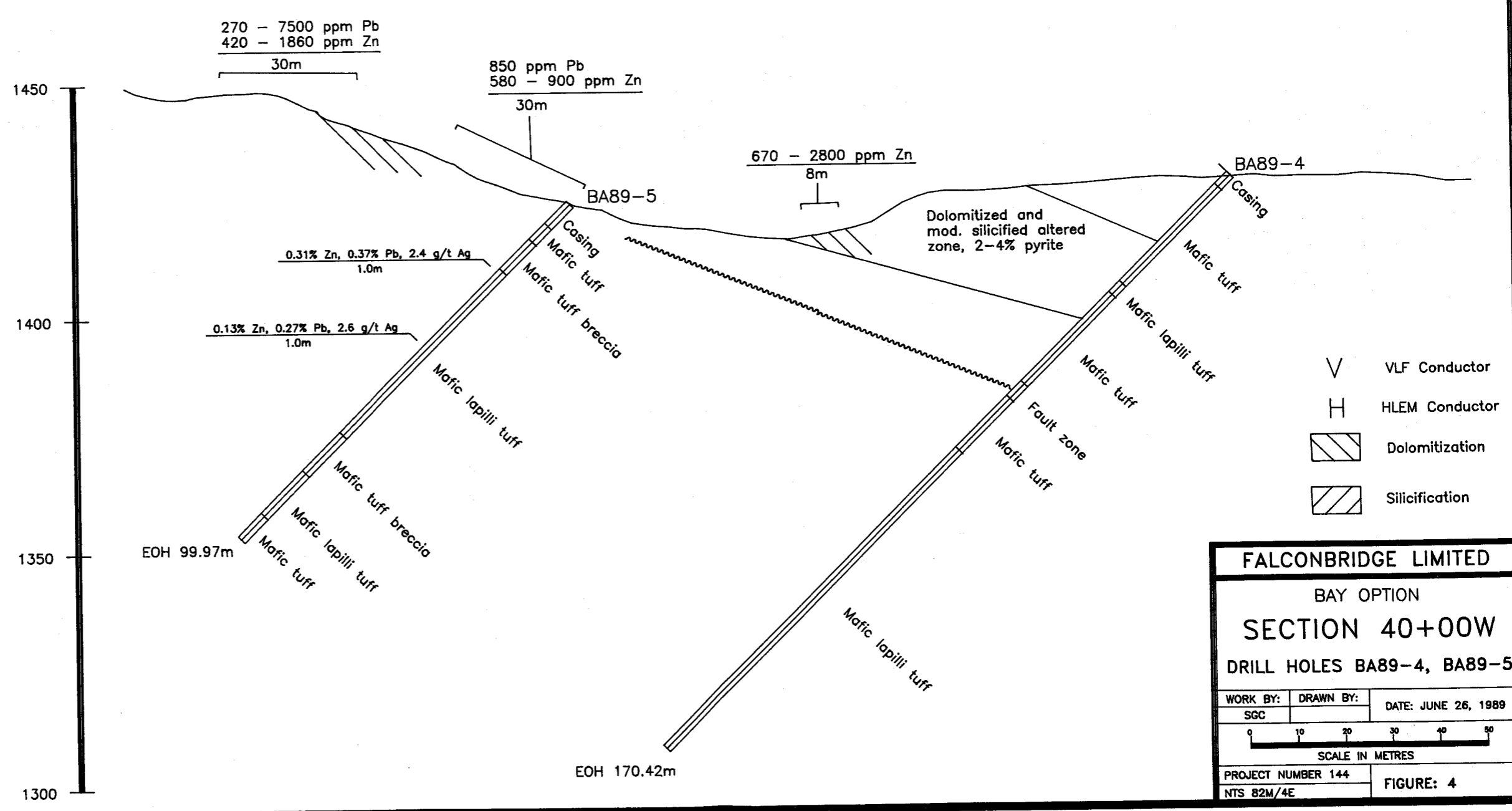
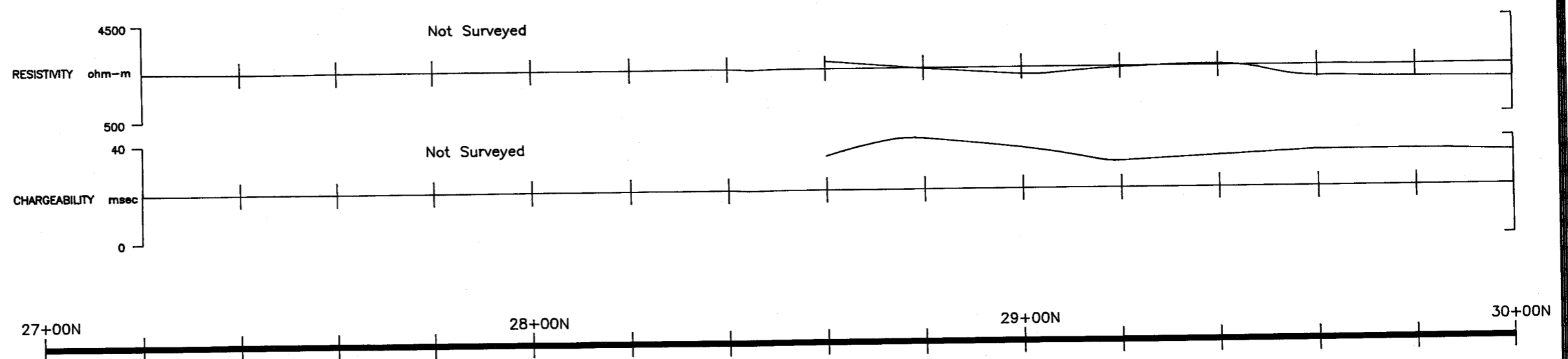

FALCONBRIDGE LIMITED

BAY OPTION

SECTION 40+00W

DRILL HOLES BA89-4, BA89-5

| | | |
|-----------------|-----------|---------------------|
| WORK BY: SGC | DRAWN BY: | DATE: JUNE 26, 1989 |
|-----------------|-----------|---------------------|

0 10 20 30 40 50
SCALE IN METRES

| | |
|----------------------------------|-----------|
| PROJECT NUMBER 144 NTS 82M/4E | FIGURE: 4 |
|----------------------------------|-----------|

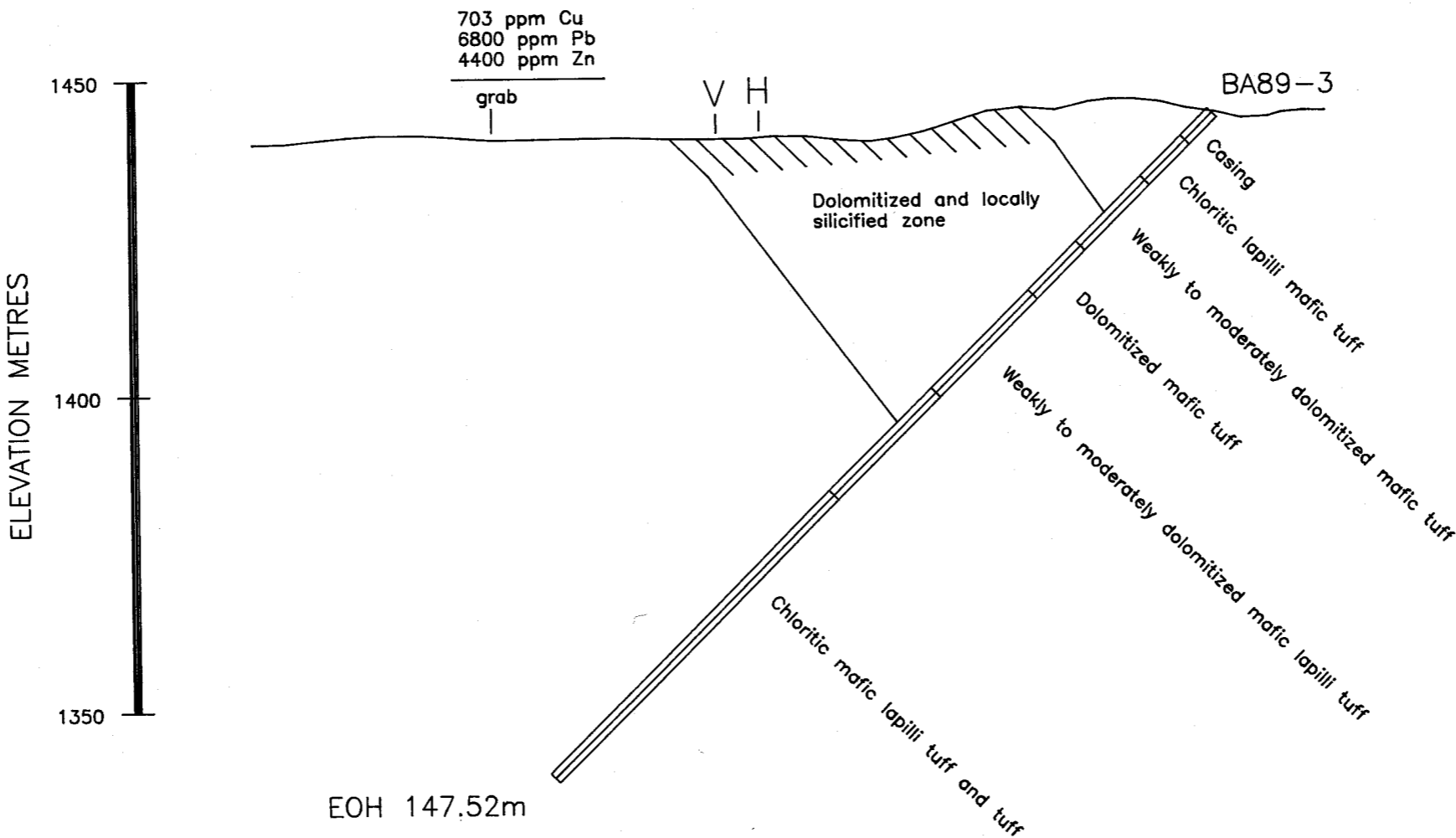
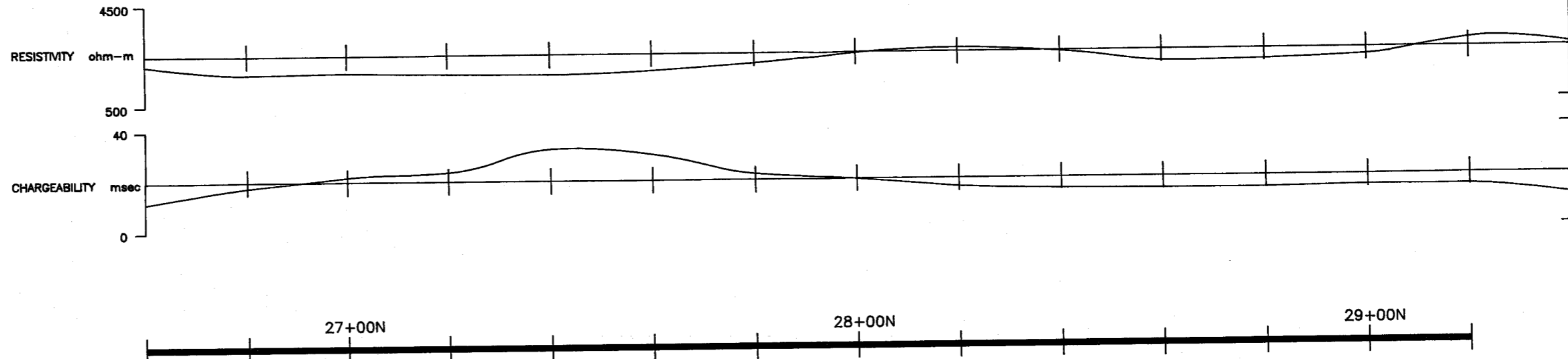

- V VLF Conductor
- H HLEM Conductor
- Dolomitization
- Silicification

| | | |
|-----------------------------|-----------|---------------------|
| FALCONBRIDGE LIMITED | | |
| BAY OPTION | | |
| SECTION 34+00W | | |
| DRILL HOLE BA89-3 | | |
| WORK BY: SGC | DRAWN BY: | DATE: JUNE 26, 1989 |
| SCALE IN METRES | | |
| PROJECT NUMBER 144 | | FIGURE: 5 |
| NTS 82M/4E | | |

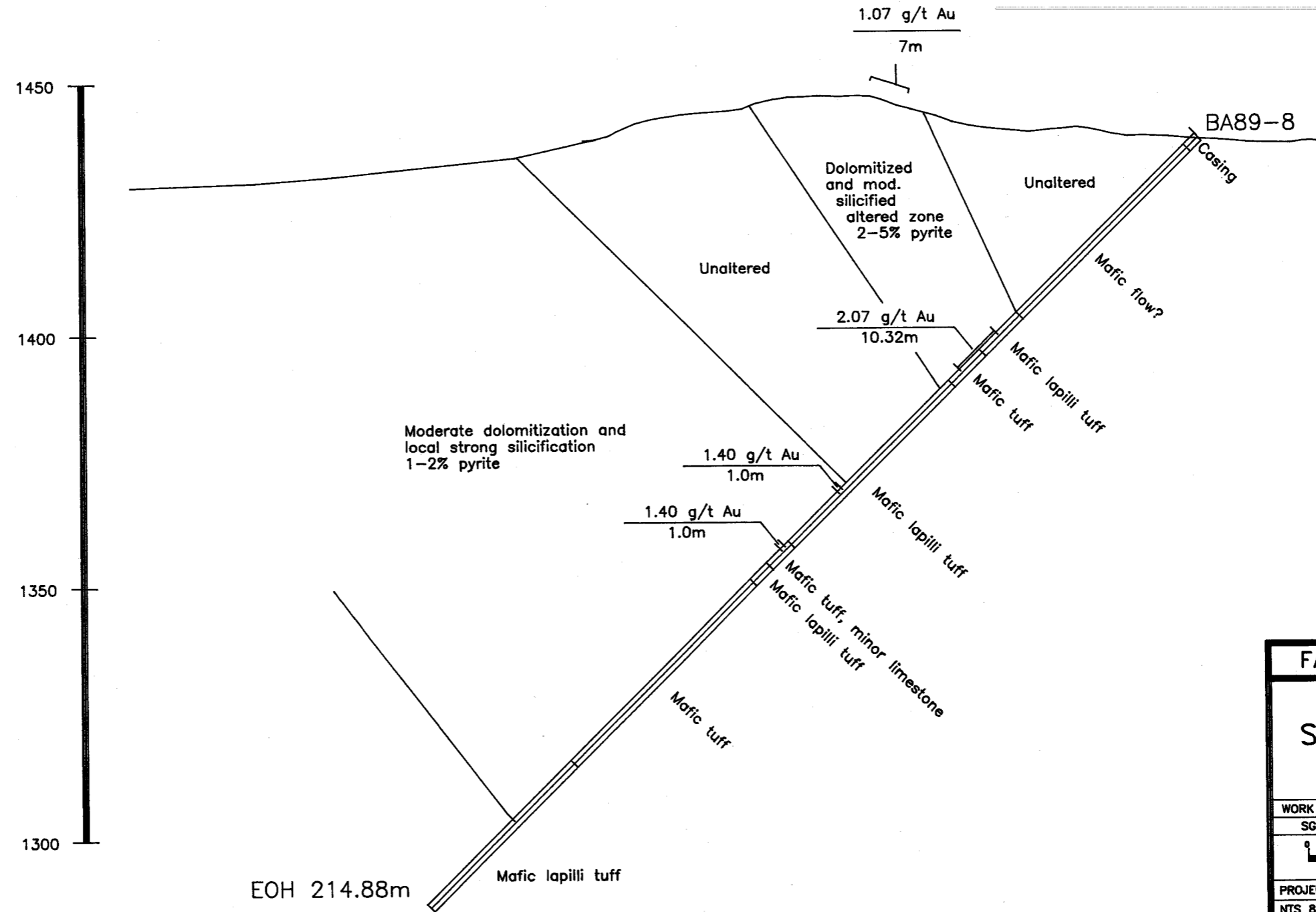
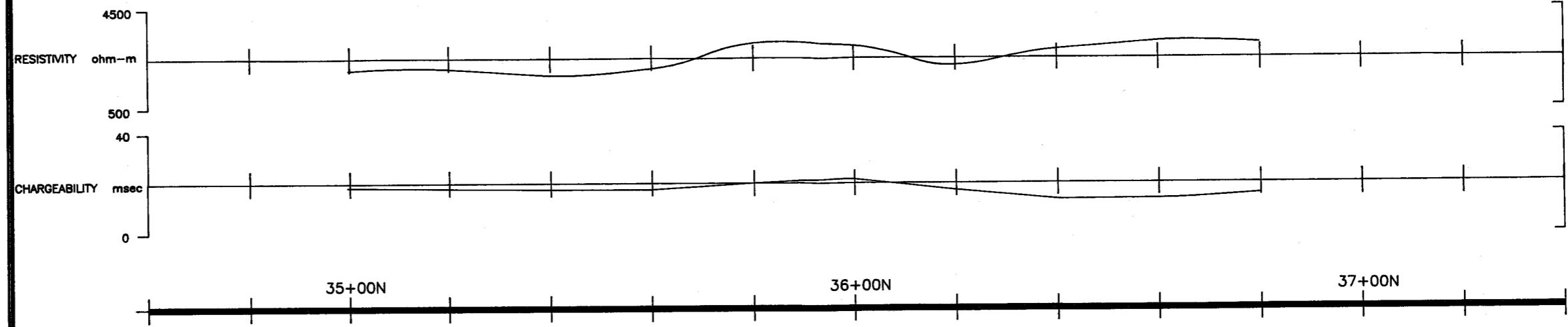

| | | |
|----------------------|-----------|---------------------|
| FALCONBRIDGE LIMITED | | |
| BAY OPTION | | |
| SECTION 42+00W | | |
| DRILL HOLE BA89-8 | | |
| WORK BY: SGC | DRAWN BY: | DATE: JUNE 25, 1989 |
| | | |
| PROJECT NUMBER 144 | | FIGURE 6 |
| NTS 82M/4E | | |

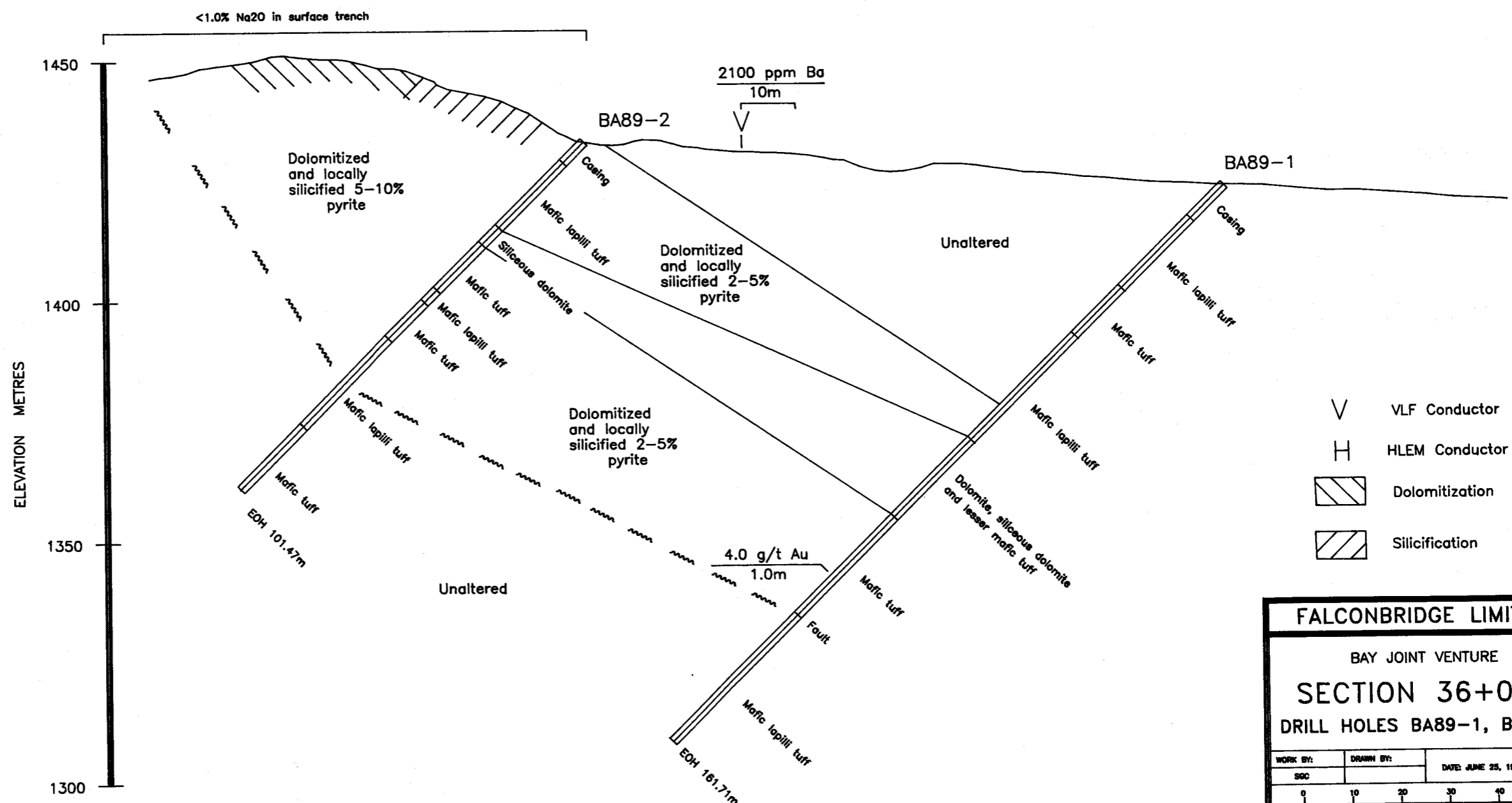
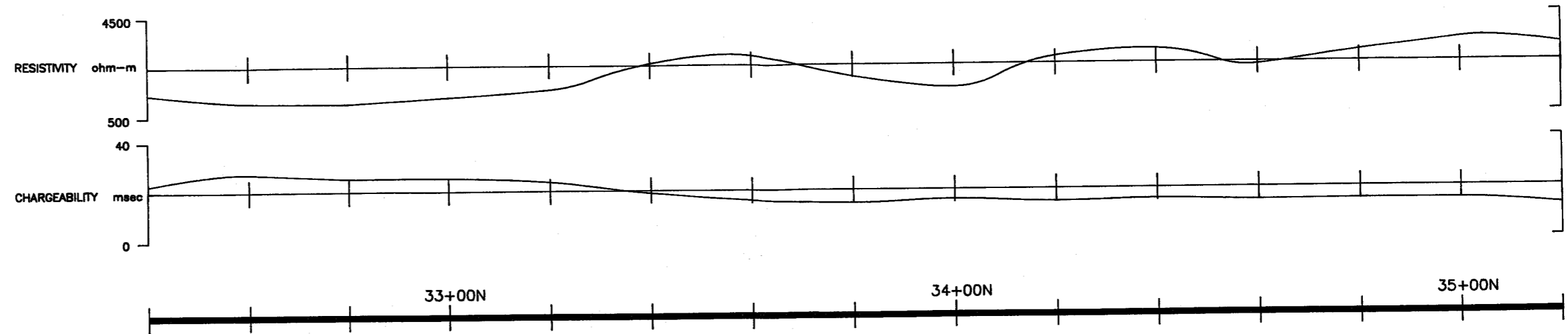

- V VLF Conductor
- H HLEM Conductor
- Dolomitization
- Silicification

FALCONBRIDGE LIMITED

BAY JOINT VENTURE

SECTION 36+00W

DRILL HOLES BA89-1, BA89-2

| | | |
|----------|-----------|---------------------|
| WORK BY: | DRAWN BY: | DATE: JUNE 25, 1988 |
| SGC | | |

0 10 20 30 40 50

SCALE IN METRES

PROJECT NUMBER 144

NTS 82M/4E

FIGURE : 7

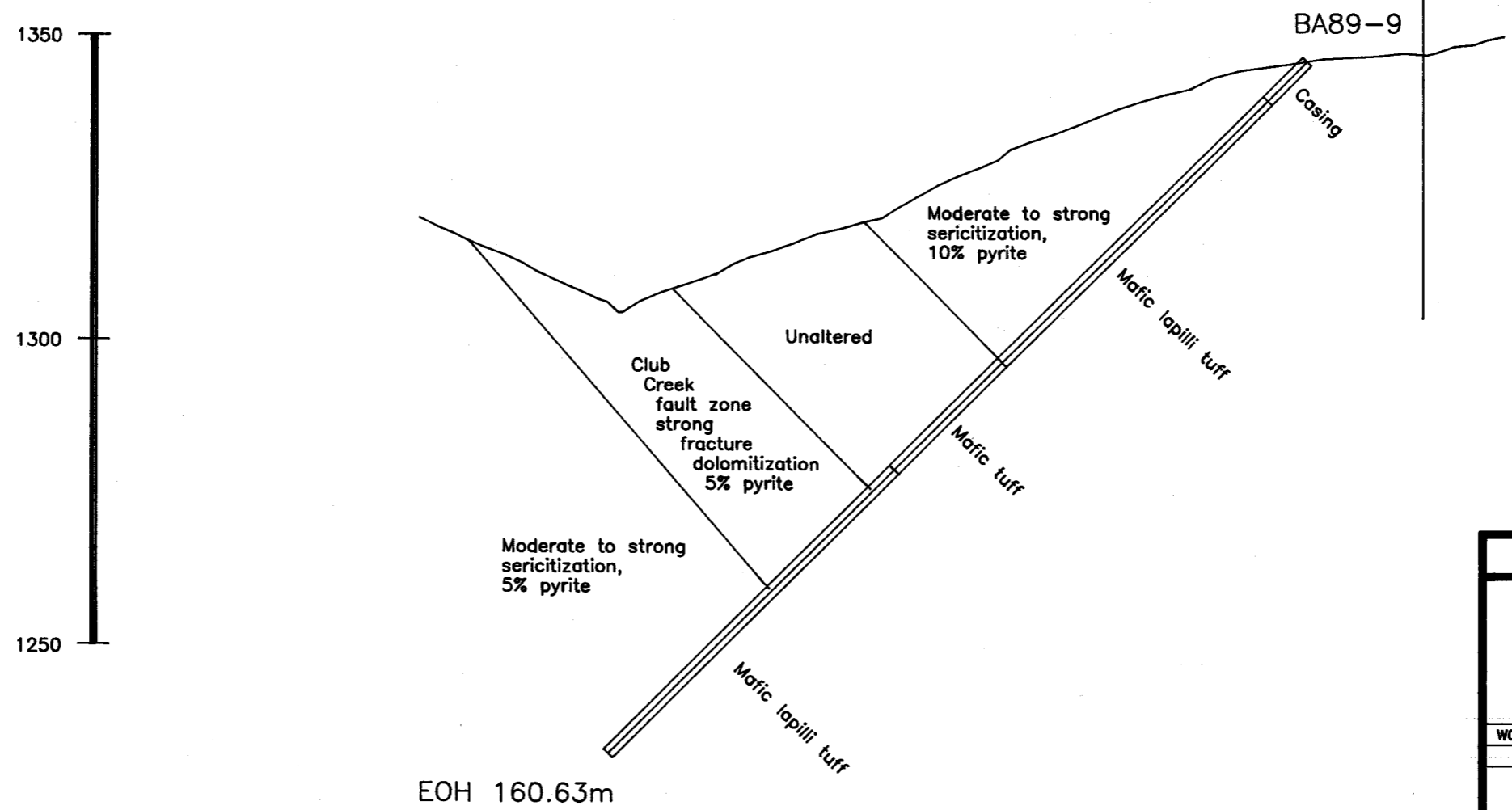
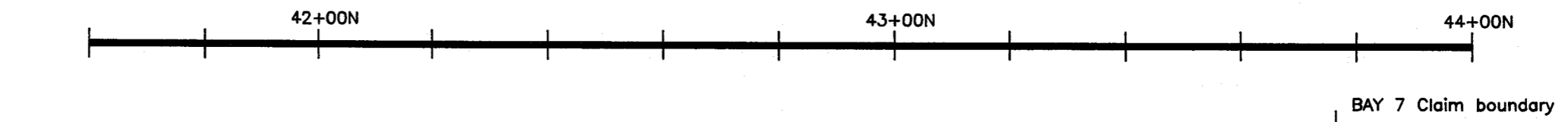
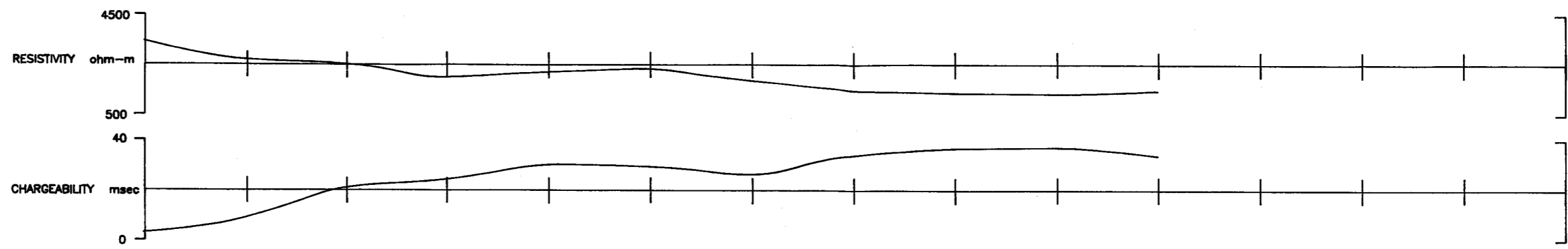

| | | |
|----------------------|-----------|---------------------|
| FALCONBRIDGE LIMITED | | |
| BAY OPTION | | |
| SECTION 35+00W | | |
| DRILL HOLE BA89-9 | | |
| WORK BY: SGC | DRAWN BY: | DATE: JUNE 25, 1989 |
| SCALE IN METRES | | |
| PROJECT NUMBER 144 | | FIGURE: 8 |
| NTS 82M/4E | | |

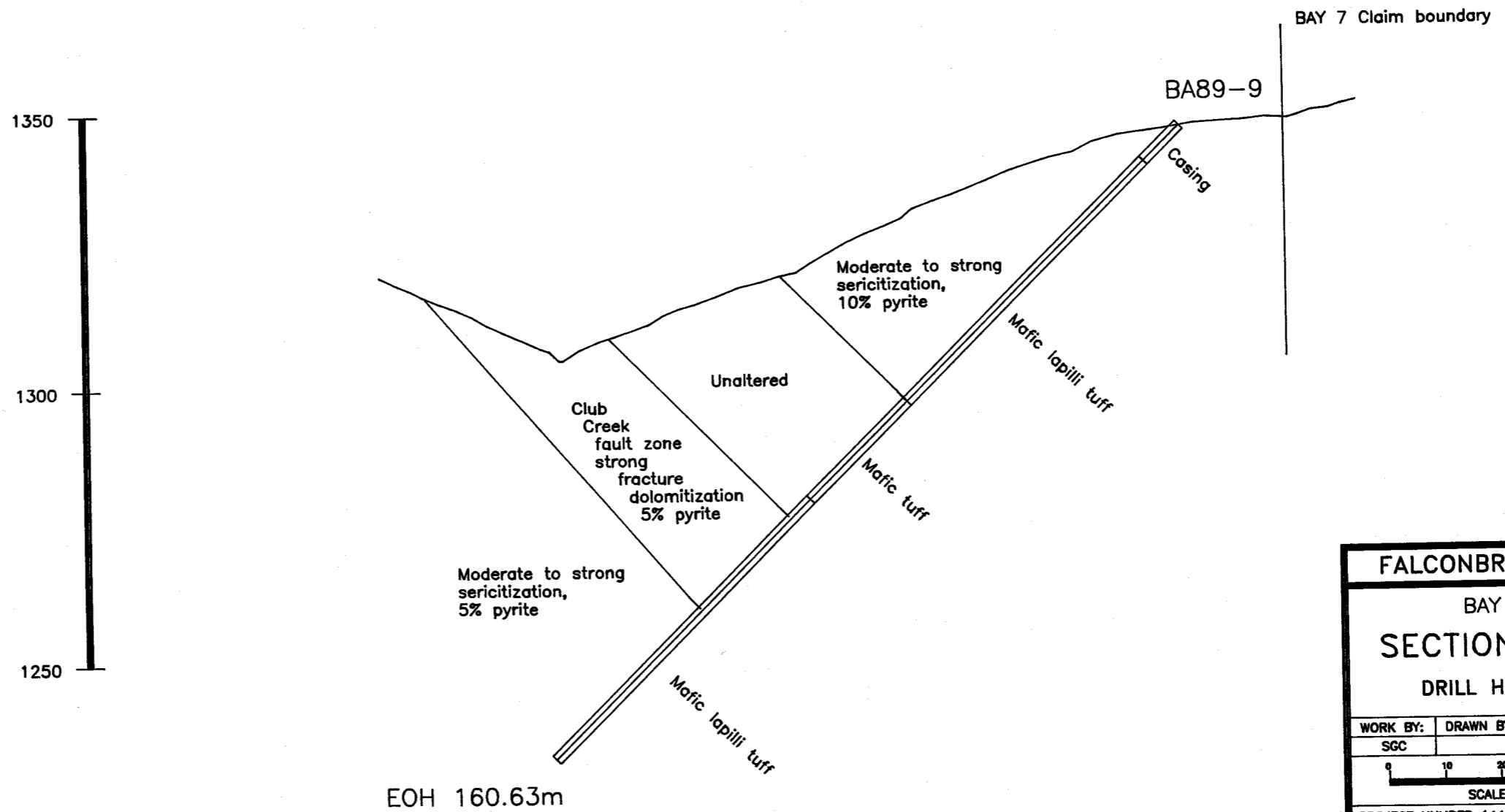
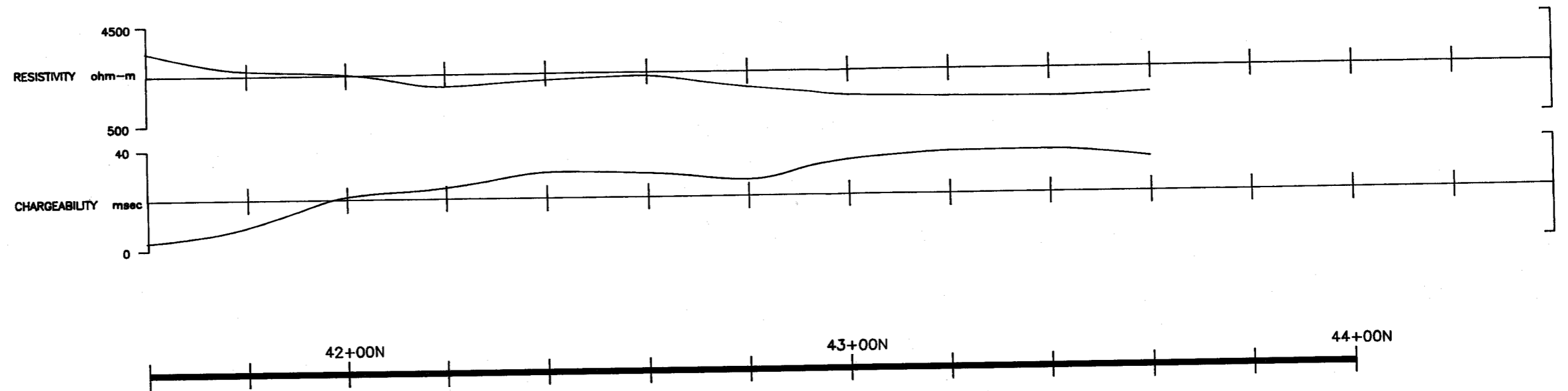

| | | |
|------------------------|-----------|---------------------|
| FALCONBRIDGE LIMITED | | |
| BAY OPTION | | |
| SECTION 35+00W | | |
| DRILL HOLE BA89-9 | | |
| WORK BY: SGC | DRAWN BY: | DATE: JUNE 25, 1989 |
| <p>SCALE IN METRES</p> | | |
| PROJECT NUMBER 144 | | FIGURE: 8 |
| NTS 82M/4E | | |

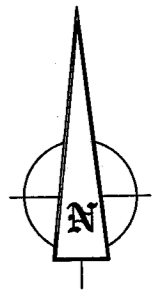
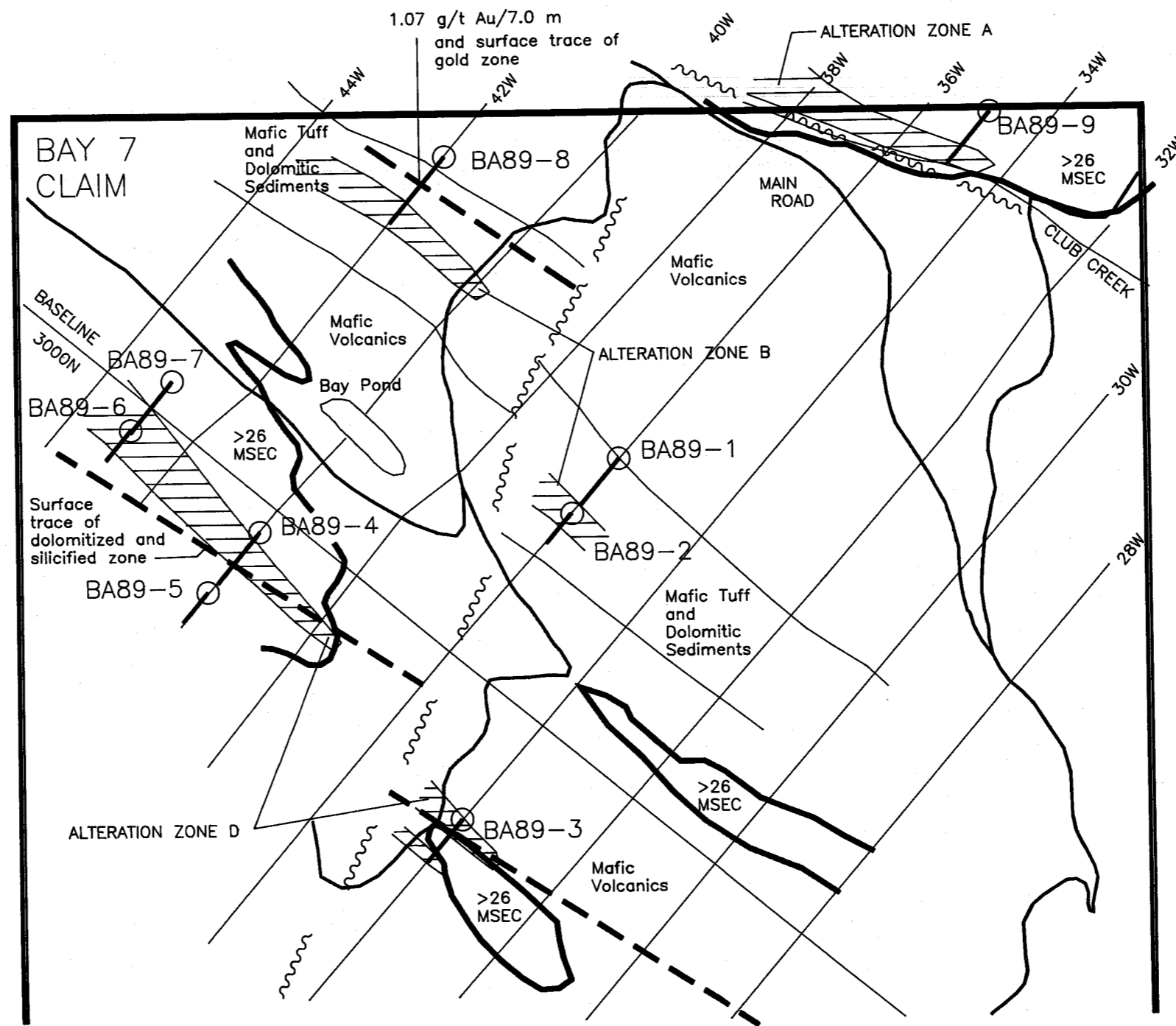

- IP CHARGEABILITY > 26 MSEC SCHLUMBERGER ARRAY
- FAULT
- ALTERATION ZONE
- DRILL HOLE

| | | |
|-----------------------------|-------------------|---------------------|
| FALCONBRIDGE LIMITED | | |
| BAY OPTION | | |
| SUMMARY MAP | | |
| 1989 DRILL PROGRAM | | |
| WORK BY: | DRAWN BY: | DATE: JUNE 25, 1989 |
| SGC | | |
| | | |
| SCALE IN METRES | | |
| PROJECT NUMBER 144 | FIGURE : 3 | |
| NTS 82M/4E | | |

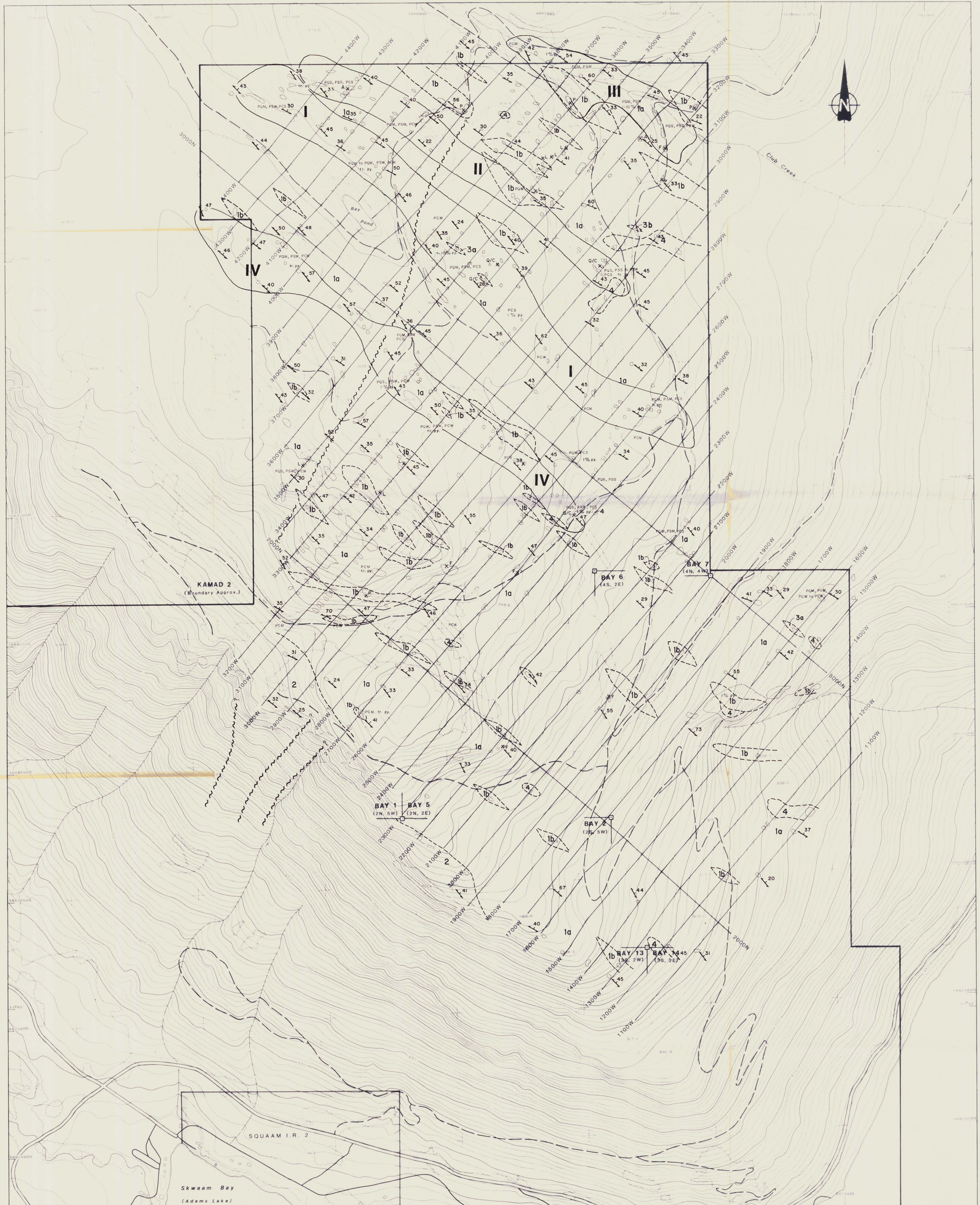

LEGEND

- SYMBOLS**
- Legal corner post
 - Property boundary
 - Grid
 - Foliation strike and dip
 - Geological contact, approximate
 - Outcrop

LITHOLOGIES

- EAGLE BAY FORMATION**
- 1 Calcareous Chlorite Phyllite/Schist
 - a Moderate to strongly foliated mafic pyroclastic
 - b Weak to moderately foliated mafic flow
 - 2 Quartz-Sericite Schist
 - 3 Metasediments
 - a Argillite
 - b Limestone
 - 4 Metagabbro

ALTERATION

- PCW Weak pervasive Fe/Mg carbonatization
- PCM Moderate pervasive Fe/Mg carbonatization
- PCS Strong pervasive Fe/Mg carbonatization
- PSW Weak pervasive sericitization
- PSM Moderate pervasive sericitization
- PSS Strong pervasive sericitization

ALTERATION ANOMALY

- QW Weak pervasive silicification
- QMW Moderate pervasive silicification
- QMS Strong pervasive silicification
- IV Alteration anomaly

MINERALIZATION

- PY Pyrite
- X A Ash tuff
- X L Lapilli tuff
- X F Block-sized fragmental
- X P Pillow
- X Q/C Quartz-carbonate

KIDD CREEK MINES LTD

1987 BAY PROPERTY GEOLOGY

NTS 82M/4E Project No. 144
 DATE _____ DRAWN BY _____
 SCALE IN METRES 1:5000
FIGURE: 2



SQUAM I.R. 2

Skwaam Bay
(Adams Lake)

KIDD CREEK MINES LTD.

Bay Property

Whole Rock

Sample Locations

| | | | |
|-------------------------|----------|-----------------|-----------|
| NTS 82M/4E | | Project No. 144 | |
| WORK BY | DRAWN BY | DATE | FIGURE: 7 |
| 0 | | 100 | 200 300 |
| Scale in Metres 1:5,000 | | | |



SQUAAM I.R. 2

Skwaam Bay
(Adams Lake)

KIDD CREEK MINES LTD.

Bay Property
Whole Rock
Modified Ishikawa

| | |
|------------|-----------------|
| NTS 82M/4E | Project No. 144 |
| WORK BY | DRAWN BY |
| DATE | FIGURE: 8 |

Scale in Metres 1:5,000

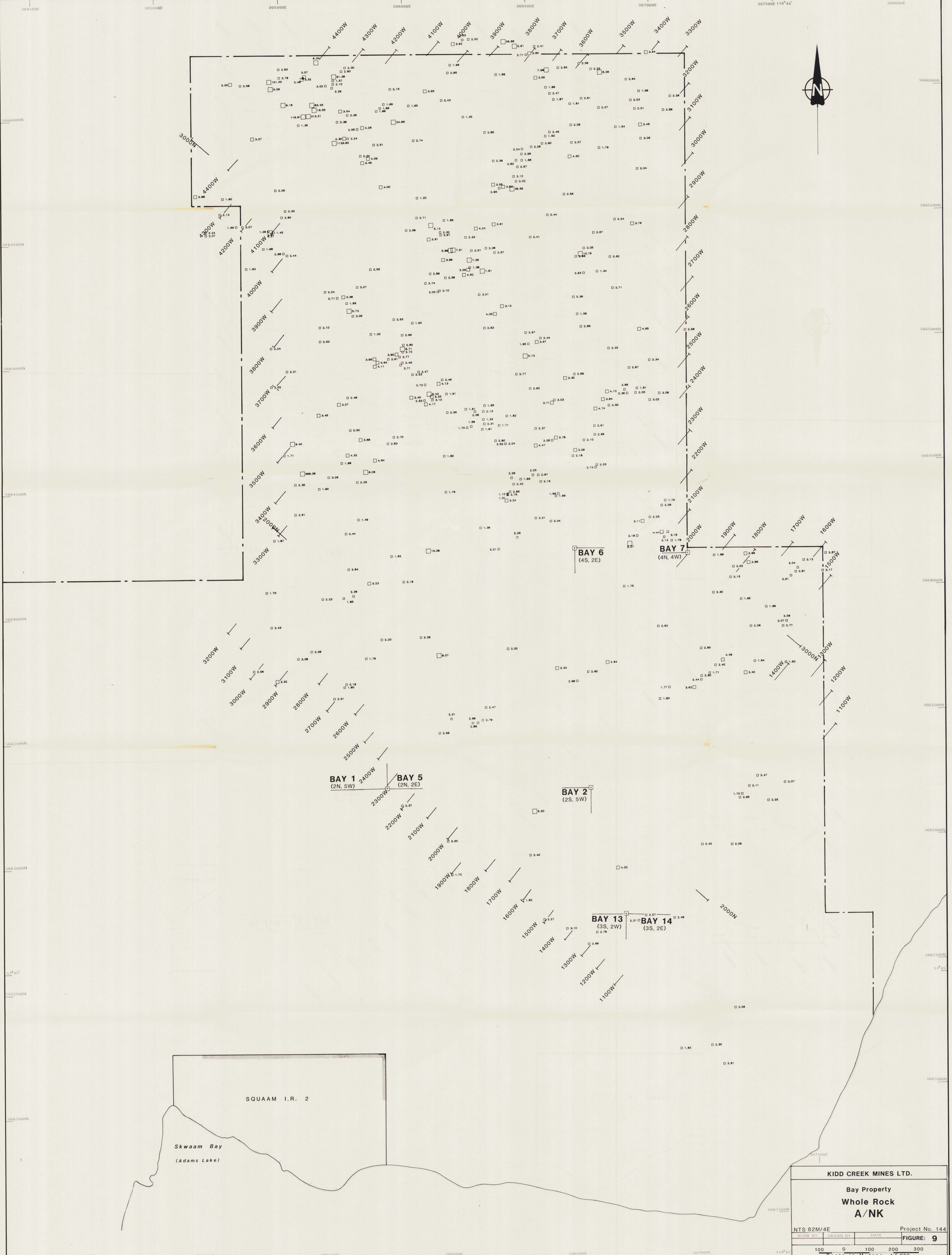

SQUAAM I.R. 2

Skwaam Bay
(Adams Lake)

BAY 6
(4S, 2E)

BAY 7
(4N, 4W)

BAY 1
(2N, 5W)

BAY 5
(2N, 2E)

BAY 2
(2S, 5W)

BAY 13
(3S, 2W)

BAY 14
(3S, 2E)

KIDD CREEK MINES LTD.

Bay Property
Whole Rock
A/NK

NTS 82M/4E Project No. 144

| | | | |
|---------|----------|------|-----------|
| WORK BY | DRAWN BY | DATE | FIGURE: 9 |
|---------|----------|------|-----------|

Scale in Metres 1:5,000

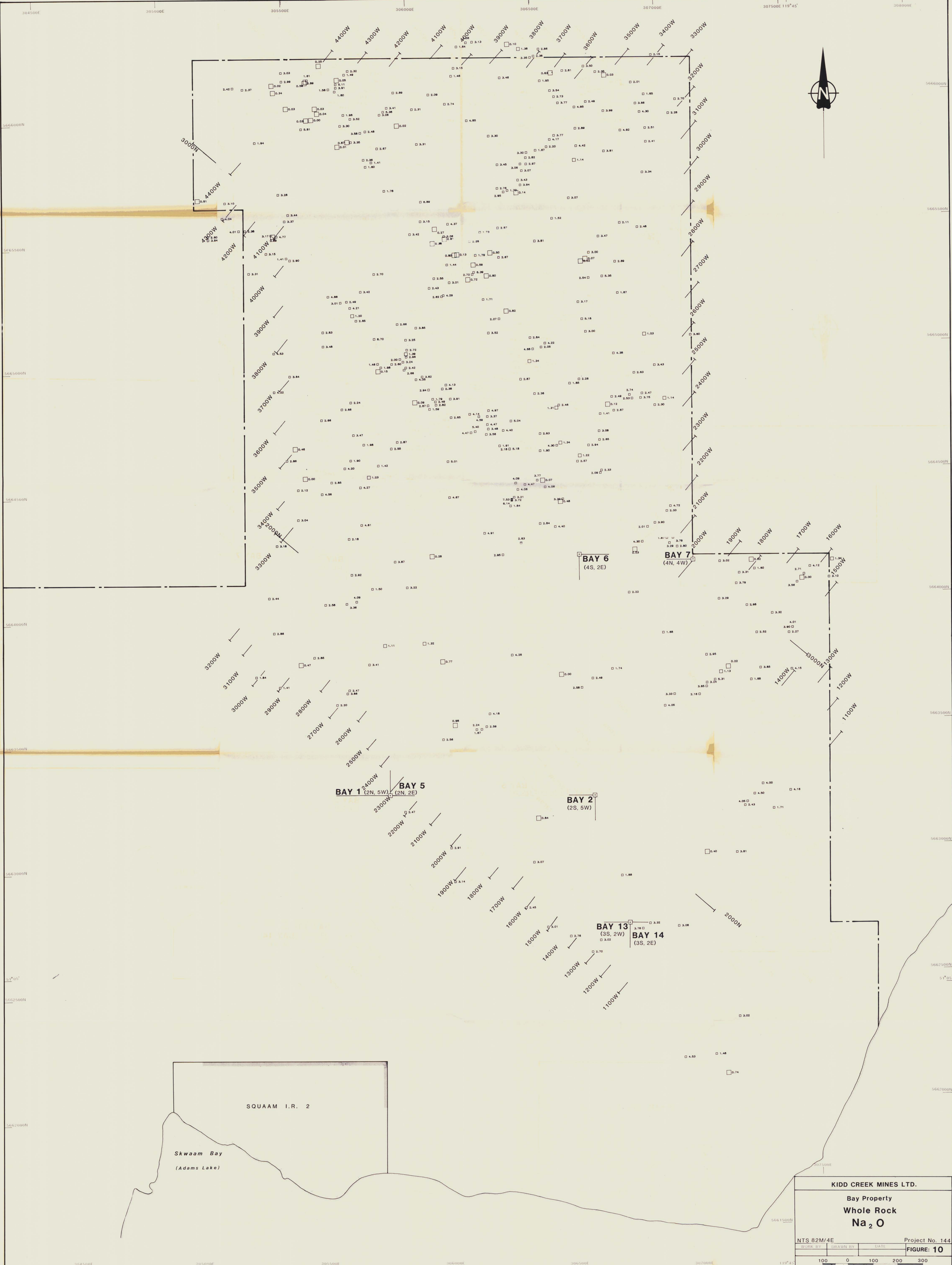

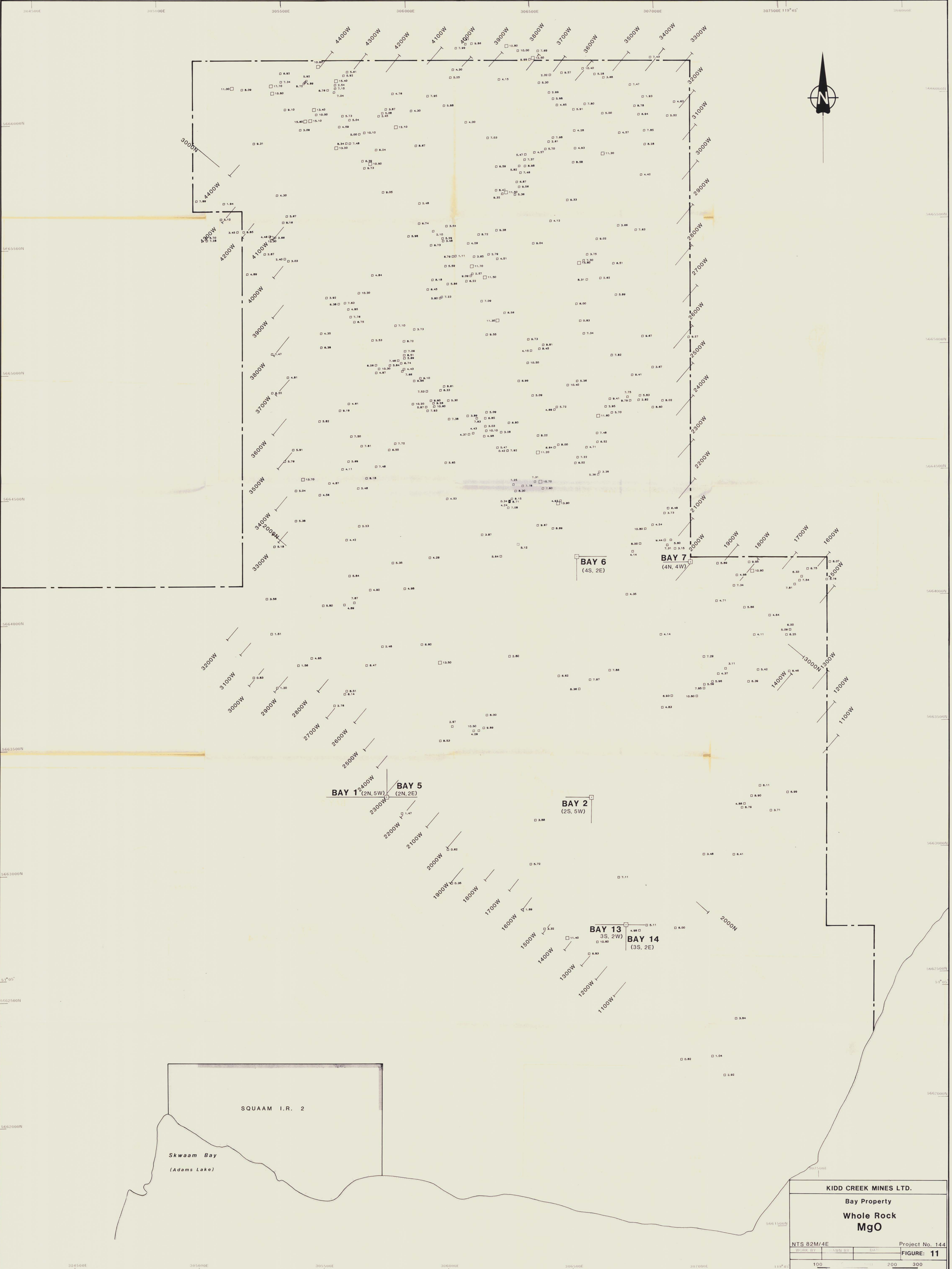

SQUAAM I.R. 2

Skwaam Bay
(Adams Lake)

BAY 6
(4S, 2E)

BAY 7
(4N, 4W)

BAY 1
(2N, 5W)

BAY 5
(2N, 2E)

BAY 2
(2S, 5W)

BAY 13
(3S, 2W)

BAY 14
(3S, 2E)

KIDD CREEK MINES LTD.

Bay Property

Whole Rock

MgO

NTS 82M/4E Project No. 144

| | | |
|---------|--------|------|
| WORK BY | AWN BY | DATE |
| | | |

FIGURE: 11

100 200 300

1:5,000

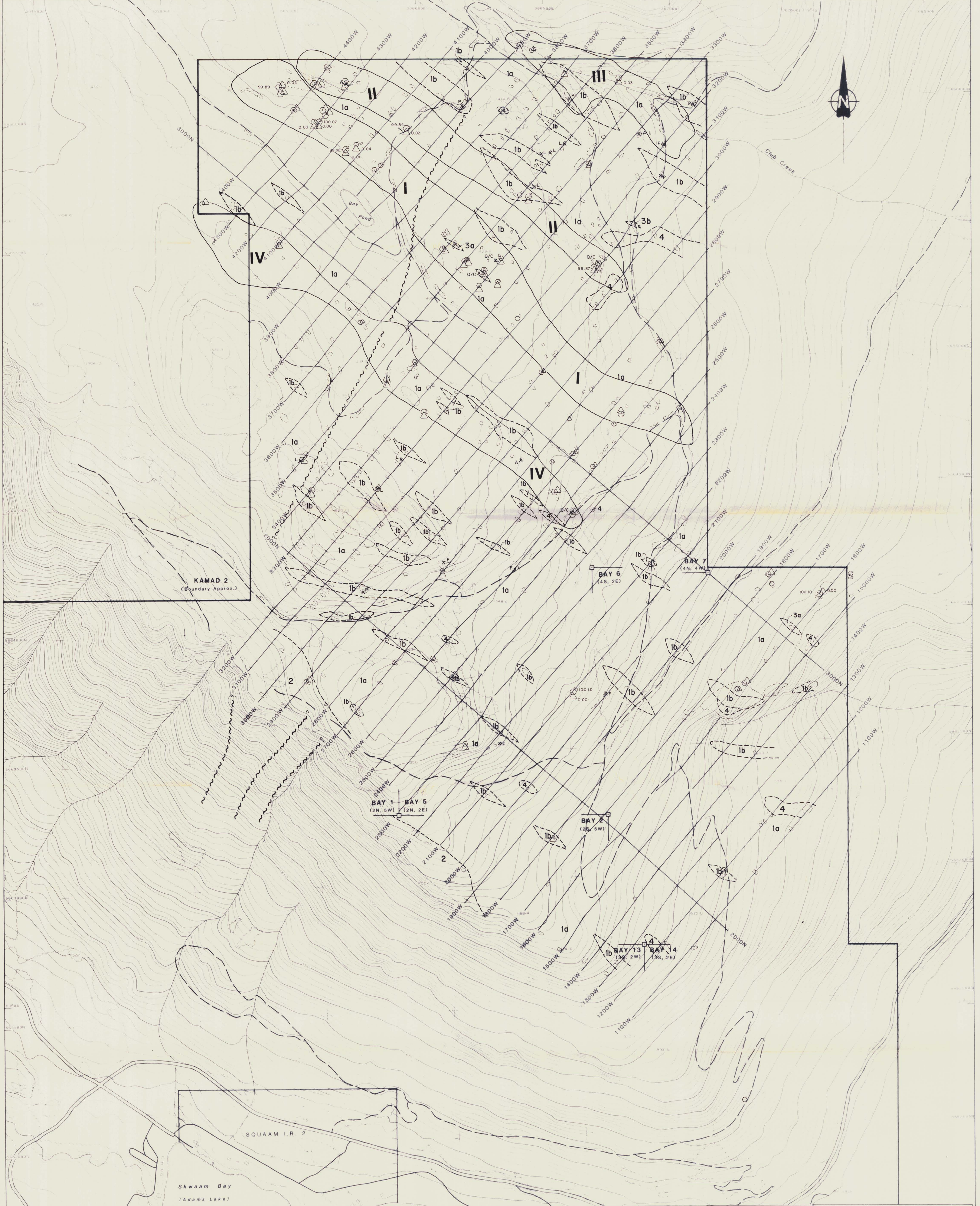

LEGEND

SYMBOLS

- Legal corner post
- Property boundary
- Grid
- Foliation strike and dip
- Geological contact, approximate
- Outcrop

LITHOLOGIES

EAGLE BAY FORMATION

Calcareous Chlorite Phyllite/Schist

1 Moderate to strongly foliated mafic pyroclastic

b Weak to moderately foliated mafic flow

2 Quartz-Sericite Schist

3 Metasediments

a Argillite

b Limestone

4 Metagabbro

ALTERATION

PCW Weak pervasive Fe/Mg carbonatization

PCM Moderate pervasive Fe/Mg carbonatization

PCS Strong pervasive Fe/Mg carbonatization

PSW Weak pervasive sericitization

PSM Moderate pervasive sericitization

PSS Strong pervasive sericitization

ALTERATION ANOMALY

IV Alteration anomaly

ISHIKAWA

○ 95.01-95.00

○ 95.01-100.11

△ 1.01-1.40

△ 0.00-1.00

MINERALIZATION

Py Pyrite

X A Ash tuff

X L Lapilli tuff

X F Block-sized fragmental

X p Pillow

X Q/C Quartz-carbonate

KIDD CREEK MINES LTD

1987 BAY PROPERTY

WHOLE ROCK ANOMALIES

MODIFIED ISHIKAWA, Na₂O

NTS 82M/4E Project No. 144

FIGURE 12

SCALE IN METRES 1:5000

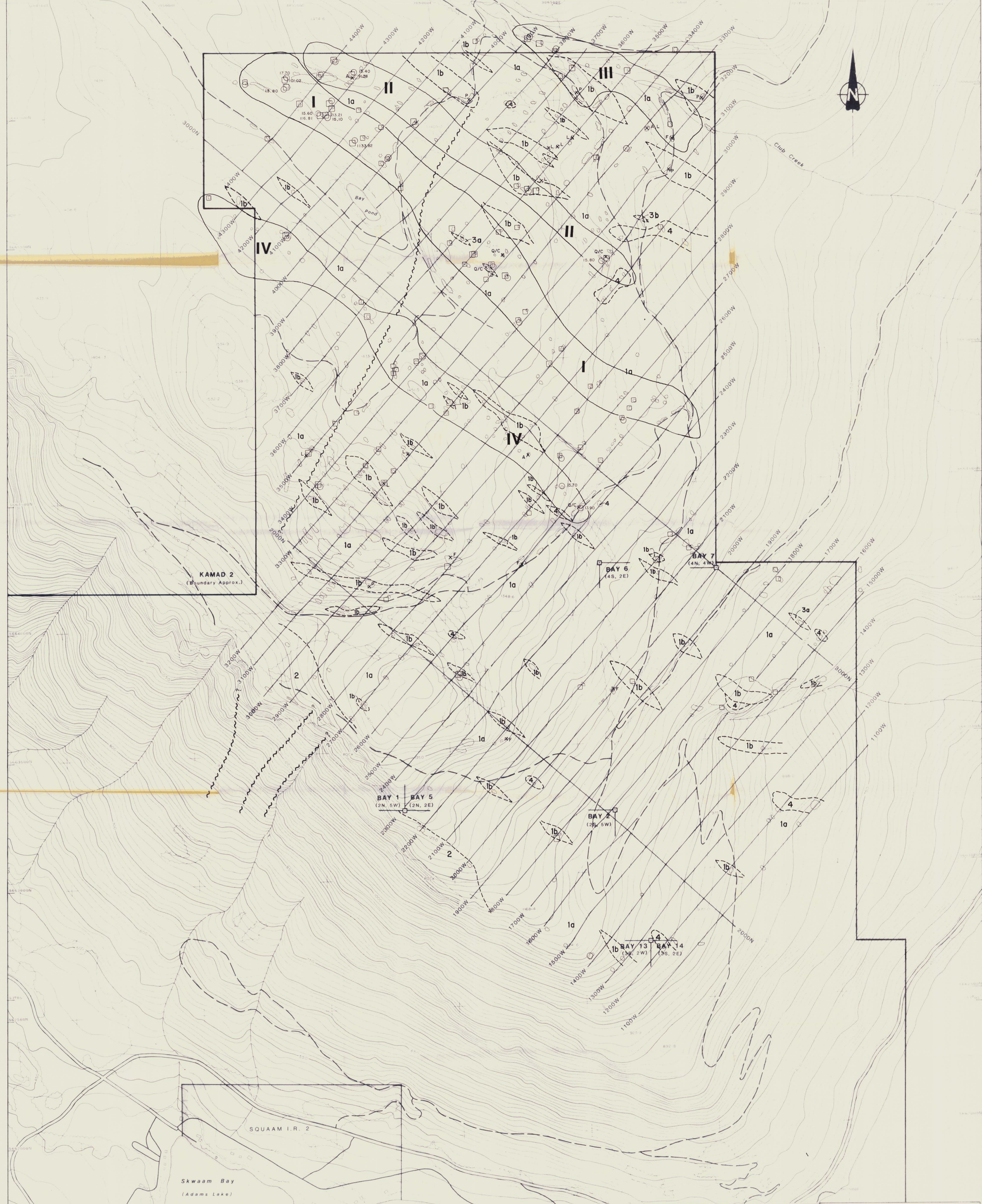

LEGEND

- SYMBOLS**
- Legal corner post
 - Property boundary
 - Grid
 - ↘ 45° Foliation strike and dip
 - - - Geological contact, approximate
 - Outcrop

LITHOLOGIES

- EAGLE BAY FORMATION**
- 1 Calcareous Chlorite Phyllite/Schist
 - a Moderate to strongly foliated mafic pyroclastic
 - b Weak to moderately foliated mafic flow
 - 2 Quartz-Sericite Schist
 - 3 Metasediments
 - a Argillite
 - b Limestone
 - 4 Metagabbro

ALTERATION

- PCW Weak pervasive Fe/Mg carbonatization
- PCM Moderate pervasive Fe/Mg carbonatization
- PCS Strong pervasive Fe/Mg carbonatization
- PSW Weak pervasive sericitization
- PSM Moderate pervasive sericitization
- PSS Strong pervasive sericitization

MINERALIZATION

- PW Weak pervasive silicification
- PM Moderate pervasive silicification
- PS Strong pervasive silicification
- IV Alteration anomaly

MINERALIZATION

- Py Pyrite
- X A Ash tuff
- X L Lapilli tuff
- X F Block-sized fragmental
- X P Pillow
- X Q/C Quartz-carbonate

A/NK

- 0.01-1200.00
- 3.11-5.00
- 10.9-18.00

KIDD CREEK MINES LTD

1987 BAY PROPERTY

WHOLE ROCK ANOMALIES

A/NK, MgO

NTS 82M/4E Project No. 144

DATE: _____

FIGURE: 13

SCALE IN METRES 1:5000

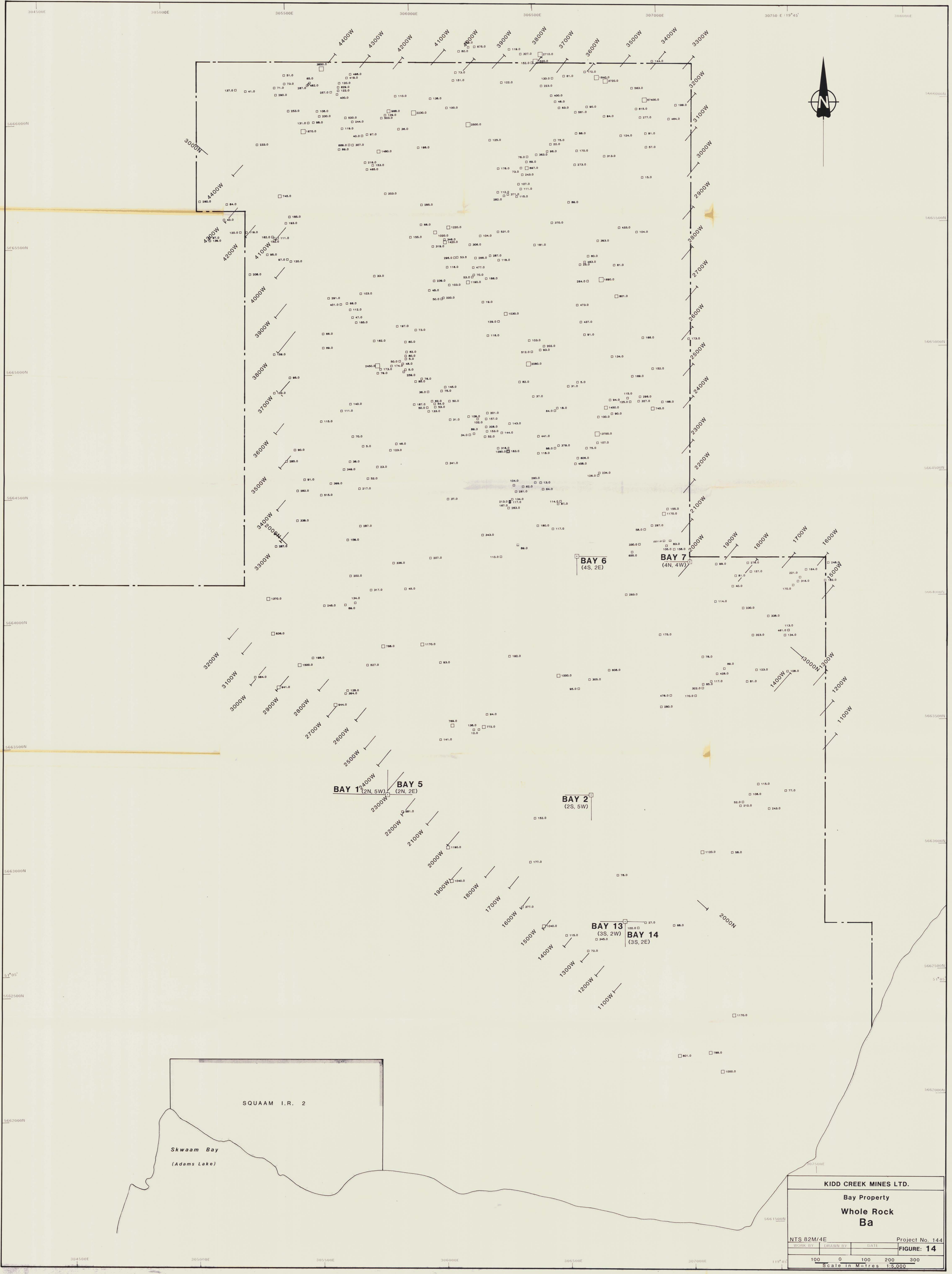

SQUAAM I.R. 2

Skweam Bay
(Adams Lake)

KIDD CREEK MINES LTD.

Bay Property

Whole Rock

Ba

| | | | |
|------------------------|----------|-----------------|------------|
| NTS 82M/4E | | Project No. 144 | |
| WORK BY | DRAWN BY | DATE | FIGURE: 14 |
| 100 | 0 | 100 | 200 300 |
| Scale in Metres 1:5000 | | | |

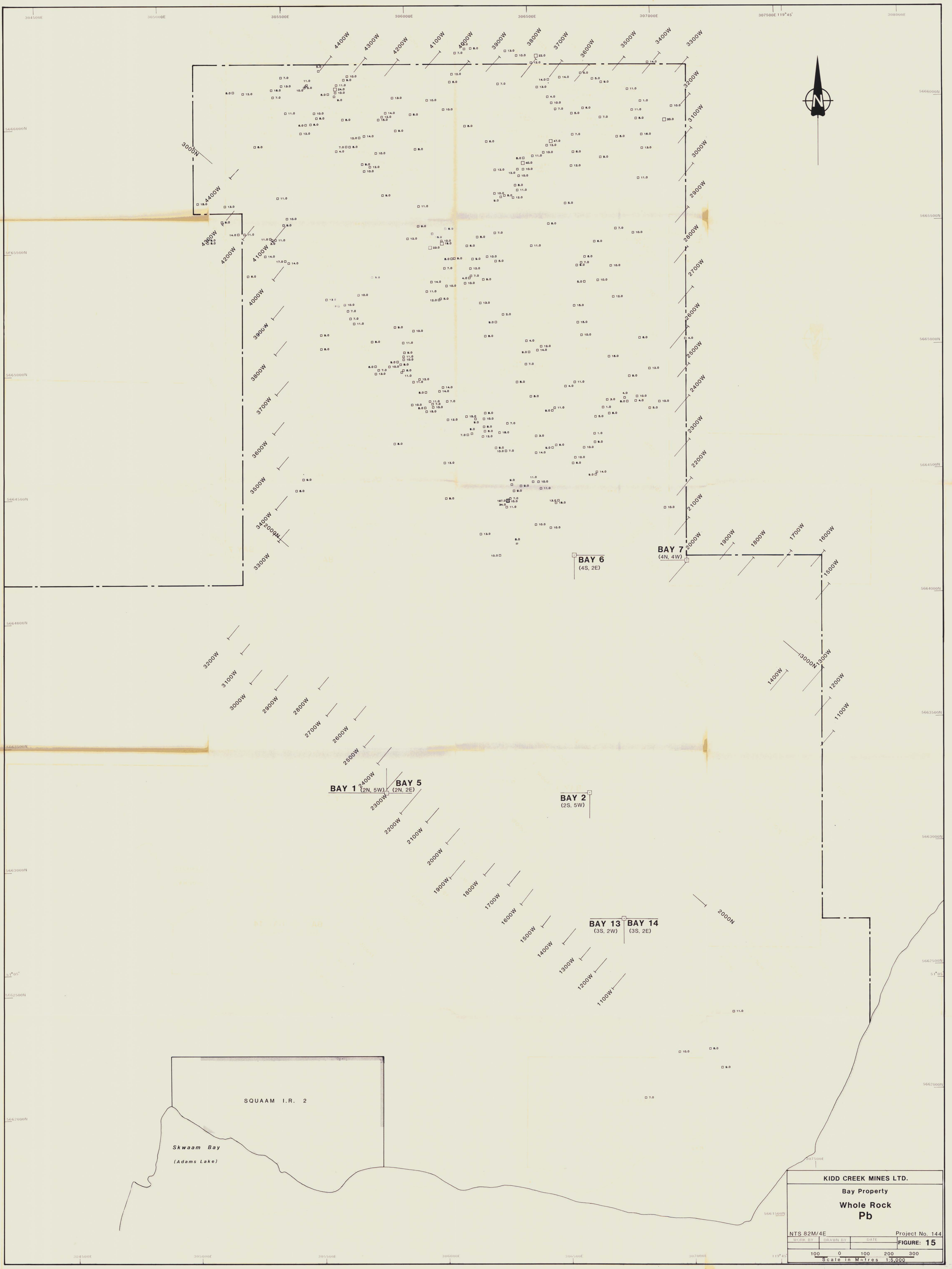

| | | | |
|------------------------------|----------|-----------------|------------|
| KIDD CREEK MINES LTD. | | | |
| Bay Property | | | |
| Whole Rock Pb | | | |
| NTS 82M/4E | | Project No. 144 | |
| WORK BY | DRAWN BY | DATE | FIGURE: 15 |
| 100 0 100 200 300 | | | |
| Scale in Metres 1:5,000 | | | |

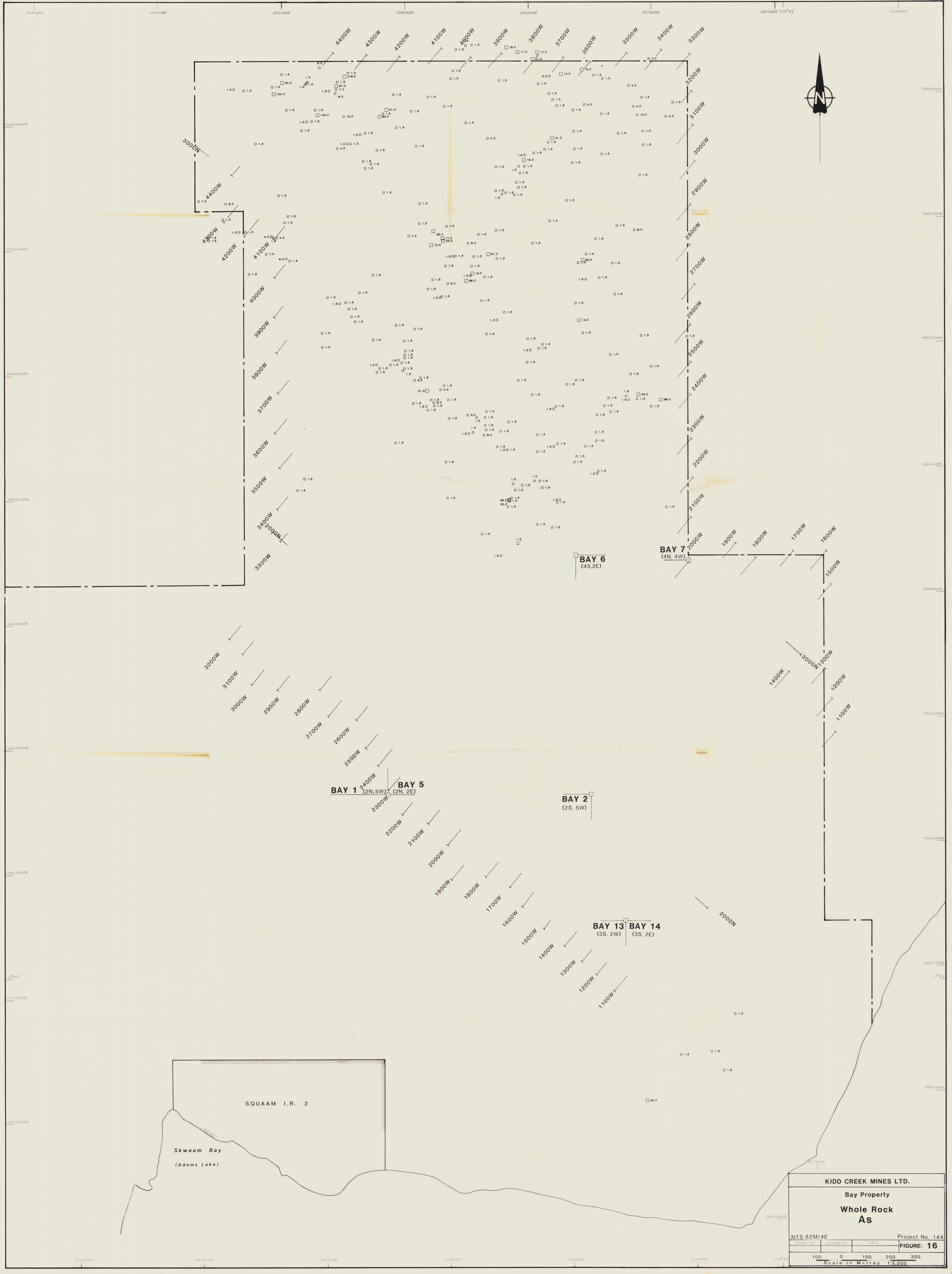

KIDD CREEK MINES LTD.
Bay Property
Whole Rock
As

| | | |
|-------------------------|-----------------|------|
| NTS 82M/4E | Project No. 144 | |
| WORK BY | DRAWN BY | DATE |
| FIGURE: 16 | | |
| Scale in Metres 1:5,000 | | |

SQUAAM I.R. 2

Skwaam Bay
(Adams Lake)

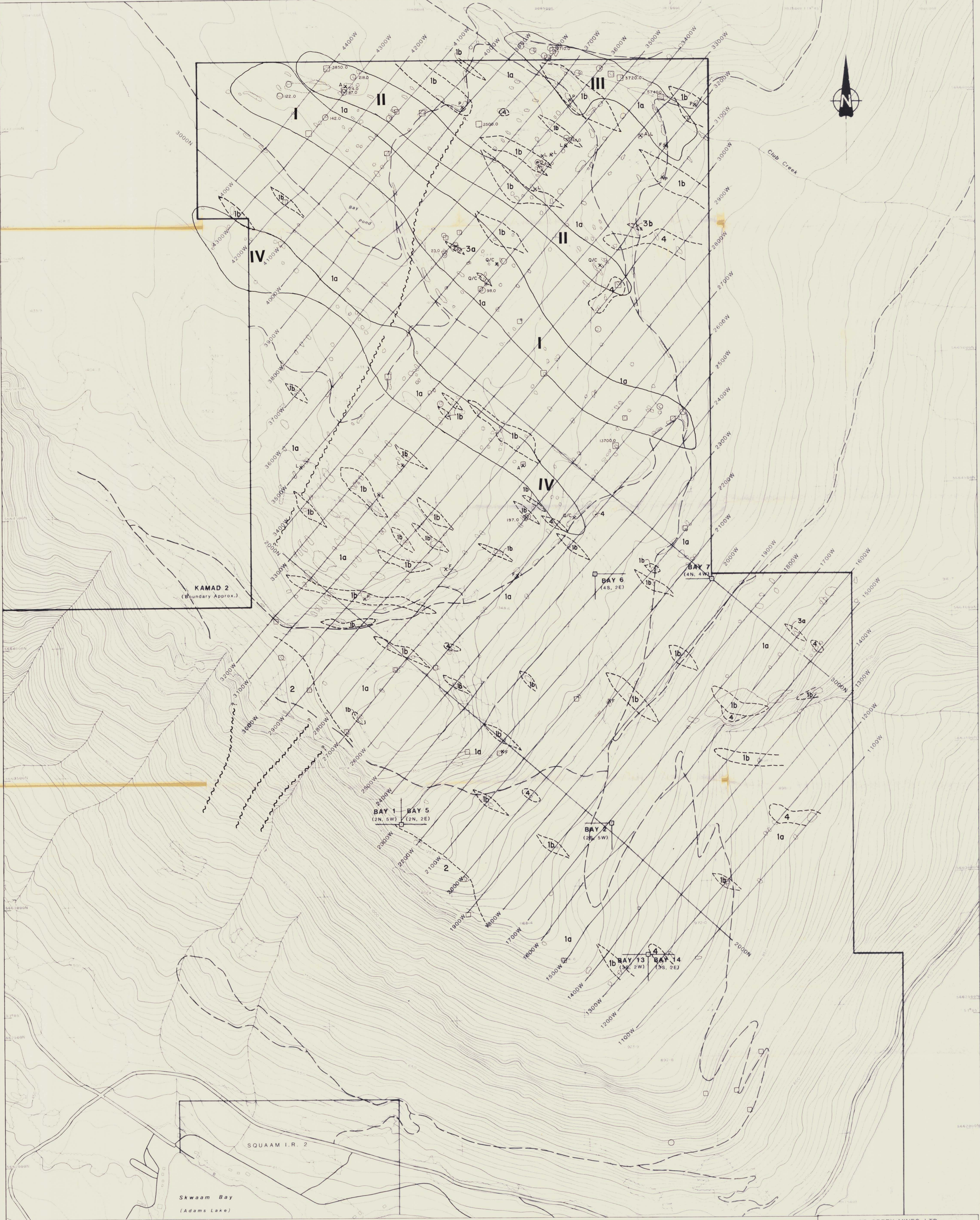

LEGEND

- SYMBOLS**
- Legal corner post
 - Property boundary
 - Grid
 - 45° Foliation strike and dip
 - Geological contact, approximate
 - Outcrop

- LITHOLOGIES**
- EAGLE BAY FORMATION**
- 1 Calcareous Chlorite Phyllite/Schist
 - a Moderate to strongly foliated: mafic pyroclastic
 - b Weak to moderately foliated: mafic flow
 - 2 Quartz-Sericite Schist
 - 3 Metasediments
 - a Argillite
 - b Limestone
 - 4 Metagabbro

- ALTERATION**
- PCW Weak pervasive Fe/Mg carbonatization
 - PCM Moderate pervasive Fe/Mg carbonatization
 - PCS Strong pervasive Fe/Mg carbonatization
 - PSW Weak pervasive sericitization
 - PSM Moderate pervasive sericitization
 - PSS Strong pervasive sericitization
 - PCW Weak pervasive silicification
 - PCM Moderate pervasive silicification
 - PCS Strong pervasive silicification
 - IV Alteration anomaly

- MINERALIZATION**
- Py Pyrite
 - X A Ash tuff
 - X L Lapilli tuff
 - X F Block-sized fragmental
 - X p Pillow
 - X Q/C Quartz-carbonate

- BARIUM**
- 1500.01 - 58000.00
 - 700.01 - 1500.00
- ARSENIC**
- 10.01 - 220.00
- LEAD**
- 18.01 - 200.00

KIDD CREEK MINES LTD

1987 BAY PROPERTY WHOLE ROCK ANOMALIES Ba, Pb, As

NTS 82M/4E Project No. 144

DATE DRAWN BY DATE

FIGURE: 17

SCALE IN METRES 1:5000