

Box 4

B.C. GEOLOGICAL
SURVEY BRANCH

MICKLE MORESBY ISLAND OPTION
(Snow 1 to 5 claims)
PN 080
NTS 103G/4W
Vancouver, B. C.
February, 1981 B. W. Downing

MICKLE MORESBY ISLAND OPTION (Snow 1 to 5 Claims) 103-G-4
PN 080 B. Downing February 1981. B.C.

REFERENCE MEMORANDUM

SMC

DATE Feb 19 1981
TO J. E. Cowan / WBBB
FROM B. W. Downing EXT. NO. _____

- Work Order
- Tax
- Need More Detail
- Please Code
- Please Expedite
- Please See Me
- For Your Information
- For Approval
- Your Comments
- Please Retain
- Please Return
- Please Photocopy
- Please File
- Please Handle

Remarks PN 080 Report
Mickle Option

RECEIVED

FEB 23 1981

MICKLE MORESBY ISLAND OPTION (Snow 1 to 5 Claims)

PN 080

NTS 103G/4W

Vancouver, B. C.

B. W. Downing

February, 1981

ABSTRACT

A gold property consisting of five claims near Sandspit, Queen Charlotte Islands, was optioned from R. Mickle in June 1979. Ten surveys (geochemical, drilling, trenching) were completed between September 1979, and January 1981, most of which were conducted by different FNM personnel for assessment purposes. A Mineral Exploration Incentive Program contract was made with the B. C. Dept. of Mines in which a \$5000.00 grant was paid to R. Mickle and subsequently passed onto Falconbridge.

The property occurs along a major northwesterly striking lineament, Sandspit fault, in an area of numerous westerly trending subsidiary faults. The claims are underlain by the Jurassic Yakoun formation (porphyritic andesite, pyritiferous silicified tuff) which has been intruded by a Cretaceous - Tertiary non-mineralized quartz diorite pluton. Mineralization consists predominantly of scattered pyrite - bearing fault zones (gouge) and barite veinlets with minor amounts of pyrite, chalcopyrite and galena. Three grids were established (chain and compass) and soil sampled. Silt and talus samples were collected on a regional scale. No good anomalous Au, As or Hg geochemical values are present in the soil, silt or talus samples. Chip sampling of outcrops and trenches gave low gold and silver values.

The type of mineralization and low geochemical values do not appear to correspond, with that of the Cinola gold deposit which occurs forty km. northwest of the Mickle property. The only area where appreciable gold values (0.072 oz/ton over 3 metres) were obtained are from a fault zone on Baxter Creek, a salmon spawning creek located in an ecological sensitive area.

No further work is recommended and the property should be returned to R. Mickle under the terms of the option agreement.

TABLE OF CONTENTS

	<u>Page</u>
1. INTRODUCTION	1
1.1 Location	1
1.2 Claims	1
1.3 Metal	1
1.4 Access	1
1.5 Topography	1
1.6 History	1
2. GEOLOGY	7
2.1 Mineralization	8
3. GEOCHEMISTRY	13
3.1 Regional Survey	13
3.2 Detail Surveys	13
3.2.1 Barite Grid	13
3.2.2 Copper Grid	14
3.2.3 Gold Grid	15
3.2.4 Creek Grid	18
4. CONCLUSIONS.	19
REFERENCES	20
APPENDIX I Mineralogical Examinations	21
APPENDIX II Barite Grid, Geochemical Data	28
APPENDIX III Copper Grid, Geochemical Data	32
APPENDIX IV Trench and Drill Results	35

LIST OF FIGURES

		<u>Page</u>
Figure 1	Location map	3
Figure 2	Claim Map	4
Figure 3	Regional view of the Sandspit Fault (photo)	5
Figure 4	Baxter Creek area (photo)	6
Figure 5	Trench #1 (photo)	11
Figure 6	Trench #3 (photo)	12
Figure 7	Probability plot of As and Hg, A horizon	16
Figure 8	Probability plot of As and Hg, B horizon	17
Figure 080-81-1	Geological, Geochemical Map	Map Pocket
Figure 080-81-2	Geochemical map, Gold and Creek Grids	Map Pocket
Figure 080-80-1	Geochemical map, Snow 3 & 4 Claims . .	Map Pocket

MICKLE OPTION (P.N. 080)

1. INTRODUCTION

1.1 Location: Figure 1, 750 km. NW of Vancouver
(1 mile south of Sandspit, Queen Charlotte Islands)
NTS 103G/4W, airphoto BC 77062-10-13, 130-134
Latitude 53°12', Longitude 131°47'
UTM 311200 E 5900000 N
Skeena Mining Division.

1.2 Claims: Figure 2, Snow 1 - 20 units
Snow 2 - 20 units
Snow 3 - 12 units
Snow 4 - 20 units
Snow 5 - 20 units
} Snow Group
92 units

Assessment Reports:

- Prospecting Report on the QCBM Claim Group (Snow #1 & #2) Dec. 27/79, R. E. Mickle.
- Assessment Report on the QCSZ Claim Group (Snow #3 & #4), Jan. 31/80, S. Zastavnikovich
- Geochemical Report on the Snow #5 Claim, Feb. 15/80, P. Burns, I. Elliott.
- Geochemical Report, Feb./81, B. W. Downing

1.3 Metals: Au, minor Ag

1.4 Access: gravel road from Sandspit

1.5 Topography:

The property occurs along the Sandspit fault scarp with an elevation range of 15 to 300 metres. Most of the area consists of tag alders, salal bush and immature forest growth which makes traversing very difficult, Figures 3 and 4. Outcrops are scattered and occur along major creeks and the fault scarp.

1.6 History: An option was made with R. E. Mickle on his Snow 1-5 claims which were staked in 1979. The claims were transferred to Falconbridge by a Bill of Sale on Sept. 5, 1979. A Mineral Exploration Incentive program (MEIP) contract was made with the B. C. Dept. of Mines in which a grant of \$5000.00 was paid to Mickle who in turn sent it to Falconbridge. A report written by P. Burns was submitted in February for the grant. Essentially, it is a grant not to exceed one third of the exploration expenses for which work is done on a new property. Falconbridge received \$5000.00 for \$20,000.00 worth of work.

- Sept. 18-29, 1979 - Soil geochemical survey by S. Zastavnikovich on the Barite Grid.
- Dec. 13-17, 1979 - soil geochemical survey by P. Burns on the Copper Grid.
- Feb. 5-6, 1980 - Examination and sampling by J. McDougall and J. Hugi.
- Feb. 14-17, 1980 - Trenching of showing on the Gold Grid by J. Hugi and K. H. Christensen.
- Feb. 18-22, 1980 - Examination and sampling of trenches by P. Burns and L. Tihor.
- Feb. 23-28, 1980 - Packsack drilling, 3 holes, by K. H. Christensen and R. Gibson.
- Feb. 28, 1980 - logging core, P. Burns.
- April 28- May 2, 1980 - Soil geochemical survey by S. Zastavnikovich on the Gold Grid.
- Oct. 7-17, 1980 - Soil geochemical survey and trenching on the Gold Grid extension and Creek Grid, chip sampling of showing on the Barite Grid, regional mapping and prospecting in the Baxter Creek area, B. Downing, K. Christensen, A. McArthur, (property visit by I. Elliott Oct. 7-8).
- Jan 7-15, 1981 - Trenching using a backhoe on the Gold Grid; chip sampling of the trenches; B. Downing, K. Christensen (trench examination by J. J. McDougall, January 13).

The northern part of the property covers the 13 Airport claims and airport grid which were staked and mapped in 1969. The claims were located to cover a few anomalous copper and molybdenum silt samples. The property was subsequently dropped in 1971.

This report is a compilation of the various assessment reports by P. Burns, I. Elliott and S. Zastavnikovich together with work done by the author.

No geophysics was done on the property.

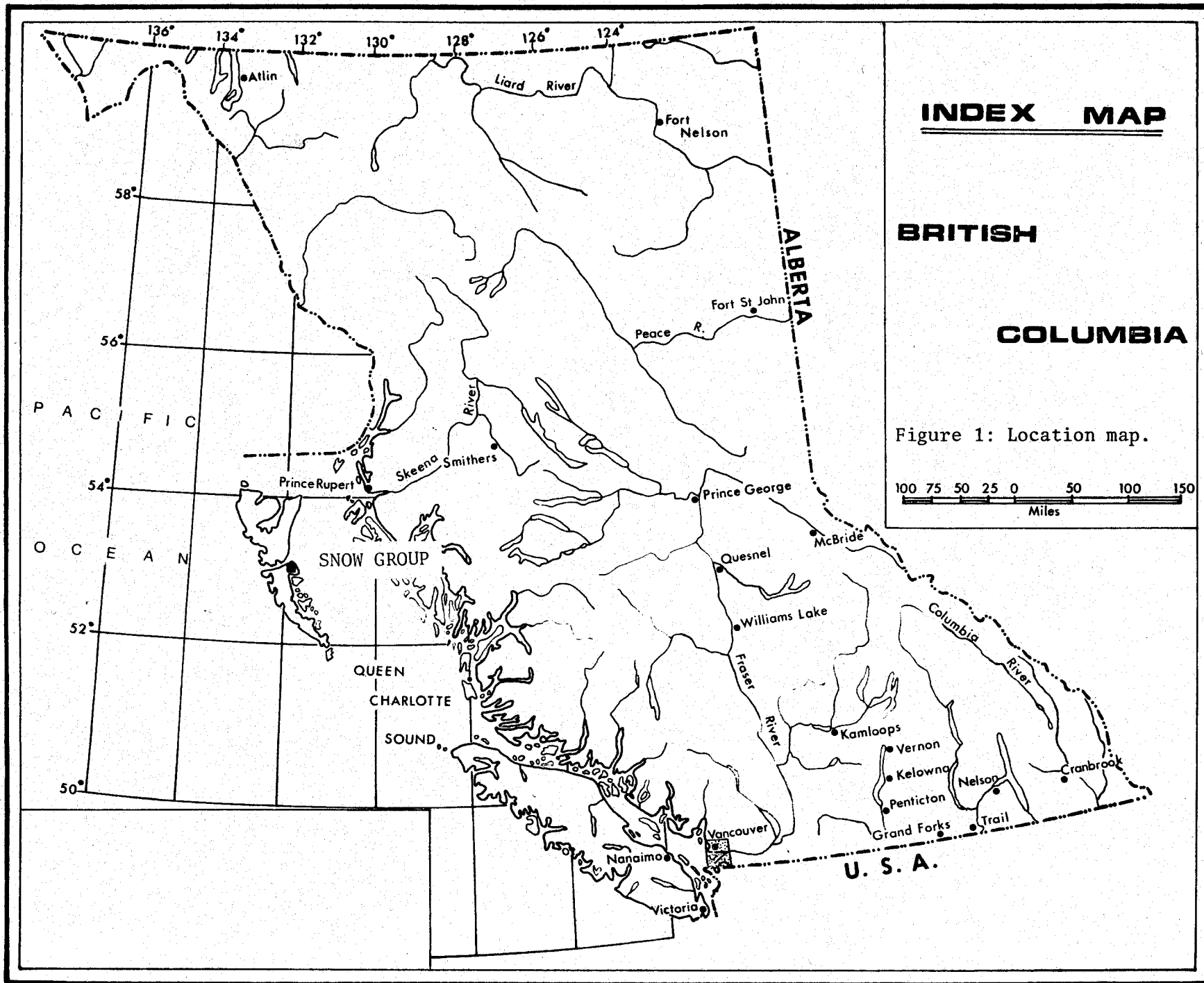

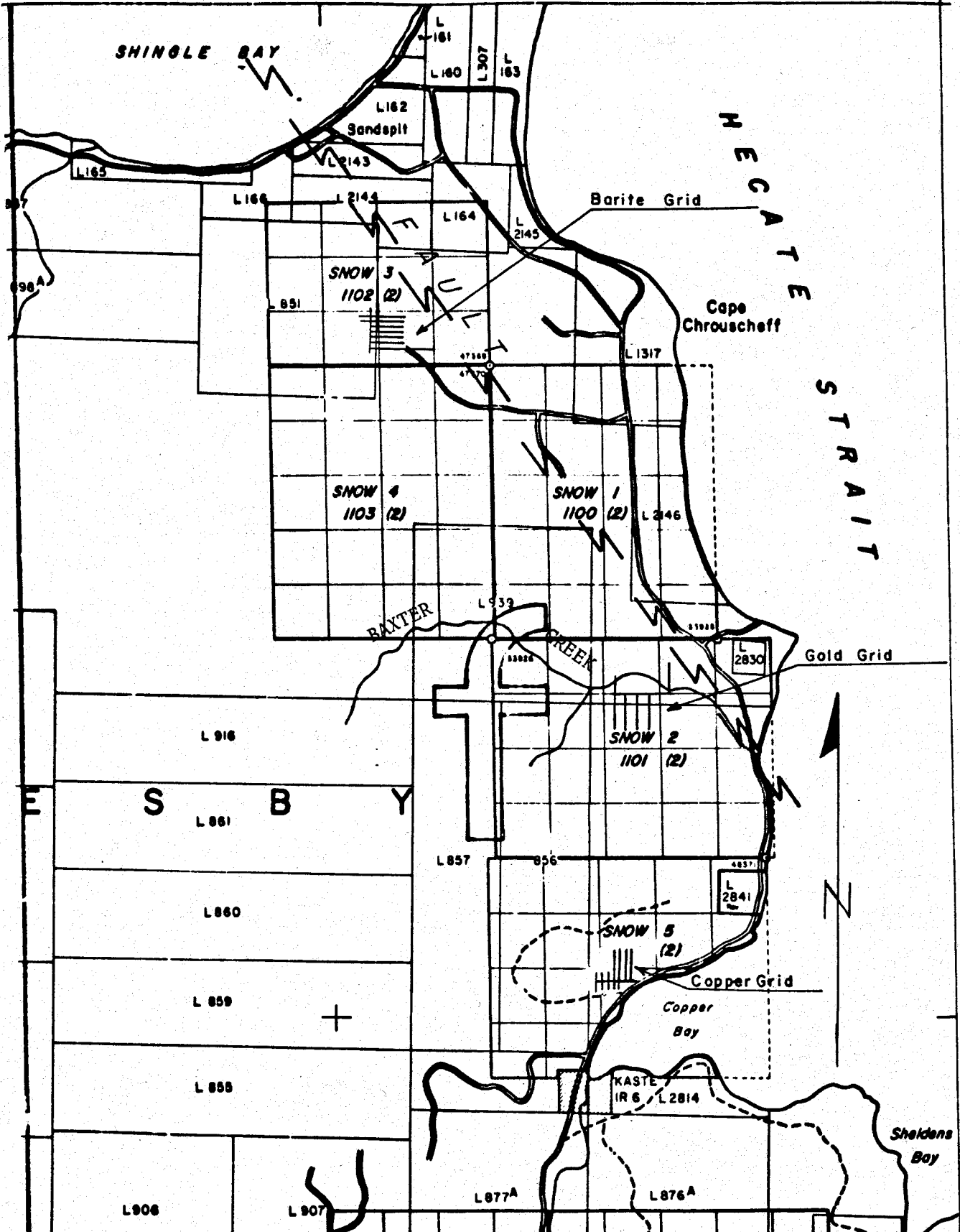

SCALE: 1:50-000

FALCONBRIDGE NICKEL MINES LTD.

MICKLE GOLD Q.C.I

CLAIM LOCATION

N.T.S NO.:103-G-4 : Figure 2:Claim map.

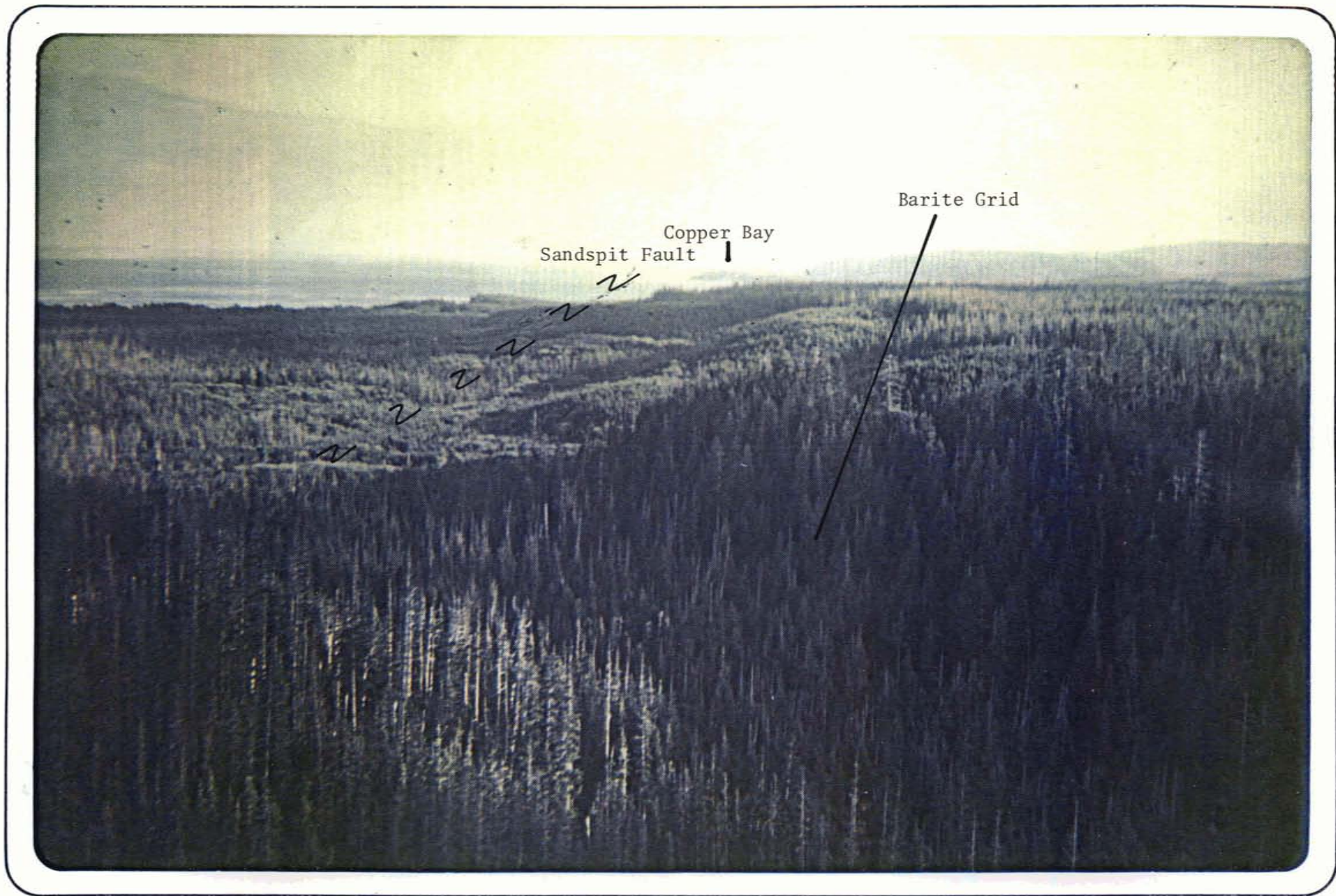

Figure 3: Sandspit Fault (scarp)



Figure 4: Baxter Creek, Gold Grid.

2. GEOLOGY

No regional or detail mapping was apparently done on and around the Airport claims, as there is no geological map in any report.

The Barite and Copper Grids were not mapped at the time of the geochemical surveys.

The Queen Charlotte Islands were mapped on a reconnaissance scale by A. Sutherland-Brown from 1958 to 1965. The area covered by the Snow claims occurs along the northwesterly trending Sandspit Fault having an approximate dip of 65° west. A number of westerly trending subsidiary faults occur throughout, the most prominent being Baxter Creek. Bedding attitudes are difficult to obtain, however, the sediments appear to strike in a northerly direction dipping $25 - 35^{\circ}$ west.

The claim area is underlain by the Yakoun formation rocks of Jurassic age. This formation consists primarily of pyroclastics, porphyritic andesite, volcanic sandstone, some conglomerate, shale, siltstone and minor amount of coal, Figure 080-81-1. A sample from Trench #1 on the Gold grid, was identified as opalized rhyolite breccia (Appendix D). This sample is from a fault zone (Baxter Creek fault) between quartz diorite and volcanics and may actually be silicified tuff or fault breccia. This unit (Yt) contains disseminated pyrite (0-5%). Non-mineralized porphyritic andesite (Ypa) appears to be the dominant volcanic unit and occurs to the west of the above (Yt) unit. A Cretaceous - Tertiary medium-grained diorite - quartz diorite known as the Sandspit pluton intrudes the Yakoun formation south of Sandspit, and appears to be faulted along its contact with the volcanics. No dykes or quartz vein network were observed in either the volcanics or intrusive.

2.1 Mineralization

Mineralization in the area consists predominantly of scattered pyritiferous fault gouge with minor amount of arsenopyrite. Scattered barite veinlets containing scattered blebs of galena, sphalerite and chalcopyrite were observed at the Barite grid. Carbonate bearing shear zones up to ten cm. wide containing minor amounts of pyrite, galena and chalcopyrite occur in the porphyritic andesite north of Copper Bay. These shear zones are exposed at low tide.

Hand trenching was done on the Barite and Gold grids in October, the results of which are shown on Figure 080-81-1. Previous trenching on the Gold grid (vicinity of Trench #1) was done in February, Table 2. Four trenches (#1-4) each approximately 10 X 1 X 3 m. were dug in January 1981 on the Gold grid using a tracked backhoe. Silicified tuff occurs in trenches 1 and 2 and quartz diorite in trenches 3 and 4. Pyrite - bearing fault zones (gouge) up to 30 cm. wide are present in all trenches. The assay results of the chip samples taken in the four trenches are shown in Table 1. Gold values are generally low (0.002 - 0.072 oz/ton) and no value over any distance (chip sampling) approached the 0.42 oz/ton from the selected sample (Table 2). The gold results from the packsack drilling are low (<0.002 oz/ton). Silver is generally negligible (0.02 oz/ton). Assays of fault gouge material from another area (#10354-55) are also low (0.002 oz/ton).

TABLE 1: ASSAYS OF TRENCH SAMPLES, GOLD GRID.

<u>Number</u>	<u>Chip Length</u> <u>(metres)</u>	<u>Description</u>	<u>Au</u> <u>oz/ton</u>	<u>As</u> <u>ppm</u>
<u>TRENCH #1 (Figure 5)</u>				
10361 (1)	3	silicified tuff	0.002	650
10362 (2)	3	fault gouge, chip sampled along strike - 080/75°N	0.072	>1000
10363 (3)	3	fault gouge, chip sampled along strike - 080/75°N	0.011	>1000
10364 (4)	3	silicified tuff	<0.002	130
10365 (5)	3	silicified tuff	<0.002	60
10366 (6)	1	chip sampled across fault zone	0.015	>1000
<u>TRENCH #2</u>				
10367	3	silicified tuff (2½ m) & fault gouge (½ m.)	<0.002	70
10368	3	silicified tuff	<0.002	50
10369	3	silicified tuff	<0.002	12
<u>TRENCH #3 (Figure 6)</u>				
10370 /1/	3	quartz diorite (2 m) & fault gouge (1 m)	0.010	>1000
10371 /2/	3	quartz diorite (2 m) & fault gouge (1 m)	0.005	>1000
10372 /3/	3	quartz diorite (2½ m) & fault gouge (½ m)	<0.002	90
10373	grab	fault gouge	0.008	>1000
<u>TRENCH #4</u>				
10374	3	quartz diorite (1 m) & fault gouge (2 m)	<0.002	110
10375	3	quartz diorite (1 m) & fault gouge (2 m)	<0.002	160
10626	3	quartz diorite (2½ m) & fault gouge (½ m)	<0.002	22
10627	grab	fault gouge	<0.002	150

() see Figure 5 for sample location

/ / see Figure 6 for sample location

TABLE 2 ASSAYS, GOLD GRID, SAMPLED BY J. J. MCDUGALL,
FEBRUARY, 1980 (Grab & selected samples)

<u>Number</u>	<u>Au(oz/ton)</u>	<u>As (ppm)</u>
13337	0.003	70
13338	<0.002	360
13339	0.003	110
13340	0.042	>1000
15243	0.42	>1000
15244	0.43	>1000
15245	0.002	55
15246	0.005	180
15247	0.003	32
15248	0.072	>1000
15249	0.034	>1000
15250	0.21 (clay)	>1000



Figure 5: Assay locations, Trench # 1, Gold grid.



Figure 6: Trench # 3, Gold grid.

3. GEOCHEMISTRY (Figure 080-81-1)

Three areas (Barite Gold and Copper Grids) were examined in detail at different times and by different people. Each area was soil sampled on a chain and compass grid. The results are written in separate reports, primarily for assessment work. A summary of the Barite and Copper Grids and a detail report on the Gold and Creek Grids are included in this final report.

All accessible creeks in the claim area were silt sampled. Talus samples were taken at the base of the cliffs located along creeks and the Sandspit road. Several outcrops were chip sampled and analyzed by assay and geochemical methods at the Bondar Clegg Laboratories, North Vancouver. The soil, silt and talus samples were analyzed for Au, As and Hg.

3.1 Regional Survey

No anomalous values of gold, arsenic and mercury are present from either of the silt sediment or talus (soil) samples (Figures 080-81-1 and 080-80-1).

Talus and assay values of a large gossan zone (pyrite-bearing silicified tuff) easily seen from the Sandspit - Copper Bay road are quite low in Au, Ag and Hg.

3.2 Detail Areas

The summaries for the Barite and Copper Grids have been taken from the respective assessment reports, except where indicated.

3.2.1 Barite Grid (S. Zastavnikovich)

The original stream sediment and soil samples collected during the prospecting stage indicated elevated base metal values in the vicinity of the barite occurrence as shown on the Map QCSZ-4 (see Appendix II for the various maps).

The followup work consisted of laying out a 400 m X 600 m 'QCSZ' Soil Grid in the area of interest with lines 50 metres apart and 25 m. samples intervals as shown on Map QCSZ-5. In addition , the trail leading from the coastal road was surveyed with chain and compass for location, and soil sampled at 50 m. intervals for most part as it crosses the Sandspit Fault zone at an acute angle. This detailed survey generated some 175 soil samples on the QCSZ grid and additional 35 samples along the trail. The analytical results are shown on the enclosed maps QCSZ-4 to 7, and Figure 080-80-1.

Most of the gold values in silt and soil samples are at or below the detection limit of 5 ppb., though a weak anomaly is outlined to the south of the barite occurrence.

Copper, lead, silver and particularly zinc indicate anomalous down-slope dispersion from the barite- containing outcrops, while cobalt, mercury and arsenic values suggest possible extensions of this weakly mineralized zone into the swamp below.

Five chip samples over a total of 22.4 metres were taken by B. Downing along the outcrop shown in map QCSZ-4, the results of which are show in Figure 080-81-1. Gold and silver assay values are low to background detection level. The arsenic and mercury geochemical values are also quite low with one high of 50 ppm As and 2400 ppm Hg.

3.2.2 Copper Grid (P. Burns, I. Elliott)

A soil survey grid approximately 200 m. by 400 m. was located in the centre of the claim. Soil samples were collected from the B-horizon at 25 m. intervals on 6 lines 50 m. apart.

A total of 78 soil samples were collected and sent to Bondar-Clegg in North Vancouver and analyzed for Cu, Ag, Pb, Zn, As, Sb, Hg and Au. All are indicated in ppm, excluding the latter two, which are in ppb. (Figure 080-79-3 to 5, Appendix III).

An examination of the results indicates that Cu, Pb, Zn, As and Sb are low but that Ag is locally weakly anomalous (to 0.9 ppm).

A subtle northwest trending overlapping Au and Hg anomaly, however, does occur within the claim at the north end of the soil grid. This area is densely overgrown and located on the flat top of the ridge. It is possible that this weak anomaly reflects underlying mineralization in bedrock or a fracture/fault zone possibly related to the Sandspit Fault.

3.2.3 Gold Grid (Figure 080-81-2)

A grid was established and soil sampled by S. Zastavnikovich over the trenches on Baxter Creek in April - May, 1980. The samples, analyzed only for As, were subsequently reanalyzed for Au and Hg when the grid extension was sampled in October. The A and B soil horizons were sampled where possible. Three soil pits were dug, two of which (#2 & 3) occur in anomalous As and Hg zones.

The As and Hg values for the A and B horizons are plotted separately on probability paper, Figures 7 and 8. Gold values are generally low to background level (5 ppb) though a few scattered high values are present. Arsenic approaches a normal distribution and mercury a lognormal distribution in both horizons. Both elements have a unimodal distribution in each of the A and B horizons with the following parameters estimated from Figures 7 and 8.

<u>Horizon</u>	<u>As (ppm)</u>		<u>Hg (ppm)</u>	
	<u>A</u>	<u>B</u>	<u>A</u>	<u>B</u>
σ_1 (ρ_{50} , background)	4	15	150	122
σ_2 (ρ_{84})	10(15)	96(10)	198(18)	180(23)
σ_3 (ρ_{95})	75(5)	260(7)	224(43)	228(16)

() percent of samples.

ρ percentile

σ standard deviation

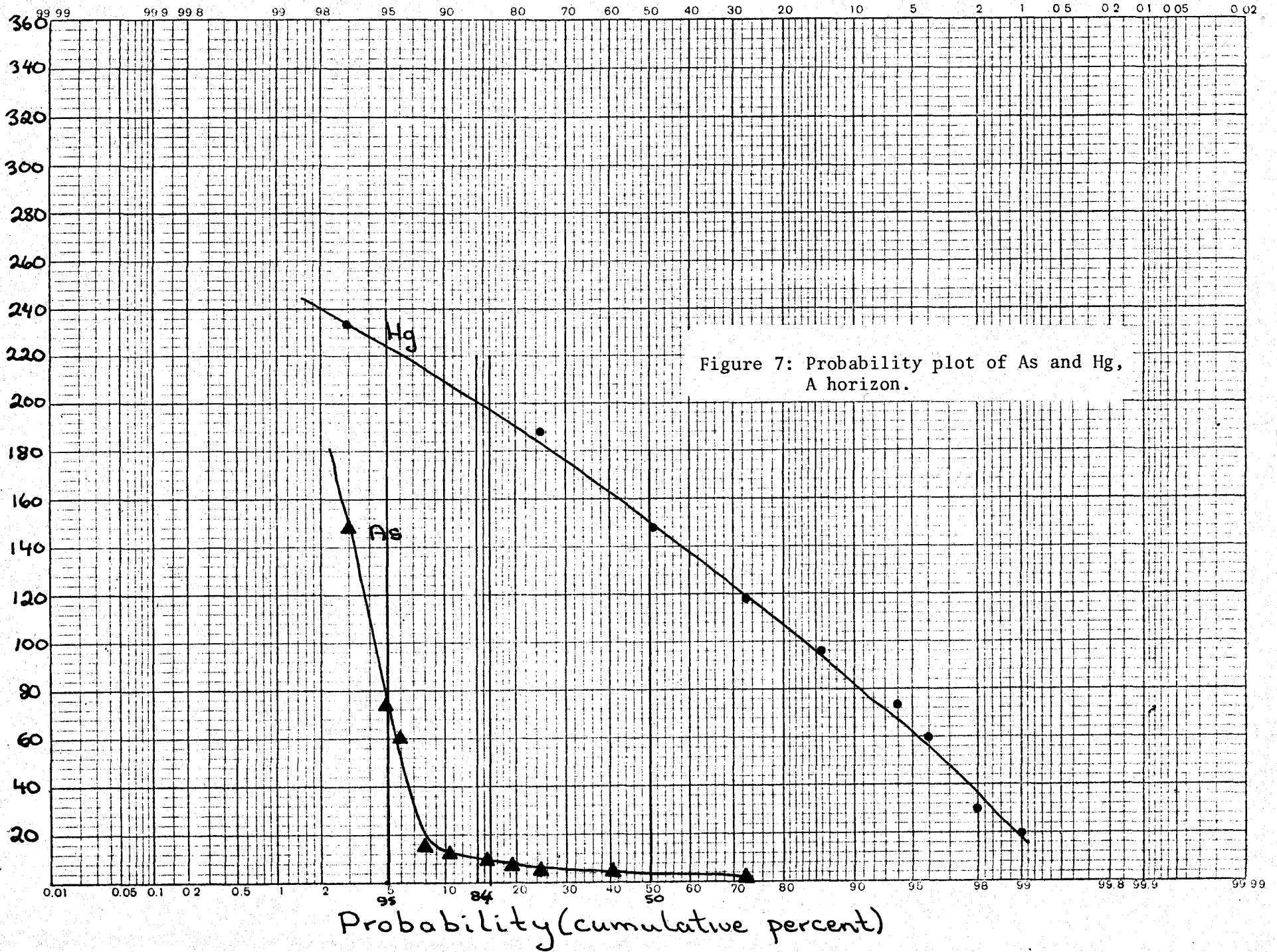

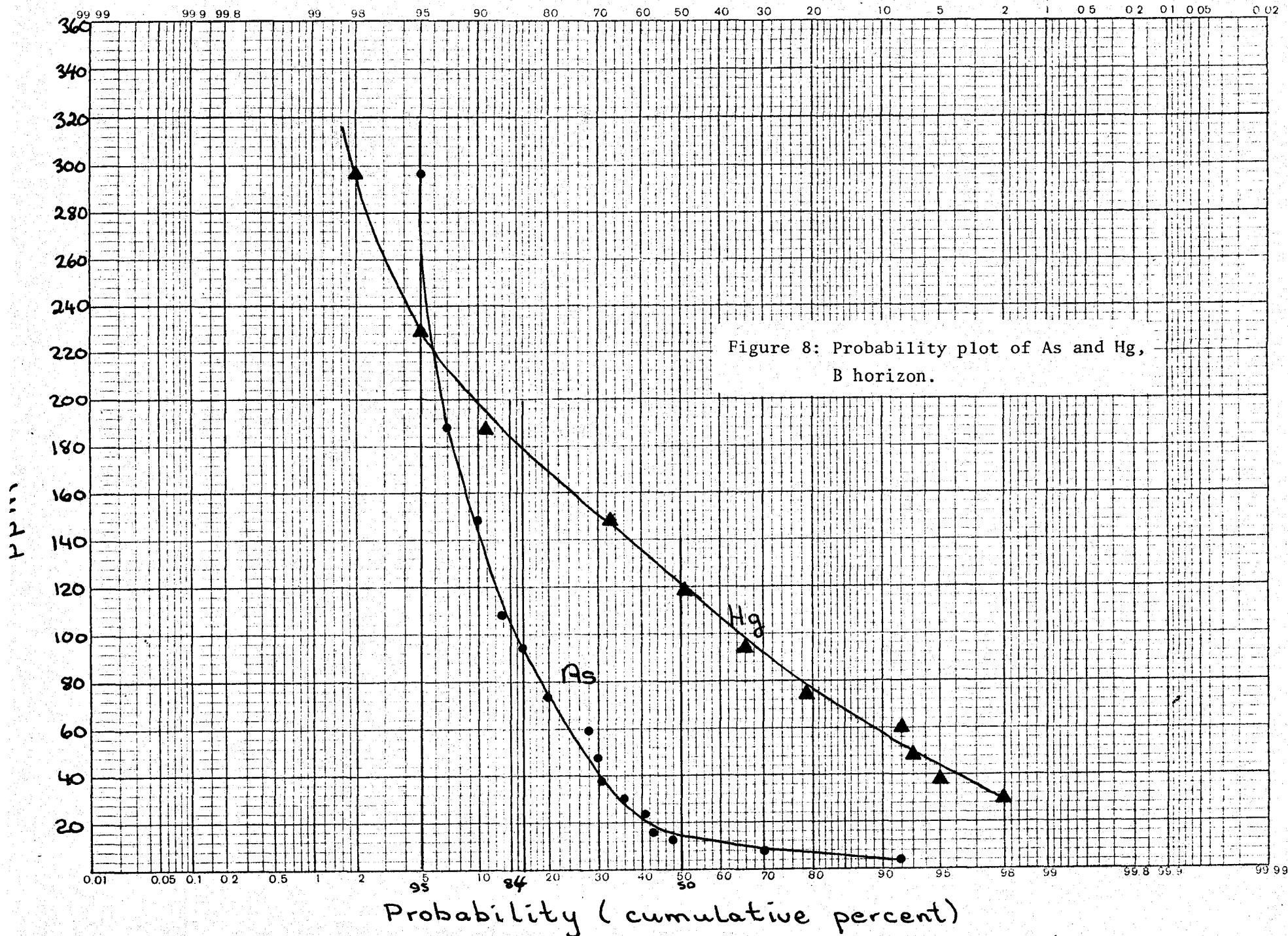

The σ_1 , σ_2 and σ_3 values for Hg are quite similar in both horizons and the As rather variable. Anomalous As and Hg values at the σ_3 level are scattered with no apparent trend. However, when the σ_2 and σ_3 level values are examined in both soil horizons together, a broad northeasterly trending As zone occurs in the middle of the grid with narrow northwesterly trending Hg zones present in the southwestern section. Soil pits 2 and 3 were dug over coincidental anomalous As and Hg zones, with the latter pit being directly over trench #1. Generally, Au, As and Hg tend to be concentrated in the A horizon and decrease with depth though the odd high value may occur throughout the profile.

Four trenches (Figures 5 and 6) were dug (backhoe) and sampled to better ascertain the cause of the anomalous As and Hg values in the vicinity of soil pits 2 and 3 (see section 2.1). The trenches were subsequently filled in after the sampling and seeded with a special grass mixture.

3.2.4 Creek Grid (Figure 080-81-2)

A small grid was established and soil sampled over a pyritiferous outcrop reported by R. Mickle. No anomalous Au or As values are present and Hg is weakly anomalous in the A horizon. A chip sample over one metre of the silicified tuff outcrop returned only background values in Au and Ag (sample #10352, Figure 080-81-1).

4. CONCLUSIONS

1) No anomalous Au, As or Hg values are present in either the silt or talus samples taken throughout the claim area.

2) Chip sampling of outcrops and trenches returned low gold and silver values. Drill core assays were also very low.

3) The anomalous Au, Ag and Hg values in soil samples possibly reflect weakly mineralized fault zones.

4) The high gold value (0.4 oz/ton - float) that was reported by R. Mickle came from the vicinity of Trench #1 and is probably from the fault zone observed in the trench. This is the only area that any appreciable gold values were obtained and they are from the fault zone which trends along and possibly under Baxter Creek, an ecologically important creek due to salmon spawning grounds.

It is therefore recommended that no further work be done and that the property be returned to Mr. R. Mickle under the terms of the option agreement.

REFERENCES

- Mickle, R. E., Dec. 27, 1979, Prospecting Report on the QCBM Claim Group (Snow 1 & 2)
- Zastavnikovich, S., January 31, 1980, Assessment Report on the QCSZ Claim Group (Snow 3 & 4).
- Burns, P. J. and Elliott, I. L., February 15, 1980, Geochemical Report on the Snow #5 Claim.
- Burns, P. J., February 20, 1980, Report on Trenching and Drill Results.
- Muir, J. E., February 14, 1980, Mineralogical Examination of a Rhyolite Breccia Sample.
- Muir, J. E., March 17, 1980, Identification of Yellow Coating on a sample from the Mickle Option.
- Sutherland-Brown, A., 1968, Geology of the Queen Charlotte Islands, Bull. 54, B. C. Dept. Energy, Mines and Petroleum Resources.
- Downing, B. W., February, 1981, Geochemical Report, Snow Group (Assessment Report).

APPENDIX I

Mineralogical Examinations

FALCONBRIDGE NICKEL MINES LIMITED
METALLURGICAL LABORATORIES
THORNHILL, ONTARIO

FALCONBRIDGE METALLURGICAL LABORATORIES

Mineralogical Examination of a
Sample of Rhyolite Breccia from
the Mickle Property, Queen Charlotte
Islands, B.C.

by
J.E. Muir
February 14, 1980

KEYWORDS: Gold, Silver, Arsenic, Cinola

COPIES TO: AMC/WDH/JCC/SNC, RAB, RB/Min

PROJECT: 302

FALCONBRIDGE METALLURGICAL LABORATORIES

MINERALOGICAL REPORT #1138

TO: J.J. McDougall

PROJECT No. 302-800214
(JO#2656)

FROM: J.E. Muir

SAMPLE No. L#80-105

DATE: February 14, 1980

SUBJECT: Mineralogical Examination of a Sample of Rhyolite Breccia from the Mickle Property, Queen Charlotte Islands, B.C.

KEYWORDS: Gold, Silver, Arsenic, Cinola

DISTRIBUTION: AMC/WDH/JCC/SNC, RAB, RB/Min File

DESCRIPTION OF SAMPLE: INFORMATION REQUESTED

A sample of "opalized rhyolite breccia" from the Mickle property was received on Feb. 11th for examination. Of particular interest was the presence of any visible (i.e. microscopically) gold and how this sample compares petrographically with samples previously examined and described from the Cinola (= Babe Gold) deposit (see MR#1089, Sept. 5, 1978).

PROCEDURES:

Spectrochem. Analysis

Chemical Analysis

X.R.D.

Optical Microscopy
PTS5596

Electron Probe

RESULTS:

In pol-thin section this rhyolite breccia is observed to consist of angular fragments of fine grained rhyolite (essentially microcrystalline quartz, sericite and clay minerals) entrained within a medium to coarse grained pegmatoid-like quartz ground mass. Euhedral pyrite (\pm marcasite) and arsenopyrite grains are abundant with chalcocite/covellite and tetrahedrite found only rarely. Sulphides/arsenides are particularly, but not exclusively, concentrated within the rhyolite fragments. Although not identical to rhyolite breccia samples previously examined from the Cinola property, this sample is however, somewhat comparable to the sample from Cinola's DDH 78-3 @ 384'. The most striking difference being,

of course, the presence of considerable arsenopyrite in the Mickle sample. A careful microscopic examination of the pol-thin section failed to reveal any discreet Au-bearing minerals. A qualitative spectrographic analysis (see Table I attached) indicates the presence of significant As, Ag and perhaps Mo contents.

JEM:dek
Attch.

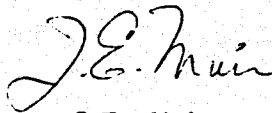

J.E. Muir

FALCONBRIDGE METALLURGICAL LABORATORIES

QUALITATIVE SPECTROGRAPHIC ANALYSIS

DISTRIBUTION: _____ REPORT No. _____

ANALYTICAL METHOD: _____

REQUESTED BY: _____ DATE: Feb. 12/80

RECEIVED FROM: _____ CHARGE: JO#2656

SAMPLE No.: L#80-105 No. of SAMPLES: 1

SAMPLE DESCRIPTION: Mickle Property, B.C.

10	- 100%	Si
3	- 30%	
1	- 10%	Fe, Al
0.3	- 3%	Mg
0.1	- 1%	Ti
0.03	- 0.3%	Co, As
0.01	- 0.1%	Ca, Cr, Ni
0.003	- 0.03%	V, Mo
0.001	- 0.01%	Mn, Cu
0.0003	- 0.003%	
0.0001	- 0.001%	Ba, Ag
< 0.0003%		
I		K, Sr, Zr
S		

I = Interference prevents positive identification.

S = Strong spectral lines, unable to estimate amount.

Unless specified above, the following were not detected at the approx. ppm
lower limits of 0.5 Cu, Ag; 1 Mn; 5 Mg, Cr; 10 Ba, Be, Bi, Ca, Co, Ni, V;
25 Ge, Fe, Pb, Mo, Si, Sr, Sn, Ti, Zr, Tl, Pd; 50 Al, Sb, B, Cd, Ga, In, Li, Zn;
100 As, Au, Na; 200 Rh, Re, Ir, Pt, Ru, Sc; 300 Te, Os; 1000 K, U, Th; 2000 P.

1112 West Pender, Vancouver, B.C.

INTER-OFFICE MEMORANDUM

DATE: February 25, 1980

TO: Ted Muir

COPIES TO:

FROM: Pat Burns

SUBJECT:

Enclosed please find rock fragments coated with yellow oxide mineral.

Jim and I are involved in a feud as to its identification. He calls it Arsenic trioxide; I believe it's sulphur. Please identify.

Also, please check yellow oxide for Au, As content.

The sample is from Bob Mickle's Gold option, P.N. 080, Queen Charlotte Islands.

Yours sincerely,

Pat Burns

PB:ik

FALCONBRIDGE NICKEL MINES LIMITED

APR 3 1980

INTER OFFICE MEMORANDUM

MEMO TO: J.J. McDougall/Pat Burns
 FROM: J.E. Muir
 DATE: March 17, 1980
 SUBJECT: Identification of Yellow Coating on a Sample from the Mickle Option, Queen Charlotte Islands, B.C.
 KEYWORDS: Arsenic, Gold
 COPIES TO: RAB, RB/Min File

PROJECT No. 302-800312
 (JO#2669)
 SAMPLE No. L# 80-157

Attached please find the results of a qualitative spectrographic analysis on the yellowish coating scraped from the hand sample. Of particular interest is the As content at 30-300 ppm. Sulphur may also be present but is not detectible by our spectrographic technique. An XRD chart run on the scrapings suggests that the material is amorphous. A gold assay was not done as requested due to insufficient coating material for analysis. No further work will be done on the sample unless requested.

J.E. Muir
 J.E. Muir

JEM:dek

cc
 → PB

Did not burn nor have any of the Xstal habit so common with native sulphur.

There is ample arsenopyrite as originally suggested to account for this yellow coating if no V or Cd present.

FALCONBRIDGE METALLURGICAL LABORATORIES
QUALITATIVE SPECTROGRAPHIC ANALYSIS

DISTRIBUTION: _____ REPORT No. _____

ANALYTICAL METHOD: _____

REQUESTED BY: _____ DATE: March 4/80

RECEIVED FROM: _____ CHARGE: JO#2669

SAMPLE No.: L#80-157 No. of SAMPLES: 1

SAMPLE DESCRIPTION: Yellowish coating scraped from hand sample -
Mickle Property, Q.C.I.

10	- 100%	Si
3	- 30%	
1	- 10%	Al
0.3	- 3%	Mg
0.1	- 1%	Fe, Ti
0.03	- 0.3%	Ni, As
0.01	- 0.1%	Ca
0.003	- 0.03%	
0.001	- 0.01%	Cu, V
0.0003	- 0.003%	Mn, Pb, Co
0.0001	- 0.001%	Ba
< 0.0003%		Cr
I		K, Sr, Sb
S		

I = Interference prevents positive identification.

S = Strong spectral lines, unable to estimate amount.

Unless specified above, the following were not detected at the approx. ppm
lower limits of 0.5 Cu, Ag; 1 Mn; 5 Mg, Cr; 10 Ba, Be, Bi, Ca, Co, Ni, V;
25 Ge, Fe, Pb, Mo, Si, Sr, Sn, Ti, Zr, Tl, Pd; 50 Al, Sb, B, Cd, Ga, In, Li, Zn;
100 As, Au, Na; 200 Rh, Re, Ir, Pt, Ru, Sc; 300 Te, Os; 1000 K, U, Th; 2000 P.

APPENDIX II

Barite Grid, Geochemical Data

(NO)	CU	PB	ZN	AG	CD	CO	AS	HG
SZ1	20	5	52	0.2	0.2	22	22	68
SZ2	22	5	57	0.2	0.2	26	24	75
SZ3	24	6	70	0.2	0.2	18	27	45
SZ4	30	6	74	0.2	0.2	32	36	60
SZ5	29	5	74	0.2	0.2	18	23	65

-28-
X(RM102)

CU	PB	ZN	AG	AU
95	29	67	2.0	20
65	31	42	2.0	30
14	24	79	0.7	10
93	38	59	2.8	28
50	31	50	2.0	20
62	33	42	2.1	10
111	34	57	2.8	25
31	30	79	2.1	20
172	62	142	2.3	25
78	35	51	2.9	25
36	31	92	2.1	20
82	51	79	1.5	25
118	88	60	3.2	30
65	45	92	1.5	25
68	38	42	2.7	15
68	41	176	1.7	15
75	36	58	2.6	20

10621
10620
10619
10618

(NO)	CU	PB	ZN	AG	AU	AS	HG
RM21					15	4	68
RM22					30	2	82
RM23					5	1	76
RM24					5		97
RM66	58	32	58	1.8	5		
RM67	56	35	50	2.1	15		
RM68	382	100	735	3.1	35		
RM69	125	55	283	3.3	35		
RM79	29	25	140	1.7	15		
RM80	34	30	73	1.9	15		
RM81	29	24	69	1.3	15		
RM82	48	24	87	1.5	10		
RM83	68	31	45	2.1	15		
RM84	66	36	66	1.9	15		

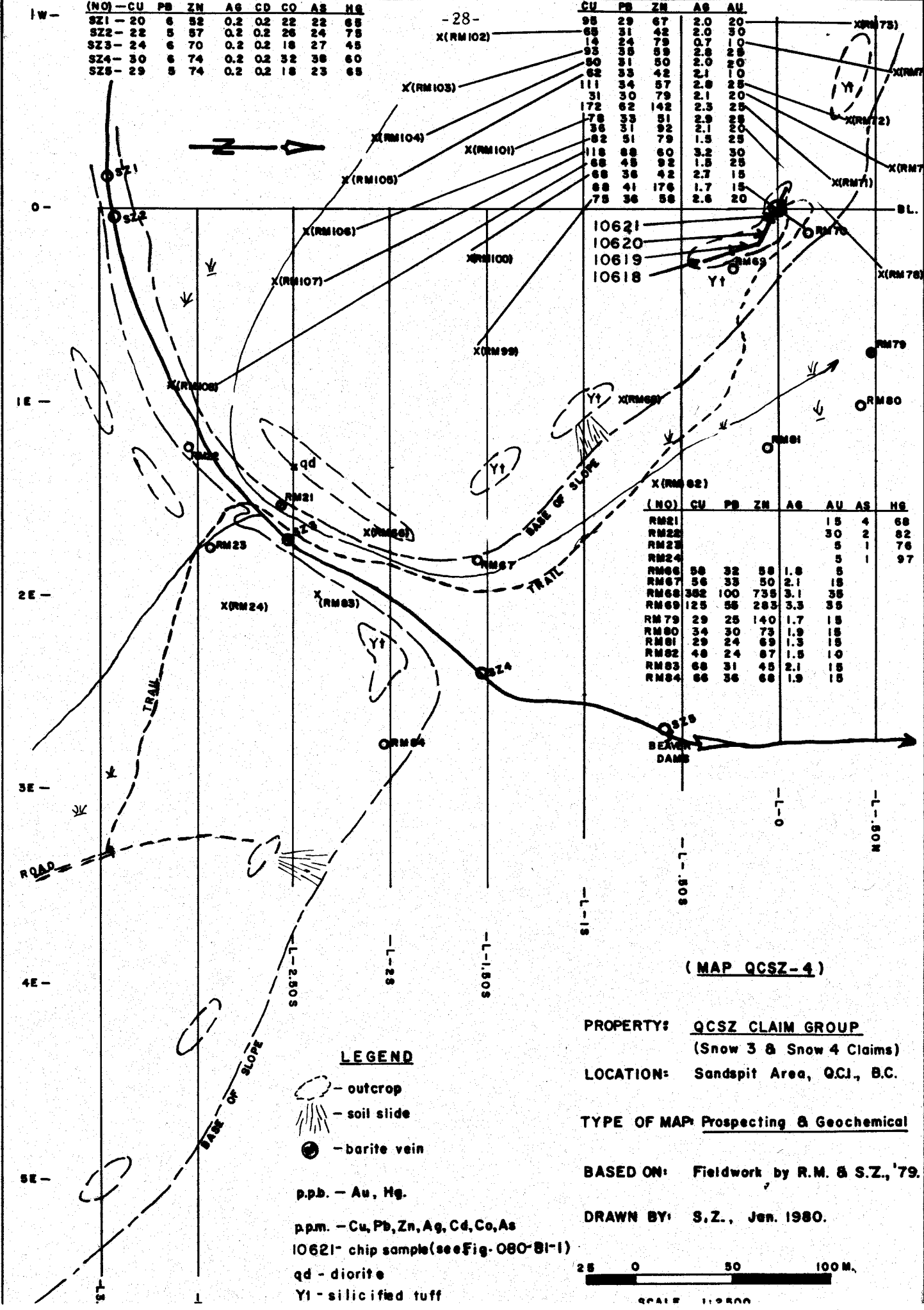

(MAP QCSZ-4)

PROPERTY: QCSZ CLAIM GROUP
(Snow 3 & Snow 4 Claims)
LOCATION: Sandspit Area, Q.C.J., B.C.
TYPE OF MAP: Prospecting & Geochemical
BASED ON: Fieldwork by R.M. & S.Z., '79.
DRAWN BY: S.Z., Jan. 1980.

LEGEND

- outcrop
- soil slide
- barite vein
- p.p.b. - Au, Hg.
- p.p.m. - Cu, Pb, Zn, Ag, Cd, Co, As
- 10621- chip sample (see Fig. 080-B1-1)
- qd - diorite
- Y1 - silicified tuff

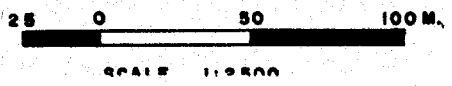

34 0 6	70 0 7	91 0 8
80 0 2	65 0 2	58 0 2
36 0 9	57 0 6	83 0 42
33 0 2	54 0 2	76 0 4
51 0 7	44 0 69	48 0 8
30 0 2	59 0 6	39 0 2
28 0 5	72 0 25	29 0 8
16 0 2	53 0 3	28 0 3
		14 0 5
		9 0 2



42 0 6 48 0 4	71 0 5 47 0 7	130 0 17 58 0 8	95 0 10 67 0 2	47 0 7 78 0 2	35 0 5 30 0 4	41 0 8 29 0 3	81 0 19 110 0 2	84 0 8 700 0 2
100 0 8 90 0 3	39 0 6 59 0 2	39 0 6 79 0 2	36 0 2 17 0 2	36 0 8 68 0 2	47 0 8 58 0 4	21 0 8 20 0 6	316 0 240 1670 0 11	33 0 18 1970 0 2
93 0 12 84 0 3	23 0 6 88 0 2	25 0 4 30 0 2	15 0 4 16 0 2	37 0 8 42 0 2	153 0 120 311 0 3	81 0 30 133 0 11	49 0 9 238 0 2	20 0 7 224 0 2
65 0 7 88 0 3	28 0 8 82 0 2	21 0 4 23 0 2	19 0 7 17 0 2	31 0 17 43 0 8	293 0 82 1010 0 2	110 0 28 252 0 7	30 0 5 142 0 2	24 0 7 136 0 2
60 0 6 76 0 2	107 0 9 97 0 2	24 0 4 32 0 4	12 0 3 10 0 2	36 0 8 48 0 2	54 0 10 176 0 2	27 0 6 234 0 2	24 0 6 75 0 2	19 0 6 115 0 2
52 0 6 42 0 2	31 0 6 36 0 2	32 0 6 48 0 2	11 0 2 12 0 2	60 0 50 133 0 8	21 0 5 28 0 2	20 0 3 71 0 2	25 0 6 49 0 2	43 0 10 109 0 2
23 0 6 26 0 2	59 0 6 36 0 2	40 0 6 58 0 2	84 0 10 57 0 2	42 0 13 52 0 2	25 0 6 60 0 2	29 0 4 57 0 2	31 0 4 65 0 2	20 0 4 66 0 2
19 0 6 59 0 2	49 0 5 30 0 2	64 0 8 62 0 2	66 0 7 61 0 2	94 0 7 57 0 2	33 0 6 63 0 2	31 0 5 60 0 2	25 0 6 49 0 2	13 0 4 47 0 2
83 0 8 54 0 2	37 0 4 56 0 2	65 0 23 67 0 2	96 0 6 56 0 2	28 0 5 47 0 2	47 0 4 72 0 2	24 0 6 52 0 2	28 0 4 61 0 2	24 0 4 49 0 2
168 0 13 65 0 2	17 0 7 15 0 4	33 0 6 32 0 2	42 0 6 29 0 2	27 0 4 53 0 2	24 0 4 58 0 2	24 0 5 41 0 2	21 0 4 60 0 2	16 0 3 48 0 2
55 0 8 56 0 2	45 0 6 53 0 2	9 0 5 11 0 4	36 0 8 45 0 2	22 0 5 57 0 2	23 0 4 49 0 2	23 0 4 61 0 2	20 0 4 51 0 2	29 0 4 58 0 2
14 0 10 10 0 2	46 0 4 47 0 2	55 0 4 41 0 5	67 0 13 62 0 2	29 0 5 56 0 2	26 0 4 57 0 2	28 0 5 56 0 2	17 0 4 51 0 2	24 0 4 59 0 2
14 0 6 3 0 2	39 0 7 29 0 2	75 0 4 56 0 2	46 0 10 49 0 2	36 0 4 73 0 2	27 0 6 53 0 2	19 0 4 32 0 2		
63 0 10 38 0 2	29 0 3 29 0 2	129 0 6 60 0 2	27 0 6 62 0 2	25 0 5 48 0 2	26 0 5 60 0 2			
32 0 7 18 0 2	24 0 5 23 0 2	98 0 21 96 0 2	30 0 6 74 0 2	31 0 6 60 0 2				
14 0 3 5 0 2	25 0 8 19 0 2							

QCSZ SOIL GRID

LEGEND

Cu ppm Pb ppm
 Zn ppm Ag ppm/10

(MAP QCSZ - 6)

40 0 6 25 0 2	46 0 5 32 0 2
30 0 5 19 0 2	37 0 6 36 0 2
27 0 6 22 0 2	98 0 7 50 0 2
56 0 6 58 0 2	25 0 7 30 0 2
28 0 5 34 0 2	25 0 7 34 0 2
78 0 8 64 0 2	29 0 6 53 0 2
16 0 2 7 0 2	24 0 7 34 0 2



2 0 8 14 245	2 0 4 23 250	2 0 4 19 460	2 0 8 21 460	2 0 8 23 110	2 0 4 13 270	2 0 4 12 135	2 0 28 13 345	2 0 18 11 320
2 0 16 17 245	4 0 8 13 105	2 0 2 12 140	2 0 4 7 75	2 0 8 21 180	2 0 8 18 525	2 0 4 11 360	40 0 82 21 460	160 0 68 58 170
2 0 20 15 215	2 0 24 10 45	2 0 4 18 375	2 0 2 11 95	2 0 4 13 170	12 0 28 20 700	6 0 14 15 1250	66 0 72 17 185	8 0 62 11 95
2 0 26 14 125	2 0 8 2 20	2 0 2 10 280	2 0 2 11 100	2 0 4 16 255	26 0 38 18 1750	2 0 16 14 450	2 0 14 14 80	2 0 36 9 430
2 0 6 16 230	2 0 28 19 105	2 0 4 13 190	2 0 1 8 25	2 0 6 19 190	10 0 10 12 85	6 0 6 8 95	2 0 10 13 75	2 0 8 37 75
2 0 6 8 345	2 0 6 17 220	2 0 8 14 180	2 0 2 3 20	4 0 12 16 230	2 0 2 13 85	2 0 12 20 60	2 0 14 14 120	2 0 16 24 145
2 0 4 10 325	2 0 6 11 225	2 0 10 12 165	2 0 20 18 305	2 0 6 17 315	2 0 18 20 70	2 0 16 14 110	2 0 20 23 125	2 0 14 13 75
2 0 6 9 130	2 0 6 6 185	2 0 8 12 95	2 0 10 12 160	2 0 12 12 235	2 0 10 17 80	2 0 36 16 130	2 0 30 24 85	2 0 14 21 45
2 0 12 13 120	2 0 6 11 140	2 0 8 13 180	2 0 24 13 325	2 0 6 11 95	2 0 10 16 115	2 0 8 13 110	2 0 12 13 90	2 0 8 16 90
2 0 28 16 125	2 0 2 13 125	2 0 4 12 175	2 0 1 6 370	2 0 18 13 155	2 0 8 16 180	2 0 8 13 105	2 0 10 11 85	2 0 10 7 75
2 0 12 14 275	2 0 6 18 235	2 0 1 10 50	2 0 8 12 470	2 0 20 17 60	2 0 14 22 105	2 0 14 12 70	2 0 6 5 80	2 0 10 8 90
2 0 1 16 55	2 0 6 11 210	2 0 4 13 160	2 0 10 19 250	2 0 22 18 70	2 0 14 21 110	2 0 10 16 105	2 0 6 10 70	2 0 12 14 75
2 0 1 5 35	2 0 6 12 155	2 0 10 18 205	2 0 10 17 230	2 0 24 16 100	2 0 12 13 110	2 0 4 6 210		
2 0 6 11 230	2 0 4 10 135	2 0 22 16 255	2 0 10 14 105	2 0 16 14 140	2 0 10 20 80			
2 0 1 10 180	2 0 4 11 215	2 0 18 25 300	2 0 20 19 75	2 0 22 21 145				

QCSZ SOIL GRID

LEGEND

Cd ppm Co ppm
As ppm Hg ppb

(MAP QCSZ - 7)

2 0 1 6 45	2 0 1 12 215
2 0 4 10 225	2 0 8 13 240
2 0 4 10 190	2 0 12 15 230
2 0 4 12 50	2 0 28 18 345
2 0 6 12 110	2 0 6 17 60
2 0 4 8 50	3 0 4 6 180
2 0 8 17 185	2 0 6 15 55
2 0 2 10 185	2 0 4 14 115

APPENDIX III

Copper Grid, Geochemical Data

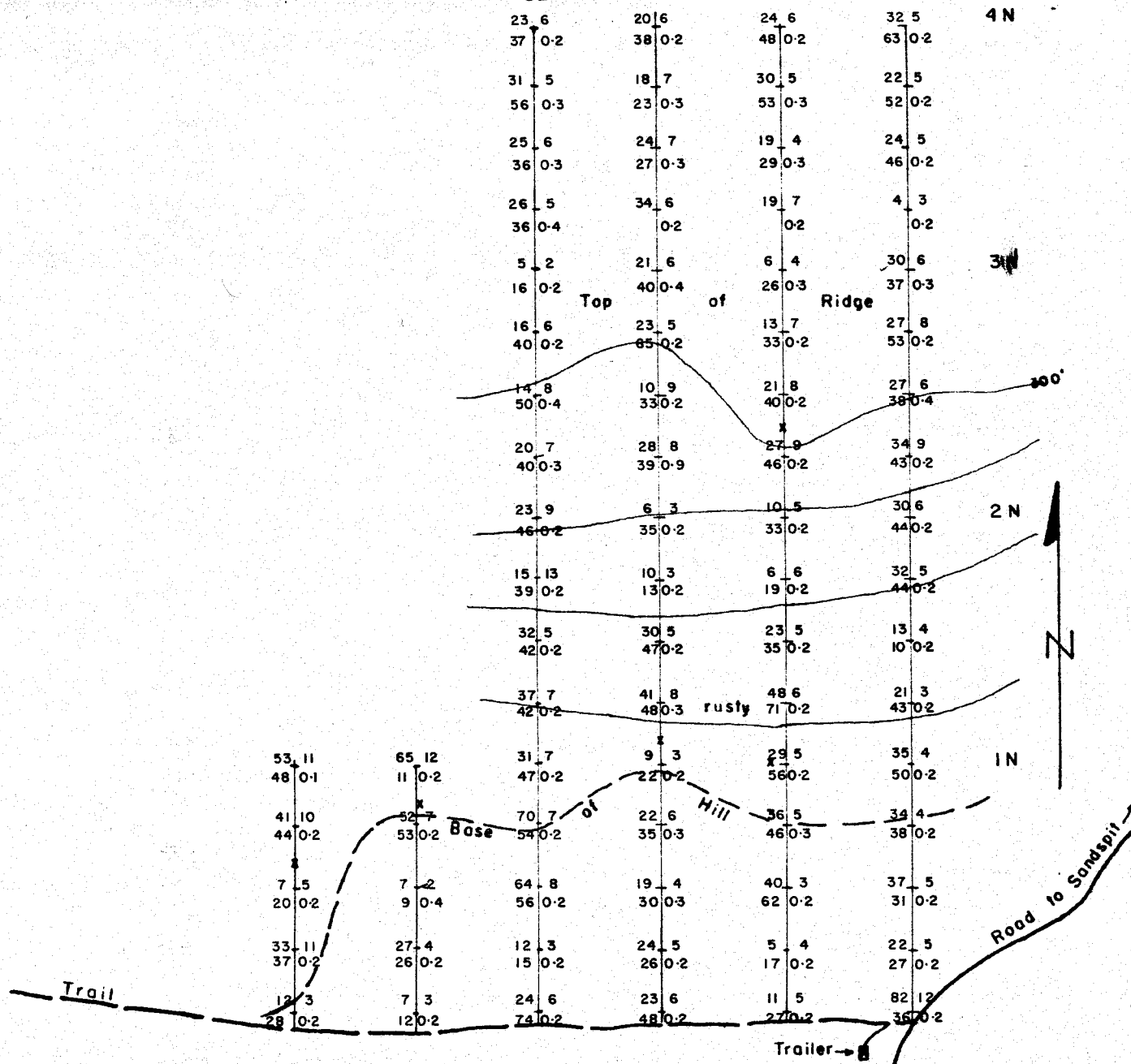

Cu | Pb Sample location & Value
 Zn | Ag in ppm.

x o/c Conglomerate

PROPERTY: Snow No. 5 Mineral Claim

LOCATION: Sandspit Area Q.C.I. B.C.

TYPE OF MAP: Geochem (Soil)

BASED ON: Fieldwork by P.B. Dec. 1979

DRAWN BY: G.T. Jan. 1980

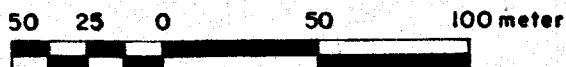

SCALE: 1:2,500

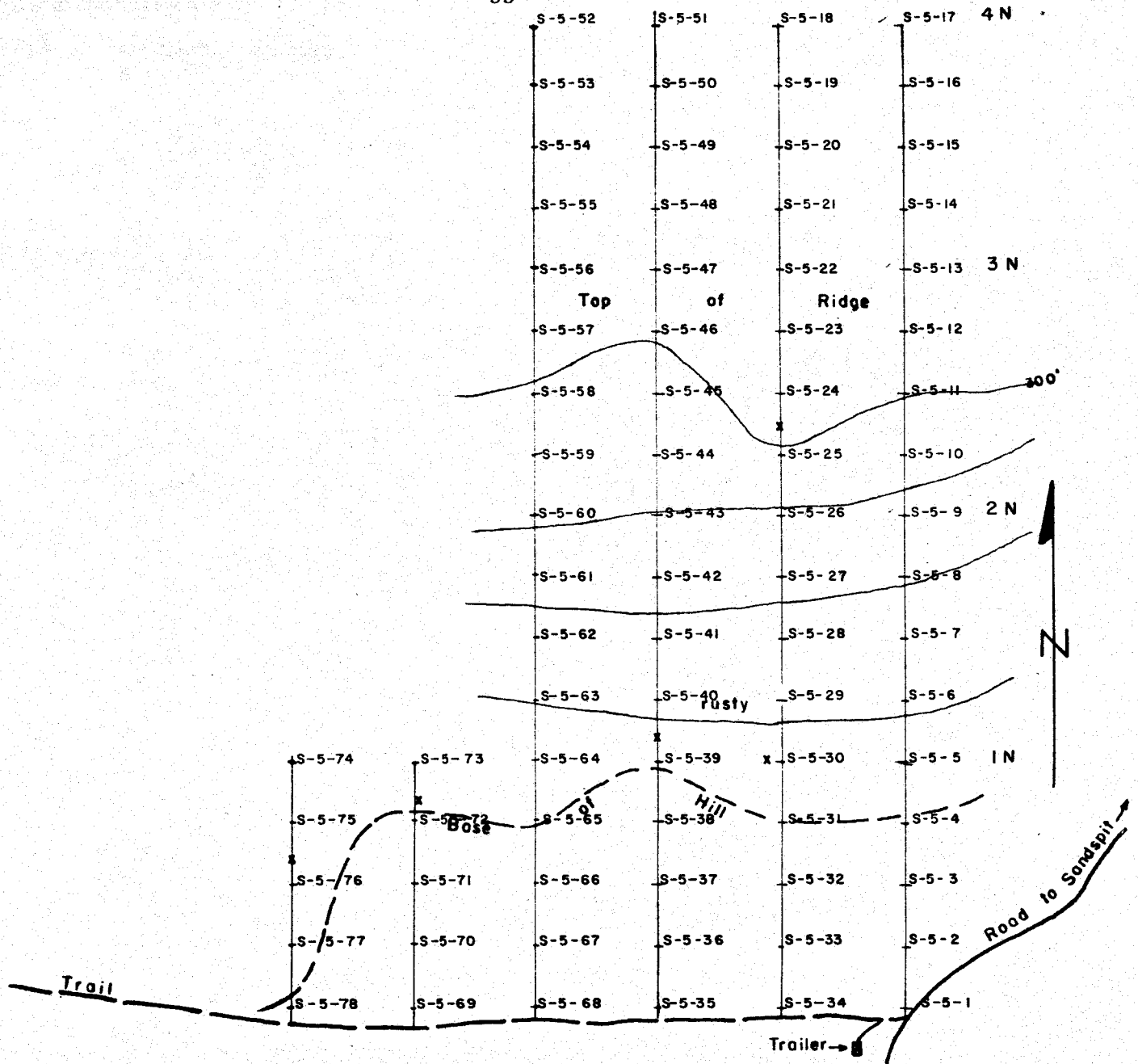

S-5-1 Sample location & No.

x o/c Conglomerate

PROPERTY: Snow No. 5 Mineral Claim

LOCATION: Sandspit Area Q.C.I. B.C.

TYPE OF MAP: Geochem (Soil)

BASED ON: Fieldwork by P.B. Dec. 1979

DRAWN BY: G.T. Jan. 1980

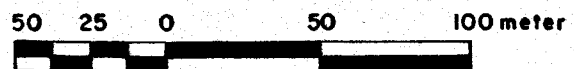

SCALE: 1:2,500

APPENDIX IV

Trench and Drill Results

GEOLOGICAL SKETCH MAP OF TRENCHES
SNOW NO.2 CLAIM
SANDSPIT AREA Q.C.I.



DDH-1 Vertical 21'
DDH-2 160°- 45°- 22'
DDH-3 160°- 45°- 11'

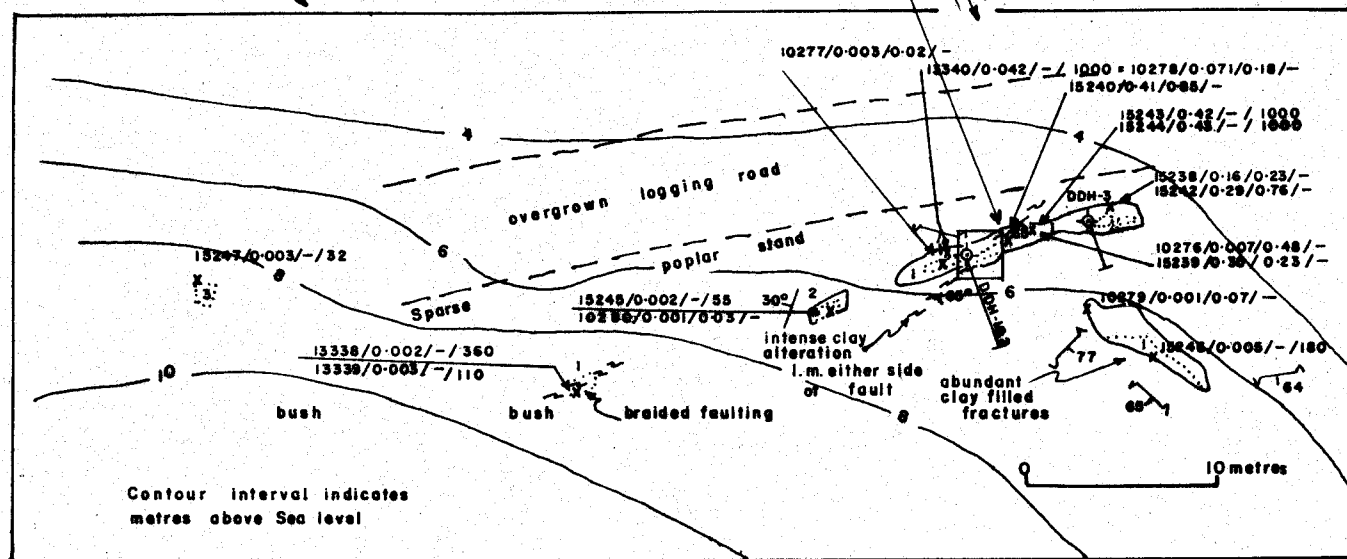
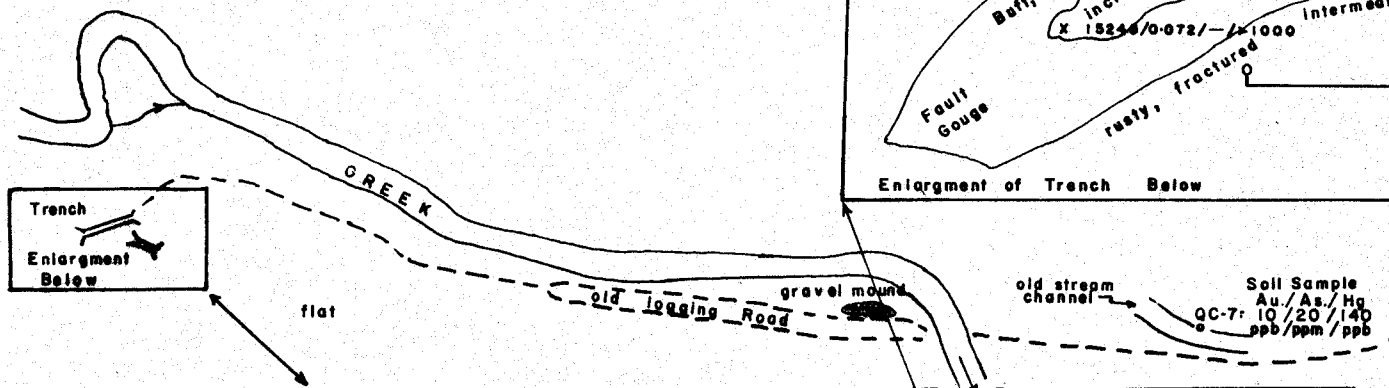
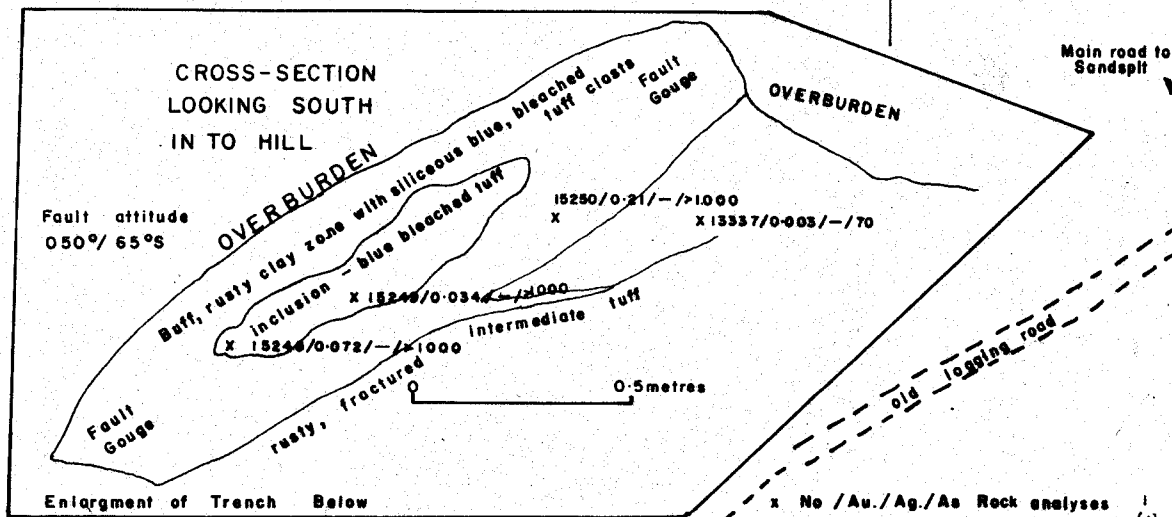

- Pack Sack D.D. Hole
 - 1 Intermediate Tuff Breccia
 - 2 Black Cherty Tuff
 - 3 Dark Grey Porphyritic Andesite
 - Trench boundaries with exposed outcrop
 - 30° Possible bedding
 - 50° Fracture strike & dip
 - 65° Fault and dip
- 0 50 metres
SCALE

Approximate

NORTH Lat 53° 11' 30" N
Long. 131° 47' 15" W STARTED 26/2/80
 COMPLETED 28/2/80
 ELEV. 5m (Approx) A.S.L. LENGTH 11' (3.4m)
 BEARING 160°
 DIP -45°

FALCONBRIDGE DIAMOND DRILL RECORD

PROPERTY
Snow Group - Q.C.I.

PURPOSE To test area of HOLE No. 80-3
Anomalous Au in soil & CLAIM Snow #2
rock. SECTION _____
 LOGGED BY P.J. Burns OFFSET _____
 PLOTTED _____

FOOTAGE	DESCRIPTION	SAMPLE	FOOTAGE	C.L.	Au	Ag		
(0-2.1m) 0 - 7'	Fault Zone. Buff Coloured Clay and Very Broken, Bleached White Intermediate Tuff. With Rusty Coloured Coatings on Fracture Surface. Trace Disseminated Pyrite					03/T		
(2.1-3.4m) 7' - 11'	15% Recovery Blue Grey Intermediate (Dacitic) Lapilli Tuff. Bleached Alteration Decreases With Depth (Away From Fault Zone). Very Broken, Traces of Disseminated Pyrite Throughout.	10336	8' (2.5m)	2" (5cm)	0.002	0.05		-30'
	45% Recovery							
11' (3.4m)	End of Hole							

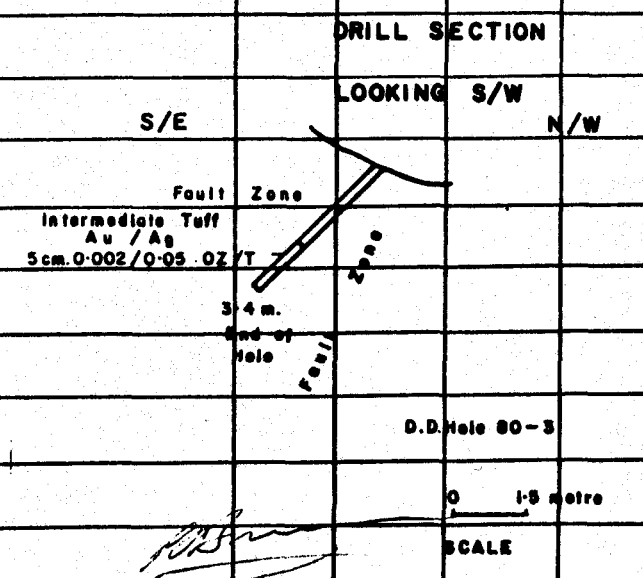

Approximate

NORTH Lat. 53° 11' 30" N
 Vest Long. 131° 47' 15" W STARTED 24/2/80
 EAST - _____ COMPLETED 26/2/80
 ELEV. 5m (Approx) A.S.L.
 BEARING 160° LENGTH 22' (6.7m)
 DIP -45°

FALCONBRIDGE DIAMOND DRILL RECORD

PROPERTY
Snow Group - Q.C.I.

PURPOSE To test area of HOLE No. 80-2
Anomalous Au in soil & CLAIM Snow #2
rock. SECTION _____
 LOGGED BY P.J. Burns OFFSET _____
 PLOTTED _____

FOOTAGE	DESCRIPTION	SAMPLE	FOOTAGE	C.L.	Au	Ag		
(0-3.7m) 0 - 10'	Fault Zone. Rusty Weathering Buff Coloured Clay and Bleached (Buff Coloured) Intermediate Lapilli Tuff				03/T			
		10334	13' (4.0m)	(5cm) 2"	<0.002	0.02		
(2.5-3.7m) 8'-10'	Very Broken, Rusty Coatings on Fractures, Trace Disseminated Pyrite	10335	20' (6.1m)	2"	<0.002	0.04		
	20% Recovery			(5cm)				
(3.7-6.7m) 10' - 22'	Altered Grey-green Intermediate (Dacitic) Lapilli Tuff. Trace Disseminated Pyrite							-37-
	12' 0" Vein @ 10° to C.A. With Quartz-Carbonate (+ Epidote?)							
	(3.8m) 12' 6" Quartz Veinlet @ 45° to C.A. 1mm Wide.			S/E			DRILL SECTION LOOKING S/W	N/W
	(4.1m) 13' 6" 2mm Wide Pyrite + Quartz Veinlet @ 45° to C.A.			Fault Zone				
	(4.6m) Bleached Grey Zone 1cm on Either Side. Same @ 15' 0"				5cm. <0.002 / 0.02 - 0Z/T			
	(4.9-6.4m) 16' - 21' Less Alteration, Trace Disseminated Pyrite				Intermediate Tuff			
	70% Recovery				5cm. <0.002 / 0.04			
(6.7m) 22'	End of Hole						End of Hole	D.D. Hole 80-2 0 1.5 metre SCALE

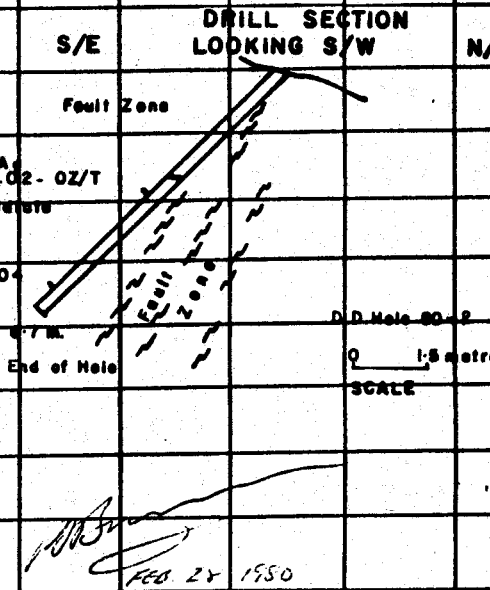

Approximate

NORTH Lat. 53° 11' 30" N STARTED 23/2/80
 East Long. 131° 47' 15" W COMPLETED 24/2/80
 ELEV. 5m (approx) A.S.L. LENGTH 21 ft. (6.4m)
 BEARING -
 DIP Vertical (90°)

FALCONBRIDGE DIAMOND DRILL RECORD

PROPERTY
Snow Group - Q.C.I.

PURPOSE To test area of MOLE No 80 - 1
Anomalous Au in soil & CLAIM Snow #2
rock. SECTION _____
 LOGGED BY P.J. Burns OFFSET _____
 PLOTTED _____

FOOTAGE	DESCRIPTION	SAMPLE	FOOTAGE	C.L.	Au	Ag		
(0-2.5m) 0-8'	Fault Zone. Rusty Weathering Buff Coloured Clay &				03/T			
	Bleached (Buff Coloured) Intermediate Lapilli	10333	21' (6.4m)	(5cm) 2"	<0.002	0.04		
	Tuff.	10332	20' (6.1m)	(5cm) 2"	<0.002	0.14		
	4% Recovery							
(2.5-6.4m) 8' - 21'	Grey-Green Intermediate (Dacitic) Lapilli							
	Tuff with Trace to 0.5% Disseminated Pyrite Grains, 1 mm or Less In Diameter.							
	8' - 12' - Very Broken; Rust-Coated Fractures; (2.5-3.7m)							
	Bleached in Part. 40% Recovery							
	(3.7-4.1m) 12' - 13'6" - Quartz-Feldspar And Unidentified							
	Pale Apple Green Mineral (Not Chlorite or Epidote)							
	in Vein @ 10° to C.A., Contains Trace Disseminated Pyrite							
	(6.1-6.4m) 20' - 21' - Very Broken, Chloritic Alteration,							
	45% Recovery							
	(2.5-6.4m) Overall Recovery For The Section From 8' to 21'							
	Approximately 75%							

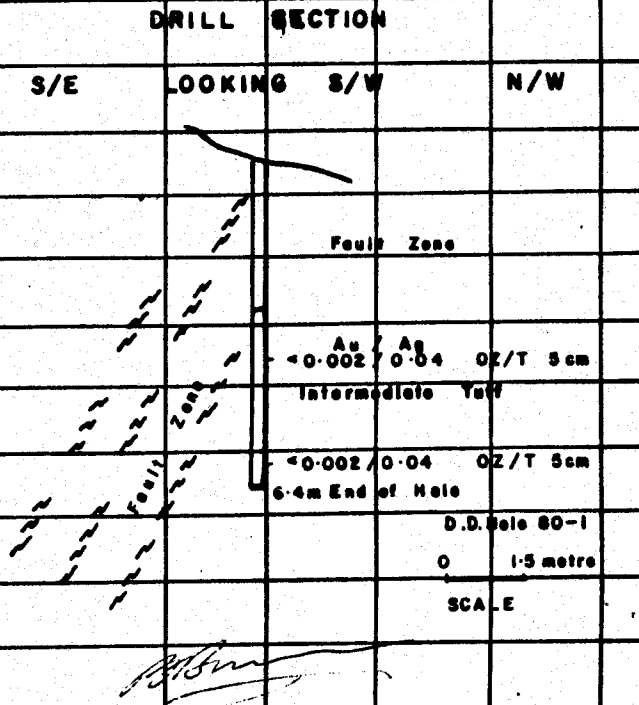

V-11. (6.4m)
21' End of Hole

1980 28 1980
HOLE No. 80-1



Repairing broken track.

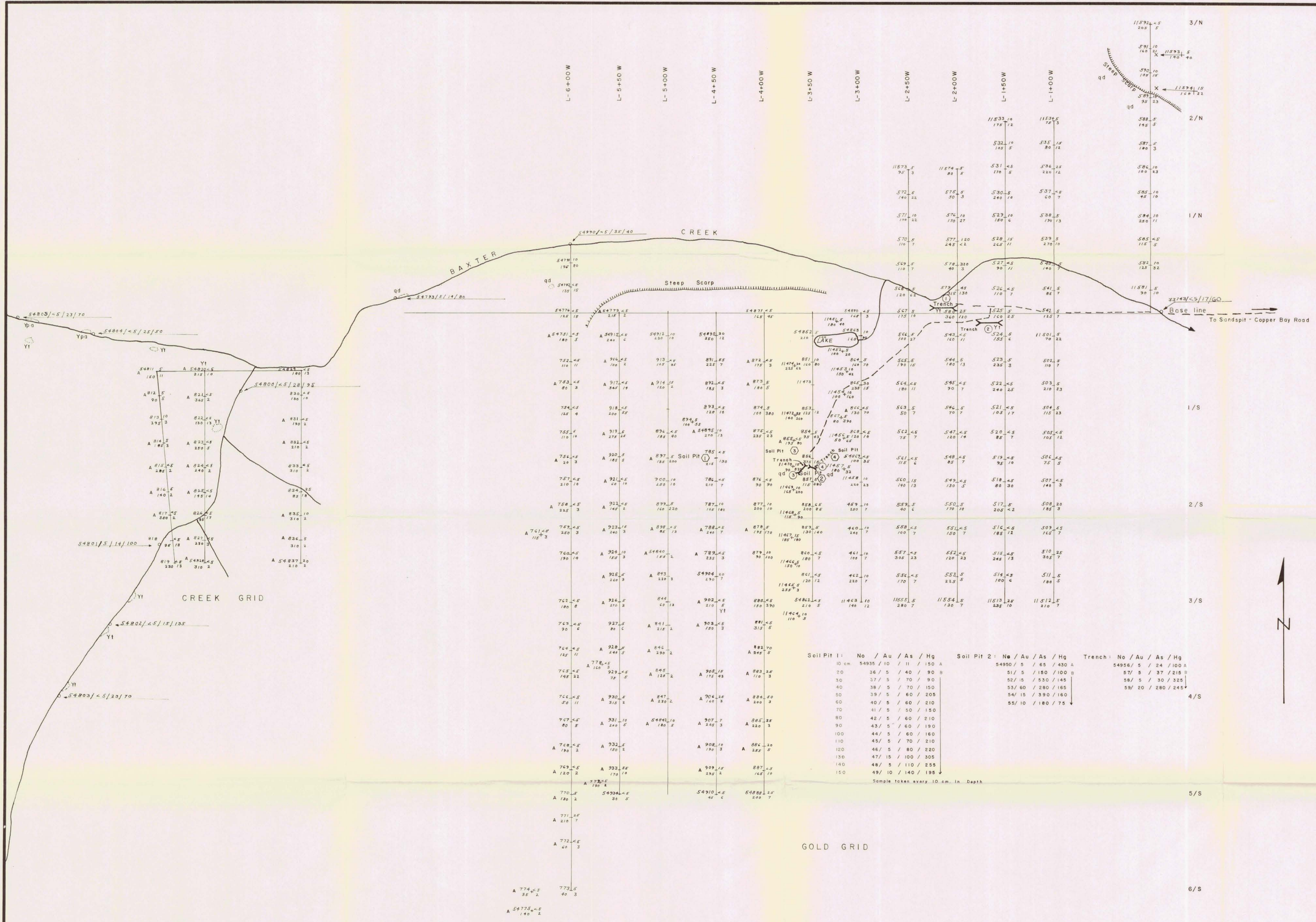

LEGEND

- No / Au / As / Hg / Soil Sample
- X No / Au / Hg / As / Rock
- No / Au / As / Hg / Silt
- A A horizon sample (all other sample from B horizon)
- Dirt road
- qd Diorite - Quartz diorite
- Y Yakoun Formation (Ypa - porphyritic andesite, Yt - silicified tuff)

Soil PH 1:	No / Au / As / Hg	Soil PH 2:	No / Au / As / Hg	Trench:	No / Au / As / Hg
10 cm	54935 / 10 / 11 / 150 A	54950 / 5 / 65 / 430 A	54956 / 5 / 24 / 100 A	54956 / 5 / 24 / 100 A	54956 / 5 / 24 / 100 A
20	36 / 5 / 40 / 90 B	51 / 5 / 150 / 100 B	57 / 5 / 37 / 215 B	57 / 5 / 37 / 215 B	57 / 5 / 37 / 215 B
30	37 / 5 / 70 / 90	52 / 5 / 530 / 145	58 / 5 / 30 / 325	58 / 5 / 30 / 325	58 / 5 / 30 / 325
40	38 / 5 / 70 / 150	53 / 60 / 280 / 165	59 / 20 / 280 / 245	59 / 20 / 280 / 245	59 / 20 / 280 / 245
50	39 / 5 / 60 / 205	54 / 15 / 390 / 160			
60	40 / 5 / 60 / 210	55 / 10 / 180 / 75			
70	41 / 5 / 50 / 150				
80	42 / 5 / 60 / 210				
90	43 / 5 / 60 / 190				
100	44 / 5 / 60 / 160				
110	45 / 5 / 70 / 210				
120	46 / 5 / 80 / 220				
130	47 / 15 / 100 / 305				
140	48 / 5 / 110 / 255				
150	49 / 10 / 140 / 195				

Sample taken every 10 cm. In. Depth

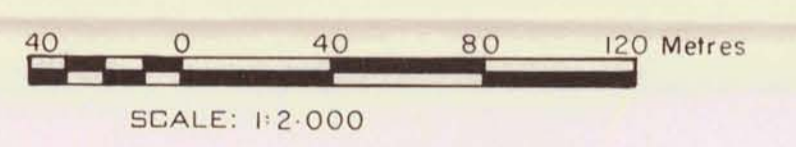

FALCONBRIDGE NICKEL MINES LIMITED

PROPERTY: Gold Grid & Creek Grid (Mickle Option)		
LOCATION: Baxter Creek Area Q.C.I.		
TYPE OF MAP: Geochemical (Soil & Silt)		
WORKING PLACE: Snow No.2 Claim		
BASED ON: Fieldwork by B.D. K.H.C. A.Mc		
DATE OF WORK: Oct. 1980	MAP REF. NO.:	FIG. NO.:
DRAWN BY: G.T.	N.T.S. NO.: 103-G-4	080-81-2
DATE: Dec. 1980		

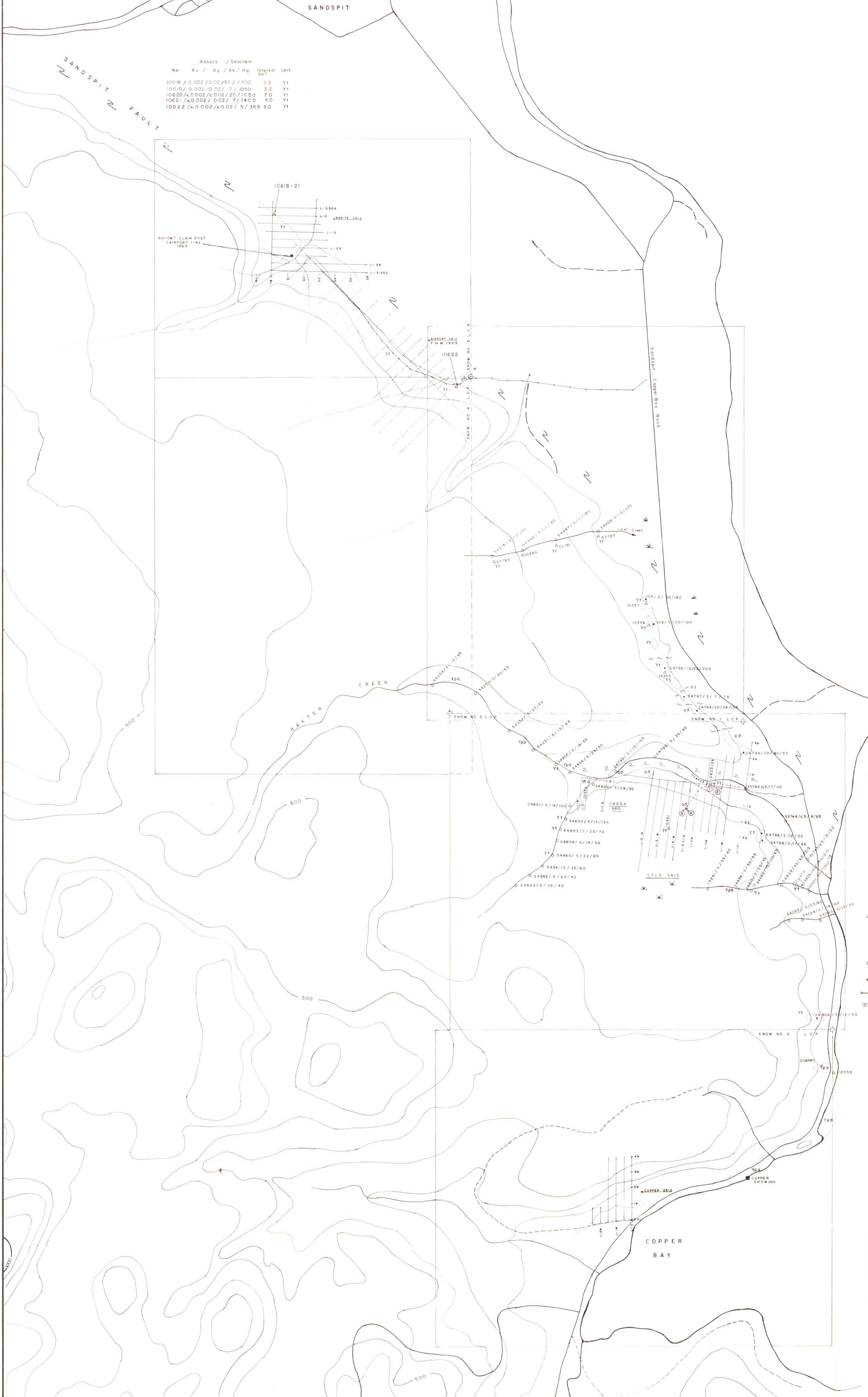

Assays / Geochem.

No.	Au	Ag	As	Hg	Interval (m)	Unit
10618	0.002	0.02	50	2400	3.2	Yt
10619	0.002	0.02	7	1050	3.2	Yt
10620	<0.002	<0.02	20	1050	7.0	Yt
10621	<0.002	0.02	7	14.0	4.0	Yt
10622	<0.002	<0.02	5	365	5.0	Yt

LEGEND

gd	Diorite-Quartz Diorite
Y	Yakou Formation
Ypa	porphyritic andesite
Yt	silicified tuff

Assays / Geochem.	Chip Sample	Unit
10351 / <0.002 / <0.02 / 7 / 15	0.5	Yt
10352 / 0.002 / 0.02 / 220 / 470	1.0	Yt
10353 / 0.002 / 0.02 / 7 / 40	2.0	Yt
10354 / 0.002 / 0.02 / 35 / 45	0.25	fault gouge
10355 / 0.002 / 0.02 / 7 / 225	grab	fault gouge
10356 / 0.002 / 0.02 / 10 / 70	1.0	Yt
10357 / 0.002 / 0.02 / 14 / 165	2.0	Yt
10358 / 0.002 / 0.02 / 15 / 10	2.0	Yt
10359 / 0.002 / 0.02 / 2 / 10	2.0	along shear (py)
10360 / 0.002 / 0.02 / 5 / 340	1.5	Yt
10623 / 0.002 / 0.02 / 60 / 45	5.0	Yt
10624 / 0.002 / 0.02 / 320 / 340	5.0	Yt
10625 / 0.002 / 0.02 / 1000 / 245	5.0	Yt

Geochem (ppm)	Chip Sample	Unit
57780 / 5 / 5 / 80	1.5	Yt
57781 / 5 / 11 / 283	1.5	Yt
57783 / 5 / 10 / 520	5.0	Yt

No. / Au / As / Hg	Silt Sample
54801 / 5 / 14 / 100	
54802 / 5 / 15 / 135	
54803 / 5 / 23 / 70	
54805 / 5 / 15 / 50	
54860 / 5 / 22 / 65	
54961 / 5 / 35 / 60	
54962 / 5 / 20 / 40	
54963 / 5 / 20 / 40	

No. / Au / As / Hg	Talus Sample
54796 / 5 / 10 / 180	
54797 / 5 / 1 / 25	
54798 / 5 / 12 / 30	
54799 / 5 / 7 / 45	
54800 / 5 / 18 / 95	
54801 / 5 / 14 / 100	
54802 / 5 / 15 / 135	
54803 / 5 / 23 / 70	
54805 / 5 / 15 / 50	
54860 / 5 / 22 / 65	
54961 / 5 / 35 / 60	
54962 / 5 / 20 / 40	
54963 / 5 / 20 / 40	

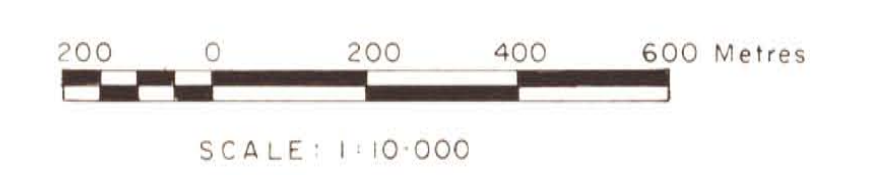

FALCONBRIDGE NICKEL MINES LIMITED		
PROPERTY: Mickle Option (P.N.080)		
LOCATION: Sandspit Area Q.C.1.		
TYPE OF MAP: Geology & Geochemical		
WORKING PLACE: Snow No. J&2 Claim		
BASED ON: Fieldwork by B.D. K.H.C. A.Mc.		
DATE OF WORK: Oct. 1980	MAP REF. NO.:	FIG. NO.:
DRAWN BY: G.T.		
DATE: Dec. 1980	N.T.S. NO.: 103-G-4	080-B1-1

