

521304

Zepher, B.C.
July 21/73

W. M. Leppin
P. Cohen & Engineering
1264 - West 11th
Vancouver, B.C.

Dear Harry:

Please find enclosed the following samples from the Thomson property.

73-62

As in the main shear zone, taken from the main showing, about 6' from the main ledge, and 24 inches from east wall.

73-66, 67, 68.

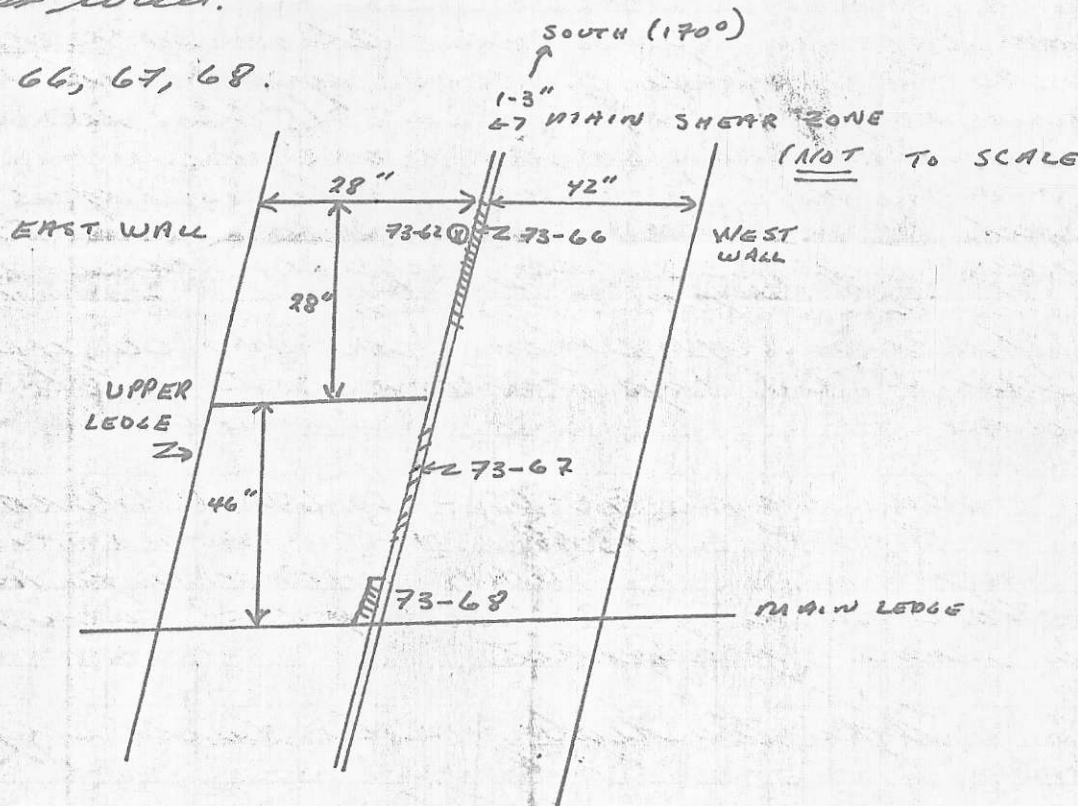

73-66 is taken along the shear zone.

SAMPLING WIDTH ≈ 1 "
DEPTH (INTO SHEAR) ABOUT 3"
LENGTH (DOWN ALONG SHEAR) 24"

73-67 SAMPLE ~~TAKEN~~ TAKEN FROM UPPER LEDGE TO SULFIDE EXPOSURE - (THE PIECE IN YOUR SAMPLE ONLY ONE WITH NATIVE Au.)
LENGTH - 40" DEPTH - ABOUT 6" TO 8"
(INTO SHEAR) -
WIDTH \div 2 INCHES.

July 29/73
 Leavitt, B. C.

Dear Harvey:

Please find enclosed one rough, sketched map showing sample locations for the samples which are being forwarded to you. Copy it, plus explanation which follows, will be transmittable.

There are 2 shear zones shown on the map. The main shear zone, (in blue) is the one containing the showings. I followed same south, about 600 ft or more from showings, & intersected second shear zone. About 100 ft further south on the MAIN SHEAR ZONE, came across the exposure I mentioned in previous letter. New samples 73-73, -74, -75 were taken.

- 73-73 - Secondary shear zone parallel to main shear zone
- 73-74 Main shear zone - exposure appears very similar to major shear showings at workings
- 73-75 Large flow block about 6' north of exposure - sampled slickenside surface.

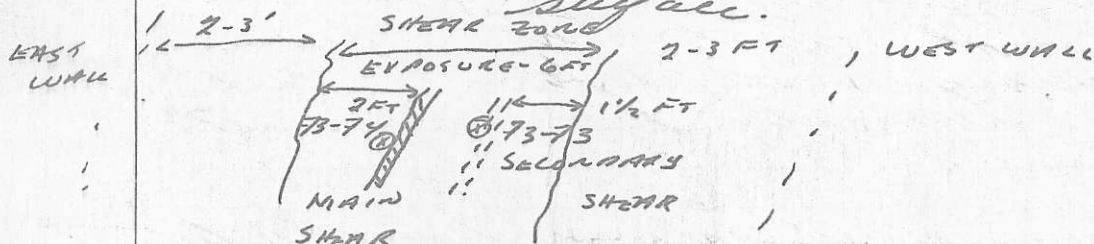

I then attempted to run the extension of the main shear zone north & down hill from workings. Ran into a possible exposure about 500 ft along strike - but there is heavy brush & steep slope.

Went a bit west and encountered ridge which I followed north - eventually reached second shear zone exposure - had been travelling across it at one point - found an exposure of same.

Sample 73-77 was taken from a narrow intensely fractured shear zone. There is

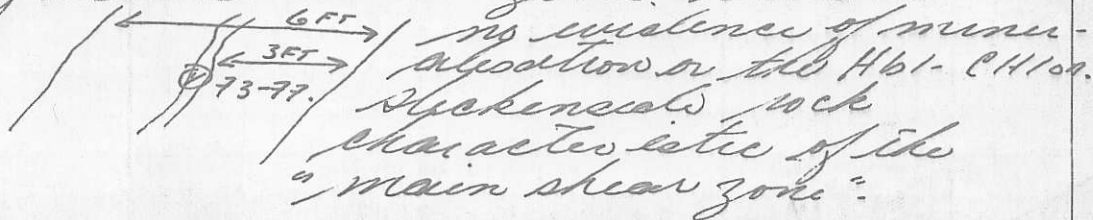

73-68: SAMPLE TAKEN FROM SULFIDE LENS(?) IN THE MAIN SHEAR ZONE.

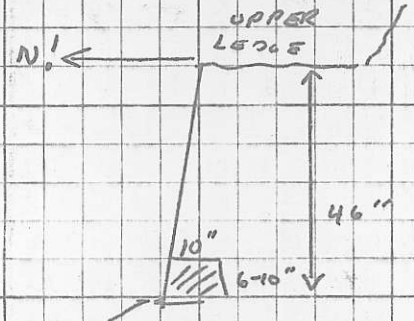

ORIGINAL SAMPLE: ABOUT 6" X 10" X 3/4"

I have chosen the samples best illustrating the Au mineralization from the main samples 73-62, 73-66, 73-67 (one only) & have included 73-68 for possible assay.

As the Au mineralization apparently begins as the sulfide zone is approached, there was only 1 sample (in 3 (5 plus) see the 73-67 group that showed any extensive Au. Am wondering if Au is in the sulfides & if so, how much.

Spill explain the sulfide business (with the rocks I have remaining as illustration if necessary) when I next see you, in the event this rapid description doesn't make sense.

Any way - 73-62, -66, -67 HIGH GRADE
73-68 AINT - AM CURIOUS
WHAT HAPPENED TO Au.

In the remaining 73-67 sample I have here, there is some malachite.

Hope the high grade will suffice

Yours!

W. H. Anderson