

521259

Date: Jan. 20/86

MINERAL PROPERTY SUBMITTAL

Submittal # 86-22

Submitted to: (Company) MCY Commodity Cu/Au Property Name: LOIS

Lat/Long \_\_\_\_\_ MINDEP/Other 228 NTS: 92L/5E Area/Province BC

SUBMITTOR: Name: ~~American International Development Corp.~~ OWNER: Jim McDonald  
Address: \_\_\_\_\_ Phone: 210-744 W. Hastings 685-0167  
687-0125

CLAIMS: Total No. 3020 4,5,6,7 Due Dates: \_\_\_\_\_  
= 50 units = 1250 ha.

PRIOR WORK BY: BRINCO 1984; ESSO 1974; Rio Tinto 1964; Venco 1970/71

CAPSULIZED GEOLOGY:

DEPOSIT TYPE:

TARGET DESCRIPTION: Length \_\_\_\_\_ Width \_\_\_\_\_ Down Dip \_\_\_\_\_

MINERALIZATION & ASSAYS:

NEIGHBOURING PROPERTY OWNERS: not known

- TERMS REQUESTED:
- \$2000 Down payment
  - 1986 Work Program of \$25,000 (negotiable)
  - 25,000 shares MCY in Dec '86
  - 25,000 shares MCY in Dec '87
  - 1% NSR

INTERVIEWED BY: AJP.  
OVERVIEW:

Submitted withdrawn - McDonald has deal w another junior.

- RECOMMENDATIONS:
- JSB
  - WR
  - AS
  - JMc

FILED NTS: 1) Claim Map 2) Data Submitted 3) Exam report 4) 1 copy this form

FINAL DISPOSITION:

Claims  
92L/SE (Apr. 179)  
old Lois Claims

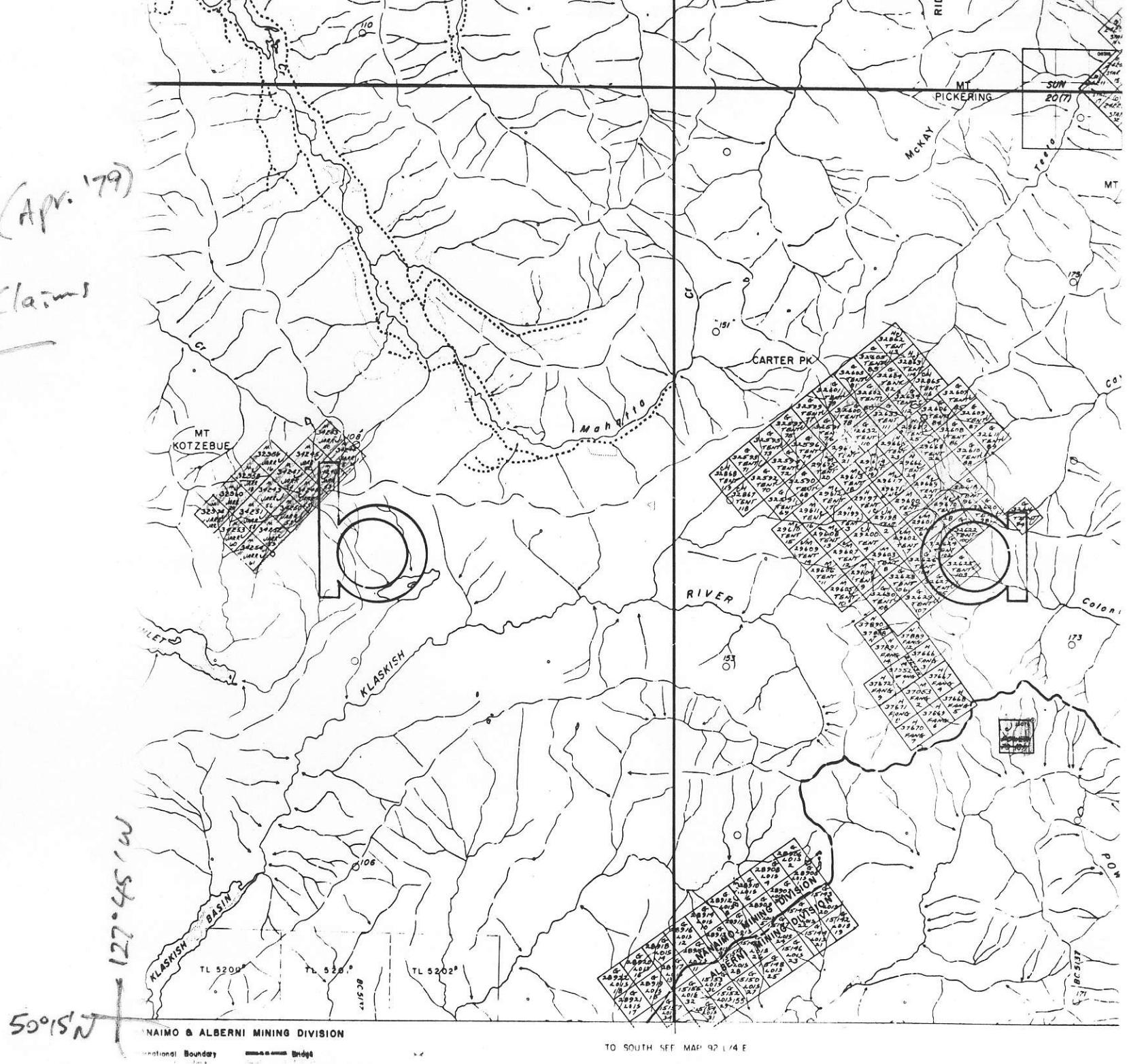

127° 45' W

50° 15' N

NAIMO & ALBERNI MINING DIVISION

TO SOUTH SEE MAP 92 L/4 E

