

HOLE No. 12

LOCATION Lower Tunnel

DIRECTION S25°W

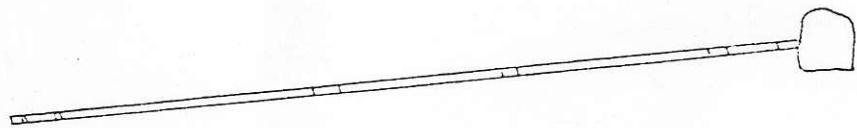
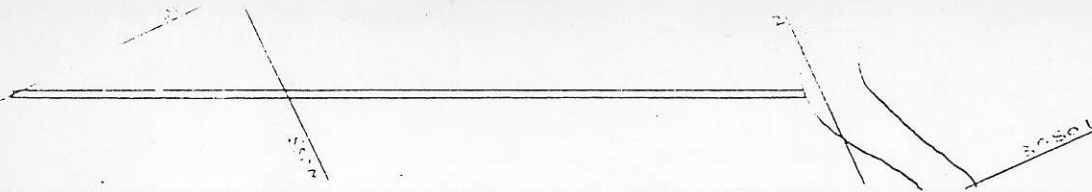

LEGEND

- Granodiorite []
- Planché Granodiorite []
- Silicified Rock []
- Disseminated Sulphides []
- Massive Sulphides []
- Assays: Au, Co, U₃O₈ []
- Shearing []

521226

NORTHERN GEM MINING CORP., LTD., N.P.L.
MINTO B.C.
D.D & TEST HOLES
 SCALE FEET
 DATE: _____

DDH #2

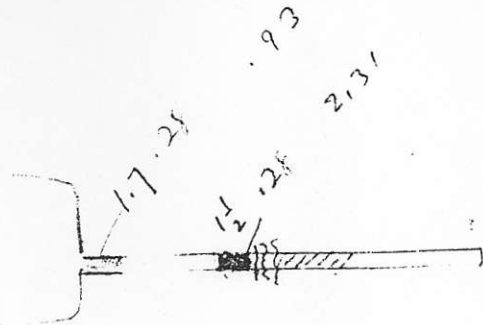

LOG

0-0	- 2-0	Heavy Sulph
2-0	- 7-0	Carbonate z.
7-0	- 8-0	L.S.
8-0	- 8-4	Heavy Sulph
8-2	- 9-2	Carbonate
9-2	- 10-0	Bleached Gra & shearings
10-0	- 14-0	Bleached Gra
14-0	- 24-6	Grano.

DDH #1

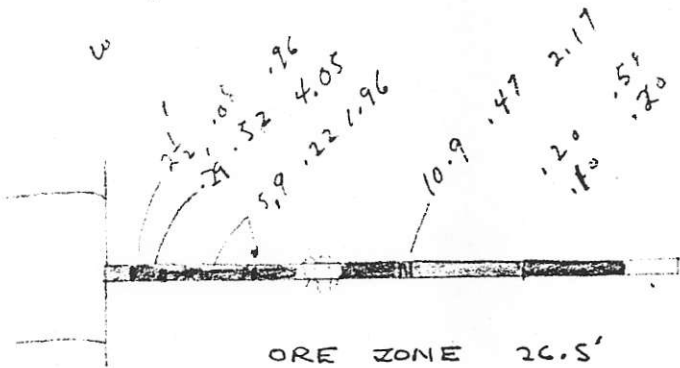

LOG

0.0	- 1-3	Diss. Sulph
1-3	- 1-5	Loose Core
1-5	- 2-3	Highgrade
2-3	- 3-1	L.C.
3-1	- 7-0	fg. rock m/
7-0	- 7-6	diss. sulph
7-6	- 7-8	Diss sulph
7-8	- 10-0	L.C.
10-0	- 12.8	Bleached Gra + Minor Diss.
12.8	- 15-0	Shredded w/ Ait. gran
15-0	- 15-10	Heavy Sulph
15-10	- 21-6	Solid fg. silice
21-6	- 26-5	Heavy diss. Diss. sulph in bleaches
26-5	- 27-0	Sil. gran
27-0	- 29-9	Granular
29-0	- 29-9	fg. Sil. Grano.

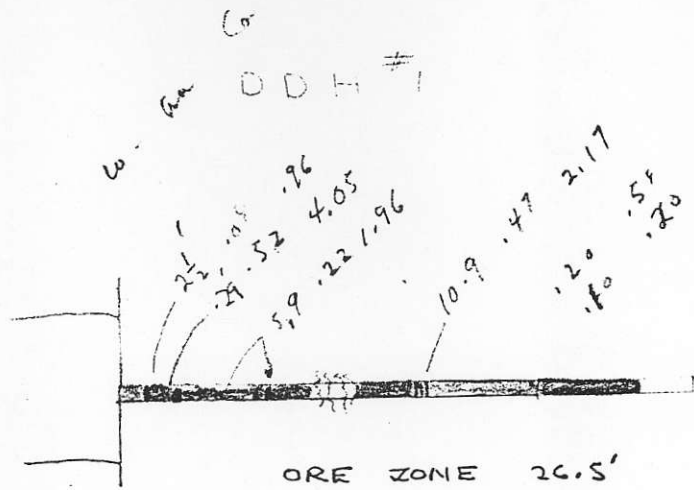

LOG

0.0 - 1.3	Diss. Sulph
1.3 - 1.5	Low Core
1.5 - 2.3	High grade
2.3 - 3.1	L.C.
3.1 - 4.0	fg. rock minor
4.0 - 7.6	diss. sulph.
7.6 - 7.8	L.C.
7.8 - 10.0	Bleached Grano. + minor Diss. Sulph.
10.0 - 12.3	Sheared white Art. grano.
12.3 - 15.0	Heavy Sulph.
15.0 - 15.10	Solid fg. fine Sulph.
15.10 - 21.6	Heavy diss Sulph
21.6 - 26.5	Diss. sulph. in bleached grano
26.5 - 28.0	Sil. grano
28.0 - 29.0	Granite
28.0 - 29.9	fg. Sil. grano.

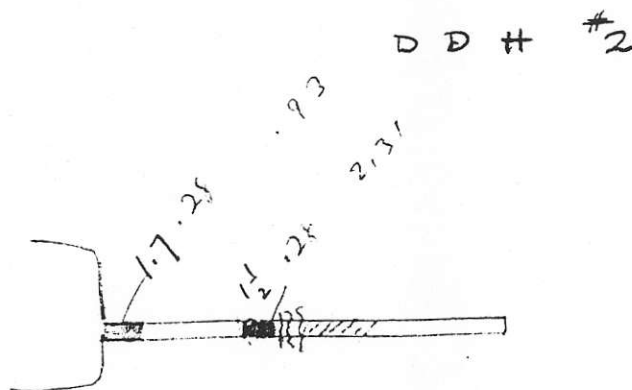

DD # 6

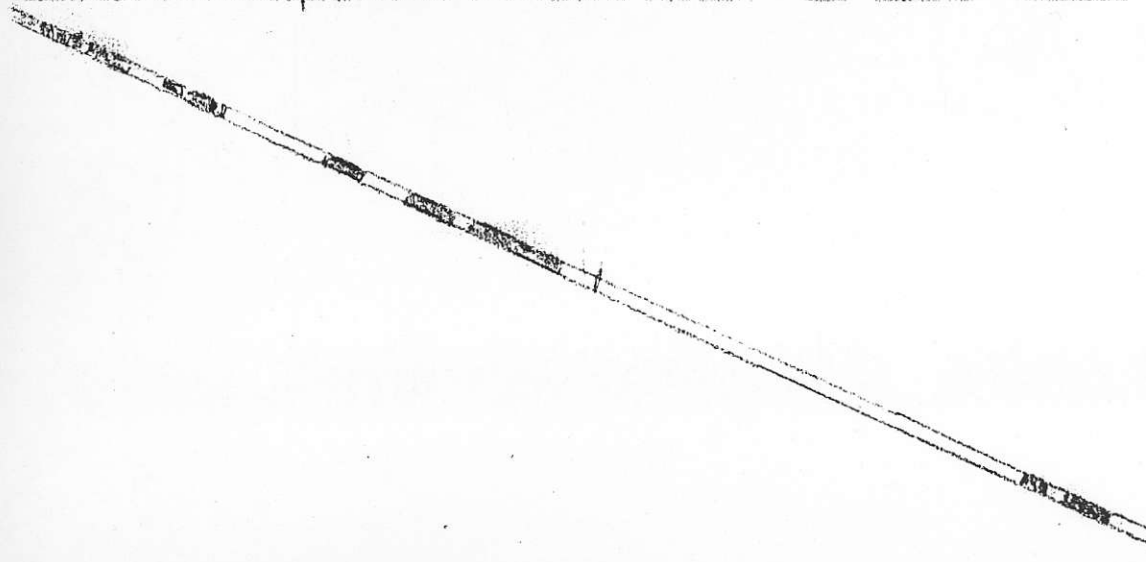

Log			
0-0	-	3-6	Sulphides
3-6	-	4-0	L.C.
4-0	-	4-6	Heavy S.
4-6	-	5-6	L.C.
5-6	-	6-0	Carbonates
6-6	-	7-6	L.C.
7-6	-	9-0	Diss. Sulph.
<hr/>			
9-0	-	10-0	Sil white Gms
10-0	-	11-0	L.C.
11-0	-	12-0	Diss Sulph
12-0	-	13-0	L.C.
13-0	-	13-6	Diss Sulph.
13-6	-	19-6	White Gms
17-6	-	21-6	Sulphides
21-6	-	24-0	White Gms
24-0	-	26-6	Diss Sulph.
26-6	-	27-6	White G.
27-6	-	33-0	Diss. Sulph
		Some	L.C.
30-0	-	57-0	White Gms
57-0	-	58-0	" " Shear
58-0	-	58-8	White Gms
58-8	-	60	L.C.
60-0	-	61-0	Qty stringer
61-0	-	62-6	L.C.
62-6	-	71-0	Carbonate
71-0	-	72-10	Shear
72-10	-	75-10	Carbonate
75-10	-	76-10	& Chols. Qty
76-10	-	85-4	Carbonate
85-4	-	86-10	L.C.
86-10	-	97-0	Soft. Carbonates Gms (brown Miller)

DD H #5

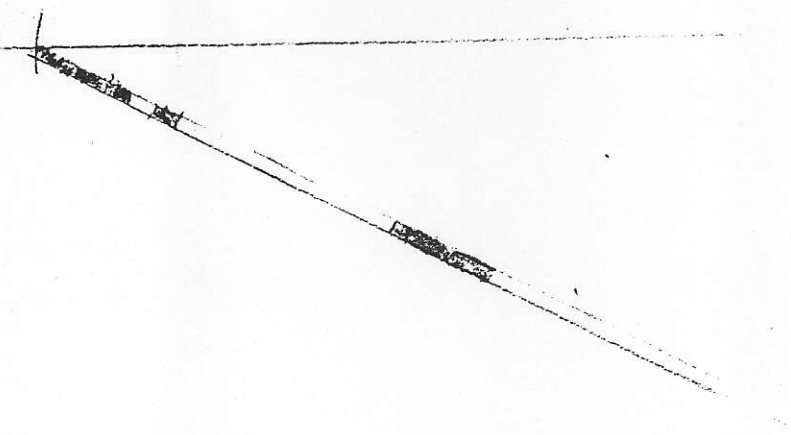

LOG

0-0	-	0-6	Heavy S.
6-6	-	1-0	L.C.
1-0	-	2-2	Heavy S.
2-2	-	2-8	L.C.
2-8	-	3-2	Heavy S.
3-2	-	4-0	White Grou
4-0	-	5-2	L.C.
5-2	-	6-8	White Grou
6-8	-	7-6	Shard & L.C.
7-6	-	8-2	L.C.
8-2	-	20-6	White Grou
20-6	-	21-4	Some Qty. Str.
21-4	-	23-0	Carbonate
23-0	-	23-6	fine veins of
23-6	-	26-0	Sulphides
26-0	-	34-0	Heavy Sulph
34-0	-	43-6	Sulphides
43-6	-	54-0	Minor Sulph
			in carbonate
			Altered
			Grou.
			Carb. & Qty
			G.

DD H #6

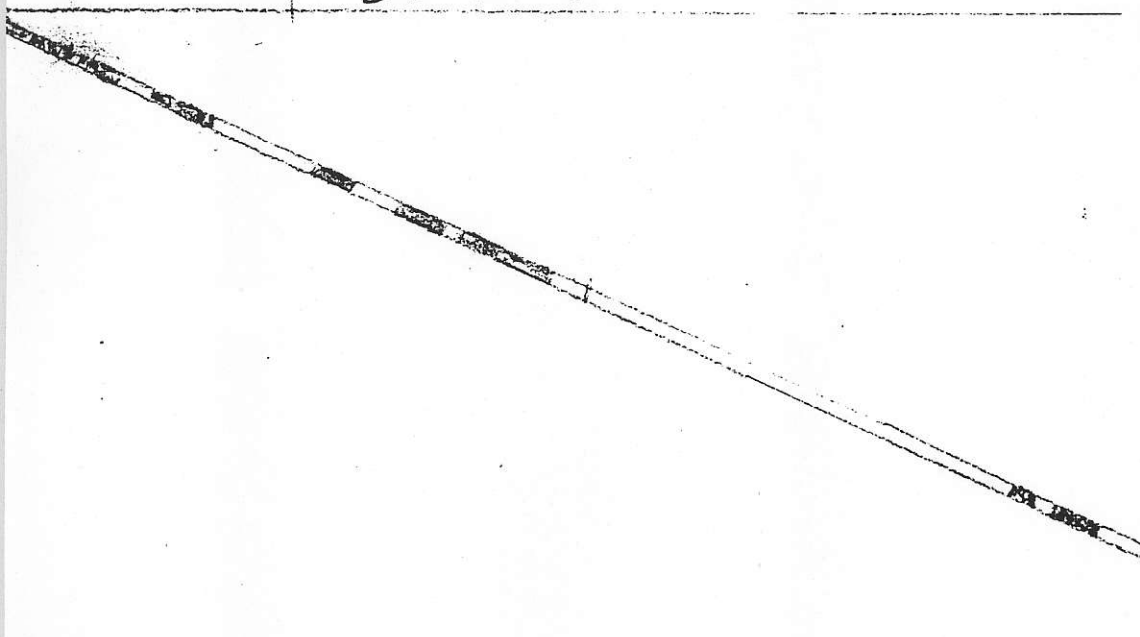

LOG

0-0	-	3-6	Sulphides
3-6	-	4-0	L.C.
4-0	-	4-6	Heavy S.
4-6	-	5-6	L.C.
5-6	-	6-0	Sulphides
6-6	-	7-6	L.C.
7-6	-	9-0	Diss. Sulph
9-0	-	10-0	Sil white Grou
10-0	-	11-0	L.C.
11-0	-	12-0	Diss Sulph
12-0	-	13-0	L.C.
13-0	-	13-6	Diss Sulph
13-6	-	14-6	White Grou
14-6	-	21-6	Sulphides
21-6	-	24-0	White Grou
24-0	-	26-6	Diss Sulph
26-6	-	27-6	White G.
27-6	-	33-0	Diss Sulph
33-0	-	57-0	Some L.C.
57-0	-	57-0	White Grou
57-0	-	58-0	" " Shard
58-0	-	58-8	White Grou
58-8	-	60	L.C.
60-0	-	61-0	Qty stringer
61-0	-	62-6	L.C.
62-6	-	71-0	Carbonate
71-0	-	72-10	Shard
72-10	-	75-10	Carbonate
75-10	-	76-10	& Chole. Qty
76-10	-	85-4	Carbonate
85-4	-	86-10	L.C.
86-10	-	97-0	Soft Carbonate
			Grou.
			(brown matrix)

DD # 7

LOG.

0-0	-	5-8	Granod.
5-8	-	8-6	Carbonated
8-6	-	10-0	"
10-0	-	12-0	Disse. Sci
12-0	-	15-0	L.C.
15-0	-	18-2	Diss. Sul
18-2	-	18-8	Heavy Sul
19-5	-	20-0	L.C.
20-0	-	20-4	Sulphide
20-4	-	20-7	L.C.
20-7	-	20-9	Qty + Sulph
20-9	-	21-0	L.C.
21-0	-	22-0	Qty + Sulph
22-0	-	23-0	L.C.
23-0	-	25-11	Sulphide
25-11	-	26-6	Black & Sulph
26-6	-	26-9	L.C.
26-9	-	27-6	Qty - Sul
27-6	-	41-0	Carbon
41-0	-	56-2	Granod
56-2	-	57-6	Shear
57-6	-	58-0	L.C.
58-0	-	59-3	Carbon +
59-3	-	60-9	L.C.
60-9	-	62-11	White
62-11	-	64-3	L.C.
64-3	-	67-9	Dark

0-0	-	0-2	U.S. G.
0-6	-	2-4	Air. G.
2-4	-	4-2	Lamp Dye. G.
4-2	-	12-5	G.
12-5	-	24-0	Carb. G.
24-0	-	31-0	" "
31-0	-	34-0	G.
34-0	-	36-0	Carb
36-0	-	71-0	G.
71-0	-	72-4	Sheared White
72-4	-	73-4	L.C.
73-4	-	74-0	Sheared W. G.
74-0	-	74-6	" with good Sulphide
74-6	-	89	G.

DD # 9

210°
0°

LOG.

0-0	-	1-0	W. G.
1-0	-	2-0	W. G. + Sulph
2-0	-	6-0	Dissam. Grano
6-0	-	10-0	W. G.
10-0	-	35-0	Grano
35-0	-	37-0	Carb + Chlorid
37-0	-	47-0	Grano
47-0	-	48-0	Grano lg. Sil. G.
48-0	-	68-0	Grano

N 20° W
+45°

0-0	-	2-0	White G. Minor S.
2-0	-	4-6	W.G. Shear
4-6	-	41-5	G
41-5	-	51-5	Disc. S.
51-5	-	57-0	G.
57-0	-	58-0	Shear, ed G. Minor Disc. S.
58-0	-	63-0	White G
63-0	-	68-0	G.
68-0	-	68-6	L.C.

DD # 11

N 15° E
+40°

LOG

0-0	→	2-6	Minor Disc. S.
2-6	-	3-10	Shear, ed W.G.
3-10	-	5-0	White + Sulph
5-0	-	6-6	W.G.
6-6	-	48-0	G
48-0	-	50-10	White G.
50-10	-	54-10	G
54-10	-	58-6	W.G.
58-6	-	81-6	G
81-6	-	82-6	Shear, ed S + W.G.
82-6	-	95. G	
95-0	-	96-0 G.	
96-0	-	97-0 G.	
97-0	-	104-0 G.	

1-0 7-0 W.G. 200
 2-0 7-6 S. Subp. G. 6.
 7-6 9-6 W.G. 6.
 9-6 29-0 S.
 27-0 30-6 $\frac{5}{11}$ G.
 30-6 47-5 S.
 47-5 47-6 G. 6.
 47-6 50-0 S. 6.
 50-0 56-0 A. 6.
 56-0 71-0 S.
 71-0 76-0 S.
 76-0 76-10 S. 6. black G.
 76-10 79-0 black dyke
 79-0 80-0 LC
 80-0 81-7 black lamp
 dyke

LOG # 2 DDH

110-133 Granodiorite
 133-133 $\frac{1}{2}$ Broken
 133 $\frac{1}{2}$ -134 $\frac{1}{2}$ Bleached with disseminated sulphide
 134 $\frac{1}{2}$ -138 Granodiorite
 138-139 Disseminated sulphide, Sample #1
 139-146 $\frac{1}{2}$ Heavy sulphide, Sample #2
 Sample #3 145-146 $\frac{1}{2}$
 146 $\frac{1}{2}$ -151 $\frac{1}{2}$ Lost core
 151 $\frac{1}{2}$ -152 $\frac{1}{2}$ Heavy sulphide Sample #4
 151 $\frac{1}{2}$ -152 $\frac{1}{2}$
 153 $\frac{1}{2}$ -155 $\frac{1}{2}$ Bleached granodiorite
 Fine, regular quartz stringers
 Little or no sulphide
 155 $\frac{1}{2}$ -156 $\frac{1}{2}$ Granodiorite
 156 $\frac{1}{2}$ -164 Bleached granodiorite - no sulphides
 164-167 Granodiorite

LOG OF DIAMOND DRILL HOLE No. 60

DATE: from September 10, 1957 to Location #1 Level drift

CO-ORDINATES: Northing Easting Elevation

LENGTH 72 BEARING 230° INCLINATION -10

VERT. COMP HORIZ. COMP OBJECTIVE

FOOTAGE		WIDTH	RECOVERY	DESCRIPTION	SAMPLE NO.	Co %	AU Oz.	U ₃ O ₈ %
FROM	TO							
0	9	9	75	(3' casing) Altered diorite, mottled in appearance				
9	11.5	2.5	80	Bleached diorite				
11.5	13	1.5	85	Bleached, disseminated sulphides				
13	19	6	90	Heavy sulphides in reddish rock. 2" calcite streak at 16. U ₃ O ₈ good				
19	20	1	90	Massive sulphides				
20	21.5	1.5		Good sulphides		?		
-	-	-		0-20 is repeat on hole #40 which caved. Ore grade from 0-20 appears better than #40 but has not been sent for assay yet			?	
21½	41	19½	80	Brown rusted carbonaceous rock small quartz streaks throughout.				
41	42½	1.5	50	Bleached, slightly better than disseminated ore.	16785	0.80	2.30	
42½	45	2.5	75	Rusty carbonates				
45	48	3	85	Altered, medium dark diorite				
48	50	2		Disseminated sulphides in bleached	16786	0.26	0.30	
50	53	3		Soft bleached diorite				
53	56	3		Altered diorite, mottled appearance				
56	60	4		Bright green rock with blobs of black in it. Good sulphides.	3' assay (57-60) 16787	1.58	0.50	
60	72	12		Granidiorite, coarse grain. Not too dark in color.				

Signed..... H. Shuttleworth

LOG OF DIAMOND DRILL HOLE No. 59

DATE: from September 8, 1957 to Location #1 Level drift
 CO-ORDINATES: Northing Easting Elevation #1 Drill Station
Under 36
 LENGTH 55 BEARING 194° INCLINATION -38
 VERT. COMP. HORIZ. COMP. OBJECTIVE

FOOTAGE		WIDTH	RECOVERY	DESCRIPTION	SAMPLE NO.	CO %	AU OZ.	U ₃ O ₈ %
FROM	TO							
0	3	1		2' casing, Bleached granodiorite (not assayed) disseminated sulphides				
3'	13'	10	90	Massive sulphides 6'-9' U ₃ O ₈ present also 11'-13'	3-7' #16778 7-9' 16779 9-12' 16780 12-13 16781	4.7 6.2 6.25	0.72 1.2 1.2	0.139 0.15
13	18	5	90	Bleached, soft carbonates				
18	21	3	90	Bleached diorite, good to heavy sulphides	#16782	2.45	1.33	
21	23	2	90	Bleached diorite disseminated sulphides				
23	25	2	90	Bleached, scattered sulphides				
25	29	4	80	Bleached, carbonates, soft.				
29	33	4	80	Bleached, heavy sulphides	Minor U ₃ O ₈ #16783	4.59	0.72	
33	34	1	50	Bleached, disseminated sulphides. 1 foot core lost between 34-35				
34	45	11	80	Bleached, soft carbonates 1" quartz at 43'				
45	55	10	80	Medium dark diorite. Some alteration 8" bleached at 54'				

Signed H. Huttletworth

LOG OF DIAMOND DRILL HOLE No. 53

DATE: from September 7, 1957 to..... Location #1 Level Drift
75 drill station
 CO-ORDINATES: Northing..... Easting..... Elevation.....
 LENGTH 20' BEARING 120° app. INCLINATION Flat
 VERT. COMP..... HORIZ. COMP..... OBJECTIVE.....

FOOTAGE		WIDTH	RECOVERY	DESCRIPTION	SAMPLE NO.	Co %	AU Oz.	U ₃ O ₈ %	
FROM	TO								
0	5	5	85	Bleached diorite, soft rusted appearance. Small quartz streaks throughout					
5	13	13		Medium dark diorite. 4" bleached at 14'.					
18	20	2		Soft bleached carbonates					
				Drilled to check test hole					

Signed..... **H. Shuttleworth**

LOG OF DIAMOND DRILL HOLE No. 57

DATE: from August 27, 1957 to Sept. Location #1 Level Drift
 CO-ORDINATES: Northing Easting Elevation #5 Drill Station
 LENGTH 90' BEARING 185° INCLINATION 45°
 VERT. COMP HORIZ. COMP OBJECTIVE

FOOTAGE		WIDTH	RECOVERY	DESCRIPTION	SAMPLE No.	CO %	AU Oz.	US Oz %
FROM	TO							
0	18	18	50	Soft bleached, carbonaceous quartz streaks at 4' and 17'				
18	39	21	80	Medium dark diorite				
39	41	2	75	Medium dark, but very soft				
41	65	24	-	Missing, but no ore				
65	90	25	80	Dark grandiorite. Very little alteration. 2" bleached at 71'				

Signed H. J. McLaughlin

LOG OF DIAMOND DRILL HOLE No. 56

DATE: from August 27, 1957 to..... Location #1 Level drift
 CO-ORDINATES: Northing Easting..... Elevation #3A Drill Station
 LENGTH 26' BEARING 322° INCLINATION Flat
 VERT. COMP..... HORIZ. COMP..... OBJECTIVE.....

FOOTAGE		WIDTH	RECOVERY	DESCRIPTION	SAMPLE No.	Co %	AU Oz.	U ₃ O ₈ %
FROM	TO							
0	9	9	90%	Altered medium dark diorite with some of it mottled in appearance				
				2" quartz at 9'				
9	10	1	90	Green dike				
10	14	4	50	Mottled diorite brownish in appearance				
14	15	1	75	Brownish color. Soft carbonates				
15	26	11		Medium dark - 3" pink quartz at 20'				

Signed H. Shuttleworth

LOG OF DIAMOND DRILL HOLE No. 55

DATE: from August 26, 1957 to Location #1 Level drift
 CO-ORDINATES: Northing Easting Elevation #3 Drill Station
 LENGTH 14' BEARING 50° INCLINATION + 35°
 VERT. COMP HORIZ. COMP OBJECTIVE

FOOTAGE		WIDTH	RECOVERY	DESCRIPTION	SAMPLE No.	Co %	AU Oz.	U ₂ O ₈ %
FROM	TO							
0	4	4	90	Rusted, soft carbonates				
4	11	7		Bleached, some rusty brown sections 1/4" black streaks in quartz at 9'				
11	14	3		Alt. medium dark diorite				

Signed.....

LOG OF DIAMOND DRILL HOLE No. 54

DATE: from August 26 to..... Location #1 Level drift
#3 Drill Station
 CO-ORDINATES: Northing Easting..... Elevation.....
 LENGTH 20' BEARING 110° INCLINATION + 35 °
 VERT. COMP..... HORIZ. COMP..... OBJECTIVE.....

FOOTAGE		WIDTH	RECOVERY	DESCRIPTION	SAMPLE NO.	Co %	AU Oz.	U ₃ O ₈ %
FROM	TO							
0	5	5	85	Altered medium dark diorite				
5	6	1		Bleached, rusty in color, fair sulphides	16776	0.56	0.54	
6	9½	3.5		Massive sulphides	16777	0.75	0.78	
9½	10½	1		Rusted carbonates				
10½	30	19.5		Altered medium dark diorite				

Signed..... H. Shuttleworth

LOG OF DIAMOND DRILL HOLE No. 53

DATE: from August 25, 1957 to..... Location #1 Level drift
#3 Drill Station
 CO-ORDINATES: Northing Easting..... Elevation.....
 LENGTH 20' BEARING 85° INCLINATION +35°
 VERT. COMP..... HORIZ. COMP..... OBJECTIVE.....

FOOTAGE		WIDTH	RECOVERY	DESCRIPTION	SAMPLE NO.	Co %	AU Oz.	U ₃ O ₈ %
FROM	TO							
0	1	1	85%	Altered diorite				
1	10	9	85	Sandy, rusted, soft diorite 1" quartz streak at 2'				
10	20	10	85	Altered medium dark diorite 6". Is pinkish in color at 15'				

Signed..... H. Shuttleworth.....

LOG OF DIAMOND DRILL HOLE No. 50

DATE: from August 21 to August 22 Location No. 1 Level Drift
D.D. St. #3

CO-ORDINATES: Northing Easting Elevation.....

LENGTH 20' BEARING 265° INCLINATION +36°

VERT. COMP..... HORIZ. COMP..... OBJECTIVE.....

FOOTAGE		WIDTH	RECOVERY	DESCRIPTION	SAMPLE No.	Co %	AU Oz.	U ₃ O ₈ %
FROM	TO							
0	4	4	90	Moderate sulphides in dark, almost black (when fresh cut) rock. Chloritic-green when weatherized. Black streak.	1829B	0.60		
4	5	1	90	Medium dark diorite. Rust seams. Very little alteration or mineralization.				
5	6	1	90	Dense fine-grained rock. Rust seams at both ends.				
6	8	2	90	Disseminated sulphides in light to medium dark diorite.	1830B	0.10		
8	12'-4"	4'-4"	90	Light to medium dark diorite. Rust seams. Very little mineralization.				
12'-4"	14	1'-8"	80	Moderate to heavy sulphides in altered diorite. Some free quartz.	1831B	0.41		
14	20	6	70	Light to medium dark diorite. Very little mineralization. Rust seams.				

Signed..... John Hecarth

LOG OF DIAMOND DRILL HOLE No. 49

DATE: from August 21 to August 21 Location No. 1, Level Drift
 CO-ORDINATES: Northing Easting..... Elevation..... D.D. St. #3
 LENGTH 40' BEARING 320° INCLINATION Flat
 VERT. COMP..... HORIZ. COMP..... OBJECTIVE.....

FOOTAGE		WIDTH	RECOVERY	DESCRIPTION	SAMPLE No.	CO %	AU Oz.	U ₃ O ₈ %
FROM	TO							
0	6	6	90	Altered diorite. Mostly bleach. Sections crumble easily. Very little mineralization.				
6	14'-8"	8'-8"	90	Slightly altered diorite. 2" section highly altered at 11: Very little mineralization.				
14'-8"	15	4"	90	Bleached diorite. Soft. Very little mineralization.				
15	22	7	90	Medium dark diorite. Very little alteration or mineralization. 1" section of quartz at 20'.				
22	22'-6"	6"	90	Altered diorite. Quartz inter-section.				
22'-6"	40'	17'-6"	90	Medium dark diorite. Very little alteration. A few tiny quartz filled fractures from 32' - 40'. No other mineralization.				

Signed John Hogarth

LOG OF DIAMOND DRILL HOLE No. 48

DATE: from August 20 to August 20 Location #1 Level Drift
 CO-ORDINATES: Northing Easting Elevation #4 Drill Station
 LENGTH 42' BEARING 5° W. of N. INCLINATION Flat
 VERT. COMP. HORIZ. COMP. OBJECTIVE

FOOTAGE		WIDTH	RECOVERY	DESCRIPTION	SAMPLE No.	CO %	AU OZ.	U ₃ O ₈ %
FROM	TO							
0	7	7	85%	Granidiorite - Dark 4" bleached at 3".				
7	12	5	85	Bleached - 15" Smoky quartz				
12	25	13	85	Granidiorite				
25	29	4	85	Bleached - Soft - 2" Quartz at 29'				
29	33	4	85	Granidiorite				
33	42	9	80	Bleached - Soft - Rusty color 40-42 - with small quartz streak.				

Signed H. Shuttleworth

LOG OF DIAMOND DRILL HOLE No. 47

DATE: from August 18 to Location #1 Level Dr.
 #4 Drill Station
 CO-ORDINATES: Northing Easting Elevation
 LENGTH 53' BEARING 159° INCLINATION -45°
 VERT. COMP. HORIZ. COMP. OBJECTIVE

FOOTAGE		WIDTH	RECOVERY	DESCRIPTION	SAMPLE No.	Co %	AU Oz.	U ₂ O ₃ %
FROM	TO							
0	10	10	80%	Bleached granidiorite with frequent rust seams.				
10	26	16	80%	Altered medium dark granidiorite				
26	29	3	75	Altered granidiorite finer grain. Dark with black fine spots.				
29	30	3	75	Alt. med. dark diorite				
32	36	4	80	Bleached - soft diorite with some quartz alteration				
36	39	3	80	Greenish diorite - 4" of bleached good mineralization.	1823B	7	0.05	
39	41½	2.5	75	Medium dark with some quartz				
41½	45	3.5	50%	Some bleached, some greenish with good mineralization.	1824	1.14	0.14	
45	48	3	60%	Same as above. 4" massive sulphides	1825	1.98	0.22	
48	49	1	75	Bleached disseminated ore	1826B		0.01	
49	52	3	65	3" bleached, 3" black rock with massive sulphides. Some deep green rock with good sulphides changing to medium dark at last foot	1827B	1.19	0.10	
52	58	6	70	Medium dark diorite				

Signed J. Shuttleworth

LOG OF DIAMOND DRILL HOLE No. 46

DATE: from August 17 to August 17 Location #1 Level Drift
 CO-ORDINATES: Northing Easting Elevation #4 Drill Station
 LENGTH 46' BEARING 175° INCLINATION -45
 VERT. COMP. HORIZ. COMP. OBJECTIVE

FOOTAGE		WIDTH	RECOVERY	DESCRIPTION	SAMPLE NO.	Co %	AU Oz.	U ₂ O ₃ %
FROM	TO							
0	11	11	70%	Bleached, some sand colored at 7'				
				6" dark diorite at 9½' to 10'				
11	20	9	80	Medium dark altered diorite. Some pale sections as if mixed with some bleached				
20	28	8	80	Altered mottled diorite pinkish spots 6" bleached at 26'				
28	29	1	80	Bleached				
29	32	3	80	Bleached 6" dark at 30' disseminated sulphides	18198		0.20	
32	35	3	85	High-grade ore in greenish chloritic like rock	1820		0.63	
35	37½	2½	85	Same as above	1821	192	0.34	
37½	39	1½	80	Altered diorite. Lighter in color. Slight amount of sulphides	1822	14	0.04	
39	46	7	85	Altered diorite, lighter in color. Quite hard. Some sparse mineralization between 41 and 43.			?	?

Signed.....

LOG OF DIAMOND DRILL HOLE No. 45

DATE: from August 16 to Location #1 Level Drift
 CO-ORDINATES: Northing Easting Elevation.....
#4 Drill Station
 LENGTH 43' BEARING 175° INCLINATION Flat
 VERT. COMP..... HORIZ. COMP..... OBJECTIVE.....

FOOTAGE		WIDTH	RECOVERY	DESCRIPTION	SAMPLE NO.	CO %	AU Oz.	U ₃ O ₈ %
FROM	TO							
0	22	22	80	Alt. medium dark diorite. Highly weathered, broken ground, sandy brown in color at 17' - 19'.				
22	24	2	60%	Bleached, soft, diorite				
24	31	7	85	Altered medium dark diorite				
31	36	5	80%	Bleached, sandy color 34' - 36'				
36	43	7	85	Medium dark diorite				

Signed.....

LOG OF DIAMOND DRILL HOLE No. 44

DATE: from August 15 to August 15 Location #1 Level Drift
#4 Drill Station
CO-ORDINATES: Northing Easting Elevation
LENGTH 45' BEARING 238° INCLINATION -20°
VERT. COMP. HORIZ. COMP. OBJECTIVE

FOOTAGE		WIDTH	RECOVERY	DESCRIPTION	SAMPLE No.	Co %	AU Oz.	U ₃ O ₈ %
FROM	TO							
0	6	6	80%	Bleached. Alt. 1" quartz with fine minor sulphides at collar. 1" quartz and rust seam at 2.5				
6	10.6	4.56	80	Altered medium dark diorite				
10.6	12.	1.3		Fair to good sulphides in bleached. No U ₃ O ₈ apparent	1806B		1.08	
12	15	3	85	Good to massive sulphides in chloritic deep green rock	1807		1.64	
15	16	1	85	Mostly quartz - disseminated ore	1808		0.10	
16	19	3	85	Good to massive ore in same deep green rock	1809		0.84	
19	22	3	90	Heavy sulphides in bleached	1810		0.30	
22	26	4	80	Bleached - Good sulphides. No U ₃ O ₈	1811		0.08	
26	29	3	80	Heavy to massive sulphides in bleached diorite	1812		1.64	
29	31	2	80	Same as above (Split for assays)	1813		1.52	
31	32	1	80	Bleached, High-grade ore with trace U ₃ O ₈	1814		0.36	.44
32	35	3	70%	Bleached, well mineralized	1815		0.20	
35	37	2	60	Bleached, disseminated ore	1816		0.02	
37	39	2	75	Bleached, fairly heavy disseminated ore	1817		0.16	
39	40	1	70	Disseminated ore in bleached diorite	1818		0.03	
40	45	5	70	Altered medium dark granidiorite				

Signed H. Shuttleworth

LOG OF DIAMOND DRILL HOLE No. 43

DATE: from August 14, 1957 to Location #1 Level Dr.
 CO-ORDINATES: Northing Easting Elevation #4 Drill Station
 LENGTH 56' BEARING 250° INCLINATION -30°
 VERT. COMP. HORIZ. COMP. OBJECTIVE

FOOTAGE		WIDTH	RECOVERY	DESCRIPTION	SAMPLE NO.	Co %	AU Oz.	U ₂ O ₃ %
FROM	TO							
0	4	4	80%	Altered bleached diorite minor quartz streaks				
4	20	16	85	Altered medium dark diorite, mottled in appearance, one foot bleached at 14'				
20	20.5	0.5	75%	Bleached, low-grade ore	1805	0.13	0.13	
20.5	25	4.5	80	Medium dark alt. Small pinky quartz intrusives				
25	30	5	75%	Bleached, soft 4" rust seam at 30'				
30	35	5	65	Alt. medium dark diorite				
35	45	10	70	Bleached, altered. Some quartz streaks. Very minor sulphides at 35.5 and 40-42. Very fine grain, probably chalcopyrite				
45	46	1	80	Medium dark diorite				
46	47.5	1.5	80	Bleached 6" rust seam				
47.5	50.5	3	75	Medium dark, altered, mottled and pinky in color				
50.5	51	0.5	75	Bleached with small quartz streaks				
51	56	5	70	Altered medium dark diorite				

Signed..... H. Shuttleworth

LOG OF DIAMOND DRILL HOLE No. 42

DATE: from August 13, 1957 to August 13 Location No. 1 Level Drift
 CO-ORDINATES: Northing Easting..... Elevation..... DD No. 2 A.
 LENGTH 55' BEARING 102° INCLINATION 30°
 VERT. COMP..... HORIZ. COMP..... OBJECTIVE.....

FOOTAGE		WIDTH	RECOVERY	DESCRIPTION	SAMPLE No.	Co %	AU Oz.	U ₂ O ₆ %
FROM	TO							
0	5	5	0	Hole cased. No core recovered.				
5	12	7	90	Altered diorite. Rusty sections in the bleach. Very little mineralization				
12	14	2	90	Medium dark diorite. Rust seams. Very little alteration.				
14	19	5	70	Highly altered diorite. Bleach and brown colored soft rock.				
19	39	20	90	Light to medium dark diorite. Some alteration. Very little mineralization.				
39	45	6	90	Bleached diorite. Some free quartz.				
45	55	10	90	Light to medium dark diorite. Very little mineralization.				

Signed..... **John Hogarth**

LOG OF DIAMOND DRILL HOLE No. 41

DATE: from August 12, 1957 to August 12 Location No. 1 Level Drift
 CO-ORDINATES: Northing Easting..... Elevation DD Sta # 2 A. 6. 1
 LENGTH 60' BEARING 131° INCLINATION Flat
 VERT. COMP..... HORIZ. COMP..... OBJECTIVE.....

FOOTAGE		WIDTH	RECOVERY	DESCRIPTION	SAMPLE No.	Co %	AU Oz.	U ₂ O ₃ %
FROM	TO							
0	9	9	90	Medium dark diorite. Very little alteration or mineralization.				
9	21	12	80	Highly altered diorite. Color, brown. Sections of core very soft. Very little mineralization.				
21	33.5	12.5	90	Medium dark diorite. Very little alteration or mineralization. Rust seams.				
33.5	34	0.5	90	Bleached diorite. Very little mineralization.				
34	42.5	8.5	90	Fine grained light colored rock. Rust seams. Very small crystals.				
42.5	49	6.5	90	Light to medium dark diorite. Slight alteration. Rust seams.				
49	51	2	90	Altered diorite. Color, rusty brown.				
51	55	4	90	Medium dark diorite. Very little alteration. Rust.				
55	55.5	0.5	90	Altered diorite. Rust seam. Very little mineralization.				
55.5	60	4.5	90	Light to medium dark diorite. Slight alteration. Very little mineralization.				

Signed.....John H. Genth.....

LOG OF DIAMOND DRILL HOLE No. 40

Replaced by 40

DATE: from August 9, 1957 to August 9 Location No. 1 Level Drift
 CO-ORDINATES: Northing Easting..... Elevation 2 D Sta. #1
Under 3F
 LENGTH 21' BEARING 230° E. of N. INCLINATION -45°
 VERT. COMP..... HORIZ. COMP..... OBJECTIVE.....

FOOTAGE		WIDTH	RECOVERY	DESCRIPTION	SAMPLE No.	CO %	AU Oz.	U ₃ O ₈ %
FROM	TO							
1	10.5	10.5	90	Light to medium dark diorite. Some alteration. Rust seams. Very little mineralization.				
10.5	13	2.5	90	Bleached diorite. Very little mineralization.				
13	15	2	80	Red-mauve colored rock with sulphides in moderate quantity dispersed throughout. Very radio-active.	1801B	1.23	.18	.52
15	16	1	70	Massive sulphides with some carbonate	1802B	4.32	2.36	
16	18	2	60	Red-mauve colored rock with large pieces of massive sulphides. Very	1803B	0.44	.15	.87
18	21	3	50	Bleached diorite. Large pieces of massive sulphides dispersed throughout.	1804B	2.50	.76	
				NOTE: HOLE ENDS IN ORE. THE HOLE CAVED AT 21'				

Signed..... John Hogarth

LOG OF DIAMOND DRILL HOLE No. 39

DATE: from August 8, 1957 to Location #1 Level Drift

CO-ORDINATES: Northing Easting Elevation D.D. 5/2 #1

LENGTH BEARING 230° E. of N. INCLINATION - 22°

VERT. COMP. HORIZ. COMP. OBJECTIVE

FOOTAGE		WIDTH	RECOVERY	DESCRIPTION	SAMPLE NO.	CO %	AU OZ.	U ₃ O ₈ %
FROM	TO							
0	6	6	90%	Altered granodiorite, mottled pinkish in color				
6	7	1	90	Bleached, with rust seams				
7	10	3	90	Bleached with scattered mineralization. Low grade	1791			
10	14.5	4.5	90	Bleached, disseminated mineral. Better grade	1796	2.05	.08	
14.5	16.5	2	80	Sandy, red. Fair to good mineralization. U ₃ O ₈ indicated	1797	0.98	.03	.26
16.5	20	3.5	90	Bleached. Good mineralization	1798	0.73	.05	
20	22	2	90	Massive sulphides	1799	5.31	.76	
22	25	3	90	Massive sulphides	1800	4.61	.66	
25	26	1	90%	Bleached with rust seams. Very little mineral visible				
26	30	4	85%	Altered medium dark granodiorite with more greenish color				
30	42	12	70%	Bleached, highly weathered, soft with rust seams and some small quartz streaks.				
42	45	3	80	Granodiorite. Some rust seams				
45	47	2	90	Bleached with rust seams				
47	49.5	2.5	85	Medium dark granodiorite				
49.5	50.5	1	80	Bleached granodiorite				
50	51.5	1.5	70	Medium dark granodiorite				
51.5	57	5.5	60%	Bleached. Highly weathered. Very soft. Rust seams. Some 1/4" quartz streaks				

Signed H. Shuttleworth

LOG OF DIAMOND DRILL HOLE No. 38

DATE: from August 7, 1957 to..... Location # 1 Level drift
 CO-ORDINATES: Northing..... Easting..... Elevation..... DD. 54. #1
 LENGTH..... BEARING..... 225° E. of N. INCLINATION..... Flat
 VERT. COMP..... HORIZ. COMP..... OBJECTIVE.....

FOOTAGE		WIDTH	RECOVERY	DESCRIPTION	SAMPLE NO.	CO %	AU Oz.	U ₂ O ₈ %
FROM	TO							
0	5.5	5.5	85%	Altered medium dark granidiorite				
5.5	6	0.5	90	Bleached, weathered granidiorite				
6	8.5	2.5	90	Massive sulphides, some small chloritic areas	1790B	2.78	.56	.17
8.5	11	2.5	90	Massive sulphides. Indications of U ₂ O ₈	1792B	2.75	.56	.19
11	16.5	5.5	90	Altered medium dark granidiorite 6" bleached at 11'				
16.5	18	1.5	90	Bleached, low mineralization				
18	19	1	90	Bleached, moderate mineralization	1793B	0.88	.28	
19	21.5	2.5	90	Massive Sulphides, very high-grade	1794B	6.07	.84	
21.5	50	28.5	85	Medium dark granidiorite, mottled light section 49-50'. Some small rust seams interspersed throughout				

Signed..... H. Shuttleworth.....

LOG OF DIAMOND DRILL HOLE No. 37

DATE: from August 6, 1957 to Location #1 Level drift
 CO-ORDINATES: Northing Easting Elevation 3057.71
 LENGTH 38' BEARING 210° E. of N. INCLINATION Flat
 VERT. COMP. HORIZ. COMP. OBJECTIVE

FOOTAGE		WIDTH	RECOVERY	DESCRIPTION	SAMPLE NO.	Co %	AU Oz.	U ₂ O ₃ %
FROM	TO							
0	1	1	90%	Bleached granidiorite, disseminated sulphides	1783B			
1	2.5	1.5	95	Medium dark altered granidiorite. No sulphides				
2.5	7	4.5	95%	Bleached granidiorite, disseminated sulphides	1784B		.03	
7	9.25	2.25	95%	Massive sulphides. Heavy arsenopyrite	1785B	2.90	.30	
9.25	10	0.75	95%	Bleached, disseminated mineralization medium grade	1786B	2.29	.005	
10	25.3	15.3	90	Light to medium dark diorite. Some alteration and rust seams $\frac{1}{8}$ " to $\frac{1}{2}$ " wide				
25.3	26.6	1.3	95	Bleached disseminated (low-grade) sulphides	1787B	0.64	.16	
26.6	30.	3.3	95	Massive sulphides	1788B	3.25	.92	
30	31	1	95	Bleached with some mineralization	1789B		.07	
31	32.5	1.5	95	Bleached, very little mineralization				
32.5	38	5.5	90	Medium dark mottled granidiorite. Some small rust seams and quartz fractures				

Signed H. Shuttleworth

NORTHERN GEM MINING CORPORATION LTD. (N.P.L.)

LOG OF DIAMOND DRILL HOLE No. 36

DATE: from August 5 to August 5 Location No. 1 Level Drift

CO-ORDINATES: Northing Easting Elevation

LENGTH ⁴⁵ 20 ft. BEARING 194° E. of N. INCLINATION flat

VERT. COMP. HORIZ. COMP. OBJECTIVE

FOOTAGE		WIDTH	RECOVERY	DESCRIPTION	SAMPLE No.	Co %	AU Oz.	U ₃ O ₈ %
FROM	TO							
0	4	4	90	Bleached diorite - Sulphides interspersed throughout in light to moderate quantity	1776B	0.35	.01	
4	7	3	90	Moderate sulphides in bleached diorite	1777B	0.35	.03	
7	10	3	90	Massive sulphides. Very heavy	1778B			
10	20	10	90	Light to med.-dark diorite. Slight alteration. Very little mineralization. Rust seams.				
				Deepened August 6th after #37 - hit second ore intersection.		?	?	
20	37	17	80	Granidiorite 1" red streak at 21'. Some rust seams. Little alteration or mineralization.				
37	38.5	1 1/2	80	Bleached diorite. No mineralization. Intersection corresponds with hole #37 @ 25-30'.				
38.5	45	6.5	75	Granidiorite. Little mineralization or alteration.				

Signed

John Hogarth

LOG OF DIAMOND DRILL HOLE No. 35

DATE: from August 5, 1957 to Aug. 5 Location No. 1 Level drift
 CO-ORDINATES: Northing Easting Elevation 325 #1
 LENGTH 20' BEARING 137° E. of N. INCLINATION Flat
 VERT. COMP. HORIZ. COMP. OBJECTIVE

FOOTAGE		WIDTH	RECOVERY	DESCRIPTION	SAMPLE NO.	CO %	AU Oz.	U ₂ O ₈ %
FROM	TO							
0	6	6	80	Bleached diorite. Sulphides inter-spersed throughout in light to moderate quantity	1773B	?	.10	
6	9	3	90	Massive sulphides. Very heavy.	1774B	3.43	.58	
9	10	1	90	Bleached diorite. Sulphides interspersed throughout ore in light to moderate quantity	1775B	0.67	.07	
10	15	5	90	Slightly altered diorite. Very little mineralization. Rust seams				
15	20	5	90	Medium dark diorite. Very little alteration. Rust seams.				

Signed John Hagarth

LOG OF DIAMOND DRILL HOLE No. 34 (Deepened)

DATE: from September 14, 1957 to..... Location #1 Level Dr.
 # 2 Drill Station
 CO-ORDINATES: Northing Easting..... Elevation.....
 LENGTH 45' - 95' BEARING..... INCLINATION.....
 VERT. COMP..... HORIZ. COMP..... OBJECTIVE.....

FOOTAGE		WIDTH	RECOVERY	DESCRIPTION	SAMPLE No.	Co %	AU Oz.	U ₃ O ₈ %
FROM	TO							
45	48½	3½	85	Altered medium dark diorite. 1" bleached at 46'				
48½	57	8½	"	Bleached carbonates. Rust seams at 48½' and 55'. 12" dark diorite at 54'.				
57	58½	1½	80	Bleached, rusty red in color. 3" heavy sulphides. U ₃ O ₈ indicated.	16788	1.94	0.10	0.32
58½	61	2½	80	Rusty red, not mineralized and no U ₃ O ₈				
61	95	34	75	Medium dark diorite, mottled in appearance. Some variations in texture and grain at 65'.				

Signed..... H. Shuttleworth

LOG OF DIAMOND DRILL HOLE No. 34

DATE: from August 4, 1957 to August 4 Location No. 1 level drift

CO-ORDINATES: Northing Easting..... Elevation.....

LENGTH 45' BEARING 210° E. of N. INCLINATION - 45°

VERT. COMP..... HORIZ. COMP..... OBJECTIVE.....

FOOTAGE		WIDTH	RECOVERY	DESCRIPTION	SAMPLE NO.	Co %	AU Oz.	U ₃ O ₈ %
FROM	TO					?		
5	6.5	1.5	80	Altered diorite. Color, brown. Some quartz and calcite				
6.5	9	2.5	80	Bleached diorite. Sulphides in small quantity dispersed throughout bleach. Many rust seams. Best ore at 7.5'.	1781B		.005	
9	10	1	90	Rust seam in altered diorite. Some pyrite mineralization				
10	11	1	90	Light to medium dark diorite. Slight alteration. Very little mineralization.				
11	16	5	90	Bleached diorite. Many rust seams. Some quartz filled fractures				
16	18	2	90	Light to medium dark diorite. Very little mineralization.				
18	20.5	2.5	90	Bleached diorite. Sulphides dispersed in small quantity throughout bleach. Best ore at 20'. Rust seams	1782B		.01	
20.5	26	5.5	90	Light to medium dark diorite. Very little mineralization. Many rust seams.				
26	27	1	90	Dark brown altered diorite. Rust. Very little mineralization.				
27	36	9	90%	Light to med. dark diorite. Some sections bleached. Many rust seams. Some quartz filled fractures.				
36	38.5	2.5	90	Brown colored highly altered diorite. Rusty. Crumbles easily.				
38.5	45	5.5	90	Light to med. dark diorite. Slight alteration. Very little mineralization.				

John Hogarth

Signed.....

