

521131

Silver Dream  
& Hill Billy  
103P 11W

**BRITISH COLUMBIA MINING RECEIPT**

Mining Division Skene

Issued at Vancouver No 140456 E

Date March 3, 19 80

RECEIVED from Jim McDonald

the sum of Eight Hundred and Eighty - Five Dollars,

in payment of Recording Silver (8 units) Silver #2 (8 units) Columbia  
(18 units) Glacier # 2 (18 units) Glacier # 1 (20 units) Glacier # 3 (8 units)

Glacier # 4 (18 units) Blacky (20 units); Long (8 units) Silver Crown  
(18 units) Silver Crown # 2 (20 units) Virginia (8 units) Virginia # 2  
(18 units) Situate vicinity Stewart B.C.

Signature Jan Lauer

\$ 1185<sup>00</sup>

Office SUB-RECORDER

SKERL #5  
12 UNITS  
2036(2)

SKERL #4  
9 UNITS  
2037(2)

ACE #1  
16 UNITS  
2031(2)

SKERL #1  
20 UNITS  
2032(2)

SKERL #3  
12 UNITS  
2034(2)

SKERL #2  
20 UNITS  
2033(2)

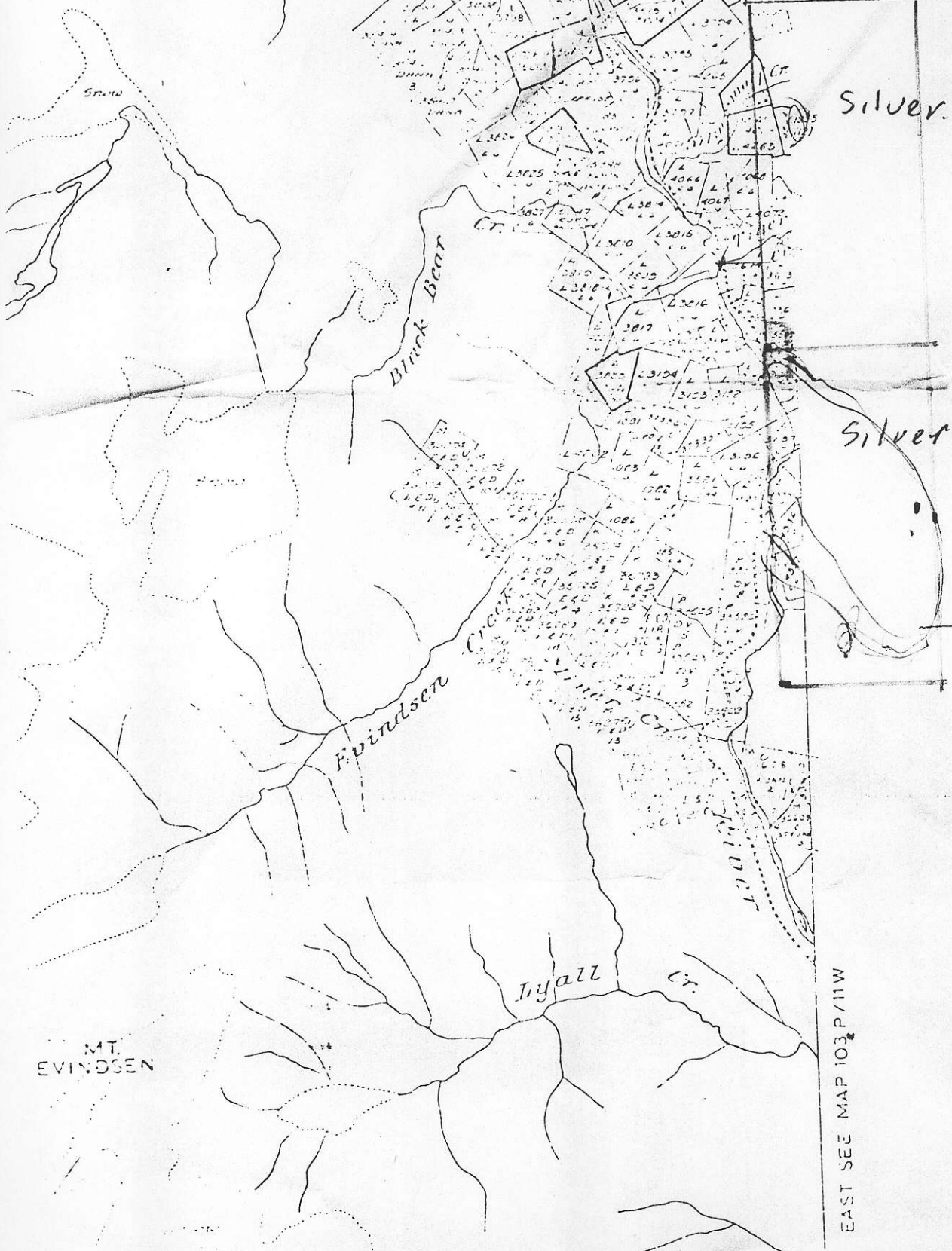

Silver

Silver #2

36

4

MT. EVINSON

MT. MAUDUC

EAST SEE MAP 103 P/11W

LEGEND  
CROWN GRANT  
REVEREND  
FORFEITED  
VENDOR  
LEGAL SURV  
LEGAL COR

Shanna 18 units

90 cu'

MINERAL ACT - PROVINCE OF BRITISH COLUMBIA

Record of Mineral Claim  
FORM G

MAP NO. 103P/12W RECORD NO. \_\_\_\_\_

MINING RECEIPT NO. \_\_\_\_\_ RECORDED AT \_\_\_\_\_ B.C. THIS \_\_\_\_\_ DAY OF \_\_\_\_\_ 19\_\_\_\_

DO NOT WRITE IN SHADED AREAS

Affidavit for Mineral Claim

I, James G. McDonald AGENT FOR \_\_\_\_\_  
PO #48444 Stn Bentall NAME  
VANCOUVER ADDRESS V7K 1A2 ADDRESS  
VALID SUBSISTING F.M.C. NO. 177675 VALID SUBSISTING F.M.C. NO. \_\_\_\_\_

MAKE OATH AND SAY: I COMMENCED LOCATING THE Silver MINERAL CLAIM

ON THE 24 DAY OF Feb 1980 AT 1:50 pm AND COMPLETED THE LOCATION

ON THE 24 DAY OF Feb 1980 AT 2:05 pm CONSISTING OF

6 UNIT LENGTHS North AND 3 UNIT LENGTHS EAST AND I HAVE IMPRESSED ALL THE REQUIRED INFORMATION

ON METAL TAGS NO. 51624 WHICH HAS BEEN SECURELY FASTENED TO THE POSTS AS REQUIRED UNDER THE REGULATIONS.

IDENTIFICATION POST(S) NOT PLACED WERE N1, N2, N3, N4, N5, N6, E1, E2, E3  
E3N1, E3N2, E3N3, E3N4, E3N5, E3N6, N6E1, N6E2

CHECK (IF) APPLICABLE SQUARE  THE LEGAL CORNER POST \_\_\_\_\_ } IS SITUATED 100 m  
 THE WITNESS POST FOR THE LEGAL CORNER POST \_\_\_\_\_

North of the Torbit Adit on the EAST BANK OF  
the Kitsault River. 300 m EAST 500 m SOUTH  
of the confluence of Tiger Cr & Kitsault River

† BEARING AND DISTANCE TO TRUE POSITION OF LEGAL CORNER POST FROM THE WITNESS POST \_\_\_\_\_  
BEARING AND DISTANCE FROM IDENTIFICATION POST TO WITNESS POST \_\_\_\_\_

I HAVE COMPLIED WITH ALL THE TERMS OF THE MINERAL ACT AND REGULATIONS PERTAINING TO THE STAKING OF MINERAL CLAIMS AND HAVE ATTACHED A PLAN, ACCEPTABLE TO THE MINING RECORDER, OF THE LOCATION

SWORN AND SUBSCRIBED TO AT \_\_\_\_\_  
THIS \_\_\_\_\_ DAY OF \_\_\_\_\_ 19\_\_\_\_ BEFORE ME

James G. McDonald  
SIGNATURE

SUB-RECORDER RECEIVED  
MAR 3 1980  
MR OR MRS STAMP

NO. OF UNITS \_\_\_\_\_ WORK REQUIREMENT \$ \_\_\_\_\_ PER YEAR RENTAL REQUIREMENT - \$10.00 PER \$200.00 WORK, \$20.00 PER \$200.00 C/L.

WORK NUMBERS	C/L IN \$	MINING RECEIPT AND DATE RECORDED	TYPE OF WORK	YEAR OF EXPIRY	CREDIT		TRANSFERS (B/S'S ASSIGNMENTS, CONVEYANCES)
					WORK UNIT(S)	RENTAL IN \$	





## MINERAL ACT - PROVINCE OF BRITISH COLUMBIA

### Record of Mineral Claim FORM G

MAP NO. 103 P/13 W RECORD NO. \_\_\_\_\_  
 MINING RECEIPT NO. \_\_\_\_\_ RECORDED AT \_\_\_\_\_ B.C. THIS \_\_\_\_\_ DAY OF \_\_\_\_\_ 19\_\_

DO NOT WRITE IN SHADED AREAS

Affidavit  
for  
Mineral  
Claim

I, JAMES G. McDONALD AGENT FOR \_\_\_\_\_  
PO # 48444 STN Bantall NAME \_\_\_\_\_  
VANCOUVER ADDRESS \_\_\_\_\_  
 VALID SUBSISTING F.M.C. NO. 177675 VALID SUBSISTING F.M.C. NO. \_\_\_\_\_

MAKE OATH AND SAY: I COMMENCED LOCATING THE BLACKY MINERAL CLAIM

ON THE 25 DAY OF Feb 1980 AT 10:30 am AND COMPLETED THE LOCATION

ON THE 25 DAY OF Feb 1980 AT 10:45 am CONSISTING OF

4 UNIT LENGTHS SOUTH AND 5 UNIT LENGTHS EAST AND I HAVE IMPRESSED ALL THE REQUIRED INFORMATION

ON METAL TAGS NO. 51671 WHICH HAS BEEN SECURELY FASTENED TO THE POSTS AS REQUIRED UNDER THE REGULATIONS

IDENTIFICATION POST(S) NOT PLACED WERE S1, S2, S3, S4, E1, E2, E3, E4, E5, E5 S1, E5 S2, E5 S3, E5 S4, S4 E1, S4 E2, S4 E3, S4 E4

CHECK "X" APPLICABLE SQUARE  THE LEGAL CORNER POST IS SITUATED: 1700 m  
 THE WITNESS POST FOR THE LEGAL CORNER POST  
North 4.10 km EAST OF STEWART (PO)

BEARING AND DISTANCE TO TRUE POSITION OF LEGAL CORNER POST FROM THE WITNESS POST \_\_\_\_\_  
 BEARING AND DISTANCE FROM IDENTIFICATION POST TO WITNESS POST \_\_\_\_\_

I HAVE COMPLIED WITH ALL THE TERMS OF THE MINERAL ACT AND REGULATIONS PERTAINING TO THE STAKING OF MINERAL CLAIMS AND HAVE ATTACHED A PLAN, ACCEPTABLE TO THE MINING RECORDER, OF THE LOCATION

SWORN AND SUBSCRIBED TO AT \_\_\_\_\_  
 THIS \_\_\_\_\_ DAY OF \_\_\_\_\_ 19\_\_ BEFORE ME

*James G. McDonald*  
SIGNATURE

**SUB-RECORDER  
RECEIVED**  
**MAR 5 1980**  
 M.R. # ..... S .....  
**VANCOUVER B.C.**  
 MINOR SURVEY STAMP

NO. OF UNITS \_\_\_\_\_ WORK REQUIREMENT \$ \_\_\_\_\_ PER YEAR RENTAL REQUIREMENT - \$10.00 PER \$200.00 WORK, \$20.00 PER \$200.00 C/L.

WORK NUMBERS	C/L IN \$	MINING RECEIPT AND DATE RECORDED	TYPE OF WORK	YEAR OF EXPIRY	CREDIT		TRANSFERS (B.S.S. ASSIGNMENTS, CONVEYANCES)
					WORK UNITS	RENTAL IN \$	



7500

Alena 15 units

MINERAL ACT - PROVINCE OF BRITISH COLUMBIA

Record of Mineral Claim FORM G

MAP NO. 103P/13W

RECORD NO. \_\_\_\_\_

MINING RECEIPT NO. \_\_\_\_\_ RECORDED AT \_\_\_\_\_ B.C. THIS \_\_\_\_\_ DAY OF \_\_\_\_\_ 19 \_\_\_\_\_

DO NOT WRITE IN SHADED AREAS

MINING RECORDER

MINING DIVISION

Affidavit for Mineral Claim

JAMES G. McDONALD AGENT FOR PO# 48444 5th Bentall VANCOUVER V7Z 1P2 VALID SUBSISTING F.M.C. NO. 177675

MAKE OATH AND SAY: I COMMENCED LOCATING THE Glacier #4 MINERAL CLAIM

ON THE 24 DAY OF Feb 1980 AT 12:00 noon AND COMPLETED THE LOCATION ON THE 24 DAY OF Feb 1980 AT 12:30 pm CONSISTING OF 5 UNIT LENGTHS North AND 3 UNIT LENGTHS WEST

ON METAL TAGS NO 16436 WHICH HAS BEEN SECURELY FASTENED TO THE POSTS AS REQUIRED UNDER THE REGULATIONS.

IDENTIFICATION POSTS NOT PLACED WERE N1, N2, N3, N4, N5, N6, W1, W2, W3, W3N1, W3N2, W3N3, W3N4, W3N5, W3N6, N6W1, N6W2

CHECK IF APPLICABLE SQUARE THE LEGAL CORNER POST IS SITUATED: on the SOUTH BANK OF THE NORTH FORK OF Glacier Creek & 100 m EAST OF THE NORTH-SOUTH FORK JUNCTION

BEARING AND DISTANCE TO TRUE POSITION OF LEGAL CORNER POST FROM THE WITNESS POST BEARING AND DISTANCE FROM IDENTIFICATION POST TO WITNESS POST

I HAVE COMPLIED WITH ALL THE TERMS OF THE MINERAL ACT AND REGULATIONS PERTAINING TO THE STAKING OF MINERAL CLAIMS AND HAVE ATTACHED A PLAN, ACCEPTABLE TO THE MINING RECORDER, OF THE LOCATION

SWORN AND SUBSCRIBED TO AT THIS DAY OF 19 BEFORE ME

James G. McDonald SIGNATURE

SUB-RECORDED RECEIVED MAR 3 1980 M.R.# S VANCOUVER, B.C. MR OR SMR STAMP

NO OF UNITS WORK REQUIREMENT \$ PER YEAR RENTAL REQUIREMENT \$10.00 PER \$200.00 WORK \$20.00 PER \$200.00 C/L

Table with columns: WORK NUMBERS, C/L IN \$, MINING RECEIPT AND DATE RECORDED, TYPE OF WORK, YEAR OF EXPIRY, CREDIT (WORK UNITS, RENTAL IN \$), TRANSFERS (B.S.S. ASSIGNMENTS, CONVEYANCES)



18 units skena

90.00

# MINERAL ACT - PROVINCE OF BRITISH COLUMBIA

## Record of Mineral Claim FORM G

MAP NO 103F/13W

RECORD NO. \_\_\_\_\_

MINING RECEIPT NO. \_\_\_\_\_ RECORDED AT \_\_\_\_\_ B.C. THIS \_\_\_\_\_ DAY OF \_\_\_\_\_ 19 \_\_\_\_\_

DO NOT WRITE IN  
SHADED AREAS

Affidavit  
for  
Mineral  
Claim

James G. McDonald NAME AGENT FOR \_\_\_\_\_  
PO Box 444 Stn Bentall ADDRESS  
Vancouver ADDRESS VTX1A2  
VALID SUBSISTING F.M.C. NO. 177675

MAKE OATH AND SAY: I COMMENCED LOCATING THE Glacier #3 MINERAL CLAIM

ON THE 24 DAY OF Feb 1980 AT 12:00 Noon AND COMPLETED THE LOCATION  
(TIME INDICATE A.M. OR P.M.)

ON THE 24 DAY OF Feb 1980 AT 12:30 PM CONSISTING OF  
(TIME INDICATE A.M. OR P.M.)

6 UNIT LENGTHS SOUTH AND 3 UNIT LENGTHS WEST AND I HAVE IMPRESSED ALL THE REQUIRED INFORMATION  
(NUMBER) (DIRECTION) (NUMBER) (DIRECTION)

ON METAL TAGS NO. 16435 WHICH HAS BEEN SECURELY FASTENED TO THE POSTS AS REQUIRED UNDER THE REGULATIONS.

IDENTIFICATION POST(S) NOT PLACED WERE S1, S2, S3, S4, S5, S6, W1, W2, W3, W3S1, W3S2, W3S3, W3S4, W3S5, W3S6, S6W1, S6W2

CHECK  APPLICABLE SQUARE THE LEGAL CORNER POST } IS SITUATED: on The  
 THE WITNESS POST FOR THE LEGAL CORNER POST }

South Bank of The North Fork of Glacier Creek  
100 m EAST OF The North-south Fork Junction

† BEARING AND DISTANCE TO TRUE POSITION OF LEGAL CORNER POST FROM THE WITNESS POST \_\_\_\_\_  
BEARING AND DISTANCE FROM IDENTIFICATION POST TO WITNESS POST \_\_\_\_\_

I HAVE COMPLIED WITH ALL THE TERMS OF THE MINERAL ACT AND REGULATIONS PERTAINING TO THE STAKING OF MINERAL CLAIMS AND HAVE ATTACHED A PLAN, ACCEPTABLE TO THE MINING RECORDER, OF THE LOCATION.

SWORN AND SUBSCRIBED TO AT \_\_\_\_\_  
THIS \_\_\_\_\_ DAY OF \_\_\_\_\_ 19 \_\_\_\_\_ BEFORE ME

*[Signature]*  
SIGNATURE

SUB-RECORDER  
RECEIVED  
MAR 3 1980  
M.R. # ..... S .....  
VANCOUVER, B.C.  
MR. OR SMR STAMP

\* THIS AFFIDAVIT MAY BE TAKEN BY A PERSON EMPOWERED TO TAKE AFFIDAVITS BY THE EVIDENCE ACT OF BRITISH COLUMBIA.

NO. OF UNITS \_\_\_\_\_ WORK REQUIREMENT \$ \_\_\_\_\_ PER YEAR RENTAL REQUIREMENT - \$10.00 PER \$200.00 WORK, \$20.00 PER \$200.00 C/L.

WORK NUMBERS	C/L IN \$	MINING RECEIPT AND DATE RECORDED	TYPE OF WORK	YEAR OF EXPIRY	CREDIT		TRANSFERS (B/S S ASSIGNMENTS, CONVEYANCES)
					WORK UNITS	RENTAL IN \$	

ORIGINAL

18 units

Shenna

70.4

MINERAL ACT - PROVINCE OF BRITISH COLUMBIA  
Record of Mineral Claim  
FORM G

MAP NO. 103P/13W

RECORD NO. \_\_\_\_\_

MINING RECEIPT NO. \_\_\_\_\_ RECORDED AT \_\_\_\_\_ B.C. THIS \_\_\_\_\_ DAY OF \_\_\_\_\_ 19\_\_\_\_

DO NOT WRITE IN  
SHADED AREAS

MINING RECORDER

MINING DIVISION

Affidavit  
for  
Mineral  
Claim

I, James G. McDonald NAME AGENT FOR \_\_\_\_\_  
PO#48444 Stn Bentall NAME  
Vancouver ADDRESS \_\_\_\_\_  
VALID SUBSISTING F.M.C. NO. 177675 VALID SUBSISTING F.M.C. NO. \_\_\_\_\_

MAKE OATH AND SAY: I COMMENCED LOCATING THE Glacier #2 MINERAL CLAIM

ON THE 24 DAY OF Feb 1980 AT 12:00 noon AND COMPLETED THE LOCATION  
(TIME INDICATE A.M. OR P.M.)

ON THE 24 DAY OF Feb 1980 AT 12:30 pm CONSISTING OF  
(TIME INDICATE A.M. OR P.M.)

6 UNIT LENGTHS SOUTH AND 3 UNIT LENGTHS EAST AND I HAVE IMPRESSED ALL THE REQUIRED INFORMATION  
(NUMBER) (DIRECTION) (NUMBER) (DIRECTION)

ON METAL TAGS NO. 16434 WHICH HAS BEEN SECURELY FASTENED TO THE POSTS AS REQUIRED UNDER THE REGULATIONS.

IDENTIFICATION POST(S) NOT PLACED WERE S1, S2, S3, S4, S5, S6, E1, E2, E3, E3S1,  
E3S2, E3S3, E3S4, E3S5, E3S6, S6E1, S6E2

CHECK "V" APPLICABLE SQUARE  THE LEGAL CORNER POST  
 THE WITNESS POST FOR THE LEGAL CORNER POST } IS SITUATED: on the  
South bank of the North Fork of Glacier Cr 100m  
(PRECISELY DESCRIBE POSITION OF POST RELATIVE TO KNOWN TOPOGRAPHICAL OR SURVEYED FEATURES THAT RELATE TO FEATURES ON A MAP)  
EAST OF THE North-South Fork Junction

† BEARING AND DISTANCE TO TRUE POSITION OF LEGAL CORNER POST FROM THE WITNESS POST \_\_\_\_\_

BEARING AND DISTANCE FROM IDENTIFICATION POST TO WITNESS POST \_\_\_\_\_

I HAVE COMPLIED WITH ALL THE TERMS OF THE MINERAL ACT AND REGULATIONS PERTAINING TO THE STAKING OF MINERAL CLAIMS AND HAVE ATTACHED A PLAN, ACCEPTABLE TO THE MINING RECORDER, OF THE LOCATION.

SWORN AND SUBSCRIBED TO AT \_\_\_\_\_

THIS \_\_\_\_\_ DAY OF \_\_\_\_\_ 19\_\_\_\_ BEFORE ME

\* THIS AFFIDAVIT MAY BE TAKEN BY A PERSON EMPOWERED TO TAKE AFFIDAVITS BY THE EVIDENCE ACT OF BRITISH COLUMBIA

*James G. McDonald*  
SIGNATURE

SUB-RECORDER  
RECEIVED  
MAR 3 1980  
M.R. # \_\_\_\_\_ S \_\_\_\_\_  
VANCOUVER, B.C.  
MR OR SMR STAMP

NO. OF UNITS \_\_\_\_\_ WORK REQUIREMENT \$ \_\_\_\_\_ RENTAL REQUIREMENT - \$10.00 PER \$200.00 WORK \$20.00 PER \$200.00 C/L.

WORK NUMBERS	C/L IN \$	MINING RECEIPT AND DATE RECORDED	TYPE OF WORK	YEAR OF EXPIRY	CREDIT		TRANSFERS (B.S.S. ASSIGNMENTS, CONVEYANCES)
					WORK UNITS	RENTAL IN \$	

18 units - Speena

90.07

MINERAL ACT - PROVINCE OF BRITISH COLUMBIA

Record of Mineral Claim FORM G

MAP NO. 103 P/13 W

RECORD NO. \_\_\_\_\_

MINING RECEIPT NO. \_\_\_\_\_ RECORDED AT \_\_\_\_\_ B.C. THIS \_\_\_\_\_ DAY OF \_\_\_\_\_ 19 \_\_\_\_\_

DO NOT WRITE IN SHADED AREAS

MINING RECORDER

MINING DIVISION

Affidavit for Mineral Claim

I, JAMES G. McDONALD AGENT FOR  
PO BOX 444 STN Bentall  
VANCOUVER B.C. V7R 1T7

NAME \_\_\_\_\_

NAME

ADDRESS \_\_\_\_\_

VALID SUBSISTING F.M.C. NO. 177 675

VALID SUBSISTING F.M.C. NO. \_\_\_\_\_

MAKE OATH AND SAY: I COMMENCED LOCATING THE COLUMBIA MINERAL CLAIM

ON THE 25 DAY OF Feb 19 90 AT 10:50 am AND COMPLETED THE LOCATION

(TIME INDICATE A.M. OR P.M.)

ON THE 25 DAY OF Feb 19 90 AT 11:10 am CONSISTING OF

(TIME INDICATE A.M. OR P.M.)

6 UNIT LENGTHS NORTH AND 3 UNIT LENGTHS EAST AND I HAVE IMPRESSED ALL THE REQUIRED INFORMATION

(DIRECTION)

(NUMBER)

(DIRECTION)

ON METAL TAGS NO 51676 WHICH HAS BEEN SECURELY FASTENED TO THE POSTS AS REQUIRED UNDER THE REGULATIONS.

IDENTIFICATION POST(S) NOT PLACED WERE N1, N2, N3, N4, N5, N6, E1, E2, E3, E3N1, E3N2, E3N3, E3N4, E3N5, E3N6, N6E1, N6E2

CHECK "V" APPLICABLE SQUARE



THE LEGAL CORNER POST



THE WITNESS POST FOR THE LEGAL CORNER POST

IS SITUATED:

EAST of 1 km SOUTH OF THE confluence of The Bear River & Glacier of

(PRECISELY DESCRIBE POSITION OF POST RELATIVE TO KNOWN TOPOGRAPHICAL OR SURVEYED FEATURES THAT RELATE TO FEATURES ON A MAP)

BEARING AND DISTANCE TO TRUE POSITION OF LEGAL CORNER POST FROM THE WITNESS POST

BEARING AND DISTANCE FROM IDENTIFICATION POST TO WITNESS POST

I HAVE COMPLIED WITH ALL THE TERMS OF THE MINERAL ACT AND REGULATIONS PERTAINING TO THE STAKING OF MINERAL CLAIMS AND HAVE ATTACHED A PLAN, ACCEPTABLE TO THE MINING RECORDER, OF THE LOCATION

SWORN AND SUBSCRIBED TO AT \_\_\_\_\_

THIS \_\_\_\_\_ DAY OF \_\_\_\_\_ 19 \_\_\_\_\_ BEFORE ME

J. McDonald SIGNATURE

\* THIS AFFIDAVIT MAY BE TAKEN BY A PERSON EMPOWERED TO TAKE AFFIDAVITS BY THE EVIDENCE ACT OF BRITISH COLUMBIA

SUB-RECORDER RECEIVED MAR 3 1980 M.R. # \_\_\_\_\_ S \_\_\_\_\_ VANCOUVER B.C.

NO OF UNITS \_\_\_\_\_ WORK REQUIREMENT \$ \_\_\_\_\_ PER YEAR RENTAL REQUIREMENT - \$10.00 PER \$200.00 WORK. \$20.00 PER \$200.00 C/L.

Table with columns: WORK NUMBERS, C/L IN \$, MINING RECEIPT AND DATE RECORDED, TYPE OF WORK, YEAR OF EXPIRY, CREDIT (WORK UNITS, RENTAL IN \$), TRANSFERS (B/S, ASSIGNMENTS, CONVEYANCES)

M 103P/13W

56°00' 130°00'

A B C D

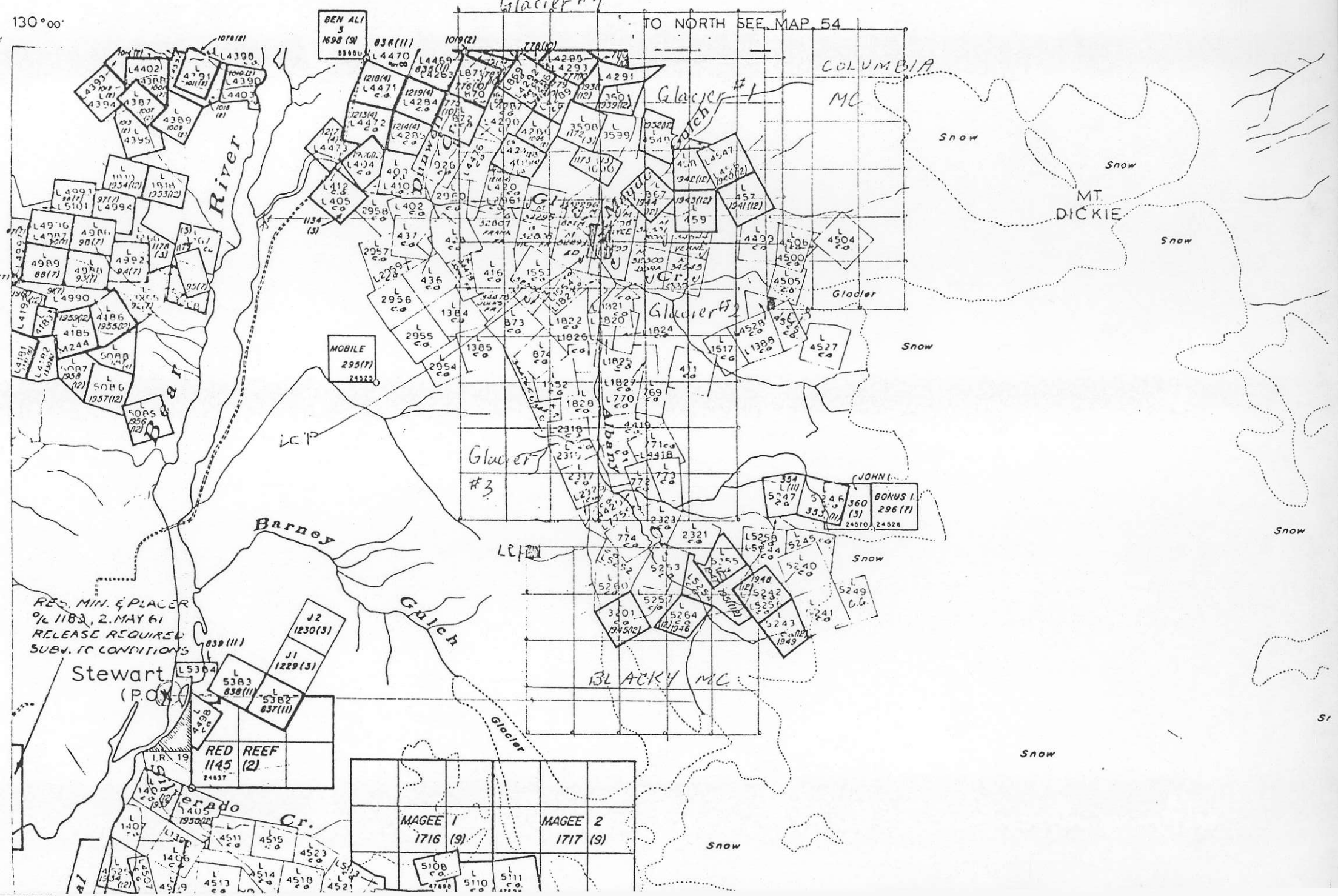

6

5

M.104A/4W

GLACIER

SNOW

Ice Falls

FORKS

Silver Divide Crown

Silver Crown #2

Basin

Bydler Ct.

MT BURTING

LONG

S I L V E R D I V I D E

A M U R I C

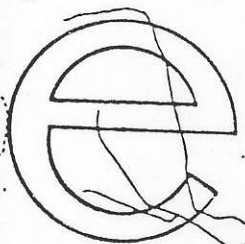

TO WEST SEE MAP 104 B/1

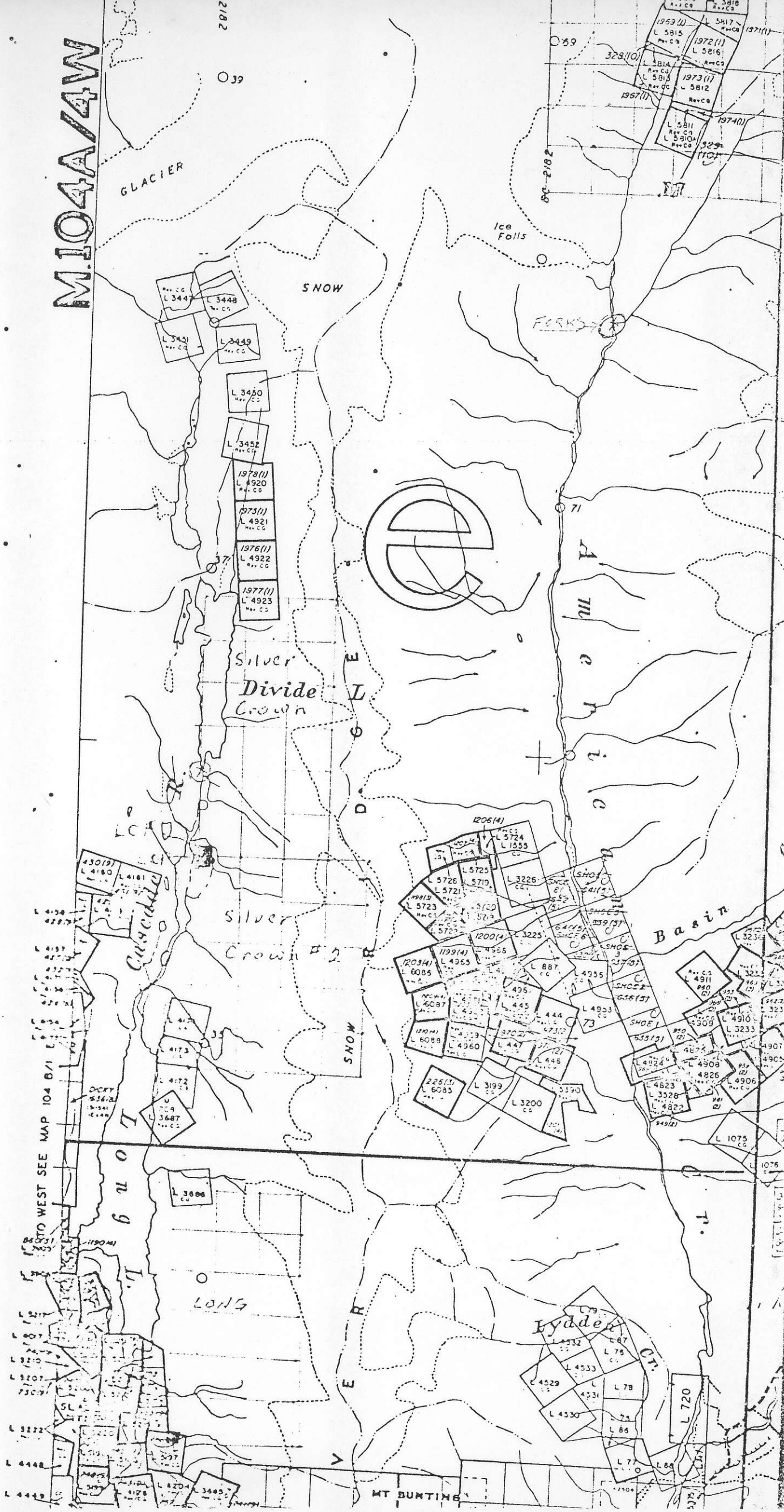





18 units Shumona

90.00

MINERAL ACT - PROVINCE OF BRITISH COLUMBIA

Record of Mineral Claim FORM G

MAP NO: 104 A/4W

RECORD NO. \_\_\_\_\_

MINING RECEIPT NO. \_\_\_\_\_ RECORDED AT \_\_\_\_\_ B.C. THIS \_\_\_\_\_ DAY OF \_\_\_\_\_ 19 \_\_\_\_\_

DO NOT WRITE IN SHADED AREAS

MINING RECORDER

MINING DIVISION

Affidavit for Mineral Claim

James G. McDonald AGENT FOR  
PO#4844 37th Bentall  
VANCOUVER B.C. V7X 1A2

NAME

ADDRESS

VALID SUBSISTING F.M.C. NO. 177675

VALID SUBSISTING F.M.C. NO. \_\_\_\_\_

MAKE OATH AND SAY: I COMMENCED LOCATING THE Silver Crown MINERAL CLAIM

ON THE 24 DAY OF Feb 1980 AT 10:15 am AND COMPLETED THE LOCATION

ON THE 24 DAY OF Feb 19 80 AT 10:40 am CONSISTING OF

6 UNIT LENGTHS North AND 3 UNIT LENGTHS EAST AND I HAVE IMPRESSED ALL THE REQUIRED INFORMATION

ON METAL TAGS NO 16428 WHICH HAS BEEN SECURELY FASTENED TO THE POSTS AS REQUIRED UNDER THE REGULATIONS

IDENTIFICATION POSTS NOT PLACED WERE N1, N2, N3, N4, N5, N6, E1, E2, E3, NE1, E3N1, E3N2, E3N3, E3N4, E3N5, E3N6, NE1, N6E2

CHECK  APPLICABLE SQUARE THE LEGAL CORNER POST IS SITUATED: 1 km  
 THE WITNESS POST FOR THE LEGAL CORNER POST  
due SOUTH OF THE SOUTH END OF DIVIDE LAKE

BEARING AND DISTANCE TO TRUE POSITION OF LEGAL CORNER POST FROM THE WITNESS POST

BEARING AND DISTANCE FROM IDENTIFICATION POST TO WITNESS POST

I HAVE COMPLIED WITH ALL THE TERMS OF THE MINERAL ACT AND REGULATIONS PERTAINING TO THE STAKING OF MINERAL CLAIMS AND HAVE ATTACHED A PLAN, ACCEPTABLE TO THE MINING RECORDER, OF THE LOCATION.

SWORN AND SUBSCRIBED TO AT \_\_\_\_\_

THIS \_\_\_\_\_ DAY OF \_\_\_\_\_ 19 \_\_\_\_\_ BEFORE ME

James McDonald SIGNATURE

M.R. # \_\_\_\_\_ S \_\_\_\_\_

\* THIS AFFIDAVIT MAY BE TAKEN BY A PERSON EMPOWERED TO TAKE AFFIDAVITS BY THE EVIDENCE ACT OF BRITISH COLUMBIA

SUB-RECORDED RECEIVED MAR 3 1980 VANCOUVER B.C.

NO. OF UNITS \_\_\_\_\_ WORK REQUIREMENT \$ \_\_\_\_\_ PER YEAR RENTAL REQUIREMENT - \$10.00 PER \$200.00 WORK, \$20.00 PER \$200.00 C/L.

Table with columns: WORK NUMBERS, C/L IN \$, MINING RECEIPT AND DATE RECORDED, TYPE OF WORK, YEAR OF EXPIRY, CREDIT (WORK UNITS, RENTAL IN \$), TRANSFERS (B.C.S. ASSIGNMENTS, CONVEYANCES)







M104A/4W

GLACIER

SNOW

Ice Falls

FERRIS

A  
m  
e  
r  
i  
c  
a

Silver  
Divide  
Crown

Silver  
Crown #2

Basin

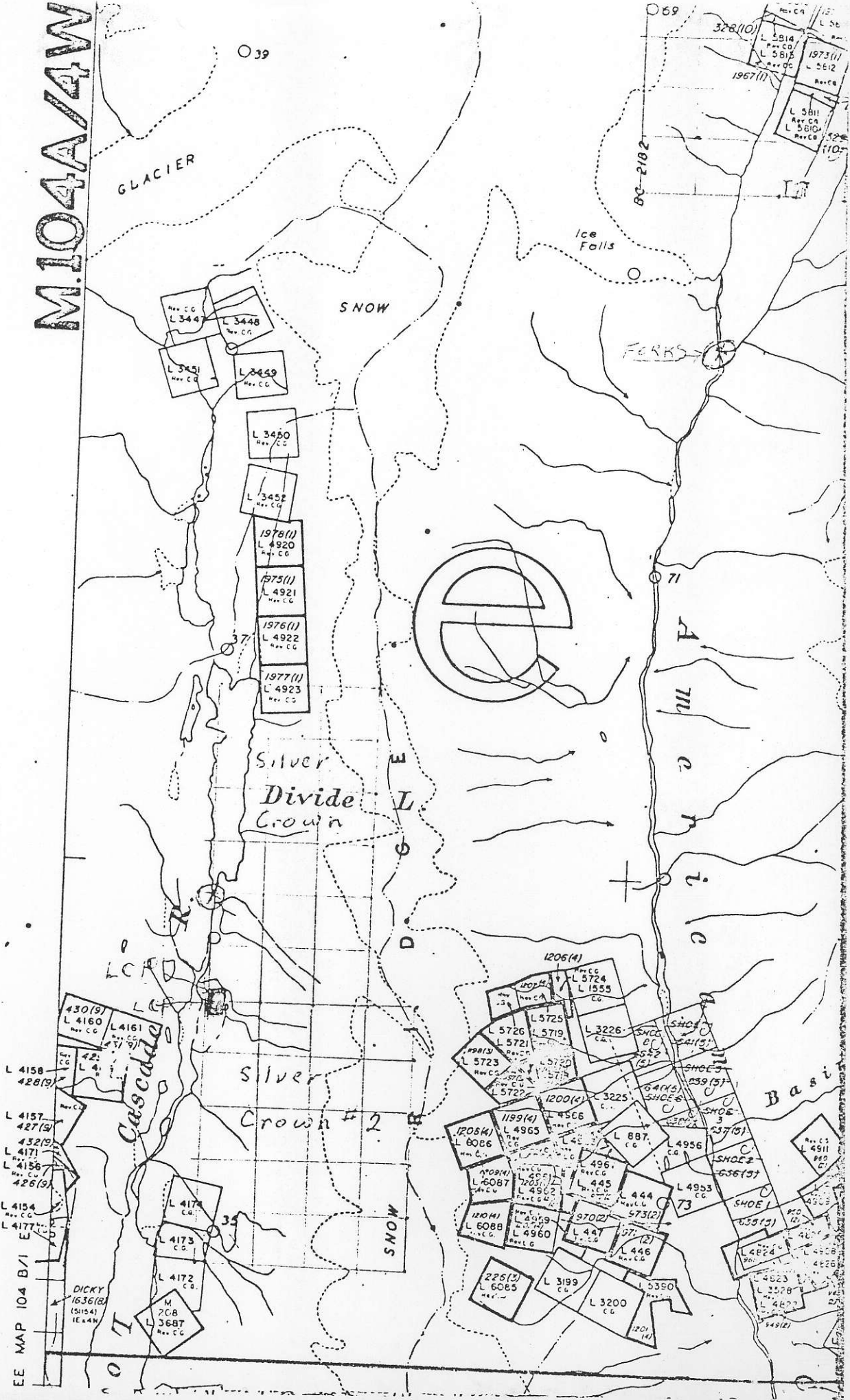

EE MAP 104 B/1 E

L 4158  
428(9)

L 4157  
427(9)

L 432(9)

L 4171

L 4156  
426(9)

L 4154

L 4177

DICKY  
1636(B)  
(52154)  
1E4W

L 4174  
CG

L 4173  
CG

L 4172  
CG

M  
70B  
L 3687  
Rev. CG

1206(A)

L 5726 L 5719 L 3226

L 5721 L 5720 L 5722

L 5723 L 5724 L 1555

1200(K) 3225

1189(A) 4566

L 6086 L 4965

L 6087 L 4962

L 6088 L 4960

L 445 L 444

L 447 L 446

L 3199 L 3200

L 4956 L 4953

L 887 L 4955

L 444 L 445

L 446 L 447

L 448 L 449

L 450 L 451

L 452 L 453

L 454 L 455

L 456 L 457

L 458 L 459

L 460 L 461

L 462 L 463

L 464 L 465

L 466 L 467

L 468 L 469

L 470 L 471

L 472 L 473

L 474 L 475

L 476 L 477

L 478 L 479

L 480 L 481

L 482 L 483

L 484 L 485

L 486 L 487

L 488 L 489

L 490 L 491

L 492 L 493

L 494 L 495

L 496 L 497

L 498 L 499

L 500 L 501

L 502 L 503

L 504 L 505

L 506 L 507

L 508 L 509

L 510 L 511

L 512 L 513

L 514 L 515

L 516 L 517

L 518 L 519

L 520 L 521

L 522 L 523

L 524 L 525

L 526 L 527

L 528 L 529

L 530 L 531

L 532 L 533

L 534 L 535

L 536 L 537

L 538 L 539

L 540 L 541

L 542 L 543

L 544 L 545

L 546 L 547

L 548 L 549

L 550 L 551

L 552 L 553

L 554 L 555

L 556 L 557

L 558 L 559

L 560 L 561

L 562 L 563

L 564 L 565

L 566 L 567

L 568 L 569

L 570 L 571

L 572 L 573

L 574 L 575

L 576 L 577

L 578 L 579

L 580 L 581

L 582 L 583

L 584 L 585

L 586 L 587

L 588 L 589

L 590 L 591

L 592 L 593

L 594 L 595

L 596 L 597

L 598 L 599

L 600 L 601

L 602 L 603

L 604 L 605

L 606 L 607

L 608 L 609

L 610 L 611

L 612 L 613

L 614 L 615

L 616 L 617

L 618 L 619

L 620 L 621

L 622 L 623

L 624 L 625

L 626 L 627

L 628 L 629

L 630 L 631

L 632 L 633

L 634 L 635

L 636 L 637

L 638 L 639

L 640 L 641

L 642 L 643

L 644 L 645

L 646 L 647

L 648 L 649

L 650 L 651

L 652 L 653

L 654 L 655

L 656 L 657

L 658 L 659

L 660 L 661

L 662 L 663

L 664 L 665

L 666 L 667

L 668 L 669

L 670 L 671

L 672 L 673

L 674 L 675

L 676 L 677

L 678 L 679

L 680 L 681

L 682 L 683

L 684 L 685

L 686 L 687

L 688 L 689

L 690 L 691

L 692 L 693

L 694 L 695

L 696 L 697

L 698 L 699

L 700 L 701

L 702 L 703

L 704 L 705

L 706 L 707

L 708 L 709

L 710 L 711

L 712 L 713

L 714 L 715

L 716 L 717

L 718 L 719

L 720 L 721

L 722 L 723

L 724 L 725

L 726 L 727

L 728 L 729

L 730 L 731

L 732 L 733

L 734 L 735

L 736 L 737

L 738 L 739

L 740 L 741

L 742 L 743

L 744 L 745

L 746 L 747

L 748 L 749

L 750 L 751

L 752 L 753

L 754 L 755

L 756 L 757

L 758 L 759

L 760 L 761

L 762 L 763

L 764 L 765

L 766 L 767

L 768 L 769

L 770 L 771

L 772 L 773

L 774 L 775

L 776 L 777

L 778 L 779

L 780 L 781

L 782 L 783

L 784 L 785

L 786 L 787

L 788 L 789

L 790 L 791

L 792 L 793

L 794 L 795

L 796 L 797

L 798 L 799

L 800 L 801

L 802 L 803

L 804 L 805

L 806 L 807

L 808 L 809

L 810 L 811

L 812 L 813

L 814 L 815

L 816 L 817

L 818 L 819

L 820 L 821

L 822 L 823

L 824 L 825

L 826 L 827

L 828 L 829

L 830 L 831

L 832 L 833

L 834 L 835

L 836 L 837

L 838 L 839

L 840 L 841

L 842 L 843

L 844 L 845

L 846 L 847

L 848 L 849

L 850 L 851

L 852 L 853

L 854 L 855

L 856 L 857

L 858 L 859

L 860 L 861

L 862 L 863

L 864 L 865

L 866 L 867

L 868 L 869

L 870 L 871

L 872 L 873

L 874 L 875

L 876 L 877

L 878 L 879

L 880 L 881

L 882 L 883

L 884 L 885

L 886 L 887

L 888 L 889

L 890 L 891

L 892 L 893

L 894 L 895

L 896 L 897

L 898 L 899

L 900 L 901

L 902 L 903

L 904 L 905

L 906 L 907

L 908 L 909

L 910 L 911

L 912 L 913

L 914 L 915

L 916 L 917

L 918 L 919

L 920 L 921

L 922 L 923

L 924 L 925

L 926 L 927

L 928 L 929

L 930 L 931

L 932 L 933

L 934 L 935

L 936 L 937

L 938 L 939

L 940 L 941

L 942 L 943

L 944 L 945

L 946 L 947

L 948 L 949

L 950 L 951

L 952 L 953

L 954 L 955

L 956 L 957

L 958 L 959

L 960 L 961

L 962 L 963

L 964 L 965

L 966 L 967

L 968 L 969

L 970 L 971

L 972 L 973

L 974 L 975

L 976 L 977

L 978 L 979

L 980 L 981

L 982 L 983

L 984 L 985

L 986 L 987

L 988 L 989

L 990 L 991

L 992 L 993

L 994 L 995

L 996 L 997

L 998 L 999

L 1000 L 1001