

Longbar Minerals

PROJECT No.: Recce

GEOCHEMICAL ANALYSIS DATA SHEET

MIN - EN Laboratories Ltd.

705 WEST 15th ST., NORTH VANCOUVER, B.C. V7M 1T2
PHONE (604) 980-5814

FILE No. 4517

DATE: Sept. 1977.

SPANISH
MT 520701

ATTENTION:

Sample Number	Mo ppm	Cu ppm	Pb ppm	Zn ppm	Ni ppm	Co ppm	Ag ppm	Fe ppm	Hg ppb	As ppm	Mn ppm	Au ppb			
81	86	90	95	100	105	110	115	120	125	130	135	140	145	150	155
RM 1								•				145			
2								•				160			
3								•				460	<i>0/65 gr.</i>		
4								•				67.00			
5								•				85			
6								•				50			
7								•				5			
8								•				25			
9								•				55			
10								•				40			
11								•				25			
12								•				15			
13								•				5			
14								•				20			
15								•				380.0			
16								•				145			
17								•				195			
18								•				65			
19								•				1680			
20								•				645			
21								•				90			
22								•				5200			
23								•				200			
24								•				670			
25								•				85			
26								•				190			
27								•				40			
28								•				3475			
29								•				15			
RM 30								•				80			

CERTIFIED BY *[Signature]*



PESO CK.

AUG 25 / 77

SPANISH MOUNTAIN

LIKELY REEM

1-18 300' SOILS SPACING

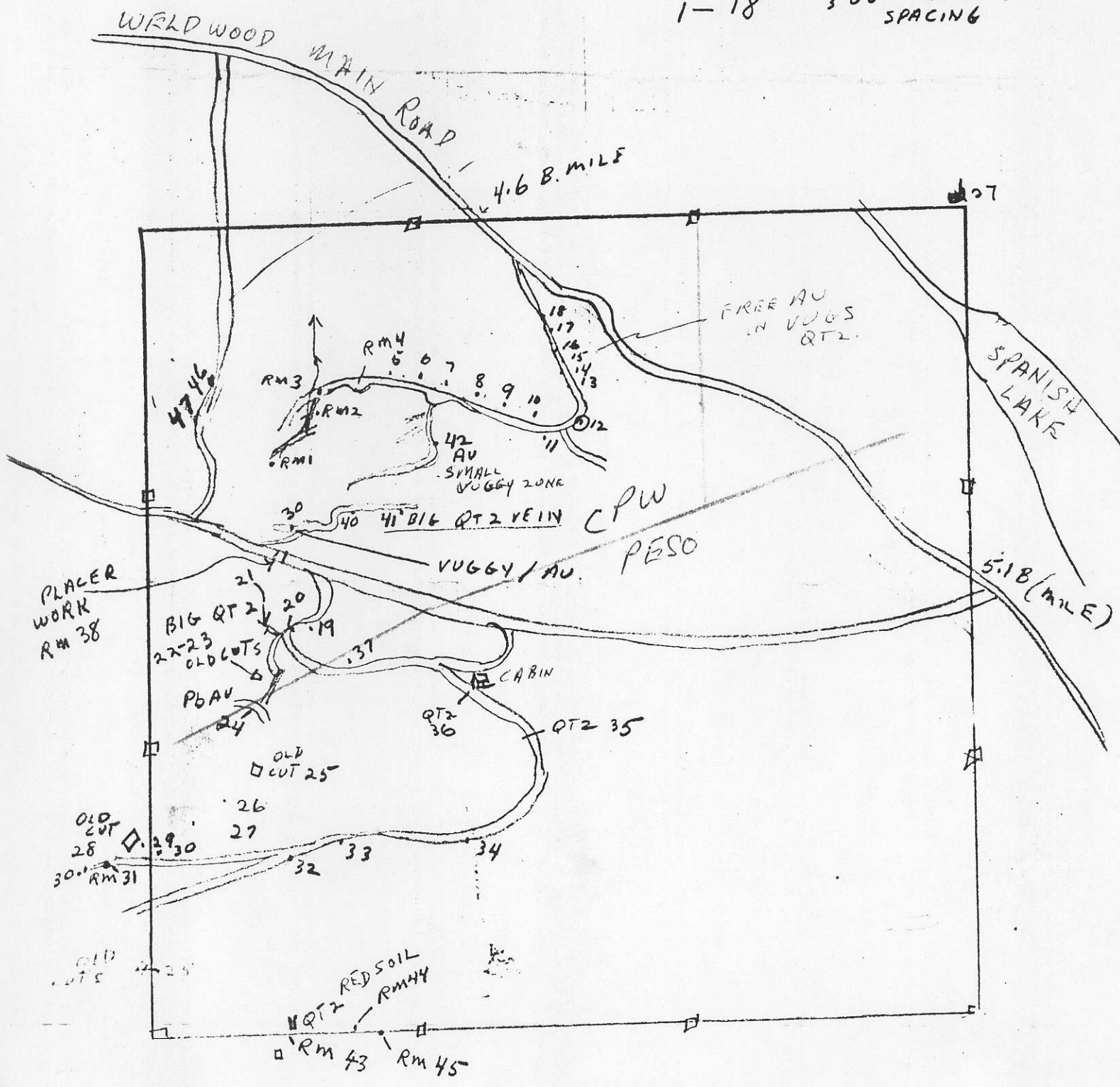

RE / LONG BAR MIN
FIL 4517 SEPT 1/77

GREEN LINE SHOWS RESULTS
ON CPW - PESO
MICKEY MOUSE MAP

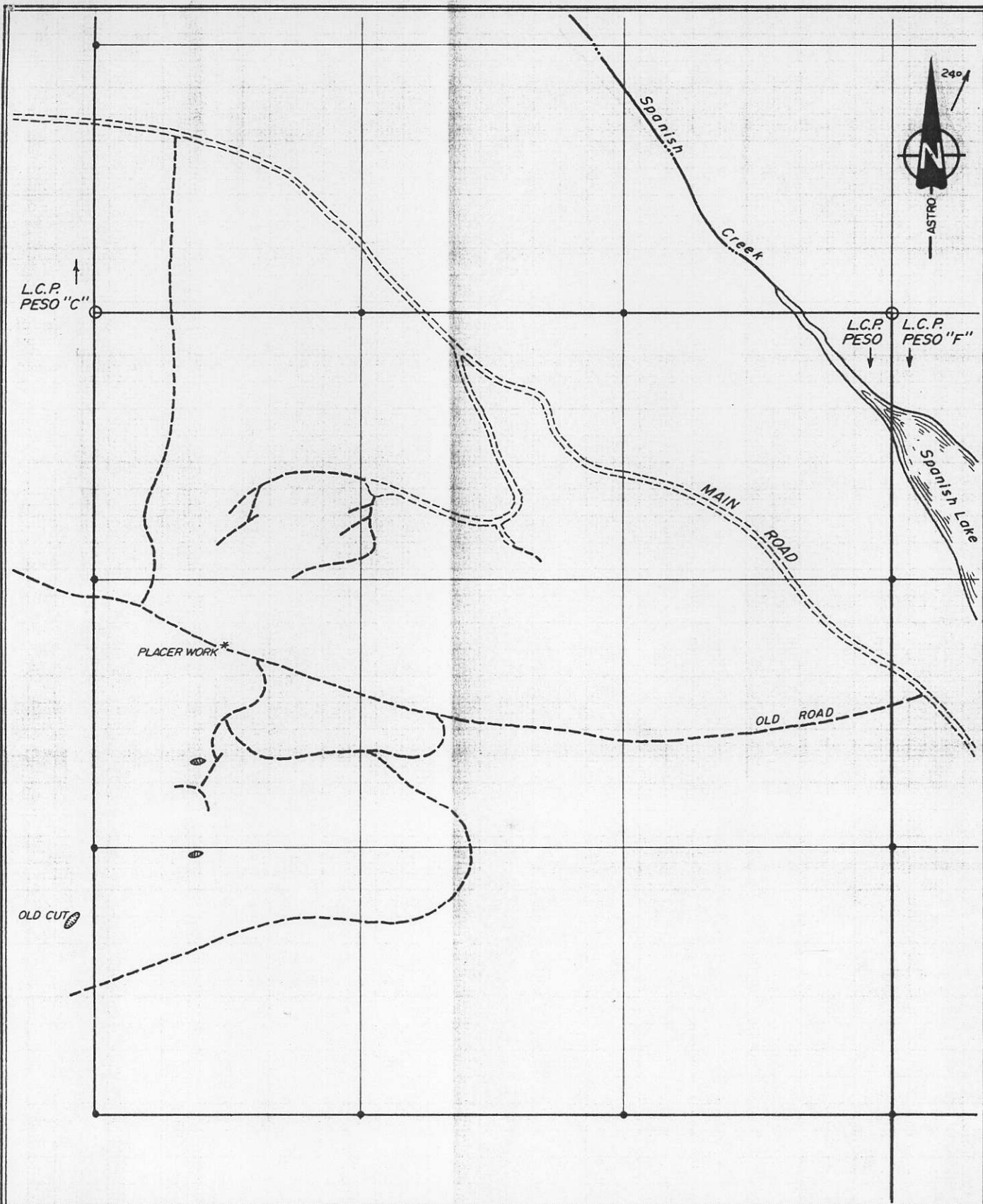

LONGBAR MINERALS LTD.

Peso Claims Spanish Mtn. near Likely, B.C.
 N.T.S. 93A/11&12. Cariboo Mining Division

PESO CLAIM

FIGURE

Scale: 1:10,000 Base map from sketch map by R.E.M., Aug. '77

0 100 200 300 400 500m

B.A.C., Oct. '77