

CHRISTOPHER G. BALDWIN

LAWSON, LUNDELL, LAWSON & MCINTOSH
BARRISTERS AND SOLICITORS

2800 VANCOUVER CENTRE
P.O. BOX 11506
650 WEST GEORGIA STREET
VANCOUVER, B.C., CANADA
V6B 4R7

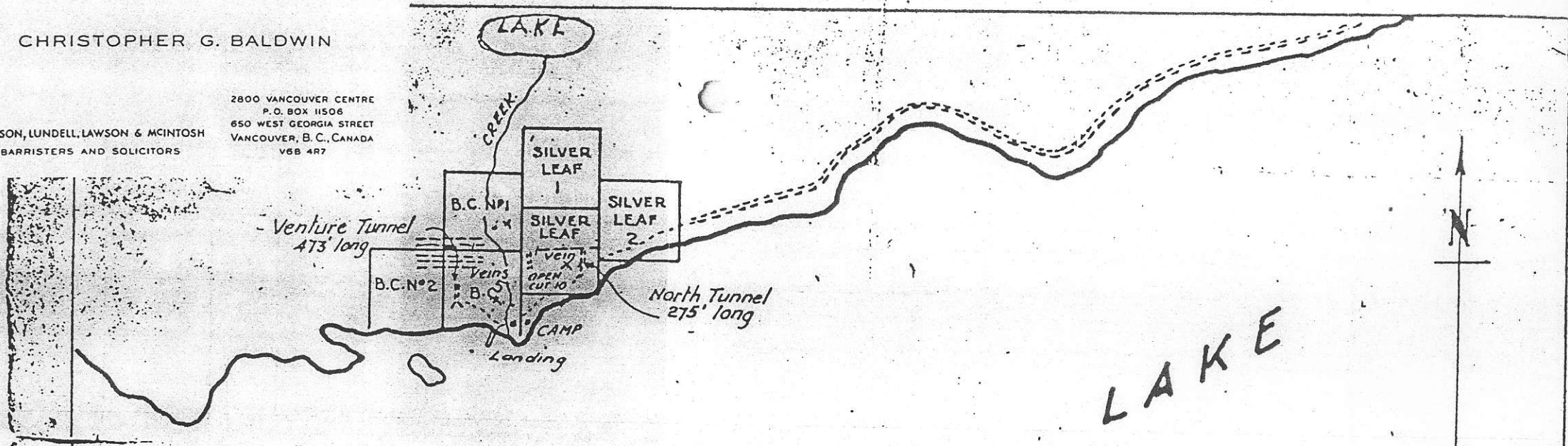

BABINE

OPEN CUTS MADE IN 1935.

N°1	16' x 7' x 5'
2	14' x 4' x 8'
3	30' x 6' x 10'
4	20' x 10' x 5'
5	35' x 6' x 4'
6	18' x 6' x 4'
7	10' x 4' x 7'
8	7' x 4' x 4'
9	20' x 5' x 7'
10	8' x 8' x 4'

WORK DONE ON ISLAND

OPEN CUTS 4 to 9 incl.
N°1 TUNNEL WITH SHAFT 219'
CROSS CUTS 40' & 20'
N°2 TUNNEL WITH WINTER 203'

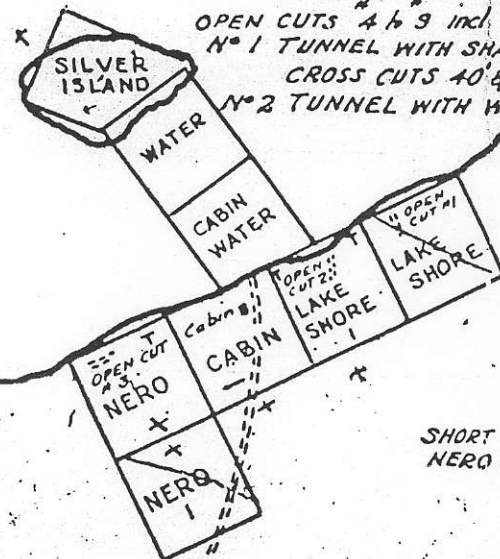

SHORT TUNNELS ON NERO & LAKE SHORE #1

Silver Island
92K/6W 520373