

6 93K/6W

Arg.  
Mora - Aug. 28/1975  
N. Campbell  
2706-1011 Beach Ave.  
Vancouver, B.C.  
- paid 1/2 each yr - paid to '84

Silver - Oct. 7/82  
1, 2, 3  
Ducne Poliquin  
16840-26 Ave.  
Surrey, B.C.

Mineral Revenue  
387-6991  
Victoria

L-6285 - \$1189 taxes  
paid by Barbara Wolfe  
2642 Westlake Rd.  
Saanichton, Redmond  
Washington



TO WEST SEE MAP 93 K/5 E

TO EAST SEE MAP 93 K/6 E

3  
2

LEGEND  
BURN-DATED MINERAL CLAIM  
BURN-UNDATED MINERAL CLAIM  
FORFEITED MINERAL CLAIM  
VERIFIED LEGAL CORNER POST  
LEGAL SURVEY  
LEGAL CORNER POST & TAG NUMBER 0350

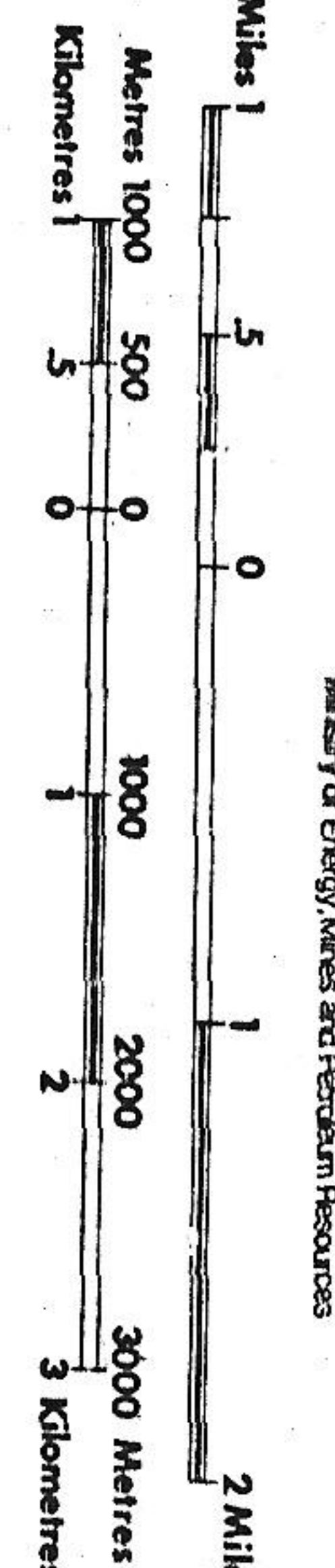

UNLESS VERIFIED OR SURVEYED, THE MAP POSITION OF A LEGAL CORNER POST IS BASED ON THE LOCATOR'S SKETCH FOR FURTHER INFORMATION, APPLY TO THE OFFICE OF THE MINING DIVISION CONCERNED.  
DATE OF MICROFILM: 83-03-17

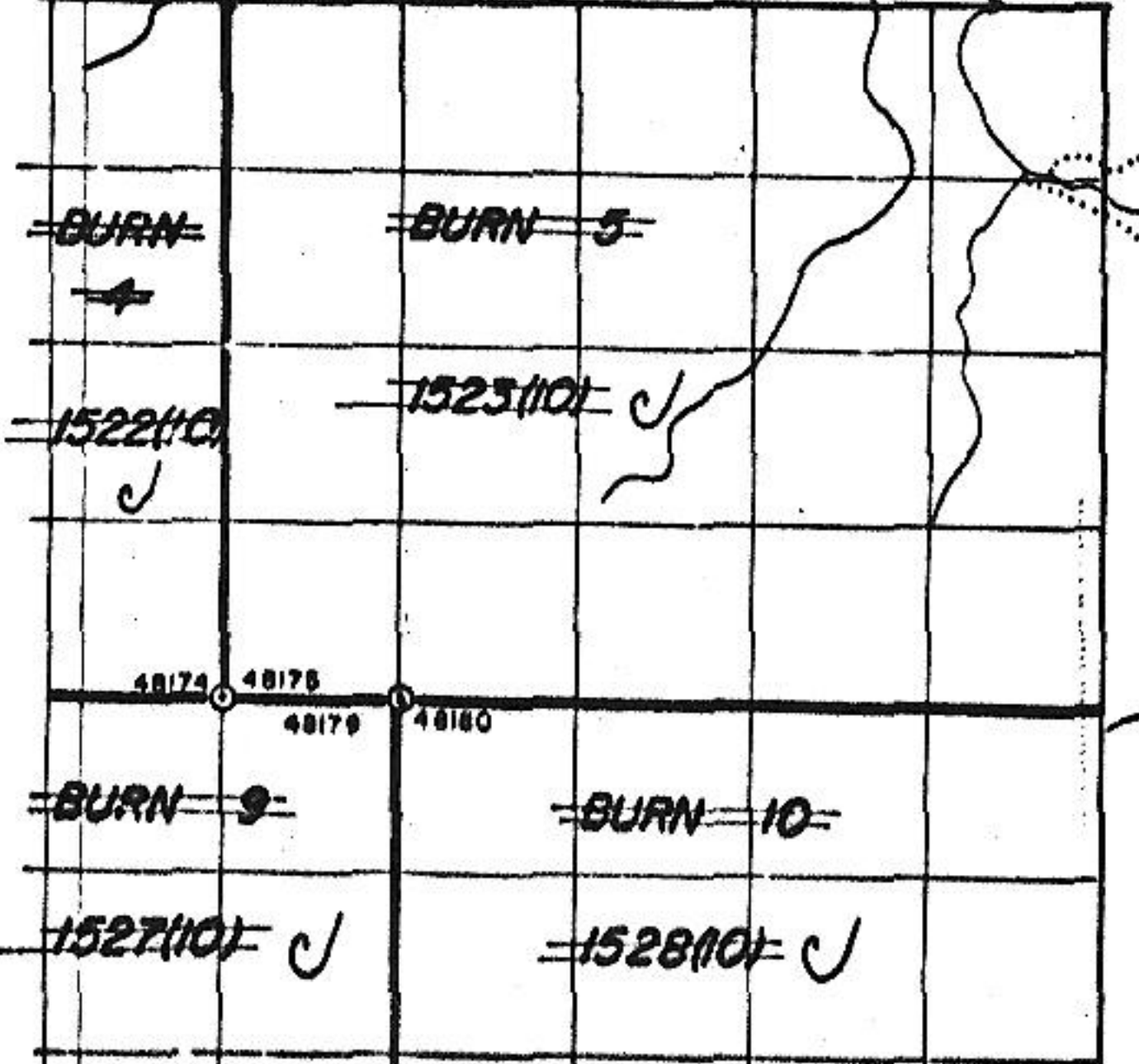

520209  
Silver Island  
93K/6W

93 K/

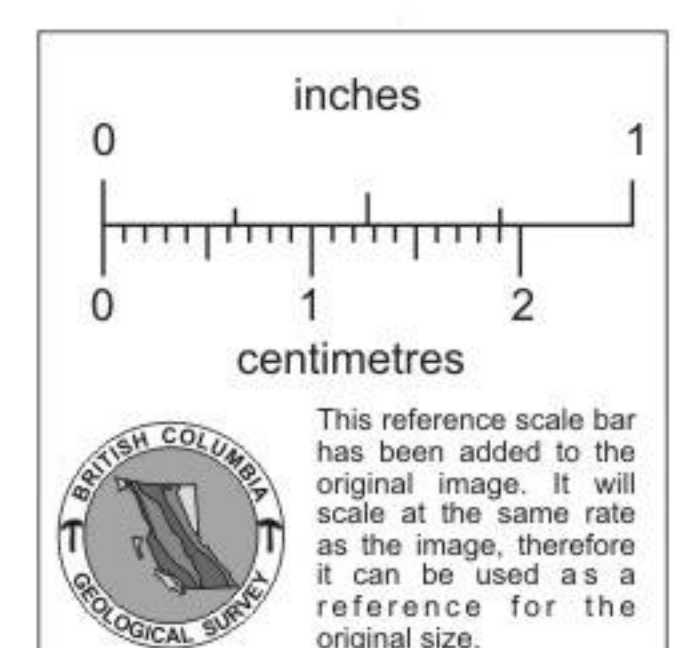

For up-to-date information on claims in any area you should apply to the Mining