

CHRISTOPHER G. BALDWIN

2800 VANCOUVER CENTRE
P.O. BOX 11506
650 WEST GEORGIA STREET
VANCOUVER, B.C., CANADA
V6B 4R7

LAWSON, LUNDELL, LAWSON & MCINTOSH
BARRISTERS AND SOLICITORS

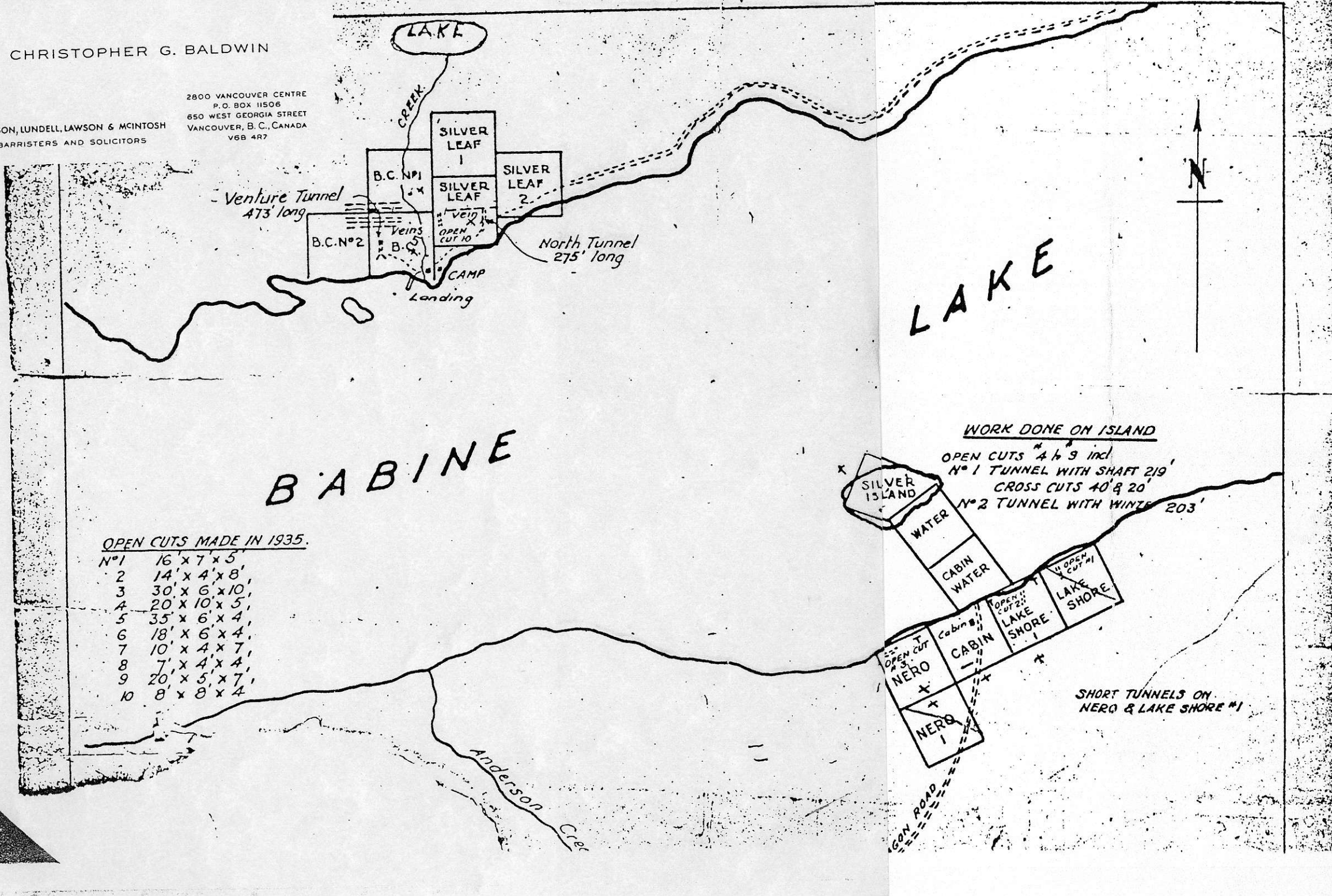

OPEN CUTS MADE IN 1935.

| | |
|-----|----------------|
| N°1 | 16' x 7' x 5' |
| 2 | 14' x 4' x 8' |
| 3 | 30' x 6' x 10' |
| 4 | 20' x 10' x 5' |
| 5 | 35' x 6' x 4' |
| 6 | 18' x 6' x 4' |
| 7 | 10' x 4' x 7' |
| 8 | 7' x 4' x 4' |
| 9 | 20' x 5' x 7' |
| 10 | 8' x 8' x 4' |

WORK DONE ON ISLAND

OPEN CUTS 4, 6, 9 incl
N°1 TUNNEL WITH SHAFT 219'
CROSS CUTS 40' & 20'
N°2 TUNNEL WITH WINTER 203'

SHORT TUNNELS ON
NERO & LAKE SHORE #1

CSK 6W 93K
25

520208
Silver Island
93K/6W